

BSA

SPARES

BANTAM

Direct Lighting. Engine No. from DD-8577

Battery Lighting. Engine No. from DDB-7849

Frame Nos. from BD2S-65001

COPY OF B.S.A. MOTOR CYCLE SPARE PARTS GUARANTEE

We give the following guarantee with B.S.A. Motor Cycle Spare Parts, instead of the guarantee implied by statute or otherwise, as to the quality or fitness of such parts for the purpose for which they are intended, any such implied guarantee being in all cases excluded, nor can any claim for consequential damages be entertained.

WE GUARANTEE, subject to the conditions mentioned below, that all precautions which are usual and reasonable have been taken by us to secure excellence of materials and workmanship, but this guarantee is to extend and be in force for six months only from the date of purchase, and the damages for which we make ourselves responsible under this guarantee are limited to the replacement of any part which may have proved defective.

WE UNDERTAKE, subject to the conditions mentioned below, to make good at any time within six months any defects in these respects. As motor cycles are easily liable to derangement by neglect or misuse, this guarantee does not apply to defects caused by wear and tear, misuse, or neglect. The term "misuse" shall include among others the following acts: The attaching of a sidecar to the motor cycle in such a manner as to cause damage or calculated to render the latter unsafe when ridden: the use of a motor cycle or a motor cycle and sidecar combined when carrying more persons or a greater weight than they were designed to bear.

CONDITIONS OF GUARANTEE

We do not guarantee the specialities of other firms, such as tyres, electrical equipment, saddles, etc., or of any component part supplied to the order of the purchaser differing from our standard specification, whether supplied with our motor cycles or otherwise.

ALWAYS USE



CATALOGUE OF



B.S.A. MOTOR CYCLES LTD.

Registered Offices and Works:

BIRMINGHAM 11

Telephones: **BIRMINGHAM, VICTORIA 2381**

Telegrams and Cables: "SELMOTO, BIRMINGHAM"

All Communications relating to Spare Parts or Repairs to B.S.A. Motor Cycles should be addressed

SERVICE DEPT., MONTGOMERY STREET, BIRMINGHAM 11

Telephone: **BIRMINGHAM, VICTORIA 2234**

Telegrams and Cables: "SELSERV, BIRMINGHAM"

Copyright B.S.A. Co. Ltd.

GENERAL INDEX

	<i>Pages</i>
Battery Carrier	28
Carburettors	32
Chainguards	28
Dual Seats	28
Electrical Equipment	32
Engine and Gearbox (General)	14-17
Frame and Fittings	17-19
Hub and Wheel Fittings (Front)	21-23
Hub and Wheel Fittings (Rear)	23-24
Front Fork and Fittings	21
Handlebar	26
Handlebar Controls	26
Legshields	30
Mudguards (Front)	24-26
Mudguards (Front and Rear)	26-28
Mudguards (Rear)	26-28
Overseas Distributors	10-13
Petrol Tank	28
Prop Stand	26
Safety Bars	30
Silencers	24
Standard Bolts	34
Standard Nuts	34
Standard Washers	35
Stockists	5-9
Sundries	30
Tools	30
Toolbox	26

**SUFFIX NUMBERS TO BE USED TO IDENTIFY VARYING FINISHES FOR
BANTAM MOTOR CYCLES.**

- /3 BRIGHT CHROME.
- /7 BLACK ENAMEL.
- /18 MIST GREEN.
- /41 CHROME RIM, MAROON HUB.
- /44 CHROME RIM, BLACK HUB.
- /45 CHROME RIM, MIST GREEN HUB.
- /64 PETROL TANK, BLACK AND CREAM
- /72 PETROL TANK, MAROON AND CREAM.

EXAMPLE: BANTAM PETROL TANK.
MIST GREEN 90-8001/18.

SPARKING PLUGS.

CHAMPION SPARKING PLUGS LTD., FELTHAM, MIDDLESEX.

ELECTRICAL EQUIPMENT.

MESSRS. WICO-PACY, DENBIGH ROAD, BLETCHLEY, BUCKS.

SPEEDOMETERS.

SMITH'S MOTOR ACCESSORIES LTD., CRICKLEWOOD WORKS, LONDON.

Stockist
Overseas
Distributors
Engine
and
Gearbox
Frame
and
Fittings
Front Fork
and
Fittings
Front and
Rear Hub
Wheel
Fittings
Handlebar
Prop Stand
Mudguards
Toolbox
and Silencer
Petrol Tank
Mudguard
Dual Seat
Chainguard
and Battery
Carrier
Tools and
Accessories
Mudguards
Safety
Bars
Technical

Buy only



LIST OF B.S.A. STOCKISTS

Save time and postage by contacting your nearest B.S.A. Stockist for B.S.A. Spare Parts, Spare Part Catalogues, Instruction Books, Transfer, etc.
All B.S.A. Dealers carry stocks of B.S.A. Spare Parts but the following appointed Stockists maintain a comprehensive range.

Town.	Name of Stockist.	Address.	Telephone No.	Telegraphic Address
Aberdeen	J. Dawson	24-26, Thistle Street	25556	
"	George Cheyne (Cycles) Ltd.	147-149, Holburn Street	26027	Motobike, Aberdeen.
Aberystwyth	Gwalia Motor Co.	North Parade	525	
Accrington	Bill Snape Ltd.	379, Blackburn Road	4724	
Aldershot	Phillips Bros. (Aldershot) Ltd.	Birchett Road	1111/2	Phillips, Cycles, Aldershot.
Alloa	J. G. Robertson	55-57, High Street	193	
Andover	Corbett & Ellis (Andover) Ltd.	Weyhill Road	2991	
Ashington	Mains of Ashington	Laburnum Terrace	3204	
Aylesbury	Eborn's Garage	44, Walton Street, Aylesbury	150	Eborn's, Aylesbury.
Banbury	Trinder Bros.	2 and 3, Broad Street	2546	
Barnsley	T. Garner & Son	Sheffield Road	2866	
Barnstaple	Bob Ray Ltd.	43, High Street	4266	
Bath	R. U. Holloway & Son	32-33-34, St. John's Road, Bathwick	5084	
Bedford	The Imperial Cycle Co.	58, St. Loyes	2374	
Belfast	W. J. Chambers & Co.	106 and 108, Donegall Pass	27253/4	Fastmote, Belfast.
Biggleswade	Bryants	25, 27, 72 and 74, Shortmead Street	3108	
Birkenhead	Bob Simister Ltd.	540, New Chester Road, Rock Ferry	Rock Ferry 1452	
Birmingham	County Cycle & Motor Co. Ltd.	266, Broad Street	Midland 2671	
"	C. E. Cope & Sons Ltd.	104, Bath Row (Repairs) (closed Saturday 1 p.m.).	Midland 2817	
"	Shovelbottom's Ltd.	481-487, Hagley Road, Edgbaston 17	Bearwood 2246/7	
"	Aston Auto Motors	376, Ladypool Road, Sparkbrook 12	South 2212	
Blackburn	Shuttleworth & Geldart	172, Aston Road, 6	Aston Cross 3201/2	
Blackpool	J. Hall & Son	15-17, Great Bolton Street	6678	
Blandford	Badger Garages Ltd.	102/6, Devonshire Road (opp. School)	22130	
Bolton	Charlie Robinson	Salisbury Road	615	
Boscombe	Craze Bros.	119 and 121, Higher Bridge Street	3931	
Bradford	C. Sidney Ltd.	473 and 475, Christchurch Road	Boscombe 33231/2	
"	J. K. Hirst	107, Manningham Lane	29889	
Bridgwater	Anderson & Wall	41, Wakefield Road	22543	
Brighton	Redhill Motors (Brighton) Ltd.	18, St. Mary Street	2416	Anderson & Wall, Bridgwater.
Bristol	S. J. Fair Motors Ltd.	104, North Road	5281	
Bromsgrove	Harold Tozer (Bromsgrove) Ltd.	201/3, Cheltenham Road	46238	
Brynawr	Jayne's Motors	110, Birmingham Road	3228	
Bury-St-Edmunds	Barclay Motors	Cwmbach Garage	Brynawr 271	
Cambridge	King & Harper Ltd.	Kings Road Corner	2345/9	
Canterbury	Marcel Hallet	Milton Road Corner	55201	Motors, Cambridge.
Cardiff	Car Distributors (Cardiff) Ltd.	St. Dunstan's Street	2275/6	
		134-140, City Road	30022	

Overseas Distributors

Engine and Gearbox

Frame and Fittings

Front Fork and Fittings

Front and Rear Hub Wheel Fittings

Handlebar Prop Stand Mudguards Toolbox and Silencer

Petrol Tank Mudguard Dual Seat Chainguard and Battery Carrier

Tools and Handries

Leg Shields and Safety Bars

Electrical

<i>Town.</i>	<i>Name of Stockist.</i>	<i>Address.</i>	<i>Telephone No.</i>	<i>Telegraphic Address.</i>
Cardiff	Robert Bevan & Son	29/35, Castle Street	1808	
Carlisle	W. T. Tiffin & Son	Irishgate Brow	25024	Tiffin, Irishgate, Carlisle.
Carmarthen	Eddie Stephens (Motors)	22/23, Water Street	Carmarthen 233 2983	
Castleford	Barrett's Motor Cycles (Castleford) Ltd.	27/35, Aire Street	144	
Chapel-en-le-Frith	E. W. Bowers	129, Town End	4005	
Chatham	Grays of Chatham Ltd.	11-19, High Street	4844/5	Hadler, Chelmsford.
Chelmsford	Hadlers Garage Ltd.	New Street	2887	
Cheltenham	Leslie Paynter	Bath Street	510	
Chester	Davies Bros.	34, Bridge Street	2033	
Chichester	W. Goodridge & Co. Ltd.	East Street	1429	
Clydebank	Weddell & Devine	72/114, Dumbarton Road	6131/2	
Colchester	G.B.R. Motors Ltd.	1-2, East Hill	859	
Colne	C. H. Scholfield (Motors) Ltd.	Market Place	2146/7	Coventry Motor Mart.
Coventry	Coventry Motor Mart Ltd.	86, London Road	2011	Cooke's Motors, Crewe
Crewe	Cooke's Garages (Crewe Ltd)	10-20, Nantwich Road	Croydon 3641/2	Gofrabike, Croydon.
Croydon	Godfreys Ltd.	228/234, London Road	Rainham 3284/2786	
Dagenham	Reginald Smith	Imperial House, New Road	25	
Dalton-in-Furness	H. Holme	24/26, Ulverston Road	Darlington 2071 67757	Duplex, Darlington.
Darlington	The Duplex Motor and Cycle Co. Ltd.	10-16, Grange Road	4279	
"	White Bros.	201/5/9, Northgate	45289	
Dartford	Schweizo Bros.	177, Lowfield Street	4594	
Derby	Ingle's Provincial Garages Ltd.	Walbrook Road	Douglas 170	
Doncaster	W. Cusworth (Doncaster) Ltd.	7, Hall Gate	Dudley 3464/5/6 5087	Vehicles, Dundee.
Douglas (I.O.M.)	Gilbert Harding	18, Duke Street	843/4	
Dudley	Chas. E. Cope & Sons Ltd.,	193, High Street	756	Jempsons, Eastbourne
Dundee	George McLean Ltd.	Ward Road, Riverside Drive	4455	Motorcycles, Edinburgh.
Dunstable	B. G. England (Dunstable) Ltd.	Halfmoon Hill, London Road	7188	Elgin 7188
Eastbourne	Jempsons Ltd.	118, Seaside	Howard 1631 58241	Piko, Exeter.
Edinburgh	J. R. Alexander & Co. Ltd.	10/14, Lothian Road	2913	
Elgin	Farquharsons	55/57, High Street	71815	
Enfield	D. J. Shepherd & Co. (Enfield) Ltd.	434/6, Hertford Road, Enfield Highway	Douglas 6414	Douglas 6414 Glasgow.
Exeter	P. Pike & Co. Ltd.	Alphington Street	Douglas 3802/3/4 23187	Alex Moto, Glasgow.
Frome	J. Difazio	25, Catherine Street	2202	Gloucester 23187.
Gateshead, 8	O. Carmichael & Son	75, 83 and 87 High Street West	777	Millard Motors, Guernsey.
Glasgow, C3	Bell Bros. (H.P.) Ltd.	215/233, St. George Road	Guildford 2274/5/6	
" C4	J. R. Alexander & Co. Ltd.	264-280, Great Western Road		
Gloucester	Harpers Garage	23a, Worcester Street		
Grimsby	H. J. Gresswell and Sons Ltd.	13/15, Osborne Street		
Guernsey	Millard & Co. Ltd.	Victoria Road		
Guildford	E. Pascall (Guildford) Ltd.	11/12, Woodbridge Road		

<i>Town.</i>	<i>Name of Stockist.</i>	<i>Address.</i>	<i>Telegraphic No.</i>	<i>Telephone Address.</i>
Harrogate	H. Aclam (Prop. H. Baynes)	11, Bower Road	5125	
Harrow	E. T. Pink (Harrow) Ltd. ..	Station Road	Spares 3328 0044/5	Pink, Harrow.
Hatfield	W. Waters & Sons Ltd. ..	32, Great North Road	3255	
Hereford	A. Kear & Co.	52b, Commercial Street	2239	Kear, Hereford.
Holbeach	G. Woodman Ltd.	34, Fleet Street	3221	
Hornchurch	T. W. Kirby	10, Reneo Corner	8785	
Hounslow	Stanley's Motors	46/8, Lampton Road	Hounslow 1949	
Huddersfield	Earnshaw	Manchester Road	1232	
Hull	Browns (Witham) Ltd. ..	47/49, Witham	33990/9	
"	Jordan & Co. (Hull) Ltd. ..	Storey Street	36809	Gumpton, Hull.
Ilford	J. J. Double	14, Mildmay Parade, Cranbrook Road ..	Valentine 3109	
Ilkston	Ray Gamble	Pelham Street off Bath Street,	873	
Ipswich	Revetts Ltd.	Clarkson Street	2822	
Jersey	Colebrooks (J. D. Poingdestre)	1, New Street	Central 642	Colebrooks, Jersey.
Keighley	Dick Ratcliffe	Coldshaw Garage, Haworth	Haworth 3133	
Kendal	Tom O'Loughlin	66, Stricklandgate	315	
Kirkcaldy	County Motors (Kirkcaldy) Ltd.	Junction Road	Dysart 5631	
Lancaster	Pye Motors Ltd.	Parliament Street	828	
Launceston	J. Wooldridge & Son	Western Road	21	Wooldridge, Launceston.
Leeds, 1	Watson-Cairns & Co. Ltd. ..	157/8, Lower Briggate	23379	Watson-Cairns, Briggate, Leeds.
Leicester	E. W. Champion & Son Ltd.	Welford Place	58054	
Lincoln	West's (Lincoln) Ltd. ..	116, High Street	10762/3/4	
Liverpool, 7	Bee Cycle & Motor Co. Ltd.	17-19, Renshaw Street	Royal 6375/6	Bee Cycles, Liverpool.
" 3	Cundles (Liverpool) Ltd. ..	41 and 61, Byrom Street	Central 4148	Cundles, Central 4148.
Llwhaden	James Bowen & Sons	Llwhaden, near Narberth, Pem. ..	Llwhaden 6	
London, W.1	Godfreys Ltd.	208, Great Portland Street	Euston 4632/4	Gofrabike, London.
" N.W.1	J. Grose Ltd.	379-381, Euston Road	Euston 5231	
" S.E.18	Cleare & Co. Ltd.	1 and 125, High Street	Woolwich 0174	
" W.5	Kays of Ealing Ltd.	8-10, Bond Street	Ealing 2387	Sparesokay, Ealux, London.
" S.E.13	F. Parks & Son Ltd.	404, Lewisham High Street	Lea Green 0535	
" E.8	Eleanor Motors	265/7/9, Mare Street	Amherst 5134	
" E.7	Godfrey's Ltd.	418, Romford Road, Forest Gate ..	Grangewood 1234	Gofrabike, Forgate.
" E.6	Godfrey's Ltd.	220, Barking Road, East Ham	Grangewood 8088	Gofrabike, Forgate.
" N.12	George Grose Ltd.	834, High Road, Finchley	Hillside 2149	
" N.12	Glanfield Lawrence Ltd. ..	Junction Great North Road and North Circular Road,	Finchley 0091	Glanfin, Norphone, London.
" N.15	Godfrey's Ltd.	94 and 96, High Road, Sth., Tottenham	Sta 9960	Gofrabike, London.
" S.E.11	Writers Ltd.	161/5, Kennington Lane	Reliance 1362	
" S.W.11	Owen Bros.	19, Battersea Rise, Clapham Junction ..	Battersea 7816/7	
" S.W.6	Claude Rye Ltd.	897/921, Fulham Road, Fulham	Renown 6174	Ryebikes, Walgreen, London.
" S.W.9	Pride & Clarke Ltd.	Stockwell Road	Brixton 6251	

**Overseas
Distributors**

**Engine
and
Gearbox**

**Frame
and
Fittings**

**Front Fork
and
Fittings**

**Front and
Rear Hub
Wheel
Fittings**

**Handlebar
Prop Stand
Mudguards
Toolbox
and Silencer**

**Petrol Tank
Mudguard
Dual Seat
Chainguard
and Battery
Carrier**

**Tools and
Lundries**

**Legshields
and Safety
Bars**

**Electrical
Equipment**

<i>Town.</i>	<i>Name of Stockist.</i>	<i>Address.</i>	<i>Telephone No.</i>	<i>Telegraphic Address.</i>
London, S.W.17 ..	Elite Motors (Tooting) Ltd.	951-961, Garratt Lane, Tooting Broadway	Balham 1200	
" W.12 ..	Turners Stores	81-83, Goldhawk Road, Shepherds Bush	Shepherds Bush 2436	
" W.3 ..	Whitby's of Acton Ltd. ..	273, The Vale, Acton	Shepherds Bush 5355/6	
" S.E.15 ..	West End Motors Ltd. ..	171, High Street, Peckham ..	Newcross 2589	
" N.W.10 ..	Slocumbes Ltd.	269, Neasden Lane, Neasden ..	Gladstone 2088 & 0508	
Lowestoft ..	R. Wright	67-69, London Road South ..	645	
Macclesfield ..	A. Watling	49, Buxton Road	3592	
Maidstone ..	Redhill Motors (Maidstone) Ltd.	The Broadway	3096	
Manchester, 3 ..	Tom Davies (Motors) Ltd. ..	233, Deansgate	Blackfriars 0681	
" ..	Fred Fearnley Ltd.	692-4, Ashton Old Road	East 1445/6	Fernbike, Manchester
" 22 ..	Alex Parker	31/33, Palatine Road, Northenden	Wythenshaw 2062	
Mansfield ..	Henstocks	128, Chesterfield Road North ..	329	Henstock 329, Mansfield.
Middlesbrough ..	J. T. Dickinson (Middlesbrough) Ltd.	160-162, Lindthorpe Road ..	3861	Payacob, Middlesbrough.
Neath ..	Fred Rist	16, Windsor Road	Neath 780	
Newcastle-on-Tyne ..	Dene (Newcastle) Motor Co. Ltd.	Haymarket	2-9165	Ened, Newcastle-on-Tyne
Newton Abbot ..	J. E. Green & Co.	87, Queen Street	653	
Newport (Mon.) ..	R. J. Ware & Sons	69, Commercial Street	66206	
Norwich ..	Chapmans (Norwich) Ltd. ..	38-42, Duke Street	24727	
Nottingham ..	E. W. Campion & Son Ltd. ..	Arkwright Street and Queen's Road	83444	
" ..	Ezra Sugden Ltd.	109, Gateford Road, Worksop ..	3053	
Oswestry ..	Roy Evans	Willow Street	1144/5	
Oxford ..	H. F. Temple	69, High Street, St. Thomas ..	2485	
" ..	Faulkner & Son	12, Cardigan Street	57279	
" ..	John Avery	228/230, Banbury Road	59353	
Parkstone ..	Bob Foster	472/4, Ashley Road	68	
Perth ..	M. Shaw & Sons	143, High Street	483	
Peterborough ..	Burrows Bros.	55-57, Westgate	2154	
Plymouth ..	P. Pike & Co. Ltd.	Millbay Road	Plymouth 63018	Piko, Plymouth.
Pontardulais (Glam.) ..	T. Griffiths	Forest Garage	Pontardulais 323	
Portsmouth ..	Jenkins & Purser Ltd. ..	277/281, Copnor Road	2339	
" ..	Glanfield Lawrence	147/157, Fratton Road	74331	
Preston ..	Loxham's Garages Ltd. ..	Central Garage, Charnley St., Fishergate	Sales Dept. 4242 Service Dept. 4243	Loxhams, Preston.
Pulborough ..	Gray & Rowsell	Bury Gate	Bury 4	
Radcliffe ..	Will Lord	115, Blackburn Street	2002	
Reading ..	Phillips & Bloomfield Motors Ltd.	10/24, South Street	2635	
" ..	Stocker & Shepherd Ltd. ..	131, Oxford Road and Weylen Street	3938	
Redhill ..	The Redhill Motor and Cycle Works Ltd.	50-54, Brighton Road	327	
Rotherham ..	Ernest Cross	55/59, Drummond Street	Rotherham 3987	
Salisbury ..	Pankhurst (Weymouth) Ltd.	78, Exeter Street	Salisbury 5222/3	

Town.	Name of Stockist.	Address.	Telephone No.	Telegraphic Address.
Scarborough	E. Andrew	Roscoe Street	Scarborough 1857 3338	
Sevenoaks	Angus Motor Cycles	Station Parade	3338	
Sheffield, 1	Walter Wragg Ltd.	Stanley Works, Wellington Street	26098	26098 Sheffield.
Shrewsbury	J. R. Meredith	Coleham Head	6529	
Sittingbourne	Scoones' Garage	9, West Street	66	Scoones, Sittingbourne
Slough	Sid Moram	Wexham Corner, High Street	Slough 23767 54081-2-3	
Southampton	Alec Bennett Ltd.	152, Portswood Road	54081-2-3	
Southport	H. F. Brockbank	62, King Street	5054	
Southsea	Percy Kiln	65, Elm Grove, Southsea	Portsmouth 4793 3918	
St. Helens	Geoff. Duke Ltd.	Greenfield Road Garage	3918	
St. Ives	Hallens (Hunts.) Ltd.	The Broadway	St. Ives 3071 2843	Hallens, St. Ives.
Stockport	Theobald & Coppack	6, Chestergate	2843	Theobald Coppack, Stockport.
Stoke-on-Trent	J. & N. Bassett	Howards Place, Shelton	2890	
Stourbridge	Pearson's Cycle Depot	31, Market Street	5677	
Sunderland	Dunns Garage (Sunderland) Ltd.	Wheatsheaf Corner, North Bridge Street	57666	
Swansea	Handel Davies Ltd.	230, Oxford Street	2956	
Swindon	Easters Garage	5/8, Manchester Road	2788	
Taunton	W. P. Edwards (Motors) Ltd.	Station Road	2943	Edwards, Motor Cycles, Taunton.
Thames Ditton	Comerfords Ltd.	Oxford House, Portsmouth Road	Emberbrook 5531 4184 and 7255	
Torquay	P. H. Sharam Ltd.	244/6, Union Street	4184 and 7255 925	
Troon (Ayrshire)	Cooper Bros.	125/129, Templehill	925	
Truro	W. H. Collins	Kenwyn Mews	Truro 2168	
Tunbridge Wells	G. E. Tunbridge	21, London Road	416	Motors, Tunbridge Wells.
Twickenham	C. A. Blay	192-9, Heath Road	Popesgrove 2103 & 1435 Uxbridge 125	
Uxbridge	J. H. Miles Ltd.	60, High Street	125	
Wakefield	Parkinsons (Wakefield) Ltd.	38-40, Ings Road	2087	
Walsall	The Motor Cycle Mart (Walsall) Ltd.	12, Ablewell Street	3363	
Warrington	Jack Frodsham Ltd.	37a, Winwick Street	471	
Watford	Lloyd Cooper & Co.	61, Queen's Road	2125	Lloyd Cooper, Watford.
Westcliff-on-Sea	J. Costin & Sons	233-5-7, London Road	Southend 2215 524	
Weston-super-Mare	Wyvern's of Weston Ltd.	3, Locking Road	524	Wyvern's, Weston-Super-Mare
Weybridge	W. L. Lewis & Sons	51, Church Street	2210	
Weymouth	Tilleys	9, Frederick Place	72	
Whitehaven	Mark Taylor	21, King's Street	252	
Wolverhampton	C. E. Cope & Sons Ltd.	168-9, Stafford Street	24605/6	
Worcester	W. J. Bladder & Son	52, Sidbury	2438	Bladder, Sidbury, Worcester.
Worksop	Ezra Sugden	109, Gateford Road	3053	
Worthing	Gray & Rowsell	56, Broadwater Street West	1224	
Yeovil	The Yeovil Motor Mart	Hendford	267	
York	C. S. Russell (York) Ltd.	Lawrence Street	3793	Russell, Lawrence Street, York.

Overseas
DistributorsEngines
and
GearboxesFrame
and
FittingsFront Fork
and
FittingsFront and
Rear Hub
Wheel
FittingsHandlebar
Prop Stand
Mudguards
Toolbox
and SilencerPetrol Tank
Mudguard
Dual Seat
Chainguard
and Battery
CarrierTools and
SundriesLegshields
and Safety
BarsElectrical
equipment

B.S.A. OVERSEAS DISTRIBUTORS

ADEN	Arabian Trading Co., Maalla Garage, Aden.
AFGHANISTAN	Levetus Ltd., 194, Bishopsgate, London, E.C.2.
ALASKA	Hap Alzina, 3074, Broadway, Oakland 11, California, U.S.A.
ALGERIA	Movea, 79, Ave. de la Grande Armee, Paris XVI, France, operating through: Societe Algerienne de Distribution d' Equipements Britanniques, 1, rue d' Assus Alger, Algiers.
ARGENTINA	Ditlevsen & Cia. Ltda., Av. Ingeniero Huergo 1335, Buenos Aires.
AUSTRALIA	
South Australia	J. N. Taylor & Co., 121/5, Grenfell St., Adelaide.
Victoria	Finlay Bros. (Pty) Ltd., 316/20, Elizabeth St., Melbourne C1.
West Australia	Mortlock Bros., 914, Hay Street, Perth.
N.S.W. and Queensland	Bennett & Wood Ltd., Corner Bathurst and Pitt Sts., Sydney and 128, Wickham St., Valley, Brisbane.
Tasmania	Sim King (Pty) Ltd. (Box A. 240G G.P.O.), 63, Brisbane Street, Launceston.
AUSTRIA	Maximillian Koeniger Stubenring, 20, Vienna, 1.
AZORES	Hayes & Travell Ltd., P.O. Box 56, Ponta Delgada, St. Michael's.
BAHAMAS	Nassau Bicycle Co., P.O. Box 191, Nassau.
BAHREIN	United Commercial Agencies, P.O. Box 166, Bahrein Islands, Persian Gulf.
BELGIAN CONGO.	
Albertville	La Sima S.C.R.L., P.O. Box 671, Elizabethville.
Bukavu	Touriel Motors, P.O. Box 796, Bukavu.
Couquilhatville	Ets. Fr. Mechant et Fils, P.O. Box 786, Leopoldville.
Elizabethville	La Sima, Boite Postale 671, Elizabethville.
Leopoldville	Ets. Fr. Mechant et Fils, P.O. Box 786, Leopoldville.
Usumbura	Capelluto Touriel & Co., P.O. Box 501, Usumbura, Ruanda Urundi.
Stanleyville	Nassers Trading Co. Ltd., P.O. Box 71.
BELGIUM	Ets Moorkens S.A., 571, Grande Chaussée, Berchem, Antwerp.
BERMUDA	Holmes, Williams & Purvey, Ltd., P.O. Box 444, Penmbroke.
BOLIVIA	Balfour Williamson Merchant Shippers Limited, 7, Gracechurch St., London, E.C.3, operating through: Gibbs Williamson (Bolivia) Ltda., Casilla 957, La Paz.
BORNEO.	
Br. N. Borneo	Harrisons & Crosfield (Borneo) Ltd., Import Dept., Jesselton.
Sarawak	The Borneo Co. Ltd. (P.O. Box 141), Thomson Road, Kuching.
BOUGAINVILLE	Bennett & Wood Ltd., Corner Pitt and Bathurst Streets, Sydney, N.S.W. Australia.
BRAZIL	Mesbla S.A., Rua de Passeio 48/54, Rio de Janeiro.
<i>and branches at</i>	Sao Paulo (Est. de Sao Paulo)—Rua 24 de Maio, 141.
BRAZIL	Porto Alegre (R.G. do Sul)—Rua Voluntarios de Patria 524. Belo Horizonte (Minas Gerais)—Rua Curitiba, 444-464. Recife (Pernambuco)—Rua da Palma 251' Pelotas (R.G. do Sul)—Praca Cel. P. Osorio, 152-154. Niteroi (Est. do Rio)—Rua Visconde Rio Branco 521-523. Marilia (Sao Paulo)—Rua 9 de Julho 1001. Victoria (Espirato Santo)—Av. Victoria 719-727. Salvador (Bahia)—Av. Frederico Pontes, 102-104.
BRITISH E. AFRICA.	
Kenya	
Tanganyika	International Motor Mart Ltd., P.O. Box 409, Dar-es-Salaam.
Uganda	The Uganda Co. (Africa) Ltd., P.O. Box 1, Kampala.
Zanzibar	Musa Jusabani, P.O. Box 366, Zanzibar.
BRITISH GUIANA	Booker Stores Ltd., 49/53, Water St., Georgetown.
BRITISH HONDURAS	Santiago Castillo, Box 69 Belize.
BRITISH SOMALILAND	Arabian Trading Co., Berbera.
BRITISH W. AFRICA.	
Gambia	Cie. F.A.O., Bathurst.
Ghana	Cie. F.A.O., P.O. Box 70, Accra.
Nigeria	Cie. F.A.O., P.O. Box 160, Lagos.
Sierra Leone	Cie. F.A.O., Freetown.
	(and other branches throughout territory)
BRITISH W. INDIÉS	
Antigua	Stephen R. Mendes Ltd., Colonia
Leeward Is.	House, 18, Thames St., St. John's
Barbados	Redman & Taylors Garage Ltd., P.O. Box 269, Church Street, Bridgetown.
Dominica	A. C. Shillingford & Co., P.O. Box
Leeward Is.	123, The Garage, Roseau.
Grenada	Glean's Garage, St. Patricks.
Windward Is.	
Jamaica	B.S.A. Agency Ltd., 9, King Street, Kingston.
St. Kitts	J. W. Thurston & Co. Ltd., Fort St.,
Leeward Is.	Basseterre.
St. Lucia	Peter & Co., Castries.
Windward Is.	
Montserrat	M. S. Osborne, Trescellian House.
Leeward Is.	
Nevis	J. W. Thurston & Co. Ltd., Fort St.,
Leeward Is.	Basseterre, St. Kitts.
St. Vincent	Corea & Co. Ltd., Kingstown, St.
Windward Is.	Vincent.
Trinidad	Sports & Games Ltd. (P.O. Box 271), 28, Henry Street, Port of Spain.
BURMA	Levetus Limited, 194, Bishopsgate, London, E.C.2, operating through: Fairweather Richards & Co. Ltd., 67/69, Lewis St., Rangoon.
CANADA.	
British Columbia and Alberta	Fred Deeley Ltd., 606, E. Broadway Ave., Vancouver.
Newfoundland	Edwin Murray Ltd., 256, Water Street, St. John's.
Nova Scotia	Mr. L. C. Comeau, Comeauville, Nova Scotia.

CANADA.		
Ontario	Brown's Sports & Cycle Co. Ltd.,	517, Yonge St., Toronto, 2.
Quebec	Arlington Cycle & Sports Ltd.,	1194, University St., Montreal.
Saskatchewan	Nicholson Bros., 245, Second Ave.	North, Saskatoon.
and Manitoba		
CANARY ISLANDS	J. Gonzalez Suarez, Nicolas Estevangz	4, Puerto de la Luz, Las Palmas.
CEYLON	Cargills (Ceylon) Ltd., Fort, Colombo	P.O. Box 23.
COOK ISLANDS ...	United Island Traders Ltd. (W. H.	Watson), Raratonga.
COLOMBIA	Balfour Williamson Merchant Ship-	pers Limited, 7, Gracechurch St.,
	London, E.C.3, operating through:	Tracey & Co. S.A., Apartado 1196,
	Bogota.	
COSTA RICA	Tiberio Paganella, Ciclo Sport La	Casa del Ciclista, Apartado 2321,
	San Jose.	
CUBA	Distribudora de Motocicletas Britan-	icas, S.A. Padre Varela, Havana,
	Cuba, P.O. Box 962.	
CYPRUS	St. G. Collocassides Ltd., 1-3, Heraclius	Ave., Box 91, Nicosia, Cyprus.
CYRENAICA	Metcalfe Eng. Co. Ltd., P.O. Box	216, Benghazi.
CZECHOSLOVAKIA.		
DENMARK	B.S.A. Motors & Cycles (H. V.	Hansen), G1, Kongevej 127-131,
	Copenhagen, V.	
DOMINICAN REPUBLIC	General Sales Co., Apartado 746,	Ciudad Trujillo, R.D.
DUTCH GUIANA...	The New Motor Supply & Importing	Co. (P.O. Box 422), Watermolen
	St., Paramaribo.	
ECUADOR	Balfour Williamson Merchant Ship-	pers Limited, 7, Gracechurch St.,
	London, E.C.3, operating through:	Sociedad Anonima Comercial, Anglo-
	Ecuatoriana, Apartado 410, Guay-	aquil.
EGYPT	T. W. M. Forsyth, 7, Sharia Maspero,	Cairo.
ERITREA	Arabian Trading Co. Ltd., Viale	Blattenchieta Lorenzo Tazaz, 29-
	33, Asmara.	
ETHIOPIA	Arabian Trading Co. (P.O. Box 23),	155, Cunningham Street, Addis
	Ababa.	
FALKLAND ISLANDS	The Falkland Island Co. Ltd., Port	Stanley.
	McAtasney & Sedgwick, Falkland	Store, Stanley.
FAROE ISLANDS	Charles Smith, Tronbargota, 35,	Tnorshann, Faroe Islands.
FIJI	Morris Hedstrom Ltd., Suva.	
FINLAND	S. & N. Osakeyhtio, Helsingfors,	N. Esplanadg, 19.
FRANCE	Movea S.A., 79, Ave., de la Grande	Armée, Paris XVIe.
FR. ANTILLES		
Guadeloupe	Maison F. D'Alexis 44, Rue Frebault,	Pointe-a-Pitre.
FRENCH INDIA ...	Levetus Ltd., 194, Bishopsgate,	London, E.C.2.
SOUTHERN MOROCCO		
	African and Eastern (Near East)	Ltd., P.O. Box 519, Casablanca.
FRENCH SOMALILAND	Arabian Trading Co., Djibouti.	

FRENCH W. AFRICA

Dahomey	Cie. F.A.O., Service Autos, Cotonou.
French Cameroons	Cie. F.A.O., Duala.
Ivory Coast	Cie. F.A.O., Abidjan.
Mauritania	The United Africa Co., Unilever
	House, Blackfriars, E.C.4, oper-
	ating through:
	Compagnie Du Niger Francais, Boite
	Postale No. 230, Saint-Louis,
	Senegal.
French Guinea ...	Cie. du Niger Français, Conakry.
French Sudan ...	Cie. du Niger Français, Bamako.
Senegal	Nouvelle Societé Commerciale Afri-
	caine, 31, Boulevard Pinet-
	Laprade, Dakar.
GERMANY (West)	Messrs. Alan W. A. Bruce, P.O. Box
	123, Cologne, 17.
GIBRALTAR	English Garage Ltd., Queensway,
	Gibraltar.
GILBERT and ELLICE ISLANDS	
	Morris Hedstrom Ltd., Apai, Samoa.
GREECE	D. F. Papoutsas, 56, Chalcocondillis
	St., Athens.
GUADELOUPE ...	Maison F. D'Alexis, 44, Rue Fre-
	bault, Pointe-à-Pitre.
GUATEMALA	H. J. Nicol & Co. S.C., 8A Avenida
	Sur No. 109, Guatemala City.
HADRAMUT	Arabian Trading Co., Esplanade,
	Aden.
HAITI	Yves Bajeux, Grande Rue 185,
	(P.O. Box 856), Port-au-Prince.
HAWAII ISLANDS	Schubert's Cyclery Stores (P.O. Box
	3443), Cor. Archer and South King
	Sts., Honolulu, Hawaii.
HONDURAS	M. Liebers, Apartado 51, Tegucig-
	alpa, D.C.
HONG KONG	Levetus Limited, 194, Bishopsgate,
	London, E.C.2, operating through:
	British Bicycle Co., 16, Hennessy
	Road.
ICELAND	Falkinn Ltd., P.O. Box 997,
	Rejkjavik.
INDIA	Levetus Limited, 194, Bishopsgate,
	London E.C.2, and branches in
	Delhi, Bombay and Calcutta,
	operating through:
Bombay	Noble Cycle & Motor Co., 225, Hornby
	Rd., Fort, Bombay.
Calcutta	Bentinck Cycle Co., 1/2, Chowrin-
	ghee Rd., Calcutta.
Jullundur	Janki Dass & Sons, Main Street,
	Jullundur.
Madras	Union Co. (Motors) Ltd., Mount Rd.,
	Madras.
Jaipur	Tandon Bros., 16, Daryaganj, Delhi
	7.
New Delhi	Peary Lal & Sons Ltd., Queen's
	Way, New Delhi.
Delhi	Peary Lal & Sons (E. Punjab) Ltd.,
	Peary Lal Bldg., Kashmere Gate,
	Delhi 6.
Allahabad...	Colonelganj Cycle & Motor Agency,
	12 P.D. Tandon Rd., Allahabad.
Kanpur	Calcutta Motor & Cycle Co., 26/51,
	Birhani Rd., Kanpur.
Cuttack	Pearl Cycle Stores, Naya Serak,
	Cuttack.
Lucknow	Motor Cycle House, 11, Station Rd.
	Lucknow.
Dehra Dun	Nawal Kishore and Son, 9, Esplanade
	Road, Delhi, 6.
Nagpur	Bombay Cycle Stores Co. Ltd.,
	Mahal, Nagpur City.

Overseas
Distributors

Engine
and
Gearbox

Frame
and
Fittings

Front Fork
and
Fittings

Front and
Rear Hub
Wheel
Fittings

Handlebar
Prop Stand
Mudguards
Toolbox
and Silencer

Petrol Tank
Mudguard
Dual Seat
Chainguard
and Battery
Carrier

Tools and
Sundries

Legshields
and Safety
Bars

Electrical
Equipment

INDIA		
Ranchi	Kedia Cycle Stores, Main Rd., Ranchi.
Jamnagar	Imperial Trading Co., Ranjit Rd., Jamnagar.
Meerut	Mittal Bros., Bombay Bazaar, Meerut.
Hyderabad	Sohrab Bros., Troop Bazar, Hyderabad—DN.
INDONESIA		
...	...	P. T. Platon, (Platon Trading Co.) Postrommel Dak 766, Djakarta-Kota.
IRAQ	Mr. J. A. Noury, 2/111, Rashid Street, Baghdad, Iraq.
IRISH REPUBLIC	...	Huet Bros., Ltd. 7 & 8, Bachelor's Walk, Dublin, C.9.
ISRAEL	S. Gousman & Son Ltd., 16, Haki-shon St., Tel-Aviv.
ITALIAN SOMALILAND		
...	...	Arabian Trading Co., Esplanade, Aden.
ITALY (North)	Ve Ba & C, Maestri Campionesi, 3, Milano.
JAPAN	Balcom Trading Co. Inc., Fukoku Building No. 1, 2-Chome Uchisaiwai-Cho, Chiyoda-Ku, Tokyo.
KOREA	Balcom Trading Co. Inc., Fukoku Building No. 1, 2-Chome Uchisaiwai-Cho, Chiyoda-Ku, Tokyo.
KUWAIT	Abdul Rahman Albisher & Zaid Alkazemi, Kuwait, Persian Gulf.
LEBANON	Associated Commercial Enterprise, P.O. Box 3270, Air Moureisseh, Beirut.
LIECHENSTEIN	Fibag, Postfach Zurich 39, Zurich, Switzerland.
LIBERIA	Cie. F.A.O., Monravia.
LIBYA		
Tripolitania	F.lli Pagani Soc. Coll. 33, Giaddat-omar Muktar, Tripoli.
Cyrenaica	Metcalfe Eng. Co. Ltd., P.O. Box 216, Benghazi.
LUXEMBOURG	Famo S.A., 571, Grande Chaussée, Berchem, Antwerp, Belgium.
MADAGASCAR	Movea, S.A., 79 Ave. de la Grande Armée, Paris XVIe, France.
MADEIRA	A. Gomez Loja, P.O. Box 52, Funchal.
MALAYA	Cycle & Carriage Co. (1926) Ltd., (P.O. Box 142), Orchard Road, Singapore.
MALTA	G. Anastasi, 27 and 35 opp. St. John's Church, Valletta.
MAURITIUS	Lising & Co., 32, Royal St., Port Louis.
MEXICO	Watson Phillips & Cia. Succs. S.A., Apartado Postal No. 67, Mexico 6 D.F.
...	...	Alejandro Dominguez Font Calle 60, Num. 536, Merida, Yucatan.
NETHERLANDS	Hart Nibbrig & Greeve N.V., Parkstraat 91A, The Hague.
NETHERLANDS ANTILLES (D.W.I.)	...	Caribbean Sales (P.O. Box 43), Noorstraat No. 543, Oranjestad, Aruba.
...	...	Caribbean Sales, Johvan Walbeeck, Plein No. 4A, Curacao.
NEW BRITAIN	Bennett & Wood Pty. Ltd., Corner Pitt and Bathurst Streets, Sydney, N.S.W. Australia.
NEW CALEDONIA	...	Agence Automobile, Boite Postale No. 176, Noumea Nouvelle Calédonia.
NEW GUINEA	Bennett & Wood Ltd., Corner Bathurst and Pitt Streets, Sydney N.S.W., Australia.
NEW HEBRIDES		
...	...	Bennett & Wood Ltd., Corner Pitt and Bathurst Streets, Sydney, N.S.W., Australia.
NEW IRELAND		
...	...	Bennett & Wood Ltd., Corner Pitt and Bathurst Streets, Sydney, N.S.W., Australia.
NEW ZEALAND		
...	...	Skeates & White Ltd., 48, Fort St., Auckland, C1.
NICARAGUA		
...	...	J. A. Estrada & Cia. Ltda., (Apartado No. 11) Avenida Roosevelt, Managua.
NORWAY		
...	...	Erling Sande, Grubbegaten 2/4, Oslo.
NYASALAND		
...	...	Manbala Motors Ltd., P.O. Box 467, Blantyre.
OKINAWA		
...	...	Balcom Trading Co. Inc., Fukoku Building No. 1, 2-Chome Uchisaiwai-Cho, Chiyoda-Ku, Tokyo.
PAKISTAN		
...	...	Levetus Ltd., 194, Bishopsgate, London, E.C.2, and their branches at Karachi and Dacca, operating through:
(WEST)	...	Shahnawaz Ltd. (P.O. Box 655), Victoria Rd., Karachi.
(EAST)	...	Crescent Cycle & Motor Co., 161, Nawabpur Rd., Dacca.
PANAMA		
...	...	Panamusica S.A., P.O. Box 3227, Panama.
PAPUA		
...	...	Bennett & Wood Ltd., Corner Pitt and Bathurst Streets, Sydney, N.S.W., Australia.
PARAGUAY		
...	...	J. & F. Perez, 14 de Mayo Pte Franco, Asuncion.
PERSIA (Iran)		
...	...	H. Mohammed Tavakolipoor, Ave., Boozarjomehri, Tehran.
PERU		
...	...	Balfour Williamson Merchant Shippers Limited, 7, Gracechurch St., London, E.C.3, operating through: Milne & Co. S.A., Apartado 684, Lima.
PHILIPPINES		
...	...	Campos Rueda & Sons, 421/7, Juan Luna, Manila.
PORTUGAL (North)		
...	...	Silva Neto & Ca. Lda., Anadia.
(South)	...	Stand Vidal, Rua Josquim Bonifacio No. 13C, Lisbon.
PORTUGUESE EAST AFRICA		
...	...	F. L. Simoes & Co., P.O. Box 13, Beira.
...	...	A. A. Azevedo, P.O. Box 482, Lourenco Marques.
...	...	Gordhandas Valabhdas & Filhos, P.O. Box 45, Mozambique.
...	...	Auto Sobressalentes Ltd., P.O. 206, Quelimane.
PORTUGUESE WEST AFRICA		
...	...	Casa Americana Commercial Sarl, Caixa Postal 1208, Luanda.
PORTUGUESE GUINEA		
...	...	Nunes & Irmao, C.P. 83, Bissau.
PORTUGUESE INDIA		
...	...	M.S.B. Caculo, Nova Goa.
PUERTO RICO		
...	...	M. Castro Fernandez & Co. Ltd., (P.O. Box 1579), San Juan 7, Puerto Rico.
QATAR		
...	...	Kasem and Abdulla Sons of Darwish Fakhroo, Qatar, Persian Gulf.
REUNION ISLES		
...	...	Movea S.A., 79, Avenue de la Grande-Armée, Paris XVIe, France.
RHODESIA (NORTHERN)		
...	...	Messrs. Miltons Motor Cycles Ltd., P.O. Box 315, Ndula.
...	...	Pals Motors, P.O. Box 51, Lusaka, Northern Rhodesia.
...	...	The British Cycle & Sports Co., P.O. Box 274, Livingstone.

RHODESIA (SOUTHERN)

Van Rooyen Motor Cycle Works Ltd.,
124, Gray St., Bulawayo, Southern
Rhodesia.

Alick Stuart Ltd., P.O. Box 306,
Bulawayo, Southern Rhodesia.

Ray's Engineering Co., 5th Street,
P.O. Box 19, Gwelo.

Gammon Bros., P.O. Box 151,
Umtali.

Johnstons Motor Cycle Supplies
(Pvt) Ltd., 28, Pioneer St.,
Salisbury.

SALVADOR... ... La Agencia Nacional Ltda., Avenida
Independencia, San Salvador.

SAMOA ... Morris Hedstrom Ltd., Apia.

SARAWAK ... Borneo Co. Ltd., Borneo House,
62/63, Mark Lane, London, E.C.3.

SAUDI ARABIA ... Ebrahim Abdullah Juffali & Bros.,
P.O. Box 297, Jeddah.

SEYCHELLES ... Chenard & Co., P.O. Box 5, Mahe.

SOLOMON ISLANDS

Bennett & Wood Ltd., Corner
Pitt and Bathurst Streets, Sydney,
N.S.W., Australia.

SOUTH W. AFRICA Terry's Motors, P.O. Box 784,
Windhoek.

SPAIN ... Commercial Yacobi, Jose Antonio,
Piamonte 16, Madrid.

SPANISH GUINEA J. Gonzalez Suarez, Nicola Estenuaz,
4, Puerto de la Luz, Las Palmas.
Canary Islands.

NORTHERN MOROCCO

Abraham S. Levy, (P.O. Box 132),
Casa Riera 26/28, Tangier.

SUDAN ... Geo. Djerdjian & Sons, P.O. Box
269, Khartoum.

SWEDEN ... A-B. E. Fleron, Malmo.

SWITZERLAND ... Fibag, Postfach Zurich 39, Zurich.
Van Leisen S.A., 34, Rue de la
Synagogue, Geneva.

SYRIA ... M. Chafik el Khiami & Co., Rue el
Nasr 169, Damascus, Syria.

TAHITI ... H. Jean Hamon, Papeete.

TANGIER ... Abraham J. Levy, (P.O. Box 132),
Casa Riera 26/28, Tangier.

THAILAND ... Triangle Co. Ltd., (P.O. Box 70),
Asdang Rd., Bangkok.

TONGA ... E.H. Jones, P.O. Box 34, Nukualofa,
Tonga Islands.

TRIPOLITANIA ... F.lli Pagani Soc. Coll., 113, Sciarra
Mizran, Tripoli, Libya.

TUNISIA ... Etabs. Jean Borg, 35, Rue de
Marseille, Tunis.

TURKEY ... Turkish Automobile Trade Co.,
Beyoglu Istiklal Caddesi 239,
(P.O. Box 32), Beyoglu, Istanbul.

UNION OF SOUTH AFRICA.

Cape Province ... Robb Motors Ltd., 102, Strand St.,
Cape Town, P.O. Box 1100.

Barnes Garage Ltd., P.O. Box 438,
East London.

The Union Cycle Works, P.O. Box
442, Kimberley.

Sahds, P.O. Box 149, Queenstown.
Haigh Motors (Pty) Ltd., P.O. Box
1160, Port Elizabeth.

Natal ... W. Killerby (Natal) (Pty) Ltd.,
281, Umbilo Road, Durban, Natal,
Jowett Bros., P.O. Box 201, Pieter-
maritzburg.

Orange Free State E. Hoehne & Co., P.O. Box 619,
Bloemfontein.

Transvaal... ... Fisher & Simmons Ltd., 12, Albert
Street, Johannesburg.

Shimwell Bros. (Pty) Ltd., P.O. Box
2035, Johannesburg, also at P.O.
Box 95, Pretoria.

UNITED STATES OF AMERICA.

East Coast ... B.S.A. Incorporated, 639, Passaic
Ave., Nutley 10, New Jersey.

West Coast ... Hap Alzina, 3074 Broadway, Oak-
land 11, California.

URUGUAY ... Linn & Cia. S.A., Casilla Correo
1027, Montevideo.

VENEZUELA ... Agencias B.S.A. de Venezuela C.A.
"Groupe Oriel," Calle el Progreso
Urb. las Acacias, Caracas.

"Casa del Motociclista," (Rafael E.
Montero), Calle 89-E No. 3-A-52,
Maracaibo, (Zulia and Falcon).

YEMEN ... Arabian Trading Co., Esplanade,
Aden.

Engine
and
Gearbox

Frame
and
Fittings

Front Fork
and
Fittings

Front and
Rear Hub
Wheel
Fittings

Handlebar
Prop Stand
Mudguards
Toolbox
and Silencer

Petrol Tank
Mudguard
Dual Seat
Chainguard
and Battery
Carrier

Tools and
Sundries

Legshields
and Safety
Bars

Electrical
Equipment

Plate 1

ENGINE and GEARBOX

125c.c.

Plate Ref. Number	Model	Part No.	Description.	Number per set.
1	125c.c.	90-814	Cylinder head	1
2	125c.c.	21-5103	Cylinder barrel stud nut	4
3	125c.c.	2-923	Cylinder barrel stud washer	4
4	125c.c.	66-102	Spark plug washer	1
5	125c.c.	65-114	Spark plug	1
6	125c.c.	65-1776	Spark plug suppressor	1
7	125c.c.	90-816	Cylinder head gasket	1
8	125c.c.	90-820	Cylinder barrel	1
9	125c.c.	90-736	Cylinder base gasket	1
10	125c.c.	90-9	Compression ring (standard)	2
10	125c.c.	90-278	Compression ring (.020" oversize)	2
10	125c.c.	90-394	Compression ring (.040" oversize)	2
11	125c.c.	90-337	Piston complete with rings, pegs, gudgeon pin and circlips (standard)	1
11	125c.c.	90-338	Piston complete with rings, pegs, gudgeon pin and circlips (.020" oversize)	1
11	125c.c.	90-388	Piston complete with rings, pegs, gudgeon pin and circlips (.040" oversize)	1
12	125c.c.	90-123	Piston ring peg	2
13	125c.c.	90-84	Gudgeon pin	1
14	125c.c.	90-85	Gudgeon pin circlip	2
15	125c.c.	90-130	Connecting rod bush (small end)	1
16	125c.c.	90-1340	Connecting rod, crankpin, rollers and roller cage	1
17	125c.c.	90-109	Crankcase dowel	2
18	125c.c.	90-111	Cylinder barrel stud	4
19	125c.c.	90-749	Crankshaft oil seal (o/s)	1
20	125c.c.	89-3023	Crankshaft bearing (o/s)	1
21	125c.c.	*90-1372	Crankcase with fixed fittings (o/s)	1
22	125c.c.	90-117	Primary chain cover gasket	1
23	125c.c.	90-112	Dipstick complete	1
24	125c.c.	2-2894	Dipstick washer (fibre)	1
25	125c.c.	90-10	Crankshaft bearing (o/s)	1
26	125c.c.	90-139	Primary chain cover with bushes and dowels	1
27	125c.c.	90-124	Primary chain cover screw (long)	2
28	125c.c.	65-3062	Primary chain cover screw	2
29	125c.c.	90-268	Gear change lever	1
30	125c.c.	89-3208	Gear change lever rubber	1
31	125c.c.	90-932	Kickstart lever	1
32	125c.c.	90-135	Kickstart lever rubber	1
33	125c.c.	21-5406	Kickstart and gearchange lever bolt	2
34	125c.c.	2-2580	Kickstart and gearchange lever washer	2
35	125c.c.	21-5102	Kickstart and gearchange lever nut	2
36	125c.c.	90-125	Primary chain cover screw (short)	1
37	125c.c.	90-262	Primary chain cover and drain plug washer	7
38	125c.c.	90-368	Clutch cover screw	3
39	125c.c.	29-3319	Clutch cover screw washer (shakeproof)	3
40	125c.c.	90-336	Clutch cover	1
41	125c.c.	90-27	Clutch casing snap ring	1
42	125c.c.	90-341	Clutch spring cup plate complete	1
43	125c.c.	90-30	Clutch spring cup	6
44	125c.c.	90-1367	Clutch spring	6
45	125c.c.	90-32	Clutch actuating plate complete	1
46	125c.c.	90-1318	Clutch driving plate complete	3
47	125c.c.	90-37	Clutch driven plate	2
48	125c.c.	90-241	Gear selector arm ball	1
49	125c.c.	90-46	Gear selector arm spring	1
50	125c.c.	90-47	Gear selector arm spring socket	1
51	125c.c.	2-2894	Drain plug fibre washer	1
52	125c.c.	90-115	Drain plug	1
53	125c.c.	90-75	Gearbox mainshaft bearing circlip	1
54	125c.c.	90-11	Gearbox mainshaft bearing	1
55	125c.c.	90-56	Gear selector arm bracket complete	1
56	125c.c.	90-63	Selector arm bracket screw lock washer	2
57	125c.c.	90-62	Selector arm bracket screw	2
—	125c.c.	90-1334	Flywheel and connecting rod assembly	1
58	125c.c.	90-782	Flywheel complete with shaft (o/s)	1

*Supplied only as complete assemblies (2 halves)

125c.c.	90-1371	Crankcase o/s and n/s assembled	1
---------	---------	---------------------------------	---

ENGINE and GEARBOX

125c.c.

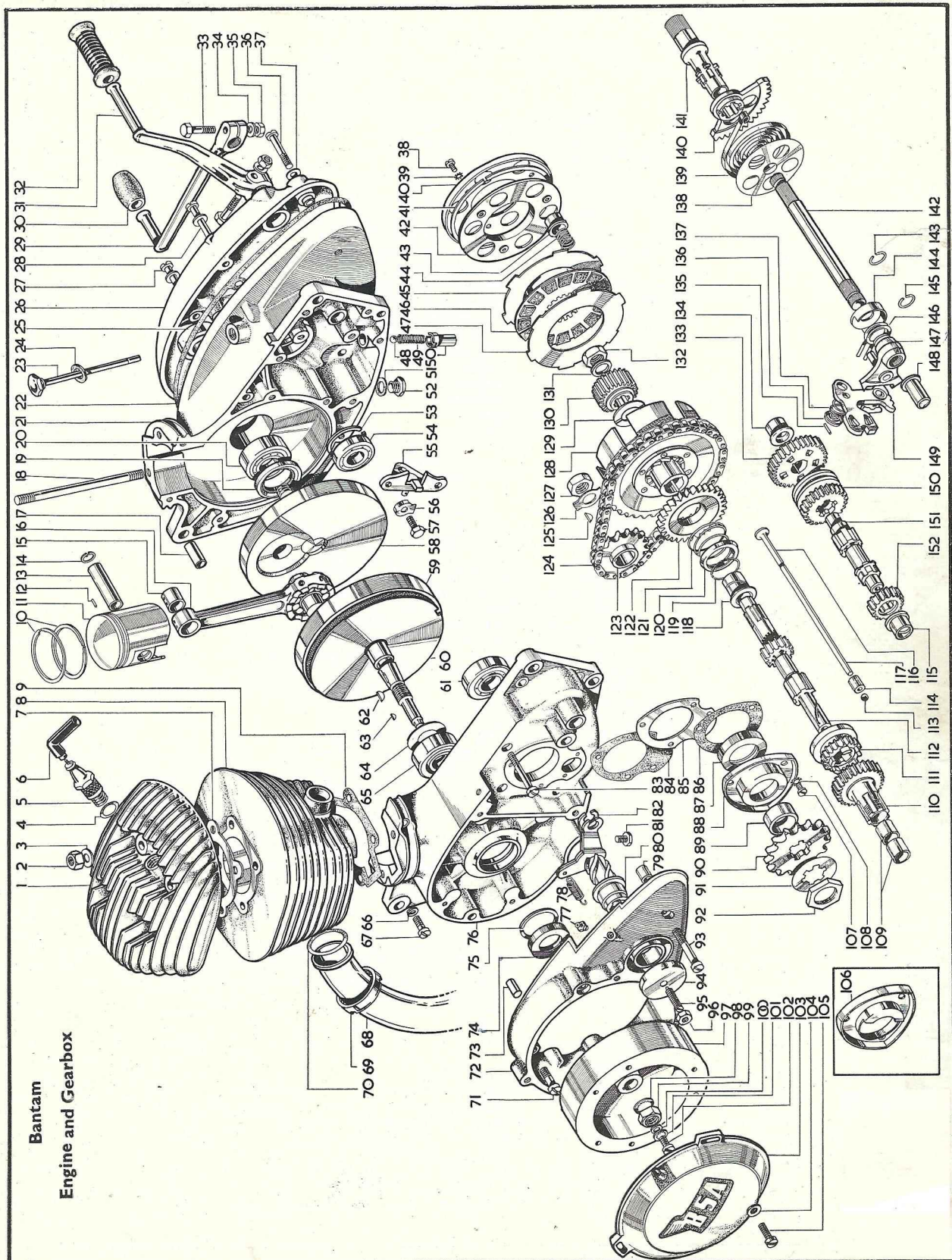

Bantam
Engine and Gearbox

Engine
and
Gearbox

Frame
and
Fittings

Front Fork
and
Fittings

Front and
Rear Hub
Wheel
Fittings

Handlebar
Prop Stand
Mudguards
Toolboxes
and Silencer

Petrol Tank
Mudguard
Dual Seat
Chainguard
and Battery
Carrier

Tools and
Sundries

Legshields
and Safety
Bars

Electrical
Equipment

ENGINE and GEARBOX

125c.c.

Plate Ref. Number.	Model.	Part No.	Description.	Number per set.
59	125c.c.	90-822	Flywheel complete with shaft (n/s)	1
60	125c.c.	90-748	Flywheel side plate	2
61	125c.c.	90-12	Gearbox pinion sleeve bearing	1
62	125c.c.	89-149	Flywheel magneto key	1
63	125c.c.	90-246	Flywheel magneto cam key	1
64	125c.c.	90-152	Crankshaft shim (.003")	as reqd.
64	125c.c.	90-153	Crankshaft shim (.004")	as reqd.
64	125c.c.	90-154	Crankshaft shim (.005")	as reqd.
64	125c.c.	90-155	Crankshaft shim (.010")	as reqd.
65	125c.c.	89-3023	Crankshaft bearing (n/s)	1
66	125c.c.	90-346	Crankcase fixing screw washer (spring)	11
67	125c.c.	65-2158	Crankcase fixing screw (short)	9
68	125c.c.	90-3024	Exhaust pipe (standard)	1
69	125c.c.	90-265	Exhaust pipe union nut	1
70	125c.c.	90-3002	Exhaust pipe union nut washer	1
71	125c.c.	90-248	Crankcase cover fixing screw (short)	2
72	125c.c.	90-1353	Crankcase cover (nearside) complete	1
73	125c.c.	90-110	Crankcase dowel	2
74	125c.c.	90-147	Crankshaft oil seal (n/s)	1
75	125c.c.	90-798	Crankshaft oil seal retaining circlip (n/s)	1
76	125c.c.	*90-1373	Crankcase with fixed fittings (n/s)	1
77	125c.c.	15-5290	Crankcase cover grease nipple (n/s)	1
78	125c.c.	90-122	Clutch operating lever spring	1
79	125c.c.	90-108	Crankcase dowel bush	2
80	125c.c.	90-184	Clutch operating lever bush	1
81	125c.c.	90-261	Crankcase drain plug	1
82	125c.c.	90-180	Clutch operating lever complete	1
83	125c.c.	90-125	Crankcase fixing screw (long)	4
84	125c.c.	90-272	Mainshaft bearing thrust plate gasket	1
85	125c.c.	90-133	Mainshaft bearing thrust plate	1
86	125c.c.	90-73	Mainshaft oil seal housing gasket	1
87	125c.c.	89-3006	Mainshaft oil seal	1
88	125c.c.	90-72	Mainshaft oil seal housing	1
89	125c.c.	90-71	Gearbox sprocket distance sleeve	1
90	125c.c.	90-68	Gearbox sprocket (standard)	1
90	125c.c.	90-299	Gearbox sprocket (14T) (as required)	1
90	125c.c.	90-473	Gearbox sprocket (16T) (as required)	1
91	125c.c.	90-70	Gearbox sprocket lock washer	1
92	125c.c.	90-172	Gearbox sprocket nut	1
93	125c.c.	90-125	Crankcase cover screw (n/s)	3
94	125c.c.	90-106	Clutch operating lever cap	1
95	125c.c.	90-105	Clutch adjusting screw	1
96	125c.c.	89-366	Clutch adjusting screw lock nut	1
97	125c.c.	19-239	Flywheel only (A.C., D.C.)	1
98	125c.c.	90-260	Flywheel magneto fixing nut washer	1
99	125c.c.	90-259	Flywheel magneto fixing nut	1
100	125c.c.	90-257	Flywheel magneto cam washer (plain)	1
101	125c.c.	90-258	Flywheel magneto cam washer (spring)	1
102	125c.c.	90-256	Flywheel magneto cam screw	1
—	125c.c.	90-959	Flywheel and generator complete (direct lighting)	1
—	125c.c.	90-960	Flywheel and generator complete (battery lighting)	1
103	125c.c.	19-284	Flywheel generator only (A.C./D.C.)	1
104	125c.c.	2-2580	Flywheel magneto fixing screw washer	3
105	125c.c.	65-2158	Flywheel magneto fixing screw	3
106	125c.c.	90-450	Mainshaft oil seal housing (must be fitted when 90-299 engine sprocket is fitted)	1
107	125c.c.	2-498	Mainshaft oil seal housing screw	5
108	125c.c.	29-3319	Mainshaft oil seal housing washer	5
109	125c.c.	90-67	Mainshaft primary drive gear bush	2
110	125c.c.	90-65	Mainshaft primary drive gear complete (standard)	1
110	125c.c.	90-474	Primary drive gear complete (alternative)	1
111	125c.c.	90-1357	Mainshaft gear (22T) (standard)	1
111	125c.c.	90-458	Mainshaft sliding gear (21T) (alternative)	1
112	125c.c.	90-1354	Gearbox mainshaft (standard)	1
112	125c.c.	90-445	Gearbox mainshaft (alternative)	1
113	125c.c.	89-5015	Clutch push rod ball	1
114	125c.c.	90-132	Clutch push rod bush (rubber)	1
115	125c.c.	90-83	Layshaft bush	1
116	125c.c.	90-98	Clutch push rod (short)	1

*See footnote on page 14.

Plate 1—continued

ENGINE and GEARBOX

125c.c.

Plate Ref. Number.	Model.	Part No.	Description.	Number per set.
117	125c.c.	90-99	Clutch push rod (long) ...	1
118	125c.c.	90-76	Clutch chainwheel distance bush	1
119	125c.c.	90-24	Clutch chainwheel circlip	1
120	125c.c.	90-40	Kickstarter pinion spring retainer	1
121	125c.c.	90-39	Kickstarter pinion spring	1
122	125c.c.	90-177	Kickstarter pinion	1
123	125c.c.	90-120	Camshaft sprocket	1
124	125c.c.	90-134	Primary chain	1
125	125c.c.	35-1896	Camshaft sprocket key	1
126	125c.c.	90-121	Camshaft sprocket lock washer	1
127	125c.c.	90-340	Crankshaft nut	1
128	125c.c.	90-175	Clutch chainwheel complete	1
129	125c.c.	90-283	Clutch chainwheel thrust washer	1
130	125c.c.	90-28	Clutch hub	1
131	125c.c.	15-39	Mainshaft washer	1
132	125c.c.	90-340	Mainshaft nut	1
133	125c.c.	90-82	Layshaft gear (32T) (standard)	1
133	125c.c.	90-448	Layshaft gear (28T) (alternative)	1
134	125c.c.	90-83	Layshaft bush	1
135	125c.c.	90-61	Swivel pin peg	1
136	125c.c.	90-60	Gear selector arm spring cup	1
137	125c.c.	90-59	Gear selector arm retaining spring	1
138	125c.c.	90-90	Kickstarter quadrant spring plate	1
139	125c.c.	90-89	Kickstarter quadrant spring	1
140	125c.c.	90-178	Kickstarter quadrant with spindle	1
141	125c.c.	90-179	Kickstarter quadrant only	1
141	125c.c.	90-88	Kickstarter quadrant spindle only	1
142	125c.c.	90-1143	Gear selector fork shaft	1
143	125c.c.	90-51	Gear selector fork spring ring	1
144	125c.c.	90-54	Gear selector fork spring cup	1
145	125c.c.	90-55	Gear selector fork spring cup ring	1
146	125c.c.	90-1288	Gear selector fork spring	1
147	125c.c.	90-190	Gear selector fork and peg	1
148	125c.c.	90-759	Gear selector shaft thrust pad	1
149	125c.c.	90-1365	Gear selector arm complete	1
150	125c.c.	90-1360	Layshaft gear (25T) (standard)	1
150	125c.c.	90-457	Layshaft sliding gear (26T) (alternative)	1
150	125c.c.	90-449	Layshaft sliding gear (25T) (alternative)	1
151	125c.c.	90-1358	Layshaft with gear (19T) (standard)	1
151	125c.c.	90-1359	Layshaft only (standard)	1
151	125c.c.	90-476	Layshaft with gear (23T) (alternative)	1
152	125c.c.	90-353	Layshaft gear (19T) (standard)	1
152	125c.c.	90-447	Layshaft gear (23T) (alternative)	1

*See footnote on page 14

Plate 2

FRAME and FITTINGS

125c.c. (Spring Frame)

Plate Ref. Number.	Model.	Part No.	Description.	Number per set.
1	125c.c.	90-4718	Central stand spring	1
2	125c.c.	90-4716	Central stand connecting link	1
3	125c.c.	90-4724	Connecting link pivot clip	1
4	125c.c.	36-382	Central stand and brake pedal stop plate bolt washer (shake-proof)	1
5	125c.c.	21-5662	Central stand and brake pedal stop plate bolt	1
5	125c.c.	21-5663	Central stand and brake pedal stop plate bolt	1
6	125c.c.	90-4707	Central stand and brake pedal stop plate	1
7	125c.c.	35-705	Footrest rod nut split pin	2

Frame
and
FittingsFront Fork
and
FittingsFront and
Rear Hub
Wheel
FittingsHandlebar
Prop Stand
Mudguards
Toolbox
and SilencerPetrol Tank
Mudguard
Dual Seat
Chainguard
and Battery
CarrierTools and
SundriesLegshields
and Safety
BarsElectrical
Equipment

FRAME and FITTINGS

125c.c. (Spring Frame)

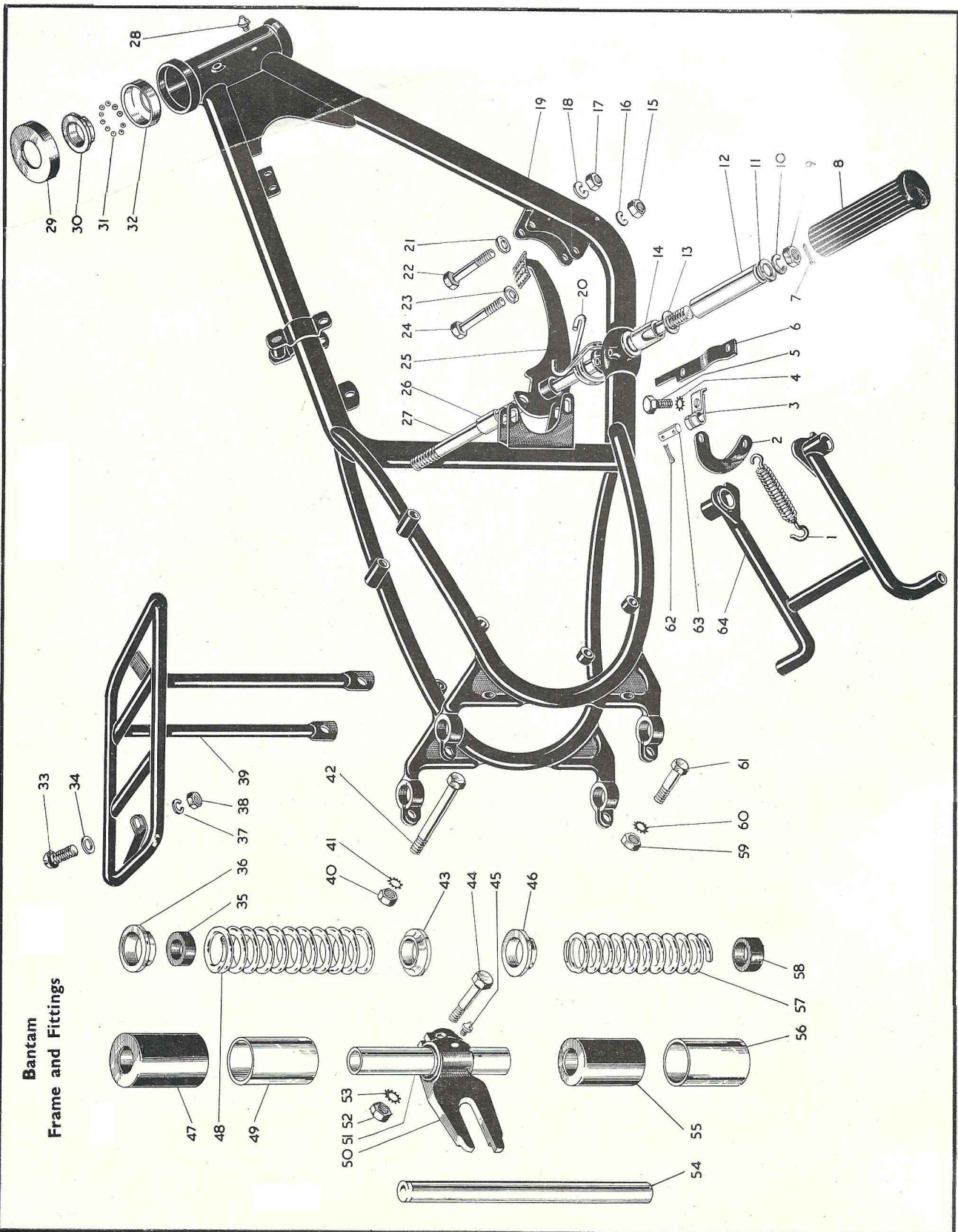

Plate 2—continued

FRAME and FITTINGS

125c.c. (Spring Frame)

Plate Ref. Number.	Model.	Part No.	Description.	Number per set.
8	125c.c.	90-4805	Footrest rubber	2
9	125c.c.	21-5306	Footrest rod nut	1
10	125c.c.	3-107	Footrest rod washer (spring)	2
11	125c.c.	24-5914	Footrest rubber locating washer (outside)	2
12	125c.c.	90-4810	Footrest rod distance tube	4
13	125c.c.	2-108	Footrest rubber locating washer (outside)	2
14	125c.c.	90-4727	Central stand sleeve (offside)	1
15	125c.c.	21-5102	Engine mounting bolt nut (bottom)	2
16	125c.c.	2-1462	Engine mounting bolt spring washer (bottom)	2
17	125c.c.	21-5103	Engine mounting bolt nut (top)	2
18	125c.c.	24-8784	Engine mounting bolt spring washer (top)	2
19	125c.c.	90-4045	Frame complete with fixed fittings	1
20	125c.c.	90-7008	Rear brake pedal return spring	1
21	125c.c.	2-923	Engine mounting bolt plain washer (top)	2
22	125c.c.	21-5670	Engine mounting bolt (top)	2
23	125c.c.	2-1374	Engine mounting bolt plain washer (bottom)	4
24	125c.c.	21-5620	Engine mounting bolt (bottom)	2
25	125c.c.	90-7001	Rear brake pedal complete	1
26	125c.c.	90-4708	Central stand and brake pedal pivot sleeve	1
27	125c.c.	90-4826	Footrest rod	1
28	125c.c.	28-2080	Ball head grease nipple	1
29	125c.c.	65-5321	Steering head dust cap	1
30	125c.c.	65-5319	Steering head ballrace cone	2
31	125c.c.	1-4676	Steering head ball (steel)	48
32	125c.c.	65-4465	Ball head cup	2
33	125c.c.	21-6173	Carrier fixing screw	2
34	125c.c.	27-8560	Carrier fixing screw washer (plain)	2
35	125c.c.	90-4105	Plunger stop rubber buffer	2
36	125c.c.	90-4115	Plunger spring collar (top)	2
37	125c.c.	2-1462	Carrier fixing screw washer (spring)	2
38	125c.c.	21-5102	Carrier fixing screw nut	2
39	125c.c.	90-6818	Carrier complete	1
40	125c.c.	21-5103	Plunger column top bolt nut	1
41	125c.c.	36-382	Plunger column top bolt washer (shakeproof)	1
42	125c.c.	21-5672	Plunger column top, mudguard stay and carrier bolt (o/s)	1
43	125c.c.	90-4112	Plunger spring collar (bottom)	2
44	125c.c.	21-5720	Bolt (plunger to lug)	2
45	125c.c.	28-2080	Lug grease nipple	2
46	125c.c.	90-4112	Rebound spring collar (top)	2
47	125c.c.	90-4111	Plunger spring shroud (outer)	2
48	125c.c.	90-4103	Plunger spring (top)	2
49	125c.c.	90-4110	Plunger spring shroud (inner)	2
50	125c.c.	90-6050	Rear hub mounting lug (nearside)	1
50	125c.c.	90-6051	Rear hub mounting lug (offside)	1
51	125c.c.	90-4113	Plunger tube with bushes (nearside)	1
51	125c.c.	90-4113	Plunger tube with bushes (offside)	1
52	125c.c.	21-5104	Plunger to lug bolt nut	2
53	125c.c.	66-4707	Plunger to lug bolt washer (shakeproof)	2
54	125c.c.	90-4121	Plunger column assembled	2
55	125c.c.	90-4120	Rebound spring shroud (outer)	2
56	125c.c.	90-4119	Rebound spring shroud (inner)	2
57	125c.c.	90-4104	Rebound spring bottom	2
58	125c.c.	90-4105	Plunger stop rubber buffer	2
59	125c.c.	21-5103	Plunger column bolt nut (bottom)	2
60	125c.c.	36-382	Plunger column bolt washer (shakeproof) (bottom)	2
61	125c.c.	21-5669	Plunger column bolt (bottom)	2
62	125c.c.	35-705	Connecting link split pin	2
63	125c.c.	90-4723	Connecting link pivot	1
64	125c.c.	90-4701	Central stand complete	1

Front Fork
and
FittingsFront and
Rear Hub
Wheel
FittingsHandlebar
Prop Stand
Mudguards
Toolbox
and SilencerPetrol Tank
Mudguard
Dual Seat
Chainguard
and Battery
CarrierTools and
SundriesLegshields
and Safety
BarsElectrical
Equipment

FRONT FORK and FITTINGS

125c.c. (Spring Frame)

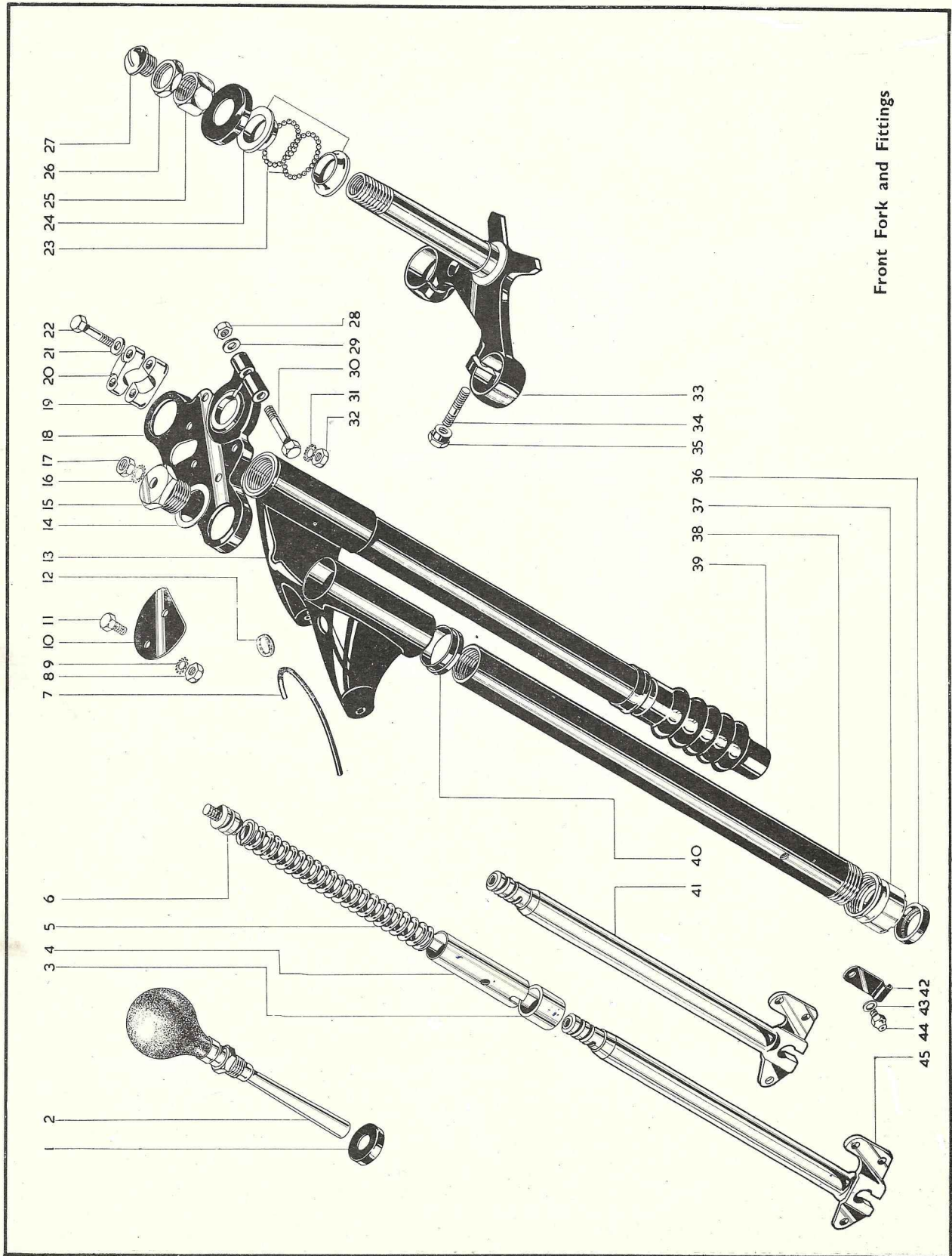

Front Fork and Fittings

Plate 3

FRONT FORK and FITTINGS

125c.c. (Spring Frame)

Plate Ref. Number.	Model.	Part No.	Description.	Number per set.
—	125c.c.	90-5116	Front fork complete	1
1	125c.c.	90-5539	Steering stem cover	1
2	125c.c.	90-9126	Bulb horn unit (when direct lighting is fitted)	1
3	125c.c.	90-5069	Fork tube bush	4
4	125c.c.	90-5068	Fork bush distance tube	2
5	125c.c.	90-5060	Fork spring	2
6	125c.c.	90-5031	Fork top scroll	2
7	125c.c.	29-5173	Headlamp beading	1
8	125c.c.	21-5102	Top yoke plate nut (required when speedo is not fitted)	2
9	125c.c.	29-541	Top yoke plate washer (required when speedo is not fitted)	2
10	125c.c.	90-5036	Top yoke plate (required when speedo is not fitted)	1
11	125c.c.	21-5611	Top yoke plate bolt (required when speedo is not fitted)	2
12	125c.c.	42-9009	Headlamp cowl speedo grommet (rubber)	1
13	125c.c.	90-5102	Headlamp mounting complete	1
14	125c.c.	90-5028	Fork tube top nut washer	2
15	125c.c.	90-5027	Fork tube top nut	2
16	125c.c.	66-4707	Fork top scroll washer	2
17	125c.c.	21-5104	Fork top scroll nut	2
18	125c.c.	90-5049	Fork top yoke	1
19	125c.c.	90-5046	Handlebar seating	2
20	125c.c.	65-5333	Handlebar clip	2
21	125c.c.	15-5155	Handlebar clip bolt washer	4
22	125c.c.	90-5082	Handlebar clip bolt	4
23	125c.c.	1-4676	Steering head balls	48
24	125c.c.	65-5319	Steering head ball race cone	2
25	125c.c.	90-5017	Steering stem nut	1
26	125c.c.	90-5035	Steering stem locknut	1
27	125c.c.	90-5050	Steering stem plug (required when bulb horn is not fitted)	1
28	125c.c.	21-5103	Top yoke clamp bolt nut	1
29	125c.c.	15-5155	Top yoke clamp bolt washer	2
30	125c.c.	21-5672	Top yoke clamp bolt	1
31	125c.c.	36-382	Handlebar clip bolt washer	4
32	125c.c.	21-5103	Handlebar clip bolt nut	4
33	125c.c.	90-5004	Bottom yoke	1
34	125c.c.	90-5018	Bottom yoke clamp stud	2
35	125c.c.	90-5052	Headlamp bracket and bottom yoke clamp stud nut	2
36	125c.c.	90-5044	Fork tube oil seal	2
37	125c.c.	90-5067	Fork tube nut	2
38	125c.c.	90-5095	Fork outer tube complete	2
39	125c.c.	90-5081	Fork leg gaiter	2
40	125c.c.	90-5107	Headlamp mounting distance rubber	4
41	125c.c.	90-5087	Fork sliding tube complete (right-hand)	1
42	125c.c.	90-5096	Fork tube bottom nut retaining clip	2
43	125c.c.	29-541	Fork tube grease nipple washer (spring)	2
44	125c.c.	28-2080	Fork tube grease nipple	2
45	125c.c.	90-5088	Fork sliding tube complete (left-hand)	1

Front Fork
and
FittingsFront and
Rear Hub
Wheel
FittingsHandlebar
Prop Stand
Mudguards
Toolbox
and SilencerPetrol Tank
Mudguard
Dual Seat
Chainguard
and Battery
Carrier

Plate 4

FRONT HUB and WHEEL FITTINGS

125c.c. (Spring Frame)

Plate Ref. Number.	Model.	Part No.	Description.	Number per set.
—	125c.c.	90-5500/45	Front wheel complete with spindle and bearings (less brake and tyre).	1
1	125c.c.	90-5575	Front hub spindle nut	1
2	125c.c.	90-5544	Hub cover plate locking sleeve	1
3	125c.c.	21-5103	Brake operating lever nut	1
4	125c.c.	36-382	Brake operating lever washer (shakeproof)	1
5	125c.c.	15-5155	Brake operating lever washer (plain)	1
6	125c.c.	90-5547	Brake operating lever	1
7	125c.c.	1-5325	Brake cam bearing oil hole cover	1
8	125c.c.	90-5526	Front brake cover plate complete	1
9	125c.c.	90-5533	Brake cam complete	1

Tools and
SundriesLegshields
and Safety
BarsElectrical
Equipment

Plate 4 FRONT HUB and WHEEL FITTINGS
125c.c. (Spring Frame)

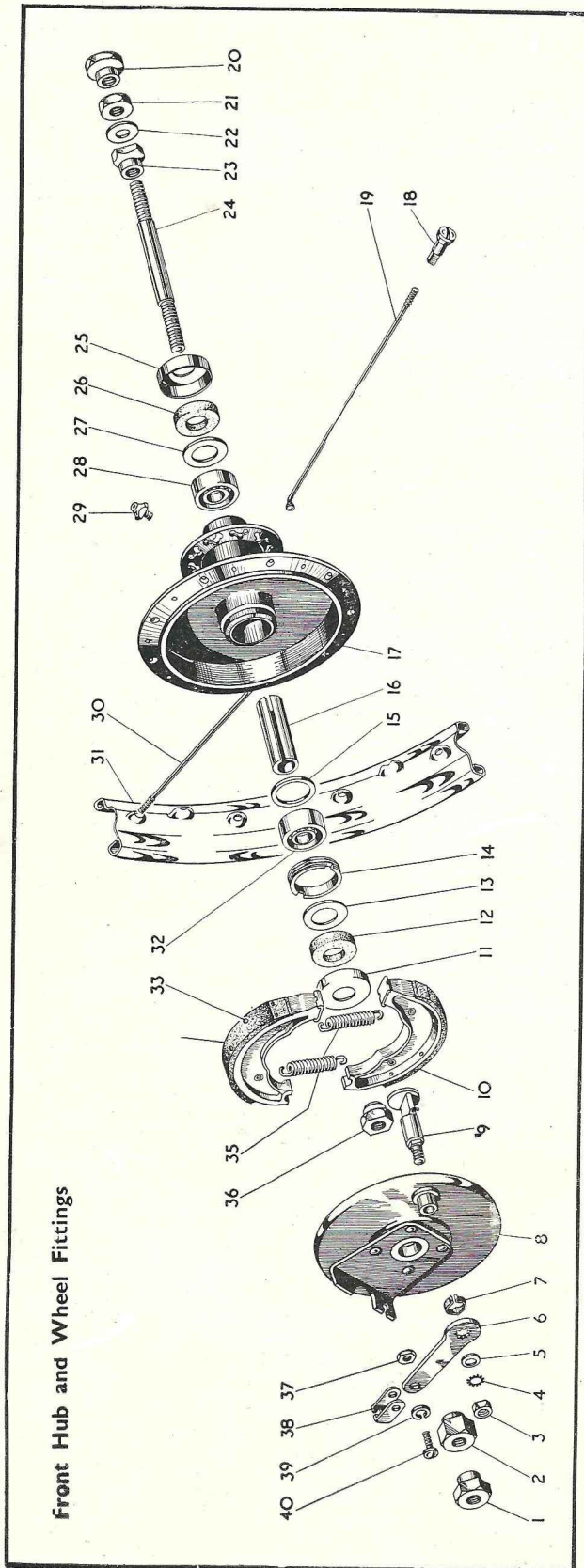

REAR HUB and WHEEL FITTINGS
125c.c. (Spring Frame) Plate 5

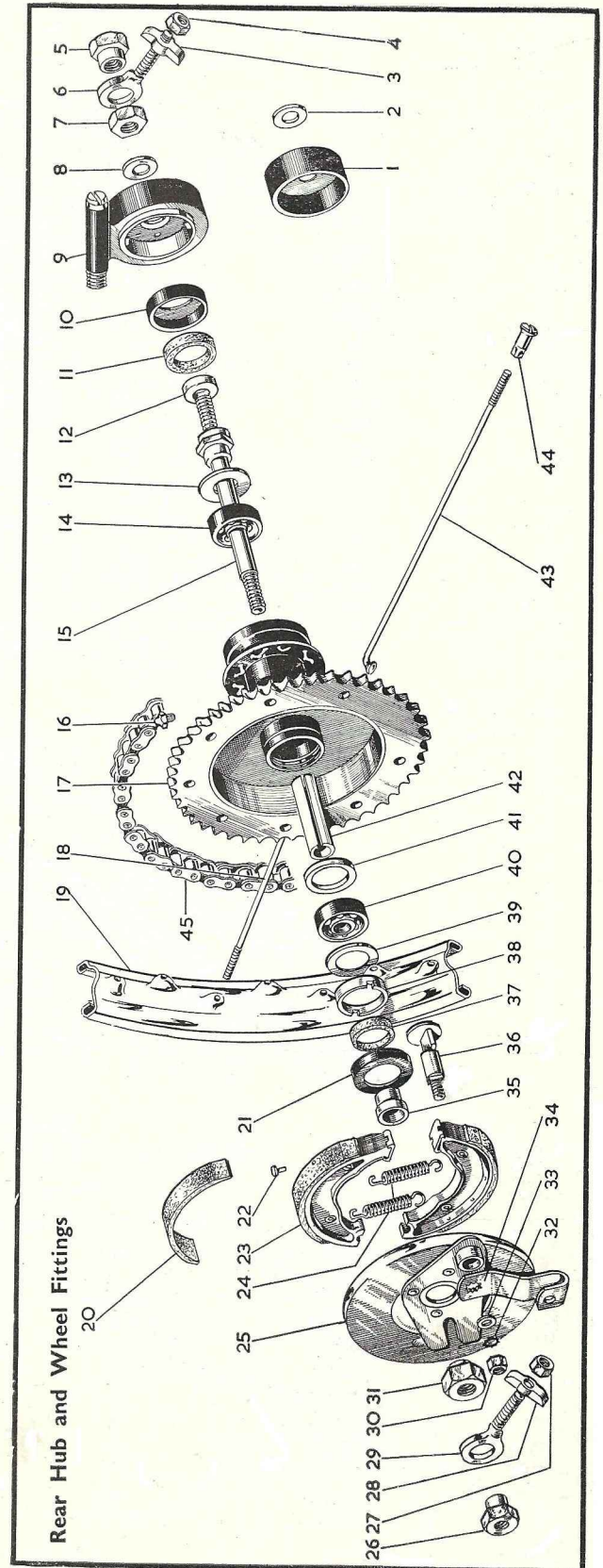

Plate 4—continued

FRONT HUB and WHEEL FITTINGS

125c.c. (Spring Frame)

Plate Ref. Number.	Model.	Part No.	Description.	Number per set.
10	125c.c.	90-5520	Brake shoe complete with lining	2
11	125c.c.	90-5539	Felt retaining cup	1
12	125c.c.	90-5540	Hub felt washer	1
13	125c.c.	90-5538	Felt retaining washer (steel)	1
14	125c.c.	90-5537	Hub bearing lockring	1
15	125c.c.	90-5536	Bearing locating washer	1
16	125c.c.	90-5535	Hub bearing distance piece	1
17	125c.c.	90-5509/18	Front hub complete with spindle and bearings	1
18	125c.c.	27-6813	Front wheel spoke nipple	36
19	125c.c.	90-5584	Front wheel spoke (left-hand)	18
20	125c.c.	90-5575	Front hub spindle nut	1
21	125c.c.	90-5543	Front hub spindle locknut	1
22	125c.c.	90-5545	Hub spindle shim (.010")	as reqd.
23	125c.c.	90-5546	Hub bearing locknut	1
24	125c.c.	90-5541	Front hub spindle	1
25	125c.c.	90-5539	Felt retaining cup	1
26	125c.c.	90-5540	Hub felt washer	1
27	125c.c.	90-5538	Felt retaining washer (steel)	1
28	125c.c.	90-5525	Hub bearing	1
29	125c.c.	28-2080	Hub shell grease nipple	1
30	125c.c.	90-5583	Front wheel spoke (right-hand)	18
31	125c.c.	90-5504/3	Front wheel rim (WM1-19)	1
32	125c.c.	90-5525	Hub bearing	1
33	125c.c.	90-5549	Brake shoe lining rivet	14
34	125c.c.	90-5522	Brake shoe lining	2
35	125c.c.	65-5904	Brake shoe spring	2
36	125c.c.	90-5546	Hub bearing locknut	1
37	125c.c.	2-443	Brake operating lever toggle nut	1
38	125c.c.	29-5871	Brake operating lever toggle	1
39	125c.c.	2-1462	Brake operating lever toggle washer (spring)	1
40	125c.c.	2-510	Brake operating lever toggle screw	1

Plate 5

REAR HUB and WHEEL FITTINGS

125c.c. (Spring Frame)

Plate Ref. Number.	Model.	Part No.	Description.	Number per set.
—	125c.c.	90-6161/45	Rear wheel complete with spindle and bearings (less brake and tyre).	1
1	125c.c.	66-5541	Rear hub barrel cap (supplied only when speedometer is not fitted).	1
2	125c.c.	24-5909	Rear hub barrel cap washer	1
3	125c.c.	90-6084	Chain adjuster cap	1
4	125c.c.	1-6032	Chain adjuster nut	1
5	125c.c.	90-6067	Hub spindle nut	1
6	125c.c.	90-6085	Chain adjuster	1
7	125c.c.	90-6066	Hub spindle locknut	1
8	125c.c.	42-4079	Speedometer drive washer	1
9	125c.c.	66-6266	Speedometer drive	1
10	125c.c.	90-6111	Felt retaining cup (o/s)	1
11	125c.c.	90-6073	Hub washer (felt) (o/s)	1
12	125c.c.	29-8740	Bearing locknut packing washer	1
13	125c.c.	90-6075	Felt retaining washer (steel)	1
14	125c.c.	90-6063	Hub bearing	1
15	125c.c.	90-6092	Hub spindle with nut	1
16	125c.c.	28-2080	Hub grease nipple	1
17	125c.c.	90-6090/18	Rear hub complete with spindle and bearings	1
18	125c.c.	90-6042	Rear wheel spoke (left-hand)	18
19	125c.c.	90-6159/3	Rear wheel rim	1
20	125c.c.	90-5522	Brake shoe lining	2
21	125c.c.	90-6072	Felt retaining cup (n/s)	1

Front and
Rear Hub
Wheel
FittingsHandlebar
Prop Stand
Mudguards
Toolbox
and SilencerPetrol Tank
Mudguard
Dual Seat
Chainguard
and Battery
CarrierTools and
SundriesLegshields
and Safety
BarsElectrical
Equipment

Plate 5—continued

REAR HUB and WHEEL FITTINGS

125c.c. (Spring Frame)

Plate Ref. Number.	Model.	Part No.	Description.	Number per set.
22 ...	125c.c.	90-5549	Brake shoe lining rivet	14
23 ...	125c.c.	90-5520	Brake shoe complete with lining	2
24 ...	125c.c.	65-5904	Brake shoe spring	2
25 ...	125c.c.	90-6059	Rear hub cover plate complete	1
26 ...	125c.c.	90-6067	Hub spindle nut	1
27 ...	125c.c.	1-6032	Chain adjuster nut	1
28 ...	125c.c.	90-6084	Chain adjuster cap	1
29 ...	125c.c.	90-6085	Chain adjuster	1
30 ...	125c.c.	21-5103	Brake operating lever nut	1
31 ...	125c.c.	90-6096	Cover plate locking nut	1
32 ...	125c.c.	36-382	Brake operating lever washer	1
33 ...	125c.c.	15-5155	Brake operating lever washer	1
34 ...	125c.c.	90-6043	Brake operating lever	1
35 ...	125c.c.	90-6095	Hub distance piece	1
36 ...	125c.c.	90-5533	Brake cam	1
37 ...	125c.c.	90-6074	Hub washer (felt) (n/s)	1
38 ...	125c.c.	90-6071	Hub bearing locking	1
39 ...	125c.c.	90-6075	Felt retaining (steel)	1
40 ...	125c.c.	90-6063	Hub bearing	1
41 ...	125c.c.	90-6076	Hub bearing thrust washer	1
42 ...	125c.c.	90-6064	Hub bearing distance piece	1
43 ...	125c.c.	90-5584	Rear wheel spoke (right-hand)	18
44 ...	125c.c.	27-6813	Spoke nipple	36
45 ...	125c.c.	90-9037	Transmission chain (rear)	1

Plate 6

Handlebar and Controls, Prop Stand, Mudguards, Toolbox, Chainguards and Silencer

125c.c. (Spring Frame)

Plate Ref. Number.	Model.	Part No.	Description.	Number per set.
1 ...	125c.c.	21-5103	Silencer stud nut	1
2 ...	125c.c.	35-33	Silencer stud washer (spring)	1
3 ...	125c.c.	2-2138	Silencer stud washer (plain)	1
4 ...	125c.c.	90-3091	Silencer fishtail	1
5 ...	125c.c.	90-3059	Sealing ring	1
6 ...	125c.c.	90-3047	Baffle assembly	1
7 ...	125c.c.	90-3061	Silencer fixing clip complete	1
8 ...	125c.c.	21-5102	Silencer fixing clip nut	1
9 ...	125c.c.	90-3064	Silencer fixing clip 'D' piece	1
10 ...	125c.c.	90-3063	Silencer fixing clip 'T' bolt	1
11 ...	125c.c.	90-3040	Silencer complete	1
12 ...	125c.c.	90-3017	Silencer support stud	1
13 ...	125c.c.	66-8348	Silencer support stud distance piece	1
14 ...	125c.c.	2-370	Silencer support stud washer (plain)	1
15 ...	125c.c.	36-382	Silencer support stud washer (shakeproof)	1
16 ...	125c.c.	21-5103	Silencer support stud nut	1
17 ...	125c.c.	27-8560	Front mudguard to stay bolt	4
18 ...	125c.c.	90-6531	Front mudguard to stay bolt washer (plain) (rear)	2
19 ...	125c.c.	21-5611	Front mudguard stay (rear)	2
20 ...	125c.c.	27-8560	Front mudguard stay bolt	2
21 ...	125c.c.	90-6530	Front mudguard stay (front) bottom fixing bolt washer (plain)	2
22 ...	125c.c.	21-5102	Front mudguard stay (front)	2
23 ...	125c.c.	2-1462	Front mudguard loopstay bolt nut (fork end)	4
24 ...	125c.c.	90-6528	Front mudguard loopstay bolt washer (spring) (fork end)	4
25 ...	125c.c.	29-541	Front mudguard loopstay complete	1
26 ...	125c.c.	21-5102	Front mudguard stay (front) bottom fixing bolt washer (shakeproof)	2
27 ...	125c.c.	27-8560	Front mudguard stay (front) bottom fixing bolt nut	2
28 ...	125c.c.	21-5611	Front mudguard to loopstay bolt washer (plain)	2
29 ...	125c.c.	2-2395	Front mudguard stay bolt	2
30 ...	125c.c.	2-1462	Front number plate fixing stud nut	2
31 ...	125c.c.	27-8560	Front number plate fixing stud washer (spring)	2
— ...	125c.c.	27-8560	Front mudguard to stay bolt washer (plain) (front)	2
— ...	125c.c.	27-8560	Front number plate washer (plain)	2

Handlebar and Controls, Prop Stand, Mudguards, Toolbox, Silencers
125c.c. (Spring Frame)

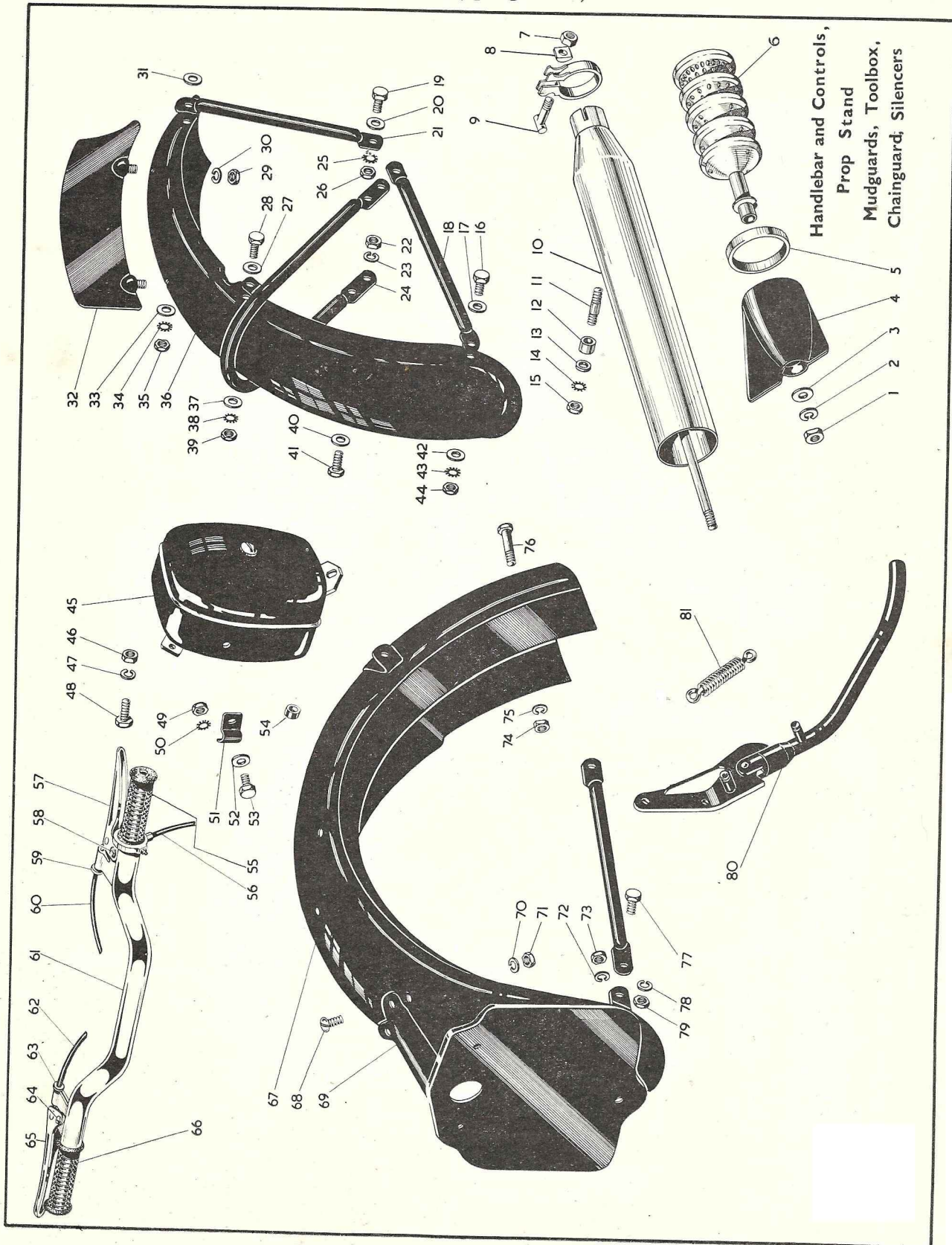

Handlebar
Prop Stand
Mudguards
Toolbox
and Silencer

Petrol Tank
Mudguard
Dual Seat
Chain Guard
and Battery
Carrier

Tools and
Sundries

Legshields
and Safety
Bars

Electrical
Equipment

Plate 6—cont'd Handlebar and Controls, Prop Stand, Mudguards, Toolbox, Chainguards and Silencer
125c.c. (Spring Frame)

Plate Ref. Number.	Model.	Part No.	Description.	Number per set.
32 ...	125c.c.	65-6576	Front number plate complete ...	1
33 ...	125c.c.	27-8560	Front mudguard to stay bolt washer (plain) (front)	2
34 ...	125c.c. Rigid	29-541	Front mudguard to stay bolt washer (shakeproof) (front)	2
	125c.c., 150c.c. Spring			
	150c.c. Swinging Arm			
35 ...	125c.c. Rigid	21-5202	Front mudguard to stay bolt nut (front)	2
	125c.c., 150c.c. Spring			
	150c.c. Swinging Arm			
36 ...	125c.c. Rigid	90-6527	Front mudguard with fixed fittings	1
	125c.c., 150c.c. Spring			
37 ...	125c.c. Rigid	27-8560	Front mudguard to loopstay bolt washer (plain)	2
	125c.c., 150c.c. Spring			
38 ...	125c.c. Rigid	29-541	Front mudguard to loopstay bolt washer (shakeproof)	2
	125c.c., 150c.c. Spring			
39 ...	125c.c. Rigid	21-5202	Front mudguard to loopstay bolt nut	2
	125c.c., 150c.c. Spring			
40 ...	125c.c. Rigid	27-8560	Front mudguard loopstay bolt washer (plain) (fork end)	4
	125c.c., 150c.c. Spring			
41 ...	125c.c. Spring	21-5613	Loopstay to fork bolt	4
	150c.c. Swinging Arm			
42 ...	125c.c. Rigid	27-8560	Front mudguard to stay bolt washer (plain) (rear)	2
	125c.c., 150c.c. Spring			
	150c.c. Swinging Arm			
43 ...	125c.c. Rigid	29-541	Front mudguard to stay bolt washer (shakeproof) (rear)	2
	125c.c., 150c.c. Spring			
	150c.c. Swinging Arm			
44 ...	125c.c. Rigid	21-5202	Front mudguard to stay bolt nut (rear)	2
	125c.c., 150c.c. Spring			
	150c.c. Swinging Arm			
45 ...	125c.c.	90-9134	Toolbox complete with lid (Wico Pacy battery lighting)	1
45 ...	125c.c.	90-9075	Toolbox complete with lid (Wico Pacy direct lighting)	1
46 ...	125c.c.	21-5103	Toolbox and battery carrier fixing bolt nut (top)	1
47 ...	125c.c.	24-8784	Toolbox and battery carrier fixing bolt washer (spring) (top)	1
48 ...	125c.c.	21-5565	Toolbox and battery carrier fixing bolt top	1
49 ...	125c.c.	2-2395	Toolbox cable clip bolt nut	1
50 ...	125c.c.	29-541	Toolbox cable clip bolt washer (shakeproof)	1
51 ...	125c.c.	90-9060	Toolbox cable clip	1
52 ...	125c.c.	27-8560	Toolbox cable clip bolt washer (plain)	1
53 ...	125c.c.	2-204	Toolbox cable clip bolt	1
— ...	125c.c.	90-9033	Saddle	1
54 ...	125c.c.	15-7563	Toolbox distance piece (Wico Pacy battery set)	2
55 ...	125c.c.	65-8516	Throttle twist grip complete (less cable and cover)	1
56 ...	125c.c.	90-8552	Throttle control cable and cover complete	1
57 ...	125c.c.	29-8812	Front brake control lever	1
58 ...	125c.c.	29-8813	Front brake control lever screw	1
59 ...	125c.c.	90-8506	Front brake control body ferrule	1
60 ...	125c.c.	90-8520	Front brake cable and cover complete	1
61 ...	125c.c.	90-4976	Handlebar	1
62 ...	125c.c.	90-8510	Clutch control cable and cover complete	1
63 ...	125c.c.	90-8506	Clutch control body ferrule	1
64 ...	125c.c.	29-8813	Clutch control lever screw	1
65 ...	125c.c.	29-8832	Clutch control lever	1
66 ...	125c.c.	65-8502	Dummy grip (left-hand bar)	1
67 ...	125c.c.	90-6843	Rear mudguard with fixed fittings	1
68 ...	125c.c.	21-6173	Rear number plate top fixing screw	2
69 ...	125c.c.	90-6839	Rear number plate	1
70 ...	125c.c.	2-1462	Rear number plate top fixing screw washer	2
71 ...	125c.c.	21-5102	Rear number plate top fixing screw nut	2
72 ...	125c.c.	2-1462	Rear number plate bottom fixing bolt washer	1
73 ...	125c.c.	21-5102	Rear number plate bottom fixing screw nut	1
74 ...	125c.c.	21-5102	Mudguard front fixing bolt nut	1
75 ...	125c.c.	2-1462	Mudguard front fixing bolt washer	1
76 ...	125c.c.	21-5619	Mudguard front fixing bolt	1
77 ...	125c.c.	21-5611	Mudguard stay fixing bolt (rear)	2
78 ...	125c.c.	2-1462	Mudguard stay fixing bolt washer (rear)	2
79 ...	125c.c.	21-5102	Mudguard stay fixing bolt nut (rear)	2
80 ...	125c.c.	90-4735	Prop stand assembly complete	1
81 ...	125c.c.	65-4742	Prop stand spring	1
— ...	125c.c.	29-8814	Front brake and clutch lever screw nut	2
— ...	125c.c.	25-9360	Cable adjuster screw	1
— ...	125c.c.	25-9365	Cable adjuster screw locknut	0

Petrol Tank, Rear Mudguard,
Dual Seat, Chainguard
Battery Carrier

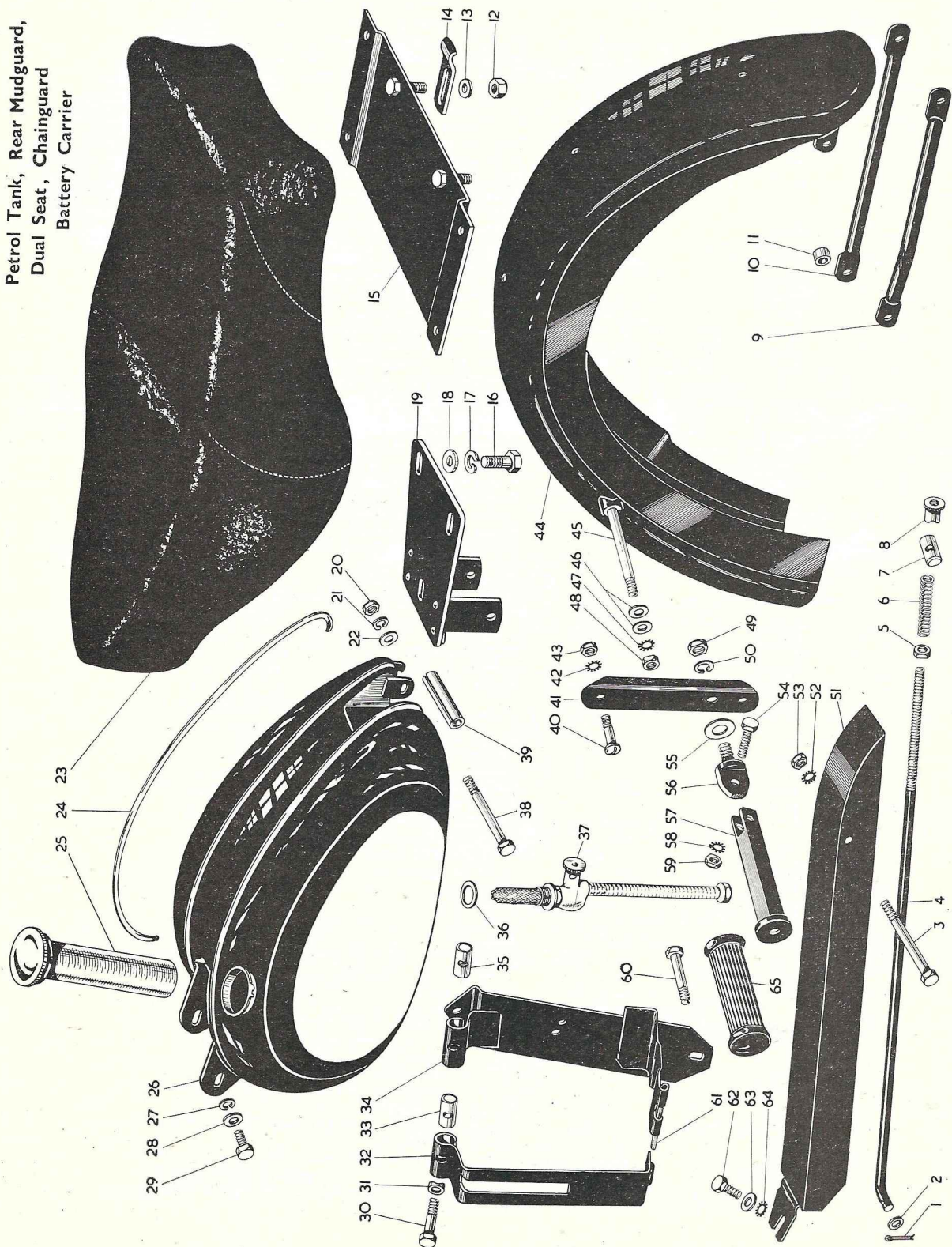

Petrol Tank
Mudguard
Dual Seat
Chainguard
and Battery
Carrier

Tools and
Sundries

Legshields
and Safety
Bars

Electrical
Equipment

Plate 7

Petrol Tank, Rear Mudguard, Dual Seat, Battery Carrier and Chainguard

125c.c. (Spring Frame)

Plate Ref. Number.	Model.	Part No.	Description.	Number per set.
1	125c.c.	35-704	Rear brake pedal rod split pin	1
2	125c.c.	2-525	Rear brake pedal rod washer	1
3	125c.c.	21-5677	Plunger column top, mudguard stay and rear chainguard bolt	1
4	125c.c.	90-7005	Rear brake rod	1
5	125c.c.	21-5102	Rear brake rod nut	1
6	125c.c.	15-1312	Rear brake rod spring	1
7	125c.c.	65-6274	Rear brake lever swivel pin	1
8	125c.c.	90-7006	Rear brake adjuster nut	1
9	125c.c.	90-6783	Rear mudguard bottom stay (nearside)	1
10	125c.c.	90-6784	Rear mudguard bottom stay (offside)	1
11	125c.c.	66-8347	Rear mudguard stay distance piece	1
12	125c.c.	21-5102	Rear carrier clip bolt nut	2
13	125c.c.	27-8560	Rear dual seat plate carrier clip washer	4
14	125c.c.	90-9203	Dual seat rear plate carrier clip	2
15	125c.c.	90-9202	Dual seat rear fixing plate	1
16	125c.c.	2-129	Dual seat front and rear bracket bolt	7
17	125c.c.	24-8784	Front and rear bracket bolt washer (spring)	7
18	125c.c.	2-923	Front and rear bracket bolt washer (plain)	7
19	125c.c.	90-9201	Dual seat front support bracket	1
20	125c.c.	21-5103	Petrol tank rear fixing bolt nut	1
21	125c.c.	24-8784	Petrol tank rear fixing bolt washer (spring)	1
22	125c.c.	2-923	Petrol tank rear fixing bolt washer (plain)	1
23	125c.c.	90-9147	Dual seat complete with brackets, bolts, and nuts	1
—	125c.c.	90-9146	Dual seat loose fittings only (sets)	1
24	125c.c.	90-8018	Petrol tank beading (o/s)	1
24	125c.c.	90-8017	Petrol tank beading (n/s)	1
25	125c.c.	90-8035	Petrol tank filler cap and oil measure	1
26	125c.c.	90-8001	Petrol tank	1
27	125c.c.	24-8784	Petrol tank front fixing bolt washer (spring)	2
28	125c.c.	2-923	Petrol tank front fixing bolt washer (plain)	2
29	125c.c.	21-5662	Petrol tank front fixing bolt	2
30	125c.c.	29-4661	Battery strap bolt	1
—	125c.c.	90-4633	Battery carrier complete	1
31	125c.c.	29-4662	Battery carrier strap saddle washer	1
32	125c.c.	90-4619	Battery strap	1
33	125c.c.	65-2352	Battery carrier swivel block (plain)	1
34	125c.c.	90-4634	Battery carrier back	1
35	125c.c.	65-2353	Battery carrier swivel block (tapped)	1
36	125c.c.	24-8504	Petrol tap washer	1
37	125c.c.	90-8029	Petrol tap complete with pipe	1
38	125c.c.	21-5676	Petrol tank rear fixing bolt	1
39	125c.c.	90-8010	Petrol tank rear fixing bolt distance tube	1
40	125c.c.	2-2980	Pillion footrest to frame bolt	4
41	125c.c.	90-4831	Pillion footrest support	2
42	125c.c.	36-382	Pillion footrest to frame bolt washer	4
43	125c.c.	2-49	Pillion footrest to frame bolt nut	4
44	125c.c.	90-6843	Rear mudguard with fixed fittings	1
45	125c.c.	90-6785	Rear mudguard and saddle fixing stud	1
46	125c.c.	2-923	Rear mudguard and saddle fixing stud washer	4
47	125c.c.	36-382	Rear mudguard and saddle fixing stud (shakeproof)	2
48	125c.c.	21-5103	Rear mudguard and saddle fixing stud nut	2
49	125c.c.	2-46	Pillion footrest anchor bolt nut	2
50	125c.c.	2-522	Pillion footrest anchor bolt washer (spring)	2
51	125c.c.	90-7711	Rear chainguard	1
52	125c.c.	36-382	Plunger column top, mudguard stay and chainguard bolt washer (shakeproof).	1
53	125c.c.	21-5103	Plunger column top, mudguard stay and chainguard bolt nut.	1
54	125c.c.	29-7564	Pillion footrest swivel bolt	2
55	125c.c.	29-5914	Pillion footrest anchor bolt washer (plain)	2
56	125c.c.	65-4917	Pillion footrest anchor bolt	2
57	125c.c.	29-7581	Pillion footrest	2
58	125c.c.	36-382	Pillion footrest swivel bolt washer (shakeproof)	2
59	125c.c.	24-6040	Pillion footrest swivel bolt nut	2
60	125c.c.	21-5672	Toolbox, battery carrier and engine bolt (top)	1
61	125c.c.	29-4664	Battery strap hinge pin	1
62	125c.c.	15-87	Rear chainguard front fixing bolt	1
63	125c.c.	27-8560	Rear chainguard front fixing bolt washer (plain)	1
64	125c.c.	29-541	Rear chainguard front fixing bolt washer (shakeproof)	1
65	125c.c.	29-7583	Pillion footrest rubber	2

TOOLS and SUNDRIES

125c.c. (Spring Frame)

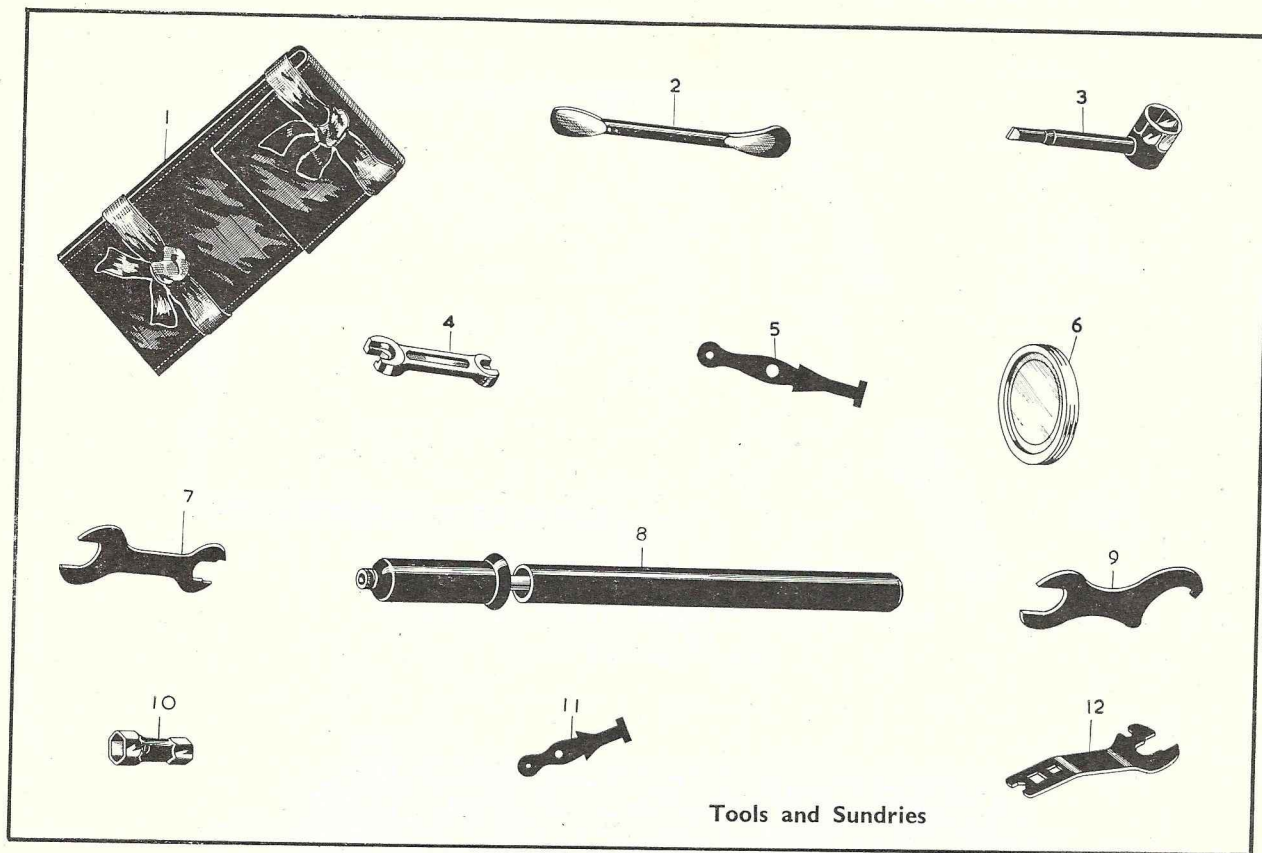

BUY

GENUINE



SPARES

EVERY OWNER OF

A B.S.A. MOTOR CYCLE IS STRONGLY

ADVISED TO BUY ONLY

GENUINE



SPARE PARTS

WHEN REPLACEMENTS BECOME NECESSARY.

Tools and
Sundries

Legshields
and Safety
Bars

Electrical
Equipment

Plate 8

TOOLS and SUNDRIES

125c.c. (Spring Frame)

Plate Ref. Number.	Model.	Part No.	Description.	Number per set.
— ...	125c.c.	... 90-9012	Toolbag complete with tools	1
1 ...	125c.c.	... 90-9192	Toolbag only	1
2 ...	125c.c.	... 90-9018	Tyre lever	1
3 ...	125c.c.	... 66-9132	Sparking plug spanner	1
4 ...	125c.c.	... 1-3051	Double ended spanner (B.S.A.)	1
5 ...	125c.c.	... 66-9049	Rubber cable clip (large)	6
6 ...	125c.c.	... 29-9221	Licence holder	1
7 ...	125c.c.	... 90-9071	Hub spindle nut spanner	1
8 ...	125c.c.	... 42-9026	Inflator	1
9 ...	125c.c.	... 90-9070	Rear wheel spindle and exhaust nut spanner	1
10 ...	125c.c.	... 65-9115	Box spanner (small)	1
11 ...	125c.c.	... 90-9024	Rubber cable clip (small)	1
12 ...	125c.c.	... 29-9254	Combination spanner	1

Plate 9

LEGSHIELDS and SAFETY BARS

125c.c. (Spring Frame)

Plate Ref. Number.	Model.	Part No.	Description.	Number per set.
1 ...	125c.c.	... 90-4812	Footrest rubber	2
2 ...	125c.c.	... 90-3021	Safety bar legshield clip (required when safety bars are fitted).	4
3 ...	125c.c.	... 90-7196	Safety bar front down tube clip	1
4 ...	125c.c.	... 21-5102	Safety bar front down tube clip nut	2
5 ...	125c.c.	... 29-541	Safety bar front down tube clip washer	2
6 ...	125c.c.	... 36-379	Safety bar front down tube clip screw	2
7 ...	125c.c.	... 90-7203	Safety bar assembled with clip, nuts, bolts and washers	1
8 ...	125c.c.	... 2-525	Legshield bottom bracket bolt washer (plain)	2
9 ...	125c.c.	... 29-541	Legshield bottom bracket bolt washer (shakeproof)	2
10 ...	125c.c.	... 21-5102	Legshield bottom bracket bolt nut	2
11 ...	125c.c.	... 90-7195	Legshield top support tube (not required when safety bar is fitted).	1
12 ...	125c.c.	... 90-7196	Legshield top support tube clip	1
13 ...	125c.c.	... 21-5102	Legshield top support tube clip nut	2
14 ...	125c.c.	... 29-541	Legshield top support tube clip washer (shakeproof)	2
15 ...	125c.c.	... 36-379	Legshield top support tube clip bolt	2
16 ...	125c.c.	... 21-5102	Legshield top support screw nut	4
17 ...	125c.c.	... 29-541	Legshield top support screw washer (shakeproof)	4
18 ...	125c.c.	... 2-525	Legshield top support screw washer (plain)	4
19 ...	125c.c.	... 21-6173	Legshield top support screw	4
20 ...	125c.c.	... 21-5102	Legshield bottom support screw nut	2
21 ...	125c.c.	... 29-541	Legshield bottom support screw washer (shakeproof)	2
22 ...	125c.c.	... 2-525	Legshield bottom support screw washer (plain)	2
23 ...	125c.c.	... 21-6173	Legshield bottom support screw	2
24 ...	125c.c.	... 90-7200	Legshield only (right-hand)	1
25 ...	125c.c.	... 90-7194	Legshield only (left-hand)	1
— ...	125c.c.	... 90-7193	Legshields assembled complete	1
26 ...	125c.c.	... 90-7198	Bottom support bracket (offside)	1
27 ...	125c.c.	... 21-5671	Support bracket engine fixing bolt	1
28 ...	125c.c.	... 90-7199	Bottom support bracket (nearside)	1
29 ...	125c.c.	... 36-382	Support bracket engine fixing bolt washer (shakeproof)	1
30 ...	125c.c.	... 21-5103	Support bracket engine fixing bolt nut	1
31 ...	125c.c.	... 90-7197	Legshield bottom bracket	2
32 ...	125c.c.	... 21-5621	Bottom bracket engine fixing bolt	1
33 ...	125c.c.	... 29-541	Bottom bracket engine fixing bolt washer (shakeproof)	1
34 ...	125c.c.	... 21-5102	Bottom bracket engine fixing bolt nut	1
35 ...	125c.c.	... 36-379	Legshield bottom bracket bolt	2

LEGSHIELDS and SAFETY BARS

125c.c. (Spring Frame)

Bantam
Legshields and Bumper Bars

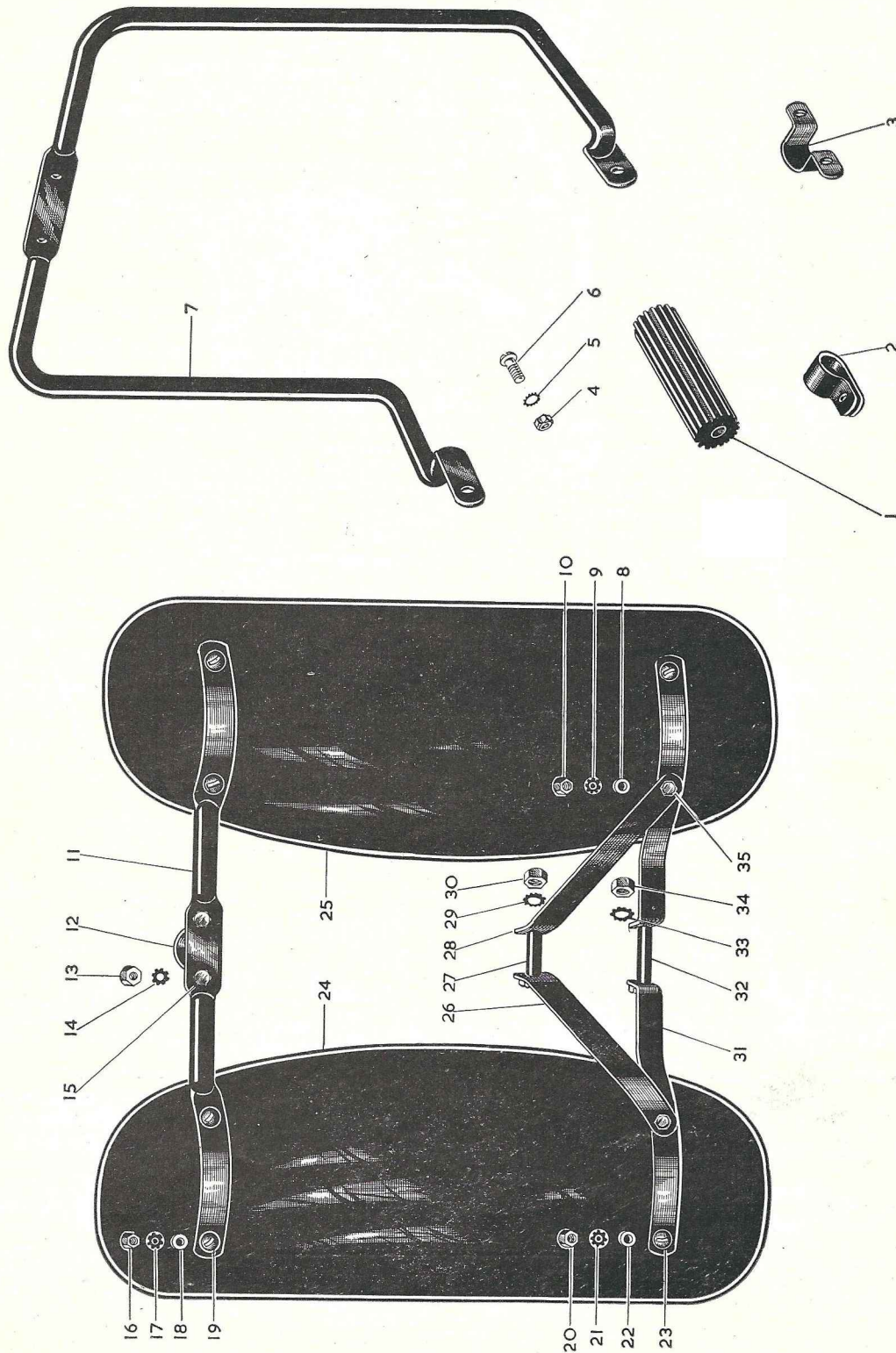

Plate 10

ELECTRICAL EQUIPMENT

125c.c. (Spring Frame)

Plate Ref. Number.	Model.	Part No.	Description.	Number per set.
1	125c.c.	90-9125	Electric horn	1
2	125c.c.	29-9349	Horn push with cable	1
—	125c.c.	66-1683	Horn push washer (fibre)	1
3	125c.c.	19-69	Tail lamp (direct lighting) (one lead)	1
3	125c.c.	19-68	Tail lamp (battery lighting) (two leads)	1
4	125c.c.	19-12	Headlamp with harness, light switch and dip switch (battery lighting).	1
5	125c.c.	19-81	Rectifier	1
6	125c.c.	19-11	Headlamp with harness, light switch and dip switch (direct lighting).	1
7	125c.c.	2-1588	Stop lamp spring clip screw nut	1
8	125c.c.	29-3319	Stop lamp spring clip screw washer	1
9	125c.c.	65-9228	Stop lamp spring clip	1
10	125c.c.	65-5912	Stop lamp spring clip screw	1
11	125c.c.	90-9127	Stop lamp spring	1
12	125c.c.	19-180	Stop lamp switch	1
13	125c.c.	2-49	Stop lamp switch fixing bolt nut (not required when pillion footrests are fitted).	1
14	125c.c.	36-382	Stop lamp switch fixing bolt washer (not required when pillion footrests are fitted).	1
15	125c.c.	2-2980	Stop lamp switch fixing bolt (not required when pillion footrests are fitted).	1
16	125c.c.	29-9293	Speedometer (m.p.h.)	1
16	125c.c.	19-2113	Speedometer (k.p.h.)	1
17	125c.c.	29-9295	Speedometer head fixing nut	2
18	125c.c.	29-9292	Speedometer head fixing nut washer	2
19	125c.c.	90-9021	Speedometer cable	1
—	125c.c.	19-1643	Battery	1

CARBURETTER

MESSRS. AMALGAMATED CARBURETTERS LTD., PERRY BARR, BIRMINGHAM.

Model	Type	Choke Size (inches)	Main Jet	Throttle Valve No.	Needle Position	Needle Jet	Engine End Size (inches)
D1	361/18	5/8	75	5	2	.106	5/8

PISTONS

Model	PISTONS COMPLETE			COMPRESSION RINGS (2)		
	Standard	.020" O.S.	.040" O.S.	Standard	.020" O.S.	.040" O.S.
D1	90-337	90-338	90-338	90-9	90-278	90-394

ELECTRICAL EQUIPMENT

125c.c. (Spring Frame)

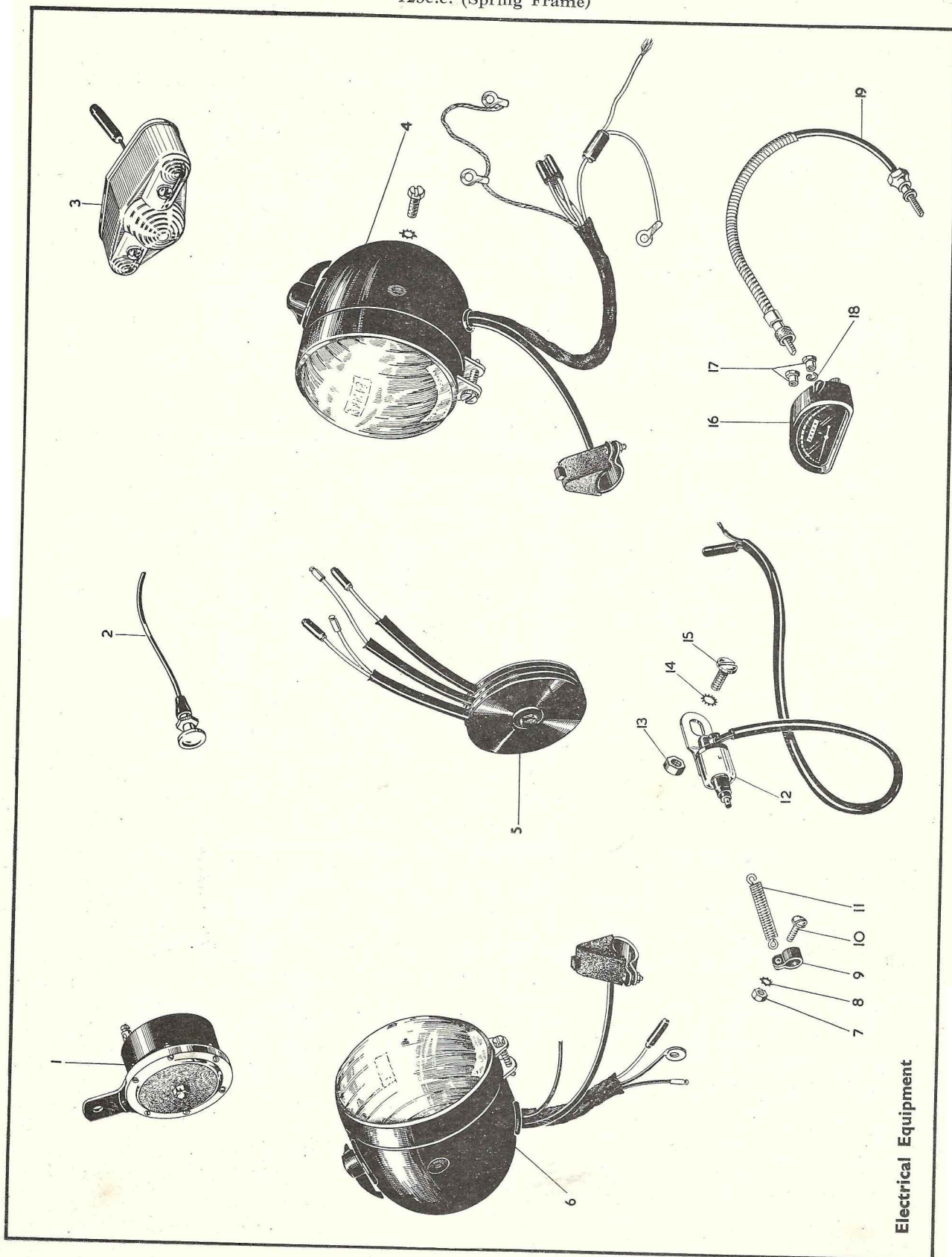

Electrical Equipment

STANDARD BOLTS. All Bolts are C.E.I. unless otherwise stated.

Part No.		Length under Head.		Thickness of Head.		Length of Thread.		Across Flats.		Diameter.
2-14	...	1:1/32"	...	3/16"	...	13/16"440" Hex.	...	1/4"
2-204	...	1/2"	...	3/16"	...	1/2"440 Hex.	...	1/4"
2-220	...	3/8"	...	3/16"	...	3/8"440" Hex.	...	1/4"
2-1354641"187"641"440" Hex.	...	1/4"
2-1402	...	7/8"	...	1/8"	...	3/8"440" Hex.	...	1/4"
2-2273	...	7/16"	...	5/32"	...	3/8"440" Hex.	...	1/4"
24-225750"187"	...	3/8"440" Hex.	...	1/4"
1-5069625"187"625"525" Hex.	...	5/16"
2-129750"250"625"440" Hex.	...	5/16"
2-1934750"156"625"440" Hex.	...	5/16"
2-6026	...	1.187"156"625"440" Hex.	...	5/16"
15-480	...	1.109"250"781"525" Hex.	...	5/16"
15-1355	...	1.500"218"625"525" Hex.	...	5/16"
15-7354625"156"625"440" Hex.	...	5/16"
27-6311750"125"625"440" Hex.	...	5/16"
28-2338718"218"687"525" Hex.	...	5/16"
24-649877"187"877"594" Hex.	...	3/8"
65-4185	...	2.687"250"750"504" Hex.	...	3/8"

All Bolts are C.E.I. (Screwdriver slotted) unless otherwise stated.

Part No.		Length under Head.		Thickness of Head.		Length of Thread.		Across Head.		Diameter.
1-4806500"125"500"312"	...	3/16"
3-360406"078"406"312"	...	3/16"
2-498312"062"312"312"	...	3/16" Whit.
2-1309343"062"343"312"	...	3/16"
2-2582343"125"343"250"	...	3/16" Whit.
24-7065250"062"250"312"	...	3/16"
2-77312"062"312"375"	...	1/4"
2-79500"109"500"375"	...	1/4"
2-510656"093"375"375"	...	1/4"
2-1500687"109"375"375"	...	1/4"
2-2210718"062"562"562"	...	1/4"
2-3718656"109"656"375"	...	1/4"
15-7161500"125"312"500"	...	1/4"
2-2980	...	1.25"93"625"562"	...	5/16"

STANDARD NUTS. All Nuts are C.E.I. unless otherwise stated.

Part No.		Across Flats.		Thickness.		Size.	Part No.		Across Flats.		Thickness.		Size.
1-4616340" Hex.162"	...	3/16"	2-1813594" Hex.218"	...	3/8"
2-47312" Hex.140"	...	3/16"	3-720594 Hex.187"	...	3/8"
2-1588255" Hex.110"	...	3/16"	24-5161594" Hex.343"	...	3/8"
15-8147340" Hex.125"	...	3/16"	24-5764782" Hex.312"	...	3/8"
25-7151340" Hex.187"	...	3/16"	2-440594" Hex.312"	...	7/16"
1-6032340" Hex.	...	3/16"	...	1/4"	2-933525" Hex.375"	...	7/16"
2-51440" Hex.250"	...	1/4"	2-1925782" Hex.375"	...	7/16"
2-53440" Hex.109"	...	1/4" Whit.	15-152592" Hex.406"	...	7/16"
2-443440" Hex.109"	...	1/4"	15-541782" Hex.281"	...	7/16"
2-1027340" Hex.	...	1/8"	...	1/4"	24-5860594" Hex.187"	...	7/16"
2-2395440" Hex.187"	...	1/4"	25-4325919" Hex.540"	...	7/16"
2-49525" Hex.218"	...	5/16"	2-52919" Hex.406"	...	1/2"
2-833440" Hex.343"	...	5/16"	2-124782" Hex.203"	...	1/2"
2-1616440" Hex.125"	...	5/16"	24-7000782" Hex.250"	...	1/2"
15-5196525" Hex.281"	...	5/16"	27-6716782" Hex.187"	...	1/2"
15-6524525" Hex.175"	...	5/16"	2-835919" Hex.375"	...	9/16"
24-563440" Hex.187"	...	5/16"	15-1455782" Hex.218"	...	9/16"
24-6040525" Hex.156"	...	5/16"	24-4255919" Hex.187"	...	9/16"
1-1706594" Hex.250"	...	3/8"	28-53782" Hex.344"	...	9/16"
2-46594" Hex.312"	...	3/8"							

STANDARD WASHERS (Plain).

Part No.	Outside Dia.	Inside Dia.	Thickness.	Part No.	Outside Dia.	Inside Dia.	Thickness
1-1804680"385"072"	2-2580500"275"064"
2-130687"380"080"	3-3525562"218"048"
2-370625"317"156"	15-39843"505"064"
2-525500"255"048"	15-431750"442"064"
2-861750"380"081"	15-5155525"328"048"
2-923625"317"062"	24-594937"505"092"
2-1096375"192"044"	24-7911875"380"156"
2-1291750"522"080"	25-7180	... 1.00"281"048"
2-1374656"255"080"	26-9461562"203"048"
2-1945875"442"064"	27-5676	... 1.00"380"092"
2-2138750"380"064"	27-8560625"255"048"

STANDARD WASHERS (Spring).

Part No.	Outer Dia.	Inside Dia.	Thickness.	Part No.	Outer Dia.	Inside Dia.	Thickness.
2-522750"390"056"	15-716937"453"064"
2-995656"380"040" double	24-978437"255"040"
2-1462593"255"040"	24-6035593"317"040" double
2-1967875"440"064"	27-6043750"437"046" double
2-2903562"406"062"	28-8784625"315"040"
3-110441"281"080"	35-33500"343"080"
3-111614"406"104"				

STANDARD WASHERS (Shakeproof).

Part No.	Outer Diameter.	Inside Diameter.	Part No.	Outer Diameter.	Inside Diameter.
29-541	... 1/2"	... 1/4"	36-399	... 11/16"	... 3/8"
29-3319	... 3/8"	... 3/16"	65-595	... 7/8"	... 1/2"
36-341	... 9/16"	... 5/16"	66-4707	... 11/16"	... 3/8"
36-382	... 9/16"	... 5/16"	66-4708	... 3/4"	... 7/16"

EVERY OWNER
OF A
B.S.A. MOTOR CYCLE
IS STRONGLY ADVISED
TO BUY ONLY



WHEN REPLACEMENTS
BECOME NECESSARY

