



BSA

SPARES

'B' GROUP

B31 Engine Nos. from GB31-101

B33 Engine Nos. from GB33-101

Frame Nos. from FB31-101

COPY OF B.S.A. MOTOR CYCLE SPARE PARTS GUARANTEE

We give the following guarantee with B.S.A. Motor Cycle Spare Parts, instead of the guarantee implied by statute or otherwise, as to the quality or fitness of such parts for the purpose for which they are intended, any such implied guarantee being in all cases excluded, nor can any claim for consequential damages be entertained.

WE GUARANTEE, subject to the conditions mentioned below, that all precautions which are usual and reasonable have been taken by us to secure excellence of materials and workmanship, but this guarantee is to extend and be in force for six months only from the date of purchase, and the damages for which we make ourselves responsible under this guarantee are limited to the replacement of any part which may have proved defective.

WE UNDERTAKE, subject to the conditions mentioned below, to make good at any time within six months any defects in these respects. As motor cycles are easily liable to derangement by neglect or misuse, this guarantee does not apply to defects caused by wear and tear, misuse, or neglect. The term "misuse" shall include among others the following acts: The attaching of a sidecar to the motor cycle in such a manner as to cause damage or calculated to render the latter unsafe when ridden; the use of a motor cycle or a motor cycle and sidecar combined when carrying more persons or a greater weight than they were designed to bear.

CONDITIONS OF GUARANTEE

We do not guarantee the specialities of other firms, such as tyres, electrical equipment, saddles, etc., or of any component part supplied to the order of the purchaser differing from our standard specification, whether supplied with our motor cycles or otherwise.

ALWAYS USE



CATALOGUE OF



ISSUED BY

BSA MOTOR CYCLES LTD.

Service Department
MONTGOMERY STREET
BIRMINGHAM 11

TELEPHONE . . . BIRMINGHAM, VICTORIA 2234 (6 lines)
TELEGRAMS "SELSERV," BIRMINGHAM

All communications relating to Spare Parts or Repairs to B.S.A. Motor Cycles
should be addressed to the above.

B.S.A. MOTOR CYCLES LTD.

Registered Offices and Works

Telephones: BIRMINGHAM VICTORIA 2381 (30 lines)

ARMOURY ROAD, BIRMINGHAM, 11

Telegrams and Cables: "SELMOTO, BIRMINGHAM"

Contractors to Her Majesty's Government, the War Office, the Admiralty, the Post Office, the Colonial and Foreign Governments

Copyright B.S.A. Co. Ltd.

Printed in England.

Stockists

Distributors

Engine

Gearbox

Clutch and
Front
Chaincase

Frame and
Fittings

Rear
Suspension
and
Central Stand

Front
and

Mudguard
Oil Tank
Silencer
Tools

Ex
H
nd

Legshield
Frog
Safety

Front and
Safety
Carrier
Hand

Electric
Equipment

'B' GROUP GENERAL INDEX

	Pages
Air Cleaners ...	24
Battery Carrier ...	24
Carburettors and Settings ...	46
Carrier ...	45
Central Stand ...	26
Chainguard and Chaincase (rear) ...	38
Clutch and Front Chaincase ...	21-23
Colour Finishes ...	3
Dual Seat and Fittings ...	36
Engine (General) ...	13-18
Equipment (Electrical) ...	3, 46
Equipment (Speedometers) ...	3
Exhaust Pipes ...	13
Footrests ...	26
Frame and Fittings ...	23-26
Front Fork and Fittings ...	28
Front Hub and Wheel Fittings ...	30
Front Stand ...	33
Gearbox and Control Parts ...	18-21
Handlebars and Controls ...	36
Handrail ...	44
Legshields ...	40
Legshields and Safety Bars ...	42
Mudguards and Fittings (Front) ...	33-35
Mudguards and Fittings (Rear) ...	33-35
Oil Tank and Fittings ...	33-35
Overseas Distributors ...	9-12
Petrol Tank and Fittings ...	36
Pillion Footrests ...	24
Pistons ...	15, 30
Prop Stand ...	24, 26
Rear Brake Control ...	38
Rear Hub and Wheel Fittings ...	30-32
Rear Suspension ...	26
Safety Bars (Front) ...	44
Safety Bars (Rear) ...	44
Silencer and Fittings ...	33-35
Standard Bolts ...	32
Standard Bolts (Screwdriver Slotted) ...	35
Standard Nuts ...	38
Standard Washers (Plain) ...	40
Standard Washers (Spring) ...	42
Standard Washers (Shakeproof) ...	44
Stockists ...	4-8
Toolbox and Fittings ...	33-35
Tools and Sundries ...	48

SUFFIX NUMBERS TO BE USED TO IDENTIFY VARYING FINISHES

/001	Cadmium
/003	Bright Chrome
/007	Black Enamel
/017	Chrome Plate, Black Lined Gold
/019	Chrome Plate, Matt Silver Lined Red
/021	Polished Aluminium
/024	Polychromatic Silver Beige
/026	Chrome Plate and Silver Beige Lined Red
/036	Maroon and Chrome Lined Gold
/037	Maroon only
/038	Metallic Green and Chrome Plate Lined Dark Green
/039	Metallic Green
/040	Dark Green
/041	Chrome Rim and Maroon Hub
/042	Chrome Rim and Dark Green Hub
/043	Chrome Rim and Beige Hub
/044	Chrome Rim and Black Hub
/078	Brilliant Red and Chrome
/100	Almond Green
/101	Gunmetal Grey
/102	Princess Grey

When ordering components with varying finishes, i.e., Petrol Tanks, Wheels, Rims, Brake Rods, Front Fork Oil Seal Holder — please state finish required by adding the appropriate suffix number to part number.

EXAMPLE. Petrol Tank

Metallic Green and Chrome Plate Lined Dark Green — 67-8104/038

SPARKING PLUGS

Champion Sparking Plugs Ltd., Feltham, Middlesex

ELECTRICAL EQUIPMENT

J. Lucas Ltd., Great King Street, Birmingham

SPEEDOMETERS

Smith's Motor Accessories, Cricklewood Works, London

LIST OF B.S.A. STOCKISTS

Save time and postage by contacting your nearest B.S.A. Stockist for B.S.A. Spare Parts, Spare Part Catalogues, Instruction Books, Transfers, etc. All B.S.A. Dealers carry stocks of B.S.A. Spare Parts but the following appointed Stockists maintain a comprehensive range.

Town.	Name of Stockist.	Address.	Telephone No.	Telegraphic Address.
Aberdeen	J. Dawson	24-26 Thistle Street	25556	
"	George Cheyne (Cycles) Ltd.	147-149 Holburn Street	26027	Motobike, Aberdeen.
Aberystwyth	Gwalia Motor Co.	North Parade	525	
Accrington	Bill Snape Ltd.	379 Blackburn Road	4724	
Aldershot	Phillips Bros. (Aldershot) Ltd.	Birchett Road	1111-2	Phillips, Cycles, Aldershot.
Alloa	J. G. Robertson	55-57 High Street	193	
Andover	Corbett & Ellis (Andover) Ltd.	Weyhill Road	2991	
Ashington	Mains of Ashington...	Laburnam Terrace	3204	
Aylesbury	Eborn's Garage	44 Walton Street, Aylesbury	150	Eborn's, Aylesbury.
Banbury	Trinder Bros.	2 and 3 Broad Street	2546	
Barnsley	T. Garner & Son	Sheffield Road	2866	
Barnstaple, North Devon	Bob Ray Ltd.	43 High Street	4266	
Bath	R. U. Holoway and Son	32, 33, 34 St. Johns Road	Bathwick 5084	
Bedford	The Imperial Cycle Co.	58 St. Loyes	2374	
Belfast	W. J. Chambers & Co.	106 and 108 Donegall Pass	27253-4	Fastmote, Belfast.
Biggleswade	Bryants	25, 27, 72 and 74 Shortmead Street	3108	
Birkenhead	Bob Simister Ltd.	540 New Chester Road, Rock Ferry	Rock Ferry 1452	
Birmingham	County Cycle & Motor Co. Ltd.	266 Broad Street 104 Bath Row (Repairs) (closed Saturday 1 p.m.)	Midland 2671 Midland 2817	
"	C. E. Cope & Sons Ltd.	481-487 Hagley Road, Edgbaston 17	Bearwood 2246-7	
"	Shovelbottom's Ltd.	376 Ladypool Road, Sparkbrook 12	South 2212	
"	Aston Auto Motors	172 Aston Road, 6	Aston Cross 3201-2	
Blackburn	Shuttleworth & Geldart	15-17 Great Bolton Street	6678	
Blackpool	J. Hall & Son	102-6 Devonshire Road (opp. School)	22130	
Blandford	Badger Garages Ltd.	Salisbury Road	615	
Bolton	Charlie Robinson	119 and 121 Higher Bridge Street	3931	
Boscombe	Craze Bros.	473 and 475 Christchurch Road	Boscombe 33231/2	
Bradford	C. Sidney Ltd.	107 Manningham Lane	29889	
"	J. K. Hirst	41 Wakefield Road	22543	
Bridgwater	Anderson & Wall	18 St. Mary Street	2416	Anderson & Wall, Bridgwater.
Brighton	Redhill Motors (Brighton) Ltd.	104 North Road	5281	
Bristol	S. J. Fair Motors Ltd.	201-3 Cheltenham Road	46238	
Bromsgrove	Harold Tozer (Bromsgrove) Ltd.	110 Birmingham Road	3228	
Brynmawr	Jayne's Motors	Cwmbach Garage	Brynmawr 271	
Bury St Edmunds.	Barclay Motors	Kings Road Corner	2345/9	
Cambridge	King & Harper Ltd.	Milton Road Corner	55201	Motors, Cambridge.
Canterbury	Marcel Hallet	St. Dunstan's Street	2275/6	
Cardiff	Car Distributors (Cardiff) Ltd.	134-140 City Road	30022	
"	Robert Bevan & Son	29-35 Castle Street	1808	
Carlisle	W. T. Tiffin & Son	Irishgate Brow	25024	Tiffin, Irishgate, Carlisle.
Carmarthen	Eddie Stephens (Motors)	22/23 Water Street	C'then 233	
Castleford	Barrett's Motor Cycles (Castleford) Ltd.	27-35 Aire Street	2983	
Chapel-en-le-Frith	E. W. Bowers	129 Town End	144	

Town.	Name of Stockist.	Address.	Telephone No.	Telegraphic Address.
Chatham	Grays of Chatham Ltd.	11-19 High Street	4005	
Chelmsford	Hadlers Garage Ltd.	New Street	4844-5	Hadler, Chelmsford.
Cheltenham	Leslie Paynter	Bath Street	2887	
Chester	Davies Bros.	34 Bridge Street	510	
Chichester	W. Goodridge & Co. Ltd.	East Street	2033	
Clydebank	Weddell & Devine	72-114 Dumbarton Road	Clydebank 1429	
Colchester	G.B.R. Motors Ltd.	1-2 East Hill	6131/2	
Colne	C. H. Schofield (Motors) Ltd.	Market Place	859	
Coventry	Coventry Motor Mart Ltd.	86 London Road	2146-7	Coventry Motor Mart.
Crewe	Cooke's Garages (Crewe) Ltd.	10-20 Nantwich Road	2011	Cooke's Motors, Crewe.
Croydon	Godfreys Ltd.	228-234 London Road	Croydon 3641-2	Gofrabike, Croydon.
Dagenham	Reginald Smith	Imperial House, New Road	Rainham 3284-2786	
Dalton-in-Furness	H. Holme	24-26 Ulverston Road	25	
Darlington	The Duplex Motor and Cycle Co. Ltd.	10-16 Grange Road	Darlington 2071	Duplex, Darlington.
"	White Bros.	201/205-9 Northgate	67757	
Dartford, Kent	Schweizo Bros.	177 Lowfield Street	Dartford 4279	
Derby	Ingles Provincial Garages Ltd.	Walbrook Road	45289	
Doncaster	W. Cusworth (Doncaster) Ltd.	7 Hall Gate	4594	
Douglas (I.O.M.)	Gilbert Harding	18 Duke Street	Douglas 170	
Dudley	Chas. E. Cope & Sons Ltd.	193 High Street	Dudley 3464-5-6	
Dundee	George McLean Ltd.	Ward Road, Riverside Drive	5087	Vehicles, Dundee.
Dunstable	B. C. England (Dunstable) Ltd.	Halfmoon Hill, London Road	843-4	
Eastbourne	Jempsons	118 Seaside	756	Jempsons, Eastbourne.
Edinburgh	J. R. Alexander & Co. Ltd.	10-14 Lothian Road	4455	Motorcycles, Edinburgh.
Elgin	Farquharsons	55-57 High Street	7188	Elgin 7188.
Enfield	D. J. Shepherd & Co. (Enfield) Ltd.	434-6 Hertford Road, Enfield Highway	Howard 1631	
Exeter	P. Pike & Co. Ltd.	Alphington Street	58241	Piko, Exeter.
Frome	J. Difazio	25 Catherine Street	2913	
Gateshead, 8	O. Carmichael & Son	75, 83 and 87 High Street West	71815	
Glasgow, C3	Bell Bros. (H.P.) Ltd.	215-233 St. George Road	Douglas 6414	Douglas 6414 Glasgow.
" C4	J. R. Alexander & Co. Ltd.	264-280 Great Western Road	Douglas 3802-3-4	Alex Moto, Glasgow.
Gloucester	Harpers Garage	23a Worcester Street	23187	Gloucester 23187.
Grimsby	H. J. Gresswell and Sons Ltd.	13-15 Osborne Street	2202	
Guernsey	Millard & Co. Ltd.	Victoria Road	777	Millard Motors, Guernsey.
Guildford	E. Pascall (Guildford) Ltd.	11-12 Woodbridge Road	Guildford 2274-5-6	
Harrogate	H. Aclam (Prop. H. Baynes)	11 Bower Road	5125	
Harrow	E. T. Pink (Harrow) Ltd.	Station Road	0044-5	Pink, Harrow.
Hatfield	W. Waters & Sons Ltd.	32 Great North Road	Spares 3328 3255	
Hereford	A. Kear & Co.	52b Commercial Street	2239	Kear, Hereford.
Holbeach	G. Woodman Ltd.	34 Fleet Street	3221	
Hornchurch	T. W. Kirby	10 Roneo Corner	8785	
Hounslow	Stanleys Motors	46-8 Lampton Road	Hounslow 1949	

Distributors

Engine

Gearbox

Clutch and Front Chaincase

Frame and Fittings

Rear Suspension and Central Stand

Front and

Mudguards, Oil Tank, Silencers, Tools

Lamps and

Lamps, Front Safety, Horns

Front and Rear Lamps, Horns, Tools

Electric Equipment, Lights

Town.	Name of Stockist.	Address.	Telephone No.	Telegraphic Address.
Huddersfield ...	Earnshaw ...	Manchester Road ...	1232	
Hull ...	Browns (Witham) Ltd. ...	47-49 Witham ...	33990-9	
" ...	Jordan & Co. (Hull) Ltd. ...	Storey Street ...	36809	Gumpton, Hull.
Ilford ...	J. J. Double ...	14 Mildmay Parade, Cranbrook Road ...	Valentine 3109	
Ilkeston ...	Ray Gamble ...	Pelham Street (off Bath Street) ...	873	
Ipswich ...	Revetts Ltd. ...	Clarkson Street ...	2822	
Jersey ...	Colebrooks (J. D. Poingdestre) ...	1 New Street ...	Central 642	Colebrooks, Jersey.
Keighley ...	Dick Ratcliffe ...	Coldshaw Garage, Haworth ...	Haworth 3133	
Kendal ...	Tom O'Loughlin ...	66 Stricklandgate ...	315	
Kirkcaldy ...	County Motors (Kirkcaldy) Ltd. ...	Junction Road ...	Dysart 5631	
Lancaster ...	Pye Motors Ltd. ...	Parliament Street ...	828	
Launceston ...	J. Wooldridge & Son ...	Western Road ...	21	Wooldridge, Launceston.
Leeds, 1 ...	Watson-Cairns & Co. Ltd. ...	157-8 Lower Briggate ...	23379	Watson-Cairns, Briggate, Leeds.
Leicester ...	E. W. Campion & Son Ltd. ...	Welford Place ...	58054	
Lincoln ...	West (Lincoln) Ltd. ...	116 High Street ...	10762-3-4	
Liverpool, 7 ...	Bee Cycle & Motor Co. Ltd. ...	17-19 Renshaw Street ...	Royal 6375-6	Bee Cycles, Liverpool.
Liverpool, 3 ...	Cundles (Liverpool) Ltd. ...	41 and 61 Byrom Street ...	Central 4148	Cundles, Central 4148.
Llawhaden ...	James Bowen & Sons ...	Llawhaden, near Narberth, Pem. ...	Llawhaden 6	
London, W.1 ...	Godfreys Ltd. ...	208 Great Portland Street ...	Euston 4632-4	Gofrabike, London.
" N.W.1 ...	J. Grose Ltd. ...	379-381 Euston Road ...	Euston 5231	
" S.E.18 ...	Cleare & Co. Ltd. ...	1 and 125 High Street ...	Woolwich 0174	
" W.5 ...	Kays of Ealing Ltd. ...	8-10 Bond Street ...	Ealing 2387	Sparesokay, Ealux, London.
" S.E.13 ...	F. Parks & Son Ltd. ...	404 Lewisham High Street ...	Lee Green 0535	
" E.8 ...	Eleanor Motors ...	265-7-9 Mare Street ...	Amherst 5134	
" E.7 ...	Godfreys Ltd. ...	418 Romford Road, Forest Gate ...	Grangewood 1234	Gofrabike, Forgate.
" E.6 ...	Godfreys Ltd. ...	220 Barking Road, East Ham ...	Grangewood 8088	Gofrabike, Forgate.
" N.12 ...	George Grose Ltd. ...	834 High Road, Finchley ...	Hillside 2149	
" N.12 ...	Glanfield Lawrence Ltd. ...	Junction Great North Road and North Circular Road ...	Finchley 0091	Glanfin, Norphone, London.
" N.15 ...	Godfreys Ltd. ...	94 and 96 High Road, Sth Tottenham ...	STA 9960	Gofrabike, London.
" S.E.11 ...	Writers Ltd. ...	161-5 Kennington Lane ...	Reliance 1362	
" S.W.11 ...	Owen Bros. ...	19 Battersea Rise, Clapham Junction ...	Battersea 7816-7	
" S.W.6 ...	Claude Rye Ltd. ...	897-921 Fulham Road, Fulham ...	Renown 6174	Ryebikes, Walgreen, London.
" S.W.9 ...	Pride & Clarke Ltd. ...	Stockwell Road ...	Brixton 6251	
" W.12 ...	Turners Stores ...	81-83 Goldhawk Road, Shepherd's Bush ...	Shepherd's Bush 2436	
" W.3 ...	Whitbys of Acton Ltd. ...	273 The Vale, Acton ...	Shepherd's Bush 5355-6	
" S.E.15 ...	West End Motors Ltd. ...	171 High Street, Peckham ...	Newcross 2589	
" N.W.10 ...	Slocombe Ltd. ...	269 Neasden Lane, Neasden ...	Gladstone 2088 & 0508	
" S.W.17 ...	Elite Motors (Tooting Ltd.) ...	951-961 Garrat Lane, Tooting Broadway ...	Balham 1200	
Lowestoft ...	R. Wright ...	67-69 London Road South ...	645	
Macclesfield ...	A. Watling ...	49 Buxton Road ...	3592	
Maidstone ...	Redhill Motors (Maidstone) Ltd. ...	The Broadway ...	3096	

Town.	Name of Stockist.	Address.	Telephone No.	Telegraphic Address.
Manchester, 3	Tom Davies (Motors) Ltd.	233 Deansgate	Blackfriars 0681	
" 22	Alex Parker	31/33 Palatine Road Northenden	Wythenshaw 2062	
"	Fred Fearnley Ltd.	692-4 Ashton Old Road	East 1445-6	Fernbike, Manchester.
Mansfield	Henstocks	128 Chesterfield Road	329	Henstock 329 Mansfield
Middlesbrough	J. T. Dickinson (Middlesbrough) Ltd.	160-162 Lindthorpe Road	3861	Payacob, Middlesbrough.
Neath	Fred Rist	16 Windsor Road	Neath 780	
Newcastle-on-Tyne	Dene (Newcastle) Motor Co. Ltd.	Haymarket	2-9165	Ened, Newcastle-on-Tyne.
Newton Abbot	J. E. Green & Co.	87 Queen Street	653	
Newport (Mon.)	R. J. Ware & Sons	69 Commercial Street	66206	
Norwich	Chapmans (Norwich) Ltd.	38-42 Duke Street	24727	
Nottingham	E. W. Campion & Son Ltd.	Arkwright Street and Queens Road	83444	
Oswestry	Roy Evans	Willow Street	1144-5	
Oxford	H. F. Temple	69 High Street, St. Thomas	2485	
"	Messrs. Faulkner & Son	12 Cardigan Street	57279	
"	John Avery	228/230 Banbury Road	59353	
Parkstone	Bob Foster	472-4 Ashley Road	68	
Perth	M. Shaw & Sons	143 High Street	483	
Peterborough	Burrows Bros.	55-57 Westgate	2154	
Plymouth	P. Pike & Co. Ltd.	Millbay Road	Plymouth 63018	Piko, Plymouth.
Pontardulais	T. Griffiths	Forest Garage	Pontardulais 323	
Portsmouth	Jenkins & Purser Ltd.	277-281 Copnor Road	2339	
"	Glanfield Lawrence	147-157 Fratton Road	74331	
Preston	Loxhams Garages Ltd.	Central Garage, Charnley St., Fishergate	Sales Dept. 4242 Service Dept. 4243	Loxhams, Preston.
Pulborough	Gray & Rowsell	Bury Gate	Bury 4	
Radcliffe	Will Lord	115 Blackburn Street	2002	
Reading	Phillips & Bloomfield Motors Ltd.	10-24 South Street	2635	
"	Stocker & Shepherd Ltd.	131 Oxford Road and Weylen Street	3938	
Redhill	The Redhill Motor and Cycle Works Ltd.	50-54 Brighton Road	327	
Rotherham	Ernest Cross	55-59 Drummond Street	Rotherham 3987	
Salisbury	Pankhurst (Weymouth) Ltd.	78 Exeter Street	Salisbury 5222-3	
Scarborough	E. Andrew	Roscoe Street	Scarborough 1857	
Sevenoaks	Angus Motor Cycles	Station Parade	3338	
Sheffield, 1	Walter Wragg Ltd.	Stanley Works, Wellington Street	26098	26098 Sheffield.
Shrewsbury	J. R. Meredith	Coleham Head	6529	
Sittingbourne	Scoones Garage	9 West Street	66	Scoones, Sittingbourne.
Slough	Sid Moram	Wexham Corner, High Street	Slough 23767	
Southampton	Alec Bennett Ltd.	152 Portswood Road	54081-2-3	
Southport	H. F. Brockbank	62 King Street	5054	
Southsea	Percy Kiln	65 Elm Grove	Portsmouth 4793	
St. Helens	Geoff. Duke Ltd.	Greenfield Road Garage	3918	
St. Ives	Hallens (Hunts.) Ltd.	The Broadway	St. Ives 3071	Hallens, St. Ives.
Stockport	Theobald & Coppack	6 Chestergate	2843	Theobald Coppack, Stockport.
Stoke-on-Trent	J. & N. Bassett	Howards Place, Shelton	2890	

Distributors

Engine

Gearbox

Clutch and
Front
ChaincaseFrame and
FittingsRear
Suspension
and
Central ShaftFront
and
RearMudguards
Oil Tank
Silencer
and
ExhaustLegshield
Front
SafetyFront and
Rear
Safety
Carriage
Landing
GearElectric
Equipment

Town.	Name of Stockist.	Address.	Telephone No.	Telegraphic Address.
Stourbridge ...	Pearsons Cycle Depot ...	31 Market Street ...	5677	
Sunderland ...	Dunns Garage (Sunderland) Ltd. ...	Wheatsheaf Corner, North Bridge Street	57666	
Swansea ...	Handel Davies Ltd. ...	230 Oxford Street ...	2956	
Swindon ...	Easters Garage ...	5-8 Manchester Road ...	2788	
Taunton ...	W. P. Edwards (Motors) Ltd. ...	Station Road ...	2943	Edwards, Motor Cycles, Taunton.
Thames Ditton ...	Comerfords Ltd. ...	Oxford House, Portsmouth Road	Emberbrook 5531	
Torquay ...	P. H. Sharam Ltd. ...	244-6 Union Street ...	4184 and 7255	
Troon ...	Cooper Bros. ...	125-129 Templehill ...	925	
Truro ...	W. H. Collins ...	Kenwyn Mews ...	Truro 2168	
Tunbridge Wells ...	G. E. Tunbridge ...	21 London Road ...	416	Motors, Tunbridge Wells.
Twickenham ...	C. A. Blay ...	192-9 Heath Road ...	Popesgrove 2103 & 1435	
Uxbridge ...	J. H. Miles Ltd. ...	60 High Street ...	Uxbridge 125	
Wakefield ...	Parkinsons (Wakefield) Ltd. ...	38-40 Ings Road ...	2087	
Walsall ...	The Motor Cycle Mart (Walsall) Ltd. ...	12 Ablewell Street ...	3363	
Warrington ...	Jack Frodsham Ltd. ...	37a Winnick Street ...	471	
Watford ...	Lloyd Cooper & Co. ...	61 Queen's Road ...	2125	Lloyd Cooper, Watford.
Westcliff-on-Sea ...	J. Costin & Sons ...	233-5-7 London Road ...	Southend 2215	
Weston-super-Mare ...	Wyverns of Weston Ltd. ...	3 Locking Road ...	524	Wyverns, Weston-super-Mare.
Weybridge ...	W. L. Lewis & Sons ...	51 Church Street ...	2210	
Weymouth ...	Tilleys ...	9 Frederick Place ...	72	
Whitehaven, Cumberland ...	Mark Taylor ...	21 King's Street ...	252	
Wolverhampton ...	C. E. Cope & Sons Ltd. ...	168-9 Stafford Street ...	24605-6	
Worcester ...	W. J. Bladder & Son ...	52 Sidbury ...	2438	Bladder, Sidbury, Worcester.
Worksop ...	Ezra Sugden Ltd. ...	109 Gateford Road ...	3053	
Worthing ...	Gray & Rowsell ...	56 Broadwater Street West ...	1224	
Yeovil ...	The Yeovil Motor Mart ...	Hendford ...	267	Motor Mart, Yeovil.
York ...	C. S. Russell (York) Ltd. ...	Lawrence Street ...	3793	Russell, Lawrence Street, York.

B.S.A. OVERSEAS DISTRIBUTORS

ADEN	...	Arabian Trading Co., Maalla Garage, Aden.
AFGHANISTAN	...	Levetus Ltd., 194, Bishopsgate, London, E.C.2.
ALASKA	...	Hap Alzina, 3074, Broadway, Oakland 11, California, U.S.A.
ALGERIA	...	Movea, 79, Ave. de la Grande Armee, Paris XVI, France, operating through: Societe Algerienne de Distribution d' Equipements Britanniques, 1, rue d' Assus Alger, Algiers.
ARGENTINA	...	Ditlevsen & Cia Ltda., Av. Ingeniero Huergo 1335, Buenos Aires.
AUSTRALIA		
South Australia	...	J. N. Taylor & Co., 121/5, Grenfell St., Adelaide.
Victoria	...	Finlay Bros. (Pty) Ltd., 316/20, Elizabeth St., Melbourne C.1.
West Australia	...	Mortlock Bros., 914, Hay Street, Perth.
N.S.W. and Queensland	...	Bennett & Wood Ltd., Cor. Bathurst and Pitt Sts., Sydney and 128, Wickham St., Valley, Brisbane.
Tasmania	...	Sim King (Pty) Ltd. (Box A. 240 G.P.O.), 63, Brisbane Street, Launceston.
AUSTRIA	...	Maximillian Koeniger Stubenring 20, Vienna 1.
AZORES	...	Hayes & Travell Ltd., P.O. Box 56, Ponta Delgada, St. Michael's.
BAHAMAS	...	Nassau Bicycle Co., P.O. Box 191, Nassau.
BAHREIN	...	United Commercial Agencies, P.O. Box 166, Bahrain Islands, Persian Gulf.
BELGIAN CONGO.		
Albertville	...	La Sima S.C.R.L., P.O. Box 671, Elizabethville.
Bukavu	...	Touriel Motors, P.O. Box 796, Bukavu.
Coquilhatville	...	Ets. Fr. Mechant et Fils, P.O. Box 786, Leopoldville.
Elizabethville	...	La Sima, Boite Postale 671, Elizabethville.
Leopoldville	...	Ets. Fr. Mechant et Fils, P.O. Box 786, Leopoldville.
Usumbura	...	Capelluto Touriel & Co., P.O. Box 501, Usumbura, Ruanda Urundi.
Stanleyville	...	Nassers Trading Co. Ltd., P.O. Box 71.
BELGIUM	...	Ets. Moorkens S.A., 571, Grande Chaussée, Berchem, Antwerp.
BERMUDA	...	Holmes, Williams & Purvey, Ltd., P.O. Box 444, Pembroke.
BOLIVIA	...	Balfour Williamson Merchant Shippers Limited, 7, Gracechurch St., London, E.C.3, operating through: Gibbs Williamson (Bolivia) Ltda., Casilla 957, La Paz.
BORNEO.		
Br. N. Borneo	...	Harrisons & Crosfield (Borneo) Ltd., Import Dept., Jesselton.
Sarawak	...	The Borneo Co. Ltd. (P.O. Box 141), Thomson Road, Kuching.
BOUGAINVILLE	...	Bennett & Wood Ltd., Corner Pitt and Bathurst Streets, Sydney, N.S.W., Australia.
BRAZIL	...	Mesbla S.A., Rua de Passeio 48/54, Rio de Janeiro.
and branches at	...	Sao Paulo (Est. de Sao Paulo)—Rua 24 de Maio, 141.

BRAZIL	...	Porto Alegre (R.G. do Sul)—Rua Voluntarios de Patria 524. Belo Horizonte (Minas Gerais)—Rua Curitiba, 444-464. Recife (Pernambuco)—Rua da Palma 251. Pelotas (R.G. do Sul)—Praca Cel. P. Osorio, 152-154. Niteroi (Est. do Rio)—Rua Visconde Rio Branco 521-523. Marilia (Sao Paulo)—Rua 9 de Julho 1001. Victoria (Espirato Santo)—Av. Victoria 719-727. Salvador (Bahia)—Av. Frederico Pontes, 102-104.
--------	-----	--

BRITISH E. AFRICA.

Kenya	...	Uganda Co. (Africa) Ltd., P.O. Box 1, Kampala, Uganda.
Tanganyika	...	International Motor Mart Ltd., P.O. Box 409, Dar-es-Salaam.
Uganda	...	The Uganda Co. (Africa) Ltd., P.O. Box 1, Kampala.
Zanzibar	...	Musa Jusabani, P.O. Box 366, Zanzibar.

BRITISH GUIANA	Bookers Stores Ltd., 49/53, Water St., Georgetown.
----------------	--

BRITISH HONDURAS

Santiago Castillo, Box 69, Belize.

BRITISH SOMALILAND

Arabian Trading Co., Berbera.

BRITISH W. AFRICA.

Gambia	...	Cie. F.A.O., Bathurst.
Ghana	...	Cie. F.A.O., P.O. Box 70, Accra.
Nigeria	...	Cie. F.A.O., P.O. Box 160, Lagos.
Sierra Leone	...	Cie. F.A.O., Freetown.

(and other branches throughout territory)

BRITISH W. INDIES

Antigua	...	Stephen R. Mendes Ltd., Colonial House, 18, Thames St., St. John's.
Leeward Is.	...	Redman & Taylors Garage Ltd., P.O. Box 269, Church Street, Bridgetown.
Barbados	...	A. C. Shillingford & Co., P.O. Box 123, The Garage, Roseau.
Dominica	...	Glean's Garage, St. Patricks.
Leeward Is.	...	B.S.A. Agency Ltd., 9, King Street, Kingston.
Grenada	...	J. W. Thurston & Co. Ltd., Fort St., Basseterre.
Windward Is.	...	Peter & Co., Castries.
Jamaica	...	M. S. Osborne, Trescellian House.
St. Kitts	...	J. W. Thurston & Co. Ltd., Fort St., Basseterre, St. Kitts.
Leeward Is.	...	Corea & Co. Ltd., Kingston, St. Vincent.
St. Lucia	...	Sports & Games Ltd. (P.O. Box 271), 28, Henry Street, Port of Spain.
Windward Is.	...	
Trinidad	...	

BURMA	...	Levetus Limited, 194, Bishopsgate, London, E.C.2, operating through: Fairweather Richards & Co. Ltd., 67/69, Lewis St., Rangoon.
-------	-----	---

CANADA.

British Columbia and Alberta	...	Fred Deeley Ltd., 606, E. Broadway Ave., Vancouver.
Newfoundland	...	Edwin Murray Ltd., 256, Water Street, St. John's.
Nova Scotia	...	Mr. L. C. Comeau, Comeauville, Nova Scotia.

Distributors

Engine

Gearbox

Clutch and Front Chaincase

Frame and Fittings

Rear Suspension and Central Stand

Front Fork and Wheel

Modular Oil Tank, Silencer and Tooling

Pe H

Legshield, Front Safety

Front and Safety, Carrier, Handle

Electric Equipment, Tools

CANADA.
 Ontario ... Brown's Sports & Cycle Co. Ltd., 517, Yonge St., Toronto.
 Quebec ... Arlington Cycle & Sports Ltd., 1194, University St., Montreal.
 Saskatchewan and Manitoba ... Nicholson Bros., 245, Second Ave. North, Saskatoon.
CANARY ISLANDS J. Gonzalez Suarez (Apartado, No.9), Puerto de la Luz, Las Palmas.
CEYLON ... Cargills (Ceylon) Ltd., Fort, Colombo. P.O. Box 23.
CHILE ... Balfour Williamson Merchant Shippers Limited, 7, Gracechurch St., London, E.C.3, operating through: Williamson Balfour & Co. S.A., Santiago.
COOK ISLANDS ... United Island Traders Ltd. (W. H. Watson), Raratonga.
COLOMBIA ... Balfour Williamson Merchant Shippers Limited, 7, Gracechurch St., London, E.C.3, operating through: Tracey & Co. S.A., Apartado 1196, Bogota.
COSTA RICA ... Tiberio Paganella, Ciclo Sport La Casa del Ciclista, Apartado 2321, San Jose.
CUBA ... Distribudora de Motocicletas Britanicas, S.A. Padre Varela, Havana, Cuba, P.O. Box 962.
CYPRUS ... St. G. Collocassides Ltd., 1-3 Heraclius Ave., Box 91, Nicosia, Cyprus.
CYRENAICA ... Metcalfe Eng. Co. Ltd., P.O. Box 216, Benghazi.
DENMARK ... B.S.A. Motors & Cycles (H. V. Hansen), Gl, Kongevej 127-131, Copenhagen, V.
DOMINICAN REPUBLIC General Sales Co., Apartado 746 Ciudad Trujillo, R.D.
DUTCH GUIANA ... The New Motor Supply & Importing Co. (P.O. Box 422), Watermolen St., Paramaribo.
ECUADOR ... Balfour Williamson Merchant Shippers Limited, 7, Gracechurch St., London, E.C.3, operating through: Sociedad Anonima Comercial, Anglo-Ecuatoriana, Apartado 410, Guayaquil.
EGYPT ... T. W. M. Forsyth, 7 Sharia Maspero, Cairo.
ERITREA ... Arabian Trading Co. Ltd., Viale Blattenchieta Lorenzo Tazaz, 29-33, Asmara.
ETHIOPIA ... Arabian Trading Co. (P.O. Box 23), 155, Cunningham Street, Addis Ababa.
FALKLAND ISLANDS The Falkland Island Co. Ltd., Port Stanley.
 McAtasney & Sedgwick, Falkland Store, Stanley.
FAROE ISLANDS Charles Smith, Trondargota 35, Thorshann, Faroe Islands.
FIJI ... Morris Hedstrom Ltd., Suva.
FINLAND ... S. & N. Osakeyhtio, N. Esplanade 19, Helsinki.
FRANCE ... Movea S.A., 79, Ave. de la Grande Armée, Paris XVIe.
FR. ANTILLES
 Guadeloupe ... Maison F. D'Alexis 44, Rue Frebault, Pointe-à-Pitre.

FRENCH EQ. AFRICA

The United Africa Co., Unilever House, Blackfriars, E.C.4.

FRENCH INDIA ... Levetus Ltd., 194, Bishopsgate, London, E.C.2.

FRENCH SOMALILAND

Arabian Trading Co., Djibouti.

FRENCH W. AFRICA

Dahomey ... Cie. F.A.O., Service Autos, Cotonou.

French Camerouns ... Cie. F.A.O., Duala.

Ivory Coast ... Cie. F.A.O., Abidjan.

Mauritania ... The United Africa Co., Unilever House, Blackfriars, E.C.4., operating through: Compagnie Du Niger Français, Boite Postale No. 230, Saint-Louis, Senegal.

French Guinea ... Cie. du Niger Français, Conakry.

French Sudan ... Cie. du Niger Français, Bamako.

Senegal ... Nouvelle Societé Commerciale Africaine, 31 Boulevard Pinet-Laprade, Dakar.

GERMANY (West) ... Messrs. Alan W. A. Bruce, P.O. Box 123, Cologne, 17.

GIBRALTAR ... English Garage Ltd., Queensway, Gibraltar.

GILBERT and ELLICE ISLANDS

Morris Hedstrom Ltd., Apia, Samoa.

GREECE ... D. F. Papoutsas, 56, Chalcocondillias St., Athens.

GUADELOUPE ... Maison F. D'Alexis, 44, Rue Frebault, Pointe-à-Pitre.

GUATEMALA ... H. J. Nicol & Co. S.C., 8A Avenida Sur No. 109, Guatemala City.

HADRAMUT ... Arabian Trading Co., Esplanade, Aden.

HAITI ... Yves Bajoux, Grande Rue 185, (P.O. Box 856), Port-au-Prince.

HAWAII ISLANDS Schubert's Cyclery Stores (P.O. Box 3443), Cor. Archer and South King Sts., Honolulu, Hawaii.

HONDURAS ... M. Liebers, Apartado 51, Tegucigalpa, D.C.

HONG KONG ... Levetus Limited, 194, Bishopsgate, London, E.C.2, operating through: British Bicycle Co., 16, Hennessy Road.

ICELAND ... Falkinn Ltd., P.O. Box 997, Reykjavik.

INDIA ... Levetus Limited, 194, Bishopsgate, London, E.C.2, and branches in Delhi, Bombay and Calcutta, operating through:

Bombay ... Noble Cycle & Motor Co., 225, Hornby Rd., Fort, Bombay.

Calcutta ... Bentinck Cycle Co., 1/2, Chowringhee Rd., Calcutta.

Jullundur ... Janki Dass & Sons, Main Street, Jullundur.

Madras ... Union Co. (Motors) Ltd., Mount Rd., Madras.

Jaipur ... Tandon Bros., 16, Daryaganj, Delhi 7.

New Delhi ... Peary Lal & Sons Ltd., Queen's Way, New Delhi.

Delhi ... Peary Lal & Sons (E. Punjab) Ltd., Peary Lal Bldg., Kashmere Gate, Delhi 6.

Allahabad ... Colonelganj Cycle & Motor Agency, 12 P.D. Tandon Rd., Allahabad.

INDIA—continued

Kanpur	Calcutta Motor & Cycle Co., 26/51, Birhani Rd., Kanpur.
Cuttack	Pearl Cycle Stores, Naya Serak, Cuttack.
Lucknow	Motor Cycle House, 11, Station Rd., Lucknow.
Dehra Dun	Nawal Kishore and Son, 9, Esplanade Road, Delhi, 6.
Nagpur	Bombay Cycle Stores Co. Ltd., Mahal, Nagpur City.
Ranchi	Kedia Cycle Stores, Main Rd., Ranchi.
Jamnagar	Imperial Trading Co., Ranjit Rd., Jamnagar.
Meerut	Mittal Bros., Bombay Bazaar, Meerut.
Hyderabad	Sohrab Bros., Troop Bazaar, Hyderabad—DN.

INDONESIA ... P. T. Platon Ltd., Postrommel Dak 766, Djakarta-Kota.

IRAQ ... Mr. J. A. Noury, 2/111, Rashid Street, Baghdad, Iraq.

IRISH REPUBLIC Huet Bros. Ltd., 7 & 8, Bachelor's Walk, Dublin, C.9.

ISRAEL ... S. Gousman & Son Ltd., 16, Haki-shon St., Tel-Aviv.

ITALIAN SOMALILAND

Arabian Trading Co., Esplanade, Aden.

ITALY (North) ... Ve Ba & C, Maestri Campionesi Milano, 1.

JAPAN ... Balcom Trading Co. Inc., Fukoku Building No. 1, 2-Chome Uchisaiwai-Cho, Chiyoda-Ku, Tokyo.

KOREA ... Balcom Trading Co. Inc., Fukoku Building No. 1, 2-Chome Uchisaiwai-Cho, Chiyoda-Ku, Tokyo.

KUWAIT ... Abdul Rahman Albisher & Zaid Alkazemi, Kuwait, Persian Gulf.

LEBANON ... Associated Commercial Enterprise, P.O. Box 3270, Air Moureisseh, Beirut.

LIECHENSTEIN ... Fibag, Postfach Zurich 39, Zurich, Switzerland.

LIBERIA ... Cie. F.A.O., Monrovia.

LIBYA

Tripolitania ... F.lli Pagani Soc. Coll, 33 Giaddat Omar Muktar.

Cyrenaica ... Metcalfe Eng. Co. Ltd., P.O. Box 216, Benghazi.

LUXEMBOURG ... Famo S.A., 571 Grande Chaussée, Berchem, Antwerp, Belgium.

MADAGASCAR ... Movea, S.A., 79 Ave. de la Grande Armée, Paris XVIe, France.

MADEIRA ... A. Gomez Loja, P.O. Box 52, Funchal.

MALAYA ... Cycle & Carriage Co. (1926) Ltd. (P.O. Box 142), Orchard Road, Singapore.

MALTA ... G. Anastasi, 27 and 35 opp. St. John's Church, Valletta.

MAURITIUS ... Lising & Co., 32, Royal St., Port Louis.

MEXICO ... Watson Phillips & Cia. Succs. S.A., Apartado Postal No. 67, Mexico 6 D.F.
Alejandro Dominguez Font Calle 60, Num. 536, Merida, Yucatan.

NETHERLANDS ... Hart Nibbrig & Greeve N.V., Parkstraat 91A, The Hague.

NETHERLANDS ANTILLES (D.W.I.)

Caribbean Sales (P.O. Box 43), Noordstraat No. 543, Oranjestad, Aruba.

Caribbean Sales, Joh. van Walbeek, Plein N.4.A.

NEW BRITAIN ... Bennett & Wood Pty. Ltd., Corner Pitt and Bathurst Streets, Sydney, N.S.W. Australia.

NEW CALEDONIA ... Agence Automobile, Boite Postale 176, Nouméa Nouvelle Calédonie.

NEW GUINEA ... Bennett & Wood Ltd., Corner Pitt and Bathurst Streets, Sydney, N.S.W., Australia.

NEW HEBRIDES ... Bennett & Wood Ltd., Corner Pitt and Bathurst Streets, Sydney, N.S.W., Australia.

NEW IRELAND ... Bennett & Wood Ltd., Corner Pitt and Bathurst Streets, Sydney, N.S.W., Australia.

NEW ZEALAND ... Skeates & White Ltd., 48, Fort St., Auckland, C1.

NICARAGUA ... J. A. Estrada & Cia. Ltda. (Apartado No. 11), Avenida Roosevelt, Managua.

NORTHERN MOROCCO

Abraham S. Levy, (P.O. Box 132), Casa Riera 26/28, Tangier.

NORWAY ... Erling Sande, Grubbegaten 2/4, Oslo.

NYASALAND ... Mandala Motors, P.O. Box 47, Mandala, Blantyre.

OKINAWA ... Balcom Trading Co. Inc., Fukoku Building No. 1, 2-Chome Uchisaiwai-Cho, Chiyoda-Ku, Tokyo.

PAKISTAN ... Levetus Ltd., 194, Bishopsgate, London, E.C.2, and their branches at Karachi and Dacca, operating through:

(WEST) Shahnawaz Ltd. (P.O. Box 655), Victoria Rd., Karachi.

(EAST) Crescent Cycle & Motor Co., 161, Nawabpur Rd., Dacca.

PANAMA ... Panamusic S.A., P.O. Box 3227, Panama.

PAPUA ... Bennett & Wood Ltd., Corner Pitt and Bathurst Streets, Sydney, N.S.W., Australia.

PARAGUAY ... J. & F. Perez, 14 de Mayo Pte Franco, Asuncion.

PERSIA ... H. Mohammed Tavakolipoor, Ave. Boozarjomehri, Tehran.

PERU ... Balfour Williamson Merchant Shippers Limited, 7, Gracechurch St., London, E.C.3, operating through: Milne & Co. S.A., Apartado 684, Lima.

PHILIPPINES ... Campos Rueda & Sons, 421/7, Juan Luna, Manila.

PORTUGAL (North) Silva Neto & Ca. Lda., Anadia.

(South) Stand Vidal, Rua Josquim Bonifacio, No. 130, Lisbon, Portugal.

PORTUGUESE EAST AFRICA

F. L. Simoes & Co., P.O. Box 13, Beira.

A. A. Azevedo, P.O. Box 482, Lourenco Marques.

Gordhandas Valabhdas & Filhos, P.O. Box 45, Mozambique.

Auto Sobressalentes Ltd., P.O. 206, Quelimane.



PORTUGUESE WEST AFRICA ... Casa Americana Ltda, Caixa Postal 1208, Luanda.

PORTUGUESE GUINEA Nunes & Irmao, C.P. 83, Bissau.

PORTUGUESE INDIA M.S.B. Caculo, Nova Goa.

PUERTO RICO ... M. Castro Fernandez & Co. Ltd., (P.O. Box 1579), San Juan 7, Puerto Rico.

QATAR ... Kasem and Abdulla Sons of Darwish Fakhroo, Qatar, Persian Gulf.

REUNION ISLES ... Movea S.A., 79, Avenue de la Grande-Armee, Paris XVIe, France.

RHODESIA (NORTHERN) Messrs. Miltons Motor Cycles Ltd., P.O. Box 315, Ndula.
Pals Motors, P.O. Box 51, Lusaka, Northern Rhodesia.
The British Cycle & Sports Co., P.O. Box 274, Livingstone.

RHODESIA (SOUTHERN) Van Rooyen Motor Cycle Works Ltd. 124, Gray St., Bulawayo, Southern Rhodesia.
Alick Stuart Ltd., P.O. Box 306, Bulawayo, Southern Rhodesia.
Ray's Engineering Co., 5th Street, P.O. Box 91, Gwelo.
Gammon Bros., P.O. Box 151, Umtali.
Johnstons Motor Cycle Supplies (Pvt) Ltd., 28, Pioneer St., Salisbury.

SALVADOR ... La Agencia Nacional Ltda., Avenida Independencia, San Salvador.

SAMOA ... Morris Hedstrom Ltd., Apia.

SARAWAK ... Borneo Co. Ltd., Sackville House, Fenchurch Street, London, E.C.3.

SAUDI ARABIA ... Ebrahim Abdullah Juffali & Bros., P.O. Box 297, Jeddah.

SEYCHELLES ... Chenard & Co., P.O. Box 5, Mahe.

SOLOMON ISLANDS Bennett & Wood Ltd., Corner Pitt and Bathurst Streets, Sydney, N.S.W. Australia.

SOUTHERN MOROCCO Africa and Eastern (Near East) Ltd., P.O. Box 519, Casablanca.

SOUTH W. AFRICA Terry's Motors, P.O. Box 784, Windhoek.

SPAIN ... Commercial Yacobi, Piamonte 16, Madrid.

SPANISH GUINEA J. Gonzalez Suarez (Apartado No. 9), Puerto de la Luz, Las Palmas, Canary Islands.

SUDAN ... Geo. Djerejian & Sons, P.O. Box 269, Khartoum.

SWEDEN ... A-B. E. Fleron, Malmo.

SWITZERLAND ... Fibag, Postfach Zurich 39, Zurich.
Van Leisen S.A., 34, Rue de la Synagogue, Geneva.

SYRIA ... M. Chafik el Khiami & Co., Rue el Nasr 169, Damascus, Syria.

TAHITI ... H. Jean Hamon, Papeete.

TANGIER ... Marrache & Levy, (P.O. Box 132), Casa Riera 26/28, Tangier.

THAILAND ... Triangle Co. Ltd., (P.O. Box 70), Asdang Rd., Bangkok.

TONGA ... E. H. Jones, P.O. Box 34, Nukualofa, Tonga Islands.

TRIPOLITANIA ... F.lli Pagani Soc. Coll., 113, Sciarra Mizran, Tripoli, Libya.

TUNISIA ... Etabs. Jean Borg, 35, Rue de Marseille, Tunis.

TURKEY ... Turkish Automobile Trade Co., Beyoglu Istiklal Caddesi 239 (P.O. Box 32), Beyoglu, Istanbul.

UNION OF SOUTH AFRICA

Cape Province ... Robb Motors Ltd., 102, Strand St., Cape Town, P.O. Box 1100.

Barnes Garage Ltd., P.O. Box 438, East London.

The Union Cycle Works, P.O. Box 442, Kimberley.

Sahds, P.O. Box 149, Queenstown.

Haigh Motors (Pty) Ltd., P.O. Box 1160, Port Elizabeth.

Natal ... W. Killerby (Natal) (Pty) Ltd., 281, Umbilo Road, Durban, Natal.

Jowett Bros., P.O. Box 201, Pietermaritzburg.

Orange Free State E. Hoehne & Co., P.O. Box 619, Bloemfontein.

Transvaal ... Fisher & Simmons Ltd., 12, Albert Street, Johannesburg.

Shimwell Bros. (Pty) Ltd., P.O. Box 2035, Johannesburg, also at P.O. Box 95, Pretoria.

UNITED STATES OF AMERICA.

East Coast ... B.S.A. Incorporated, 639, Passaic Ave., Nutley 10, New Jersey.

West Coast ... Hap Alzina, 3074 Broadway, Oakland 11, California.

URUGUAY ... Linn & Cia. S.A., Casilla Correo 1027, Montevideo.

VENEZUELA ... Agencias B.S.A. de Venezuela C.A. "Groupe Oriol" Calle el Progreso, Urb. Les Acacias, Caracas.

"Casa del Motociclista," (Rafael E. Montero), Calle 89-E No. 3-A-52, Maracaibo, (Zulia and Falcon).

YEMEN ... Arabian Trading Co., Esplanade, Aden.

Plate 1

ENGINE

B31 B33 (Swinging Arm)

Plate Ref. Number.	Models.	Part No.	Description.	Number per set.
1	B31	65-1703	Cylinder barrel	1
1	B33	65-1707	Cylinder barrel	1
2	B31	65-1706	Cylinder base washer	1
2	B33	65-1706	Cylinder base washer	2
2	B33	65-134	Cylinder base shim	1
3	B31 B33	65-930	Push rod cover stud nut	2
4	B31 B33	29-541	Push rod cover stud nut washer	2
5	B31 B33	24-4227	Push rod cover tube stud	1
6	B31 B33	66-1379	Push rod cover tube washer	1
7	B31 B33	66-1937	Tappet recess cover washer	1
8	B31 B33	66-1936	Tappet recess cover	1
9	B31 B33	29-2158	Tappet recess cover screw	4
10	B31 B33	66-115	Cylinder holding down bolt	4
11	B31 B33	65-1084	Push rod	2
12	B31 B33	65-1080	Push rod cover tube	1
13	B31 B33	65-1142	Valve rocker inspection cover	1
14	B31 B33	2-2582	Valve rocker inspection cover screw	4
15	B31 B33	65-1143	Valve rocker inspection cover washer	1
16	B31 B33	42-2967	Exhaust pipe	1
—	B31 B33	42-2861	Silencer and exhaust pipe clip	1
—	B31 B33	21-5102	Silencer clip pin nut	1
—	B31 B33	90-3063	Exhaust pipe clip pin	1
—	B31 B33	90-3064	Exhaust pipe clip swivel pin	1
17	B31	65-1110	Valve (exhaust)	1
17	B33	65-1240	Valve (exhaust)	1
18	B31	65-1514	Valve guide (exhaust)	1
18	B33	65-1516	Valve guide (exhaust)	1
19	B31 B33	65-1149	Valve spring collar (exhaust)	1
20	B31	15-1525	Valve split cotter (exhaust) (halves)	2
20	B33	15-1525	Valve split cotter (inlet and exhaust) (halves)	4
21	B31	31-103	Valve stem cap exhaust	1
22	B31 B33	65-1160	Cylinder head cover (exhaust)	1
23	B31 B33	2-443	Exhaust lifter cable holder nut	1
24	B31 B33	27-1163	Exhaust lifter cable holder	1
25	B31 B33	2-443	Exhaust lifter spindle nut	1
26	B31 B33	2-525	Exhaust lifter spindle washer	1
27	B31 B33	65-1137	Exhaust lifter	1
28	B31 B33	35-701	Exhaust lifter spindle split pin	1
29	B31 B33	65-1165	Exhaust lifter spindle	1
30	B31 B33	2-2894	Exhaust lifter bush washer (fibre)	1
31	B31 B33	65-387	Exhaust lifter bush	1
32	B31 B33	65-401	Exhaust lifter spindle washer (felt)	1
33	B31 B33	65-402	Exhaust lifter spindle washer	1
34	B31 B33	65-403	Exhaust lifter spindle spring	1
35	B31 B33	66-1436	Exhaust lifter lever	1
36	B31 B33	2-443	Exhaust lifter spindle nut	1
37	B31 B33	2-525	Exhaust lifter spindle washer	1
38	B31 B33	65-317	Rocker oil feed pipe banjo screw	2
39	B31 B33	66-102	Sparkling plug washer	1
40	B31 B33	65-114	Sparkling plug	1
41	B31	65-209	Valve stem cap (inlet)	1
42	B31	29-410	Valve split cotter (inlet) (halves)	2
43	B31 B33	65-1149	Valve spring collar (inlet)	1
44	B31 B33	31-8430	Rocker oil feed pipe union washer (top)	2
45	B31 B33	65-1161	Valve rocker fulcrum pin	2
46	B31 B33	65-1146	Valve spring (inner)	2
47	B31 B33	65-1147	Valve spring (outer)	2
48	B31	65-1513	Valve guide (inlet)	1
48	B33	65-1515	Valve guide (inlet)	1
49	B31 B33	65-1118	Valve rocker fulcrum pin washer	2
50	B31 B33	65-1117	Valve rocker fulcrum spring	1
51	B31 B33	65-1102	Valve rocker (inlet)	1
52	B31 B33	65-1100	Valve rocker (exhaust)	1
53	B31 B33	27-1111	Valve rocker spindle thrust washer	2
54	B31 B33	29-541	Cylinder head cover washer	8
55	B31 B33	65-1166	Cylinder head cover screw	8
56	B31	65-1700	Cylinder head with fixed fittings	1
56	B33	65-1704	Cylinder head with fixed fittings	1
57	B31 B33	38-481	Valve rocker spindle nut washer	2
58	B31 B33	65-311	Valve rocker spindle nut	2

Engine

Gearbox

Clutch and
Front
ChaincaseFrame and
FittingsRear
Suspension
and
Central ShaftFront
and
RearMudguard
Oil Light
Silencer
ToolboxPetrol
TankLegshield
Front
SafetyFront and
Rear
Safety
CablesElectric
Equipment

ENGINE

B31 B33 (Swinging Arm)

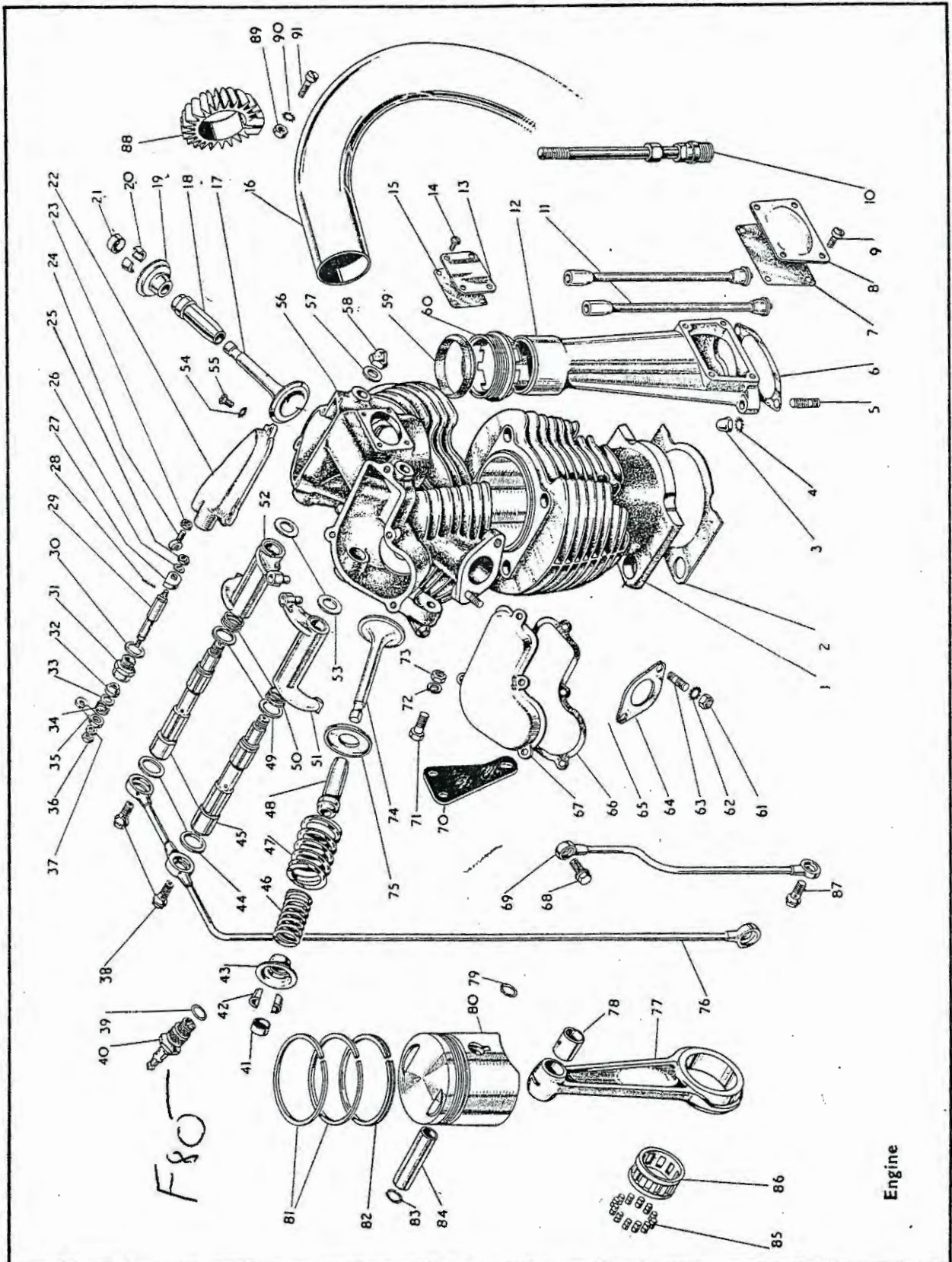

Engine

Plate 1—continued

ENGINE

B31 B33 (Swinging Arm)

Plate Ref. Number.	Models.	Part No.	Description.	Number per set.
59 ...	B31 B33	66-1367	Push rod cover tube gland packing	1
60 ...	B31 B33	65-1082	Push rod cover tube gland nut	1
61 ...	B31 B33	2-49	Carburettor stud nut	2
62 ...	B31 B33	65-1776	Sparkling plug suppressor	1
63 ...	B31 B33	36-382	Carburettor stud nut washer	2
64 ...	B31 B33	24-5205	Carburettor stud	2
64 ...	B31	65-1163	Carburettor flange washer (Tufnol)	1
64 ...	B33	65-1238	Carburettor flange washer (Tufnol)	1
66 ...	B31 B33	65-1164	Cylinder head cover washer (paper)	2
67 ...	B31 B33	65-1159	Cylinder head cover (inlet)	1
68 ...	B31 B33	26-1253	Oil return pipe banjo screw (top)	1
69 ...	B31 B33	65-1218	Oil return pipe complete	1
70 ...	B31 B33	42-50	Engine steady plate	1
71 ...	B31 B33	28-2338	Engine steady plate bolt	2
72 ...	B31 B33	24-8784	Engine steady plate bolt washer (spring)	2
73 ...	B31 B33	2-49	Engine steady plate bolt nut	2
74 ...	B31	65-1111	Valve (inlet)	1
74 ...	B33	65-1239	Valve (inlet)	1
75 ...	B31 B33	65-1519	Valve spring seat	2
76 ...	B31 B33	42-48	Rocker oil feed pipe complete	1
77 ...	B31	66-482	Connecting rod with bushes	1
77 ...	B33	65-1613	Connecting rod with bushes	1
78 ...	B31 B33	66-492	Gudgeon pin bush	1
79 ...	B31 B33	66-954	Gudgeon pin retaining circlip	1
80 ...	B31	65-809	Piston complete with rings, gudgeon pin and circlips (standard)	1
80 ...	B33	65-1660	Piston complete with rings, gudgeon pin and circlips (7.5 to 1 C.R.)	1
81 ...	B31	65-744	Compression ring	2
81 ...	B33	65-1250	Compression ring	2
81 ...	B33	24-1792	Compression ring (Maxigroove)	2
82 ...	B31	65-735	Piston scraper ring	1
82 ...	B33	65-1253	Piston scraper ring	1
83 ...	B31 B33	66-954	Gudgeon pin retaining circlip	1
84 ...	B31	65-440	Gudgeon pin	1
84 ...	B33	66-953	Gudgeon pin	1
85 ...	B31 B33	24-375	Crankpin roller	24
86 ...	B31 B33	66-506	Roller cage	1
87 ...	B31 B33	26-1253	Oil return pipe banjo screw (bottom)	1
88 ...	B31 B33	65-2890	Exhaust pipe finned collar	1
89 ...	B31 B33	21-5102	Exhaust pipe finned collar nut	1
90 ...	B31 B33	29-541	Exhaust pipe finned collar screw washer	1
91 ...	B31 B33	21-6187	Exhaust pipe finned collar screw	1

Plate 2

ENGINE

B31 B33 (Swinging Arm)

Plate Ref. Number.	Models.	Part No.	Description.	Number per set.
1 ...	B31 B33	1-4675	Oil valve spring ball	1
2 ...	B31 B33	66-1684	Oil valve spring	1
3 ...	B31 B33	66-1683	Oil valve retaining screw washer (fibre)	1
4 ...	B31 B33	65-2188	Oil valve spring retaining screw	1
5 ...	B31 B33	65-2157	Timing cover screw	6
6 ...	B31 B33	42-124	Contact breaker fixing screw	3
7 ...	B31 B33	66-1920	Timing cover washer	1
8 ...	B31 B33	66-698	Engine shaft oil feed pipe	1
9 ...	B31 B33	29-905	Engine shaft timing pinion nut	1
10 ...	B31 B33	66-1923	Oil feed washer (rubber)	2
11 ...	B31 B33	66-2007	Cam pinion spindle-bolt	2
12 ...	B31 B33	66-2008	Timing gear plate with bearing	1

ENGINE

B31 B33 (Swinging Arm)

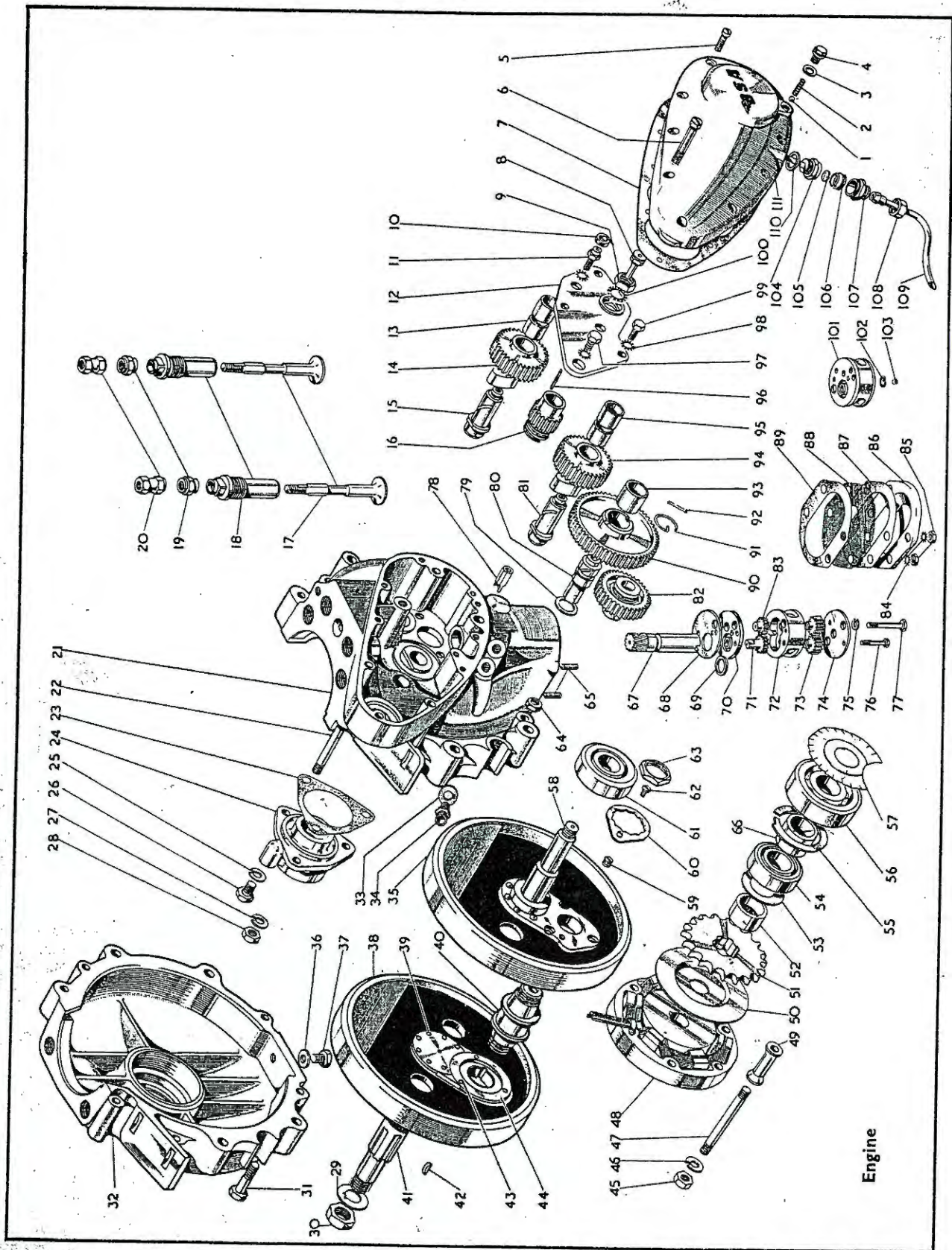

Plate 2—continued

ENGINE

B31 B33 (Swinging Arm)

Plate Ref. Number.	Models.	Part No.	Description.	Number per set.
13	B31 B33	65-441	Cam pinion bush (exhaust)	2
14	B31 B33	65-2420	Cam pinion complete (exhaust)	1
15	B31 B33	65-2426	Cam pinion spindle (exhaust)	1
16	B31 B33	65-692	Engine shaft timing pinion	1
17	B31 B33	66-1493	Tappet (inlet and exhaust)	2
18	B31 B33	66-1494	Tappet guide (inlet and exhaust)	2
19	B31	15-6524	Tappet locknut	2
19	B33	65-1332	Tappet locknut	2
20	B31 B33	66-1511	Tappet head (inlet and exhaust)	2
21	B31 B33	*42-112	Crankcase with fixed fittings (gear side) (see footnote)	1
22	B31 B33	31-212	Crankcase stud (top) (rear)	1
23	B31 B33	42-121	Contact breaker housing joint washer	1
24	B31 B33	42-119	Contact breaker housing	1
25	B31 B33	2-1462	Contact breaker clamp bolt washer (spring)	1
26	B31 B33	21-5841	Contact breaker clamp bolt	1
27	B31 B33	2-1462	Contact breaker fixing screw washer	3
28	B31 B33	2-2395	Contact breaker fixing screw nut	3
29	B31 B33	20-2024	Alternator nut lockwasher	1
30	B31 B33	29-2023	Alternator Nut	1
31	B31 B33	15-1355	Crankcase connecting bolt	3
32	B31 B33	*42-111	Crankcase with fixed fittings (drive side) (see footnote)	1
33	B31 B33	66-1683	Crankcase oil pipe adaptor washer	2
34	B31 B33	65-2252	Crankcase oil pipe adaptor	2
35	B31	65-1125	Flywheel with engine shaft (gear side)	1
35	B33	65-1285	Flywheel with engine shaft (gear side)	1
36	B31 B33	2-4553	Crankcase drain plug washer (fibre)	1
37	B31 B33	28-243	Crankcase drain plug	1
38	B31	42-93	Flywheel with engine shaft (drive side)	1
38	B33	42-94	Flywheel with engine shaft (drive side)	1
39	B31 B33	27-1239	Engine shaft rivet	14
40	B31 B33	66-545	Crankpin	1
41	B31 B33	42-95	Engine shaft (drive side)	1
42	B31 B33	2-36	Crankpin key	1
43	B31 B33	66-630	Thrust washer rivet	6
44	B31 B33	66-629	Thrust washer	2
45	B31 B33	42-101	Alternator fixing stud nut	3
46	B31 B33	24-8784	Alternator fixing stud nut washer (spring)	3
47	B31 B33	42-98	Alternator fixing stud	3
48	B31 B33	19-1222	Alternator	1
49	B31 B33	42-99	Alternator spacer	3
50	B31 B33	29-2031	Alternator spinner	1
51	B33	42-88	Engine sprocket (10T) (solo)	1
51	B31	42-89	Engine sprocket (17T) (solo and s/car)	1
52	B31 B33	42-96	Engine sprocket distance piece	1
53	B31 B33	66-661	Engine shaft shim (drive side)	1
54	B31 B33	65-2045	Ball bearing (drive side)	1
55	B31 B33	65-2240	Main bearing spring ring	1
56	B31 B33	24-724	Roller bearing (drive side)	1
57	B31 B33	24-2113	Oil flinger	1
58	B31 B33	65-1129	Engine shaft (gear side)	1
59	B31 B33	65-479	Crankpin oil hole grub screw	1
60	B31 B33	31-300	Crankpin nut locking washer	2
61	B31 B33	24-722	Roller bearing (gear side)	1
62	B31 B33	2-77	Crankpin nut locking washer screw	2
63	B31 B33	31-298	Crankpin nut	2
64	B31 B33	2-49	Crankcase connecting bolt nut	4
65	B31 B33	31-222	Crankcase scavenge cover stud	4
66	B31 B33	66-660	Engine shaft distance collar	1
67	B31 B33	66-2620	Oil pump driving spindle	1
68	B31 B33	65-2618	Oil pump and crankcase joint washer	1
69	B31 B33	65-2606	Oil pump top plate washer	1
70	B31 B33	65-2598	Oil pump top plate	1
71	B31 B33	65-2592	Oil pump feed gear (driver)	1
72	B31 B33	65-2596	Oil pump body	1
73	B31 B33	65-2590	Oil pump scavenge gear	2
74	B31 B33	65-2625	Oil pump bottom plate	1
75	B31 B33	24-978	Oil pump bolt washer (spring)	2
76	B31 B33	15-848	Oil pump bolt	2

*Supplied only as 42-110 crankcase drive side and gear side assembled with fixed fittings ... 1

Plate 2—continued

ENGINE

B31 B33 (Swinging Arm)

Plate Ref. Number.	Models.	Part No.	Description.	Number per set.
77	B31 B33	65-2604	Oil pump fixing bolt	2
78	B31 B33	65-2580	Oil pump driving spindle retaining pin	1
79	B31 B33	36-3528	Idler pinion thrust washer	1
80	B31 B33	65-2335	Idler pinion spindle	1
81	B31 B33	65-2425	Cam pinion spindle (inlet)	1
82	B31 B33	42-120	Contact breaker pinion	1
83	B31 B33	65-2591	Oil pump feed gear (driven)	1
84	B31 B33	29-541	Crankcase scavenge cover stud washer	4
85	B31 B33	2-51	Crankcase scavenge cover stud nut	4
86	B31 B33	65-2611	Crankcase scavenge cover	1
87	B31 B33	65-2612	Crankcase scavenge cover washer	1
88	B31 B33	65-2623	Oil pump filter	1
89	B31 B33	65-2612	Crankcase scavenge cover washer	1
90	B31 B33	66-2250	Magdyno drive idler pinion complete	1
91	B31 B33	42-123	Contact breaker pinion circlip	1
92	B31 B33	42-122	Contact breaker pinion pin	1
93	B31 B33	65-2336	Idler pinion bush	1
94	B31 B33	65-2420	Cam pinion complete (inlet)	1
95	B31 B33	65-441	Cam pinion bush (inlet)	2
96	B31 B33	65-693	Engine shaft timing pinion key	1
97	B31 B33	1-5069	Timing gear plate bolt (C.E.I.)	1
98	B31 B33	36-382	Timing gear plate washer (shakeproof)	6
99	B31 B33	21-2902	Timing gear plate bolt (Whit.)	3
100	B31 B33	65-695	Timing pinion locking washer	1
101	B31 B33	65-2589	Oil pump complete	1
102	B31 B33	65-2622	Oil pump ball retaining circlip	1
103	B31 B33	65-2593	Oil pump ball	1
104	B31 B33	65-2168	Timing cover air release adaptor	1
105	B31 B33	15-82	Air release disc	1
106	B31 B33	65-2171	Air release adaptor screw	1
107	B31 B33	65-2165	Timing cover air release body	1
108	B31 B33	66-8332	Breather extension pipe nut	1
109	B31 B33	65-2166	Breather extension pipe	1
110	B31 B33	31-8430	Air release adaptor washer (fibre)	1
111	B31 B33	65-2143	Timing cover	1

Plate 3

GEARBOX

B31 B33 (Swinging Arm)

Plate Ref. Number.	Models.	Part No.	Description.	Number per set.
1	B31 B33	67-3026	Ball bearing spring ring	1
2	B31 B33	67-3067	Gearbox sprocket oil seal	1
3	B31 B33	24-4065	Constant mesh gear ball bearing	1
4	B31 B33	67-3073	Constant mesh gear bush	1
5	B31 B33	67-3192	Constant mesh gear complete (26T)	1
6	B31 B33	67-3080	Constant mesh gear bush (drilled)	1
7	B31 B33	67-3201	Mainshaft sliding gear (20T)	1
8	B31 B33	67-3202	Mainshaft sliding gear (24T)	1
9	B31 B33	67-3329	Gearbox mainshaft with gear	1
10	B31 B33	67-3330	Gearbox mainshaft only	1
11	B31 B33	2-433	Gearbox mainshaft key	1
12	B31 B33	15-4124	Clutch push rod	1
13	B31 B33	67-3101	Mainshaft gear locating ring	1
14	B31 B33	67-3191	Gearbox mainshaft gear (16T)	1
15	B31 B33	24-4217	Mainshaft bearing	1
16	B31 B33	67-3028	Mainshaft bearing spring ring	1
17	B31 B33	67-3161	Kickstarter ratchet pinion sleeve washer	1
18	B31 B33	67-3169	Kickstarter ratchet pinion bush	1
	B31 B33	67-3162	Kickstarter ratchet spring	1

GEARBOX B31 B33 (Swinging Arm)

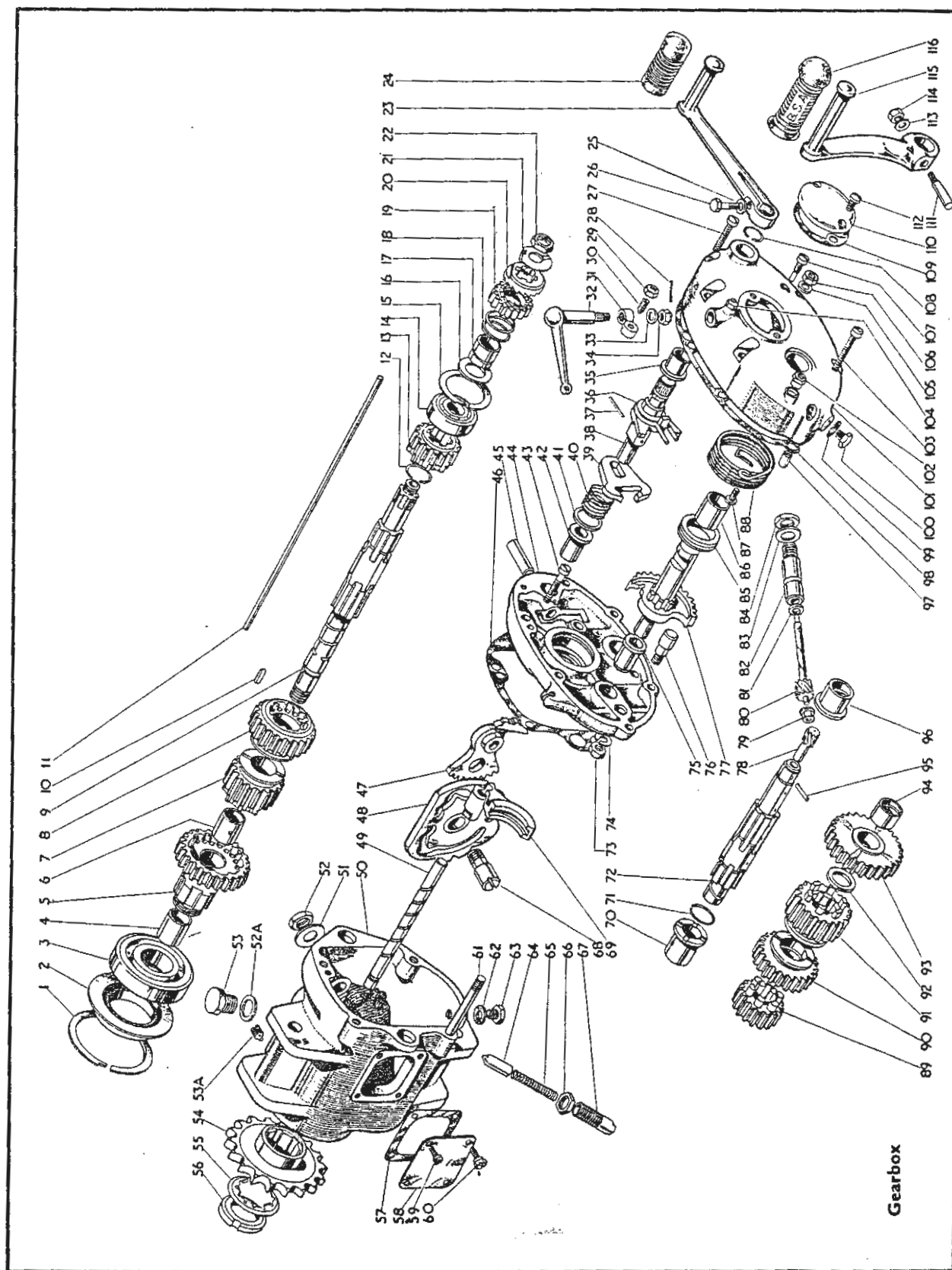

Plate 3—continued

GEARBOX

B31 B33 (Swinging Arm)

Plate Ref. Number.	Models.	Part No.	Description	Number per set.
19	... B31 B33	67-3376	Kickstarter ratchet pinion	1
20	... B31 B33	67-3167	Kickstarter ratchet	1
21	... B31 B33	67-3164	Kickstarter ratchet and mainshaft lock washer	1
22	... B31 B33	67-3163	Kickstarter ratchet and mainshaft nut	1
23	... B31 B33	42-3017	Gearchange operating lever	1
24	... B31 B33	29-3250	Foot operating lever rubber	1
25	... B31 B33	2-525	Foot operating lever screw washer	1
26	... B31 B33	65-3361	Selector lever foot operating screw	1
27	... B31 B33	65-3061	Outer cover fixing screw (long)	2
28	... B31 B33	35-702	Clutch push rod lever nut split pin	1
29	... B31 B33	2-452	Clutch push rod lever adjusting screw nut	1
30	... B31 B33	65-3403	Clutch push rod adjusting screw complete	1
31	... B31 B33	65-3360	Clutch push rod lever	1
32	... B31 B33	67-3180	Clutch operating lever complete	1
33	... B31 B33	2-525	Clutch push rod lever washer	1
34	... B31 B33	15-1485	Clutch push rod lever nut	1
35	... B31 B33	67-3353	Gearchange lever spindle bush	1
36	... B31 B33	67-3340	Footchange stop plate return spring	1
37	... B31 B33	35-709	Gear selector plate spring washer split pin	1
38	... B31 B33	67-3335	Selector spindle complete	1
39	... B31 B33	67-3341	Gear selector plate	1
40	... B31 B33	67-3342	Gear selector plate spring	1
41	... B31 B33	24-868	Gear selector plate spring washer	1
42	... B31 B33	67-3170	Footchange lever spindle bush	1
43	... B31 B33	65-2157	Gearbox inner cover retaining screw	1
44	... B31 B33	67-3344	Gearbox inner cover complete	1
45	... B31 B33	67-3350	Gearchange quadrant pivot pin	1
46	... B31 B33	67-3346	Gearbox inner cover joint washer (paper)	1
47	... B31 B33	67-3347	Gearchange quadrant complete	1
48	... B31 B33	67-3332	Gear control cam plate complete	1
49	... B31 B33	67-3116	Gear shifter fork shaft	1
50	... B31 B33	42-3006	Gearbox case with fixed fittings	1
51	... B31 B33	67-3328	Gear cam plate pivot pin washer	1
52	... B31 B33	2-124	Gear cam plate pivot pin nut	1
53	... B31 B33	67-3117	Gear shifter fork grub screw	1
54	... B31 B33	67-3065	Gearbox sprocket (19T) (B31 solo, B33 solo and s/car)	1
54	... B31	67-3068	Gearbox sprocket (17T) sidecar	1
55	... B31 B33	24-4263	Gearbox sprocket locking washer	1
56	... B31 B33	67-3052	Gearbox sprocket nut	1
57	... B31 B33	29-3449	Gearbox inspection cover washer	1
58	... B31 B33	29-3448	Gearbox inspection cover	1
59	... B31 B33	2-498	Gearbox inspection cover screw	1
60	... B31 B33	27-4258	Gearbox inspection cover screw	3
61	... B31 B33	67-3023	Gearbox outer cover stud	4
62	... B31 B33	2-4553	Gearbox drain plug washer (fibre)	1
63	... B31 B33	28-243	Gearbox drain plug	1
64	... B31 B33	67-3119	Gearbox cam plate plunger	1
65	... B31 B33	67-3121	Gear control cam plate plunger spring	1
66	... B31 B33	67-3122	Gear control cam plate plunger housing nut	1
67	... B31 B33	67-3120	Gear control cam plate plunger housing	1
68	... B31 B33	67-3327	Gear cam plate pivot pin	1
69	... B31 B33	67-3204	Gear shifter fork	2
70	... B31 B33	65-3337	Layshaft bush	1
71	... B31 B33	67-3101	Layshaft gear locating ring	1
72	... B31 B33	42-3018	Layshaft complete with gear (17T)	1
73	... B31 B33	42-3019	Layshaft only	1
74	... B31 B33	2-49	Kickstarter quadrant stop nut	1
75	... B31 B33	24-8784	Kickstarter quadrant stop washer	1
76	... B31 B33	67-3151	Kickstarter spindle bush	1
77	... B31 B33	67-3152	Kickstarter quadrant stop	1
78	... B31 B33	42-3160	Kickstarter crank spindle assembly	1
79	... B31 B33	67-3088	Speedometer driving gear (6T)	1
80	... B31 B33	65-3377	Speedometer gear bush	1
81	... B31 B33	67-3175	Speedometer driven gear (11T)	1
82	... B31 B33	65-3375	Speedometer driven gear thrust washer	1
83	... B31 B33	65-3390	Speedometer driven gear bush	1
84	... B31 B33	65-3392	Speedometer driven gear bush washer (fibre)	1
85	... B31 B33	65-3391	Speedometer driven gear bush nut	1
85	... B31 B33	67-3173	Kickstarter spindle sleeve	1
86	... B31 B33	67-3153	Kickstarter lever spindle bush	1

Plate 3—continued

GEARBOX

B31 B33 (Swinging Arm)

Plate Ref. Number.	Models.	Part No.	Description.	Number per set.
87	B31 B33	2-3718	Kickstarter spring screw	1
88	B31 B33	67-3174	Kickstarter spring	1
89	B31 B33	42-3020	Layshaft gear (17T)	1
90	B31 B33	42-3023	Layshaft sliding gear (23T)	1
91	B31 B33	67-3193	Layshaft sliding gear (19T)	1
92	B31 B33	67-3203	Layshaft thrust washer	1
93	B31 B33	67-3199	Layshaft gear complete (27T)	1
94	B31 B33	67-3093	Layshaft gear bush	1
95	B31 B33	67-3128	Speedometer gear layshaft peg	1
96	B31 B33	67-3099	Layshaft bush	1
97	B31 B33	66-3074	Dowel	2
98	B31 B33	67-3354	Gearbox outer cover joint washer (paper)	1
99	B31 B33	2-4553	Oil level plug washer (fibre)	1
100	B31 B33	28-243	Oil level plug	1
101	B31 B33	67-3351	Gearbox outer cover complete	1
102	B31 B33	27-4401	Kickstarter spring screw locknut	1
103	B31 B33	67-1705	Outer cover fixing screw (short)	1
104	B31 B33	28-2080	Grease nipple	1
105	B31 B33	2-923	Outer cover fixing nut washer	4
106	B31 B33	67-3034	Outer cover fixing nut	4
107	B31 B33	67-3176	Speedometer driven gear retaining pin	1
—	B31 B33	67-1709	Speedometer driven gear retaining pin washer	1
108	B31 B33	15-4240	Gearchange operating spindle circlip	1
109	B31 B33	64-3106	Inspection cover joint washer (fibre)	1
110	B31 B33	67-3024	Inspection cover	1
111	B31 B33	2-2579	Kickstarter crank cotter	1
112	B31 B33	24-7178	Inspection cover fixing screw	2
113	B31 B33	15-5155	Kickstarter crank cotter washer (plain)	1
114	B31 B33	2-2578	Kickstarter crank cotter nut	1
115	B31 B33	42-3167	Kickstarter crank	1
116	B31 B33	65-3397	Kickstarter pedal rubber	1

Plate 4

CLUTCH and FRONT CHAINCASE

B31 B33 (Swinging Arm)

Plate Ref. Number.	Models.	Part No.	Description.	Number per set.
1	B31 B33	65-3063	Primary chaincase fixing screw (front)	6
2	B31 B33	67-1711	Primary chaincase front fixing, oil level and drain screw	2
3	B31 B33	67-1706	Primary chaincase fixing screw (front)	4
4	B31 B33	67-42	Primary chaincase inspection cap washer	1
5	B31 B33	65-3364	Primary chaincase inspection cap	1
6	B31 B33	67-1704	Primary chaincase fixing screw (front)	3
7	B31 B33	67-1709	Primary chaincase front fixing, oil level and drain screw washer (fibre)	5
8	B31 B33	42-7543	Primary chaincase (front)	1
9	B31 B33	42-3199	Clutch centre pin nut	4
10	B31 B33	42-3204	Clutch spring	4
11	B31 B33	42-3203	Clutch spring cup	4
12	B31 B33	42-3173	Pressure plate assembly	1
13	B31 B33	42-3192	Driving plate assembly	5
14	B31 B33	42-3195	Clutch driven plate	5
15	B31 B33	42-3202	Drive rubber	4
16	B31 B33	42-3187	Retaining plate (outer)	1
17	B31 B33	42-3201	Rebound rubber	4
18	B31 B33	42-3184	Clutch spider	1
19	B31 B33	42-3200	Clutch centre	1
20	B31 B33	42-3182	Retaining plate (inner)	1
21	B31 B33	42-3207	Clutch centre pin	4
22	B31 B33	42-3208	Clutch housing and sprocket assembly	1

CLUTCH and FRONT CHAINCASE

B31 B33 (Swinging Arm)

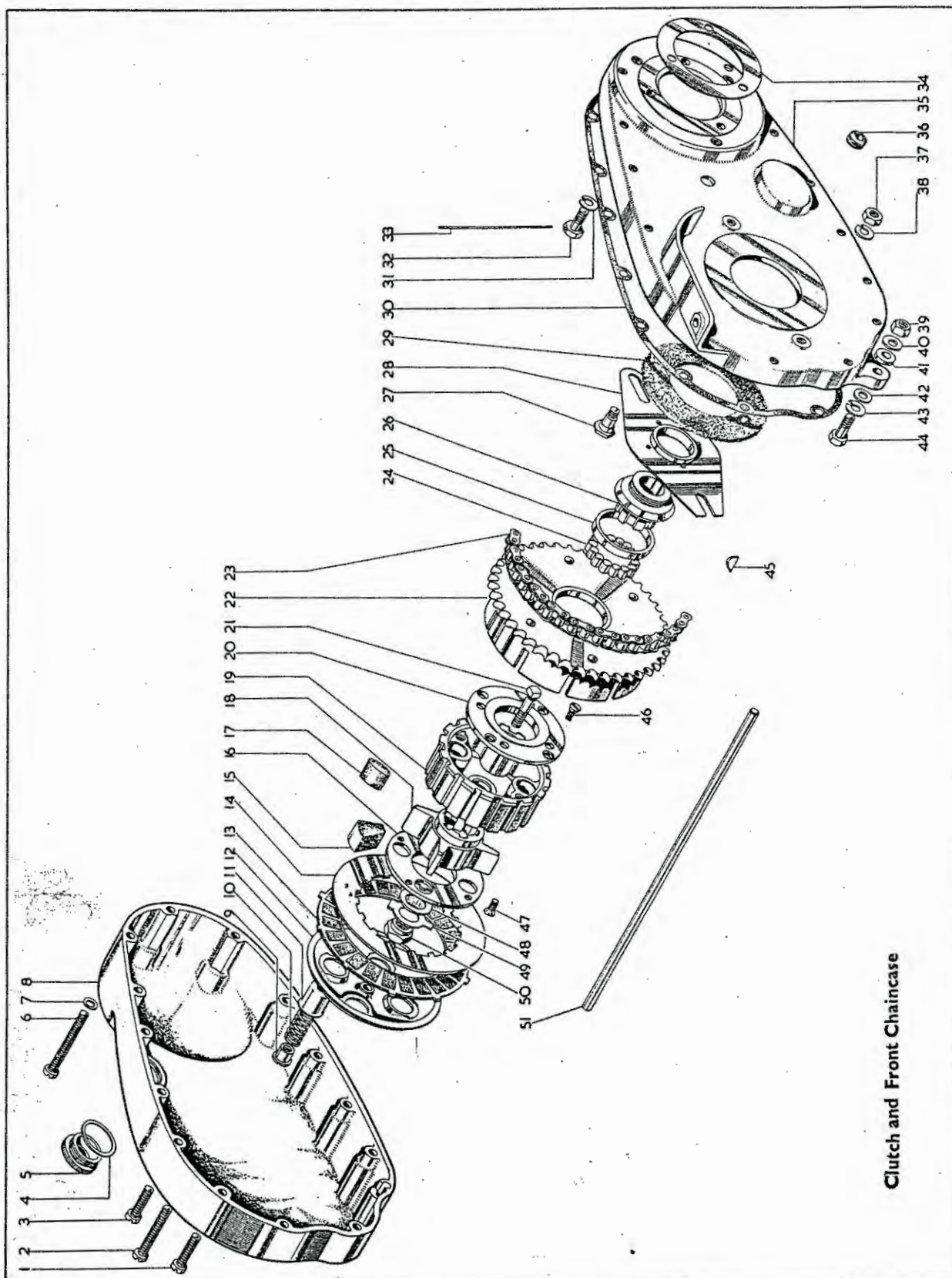

Clutch and Front Chaincase

Plate 4—continued

CLUTCH and FRONT CHAINCASE

B31 B33 (Swinging Arm)

Plate Ref. Number.	Models.	Part No.	Description.	Number per set.
23 ...	B31 ...	24-8716 ...	Transmission chain (front) 87 pitches ...	1
23 ...	B33 ...	24-8930 ...	Transmission chain (front) 68 pitches ...	1
24 ...	B31 B33 ...	42-3206 ...	Clutch roller ...	20
25 ...	B31 B33 ...	42-3177 ...	Clutch housing bearing ring ...	1
26 ...	B31 B33 ...	42-3170 ...	Clutch sleeve ...	1
27 ...	B31 B33 ...	42-7520 ...	Primary chaincase sliding plate bolt ...	2
28 ...	B31 B33 ...	66-7520 ...	Primary chaincase sliding plate ...	1
29 ...	B31 B33 ...	42-7504 ...	Primary chaincase felt washer (back) ...	1
30 ...	B31 B33 ...	42-7544 ...	Primary chaincase joint washer ...	1
31 ...	B31 B33 ...	24-8784 ...	Primary chaincase back securing bolt washer (spring) ...	3
32 ...	B31 B33 ...	42-7516 ...	Primary chaincase back securing bolt ...	3
33 ...	B31 B33 ...	65-8038 ...	Chaincase securing bolt wire ...	1
34 ...	B31 B33 ...	66-7575 ...	Primary chaincase and crankcase joint washer ...	1
35 ...	B31 B33 ...	42-7542 ...	Primary chaincase (back) ...	1
36 ...	B31 B33 ...	42-7539 ...	Chaincase cable grommet (back) ...	1
37 ...	B31 B33 ...	2-2395 ...	Chaincase sliding plate bolt nut ...	2
38 ...	B31 B33 ...	2-1462 ...	Chaincase sliding plate bolt washer ...	2
39 ...	B31 B33 ...	2-49 ...	Chaincase fixing bolt nut (back) ...	1
40 ...	B31 B33 ...	2-923 ...	Chaincase fixing bolt washer (back) ...	1
41 ...	B31 B33 ...	42-4792 ...	Chaincase fixing distance collar (back) ...	1
42 ...	B31 B33 ...	29-940 ...	Chaincase fixing distance washer (back) ...	As required
43 ...	B31 B33 ...	35-33 ...	Chaincase fixing bolt washer (spring) ...	1
44 ...	B31 B33 ...	2-6026 ...	Chaincase fixing bolt (back) ...	1
45 ...	B31 B33 ...	2-433 ...	Clutch sleeve key ...	1
46 ...	B31 B33 ...	42-3183 ...	Retaining plate screw (inner) ...	4
47 ...	B31 B33 ...	42-3183 ...	Retaining plate screw (outer) ...	4
48 ...	B31 B33 ...	42-3190 ...	Mainshaft nut washer ...	1
49 ...	B31 B33 ...	42-3191 ...	Mainshaft nut tab washer ...	1
50 ...	B31 B33 ...	42-3171 ...	Mainshaft nut ...	1
51 ...	B31 B33 ...	15-4124 ...	Clutch operating rod ...	1

Plate 5

FRAME and FITTINGS

B31 B33 (Swinging Arm)

Plate Ref. Number.	Models.	Part No.	Description.	Number per set.
1 ...	B31 B33 ...	65-4182 ...	Rear engine and gearbox plate stud (top and bottom rear) ...	2
2 ...	B31 B33 ...	2-522 ...	Rear engine and gearbox plate stud washer (spring) ...	5
3 ...	B31 B33 ...	2-46 ...	Rear engine and gearbox plate stud nut ...	5
4 ...	B31 B33 ...	2-1945 ...	Gearbox pivot stud washer (plain) ...	2
5 ...	B31 B33 ...	2-1967 ...	Gearbox pivot stud washer (spring) ...	2
6 ...	B31 B33 ...	2-1925 ...	Gearbox pivot stud nut ...	2
7 ...	B31 B33 ...	42-4077 ...	Gearbox pivot stud ...	1
8 ...	B31 B33 ...	27-5683 ...	Rear engine and gearbox plate stud (bottom front) ...	1
9 ...	B31 B33 ...	2-522 ...	Rear engine and gearbox plate stud washer (spring) (bottom front) ...	2
10 ...	B31 B33 ...	2-46 ...	Rear engine and gearbox plate stud nut (bottom front) ...	2
11 ...	B31 B33 ...	2-522 ...	Crankcase and rear engine plate fixing stud washer (spring) (bottom) ...	2
12 ...	B31 B33 ...	2-46 ...	Crankcase and rear engine plate fixing stud nut (bottom) ...	2
13 ...	B31 B33 ...	27-5683 ...	Crankcase and rear engine plate stud (bottom) ...	1
14 ...	B31 B33 ...	42-4125 ...	Front engine plate cover ...	1
15 ...	B31 B33 ...	29-3319 ...	Front engine plate cover screw washer (shakeproof) ...	6
16 ...	B31 B33 ...	2-1309 ...	Front engine plate cover screw ...	6
17 ...	B31 B33 ...	66-4149 ...	Ball head cup ...	2
18 ...	B31 B33 ...	42-4440 ...	Frame complete with central stand ...	1
19 ...	B31 B33 ...	42-4132 ...	Rear engine and gearbox plate bolt (top) ...	1
20 ...	B31 B33 ...	28-2080 ...	Ball head grease nipple ...	1
21 ...	B31 B33 ...	42-4078 ...	Petrol tank fixing bolt socket ...	1
22 ...	B31 B33 ...	29-8740 ...	Petrol tank fixing bolt socket tab washer ...	1
22 ...	B31 B33 ...	66-4707 ...	Saddle front fixing bolt washer (shakeproof) ...	1

FRAME and FITTINGS

B31 B33 (Swinging Arm)

Plate Ref. Number.	Models.	Part No.	Description.	Number per set.
23	B31 B33	2-46	Saddle front fixing bolt nut	1
24	B31 B33	29-3319	Air cleaning fixing screw washer (shakeproof)	2
—	B31 B33	42-4591	Air cleaner element	1
—	B31 B33	42-4592	Air cleaner element cover	1
—	B31 B33	42-4593	Air cleaner element sealing ring	1
—	B31 B33	42-4594	Air cleaner element retaining clip	1
—	B31 B33	42-4588	Air cleaner fixing screw distance collar	1
25	B31 B33	42-4574	Air cleaner fixing screw	2
26	B31 B33	2-1096	Air cleaner fixing screw washer (plain)	2
27	B31 B33	67-4588	Air cleaner rubber connection spring clip	1
28	B31 B33	42-4568	Air cleaner rubber connection	1
29	B31 B33	42-4070	Front engine plate and frame distance tube	1
30	B31 B33	27-5690	Front engine plate frame stud (top)	1
31	B31 B33	2-522	Front engine plate frame stud washer (spring)	4
32	B31 B33	2-46	Front engine plate frame stud nut	4
33	B31 B33	2-46	Crankcase front fixing stud nut	6
34	B31 B33	2-522	Crankcase front fixing stud washer (spring)	6
35	B31 B33	27-5684	Crankcase and front engine plate front fixing stud	3
36	B31 B33	42-4070	Front engine plate and frame distance tube	1
37	B31 B33	42-4099	Front engine plate stud (bottom) and horn fixing stud	1
38	B31 B33	42-4072	Rear engine and gearbox plate (top)	2
39	B31 B33	42-4073	Rear engine and gearbox plate (bottom)	2
40	B31 B33	65-4182	Crankcase and rear engine plate top fixing stud	1
41	B31 B33	42-4071	Front engine plate distance collar	2
42	B31 B33	42-4068	Front engine plate (offside)	1
42	B31 B33	42-4066	Front engine plate (nearside)	1
43	B31 B33	2-46	Crankcase and rear engine plate top fixing stud nut	2
44	B31 B33	2-522	Crankcase and rear engine plate top fixing stud washer (spring)	2
45	B31 B33	2-1925	Gearbox locking stud nut	1
46	B31 B33	66-4708	Gearbox locking stud washer (shakeproof)	1
47	B31 B33	42-4076	Gearbox adjusting screw	1
48	B31 B33	2-1616	Gearbox adjusting screw locknut	1
49	B31 B33	15-5664	Gearbox adjusting screw nut	1
50	B31 B33	27-5705	Gearbox adjusting screw stop	1
51	B31 B33	42-4075	Gearbox locking stud washer (serrated)	1
52	B31 B33	42-4074	Gearbox locking stud complete	1
53	B31 B33	2-1462	Gearbox adjusting screw stop washer (spring)	1
54	B31 B33	2-2395	Gearbox adjusting screw stop nut	1
55	B31 B33	24-6770	Battery base plate bolt	4
56	B31 B33	2-923	Battery base plate bolt washer (plain)	2
57	B31 B33	15-6524	Battery base plate bolt nut	2
58	B31 B33	36-382	Battery base plate bolt washer (shakeproof)	4
59	B31 B33	42-4515	Battery base plate	1
60	B31 B33	42-4406	Rear engine plate cover	1
61	B31 B33	42-4583	Air cleaner complete	1
62	B31 B33	28-2080	Saddle front fixing bolt grease nipple	1
63	B31 B33	67-4030	Saddle front fixing bolt	1
—	B31 B33	42-4514	Battery carrier complete	1
64	B31 B33	42-4516	Battery strap (side) complete	1
65	B31 B33	42-4502	Battery strap (top)	1
—	B31 B33	2-6537	Battery strap bolt washer (plain)	2
66	B31 B33	24-7343	Battery strap bolt	2
67	B31 B33	42-9032	Saddle (as required) (1954/5)	1
67	B31 B33	42-9032	Saddle (as required)	1
68	B31 B33	42-4505	Battery strap swivel pin (plain hole)	1
69	B31 B33	42-4506	Battery strap swivel pin (tapped hole)	1
70	B31 B33	42-4503	Battery strap (side)	1
71	B31 B33	2-49	Saddle rear fixing stud nut	4
72	B31 B33	2-923	Saddle rear fixing stud washer (plain)	4
73	B31 B33	67-4040	Saddle rear fixing stud	2
—	B31 B33	42-4835	Pillion footrest complete assembly	2
74	B31 B33	29-7581	Pillion footrest only	2
74A	B31 B33	29-7583	Pillion footrest rubber	2
75	B31 B33	29-7564	Pillion footrest swivel bolt	2
76	B31 B33	29-7560	Pillion footrest anchor bolt	2
77	B31 B33	36-382	Pillion footrest swivel bolt washer	2
78	B31 B33	24-6040	Pillion footrest swivel bolt nut	2
79	B31 B33	2-522	Pillion footrest anchor bolt washer	2
80	B31 B33	2-46	Pillion footrest anchor bolt nut	2
—	B31 B33	42-4769	Prop stand assembly	1

FRAME and FITTINGS

B31 B33 (Swinging Arm)

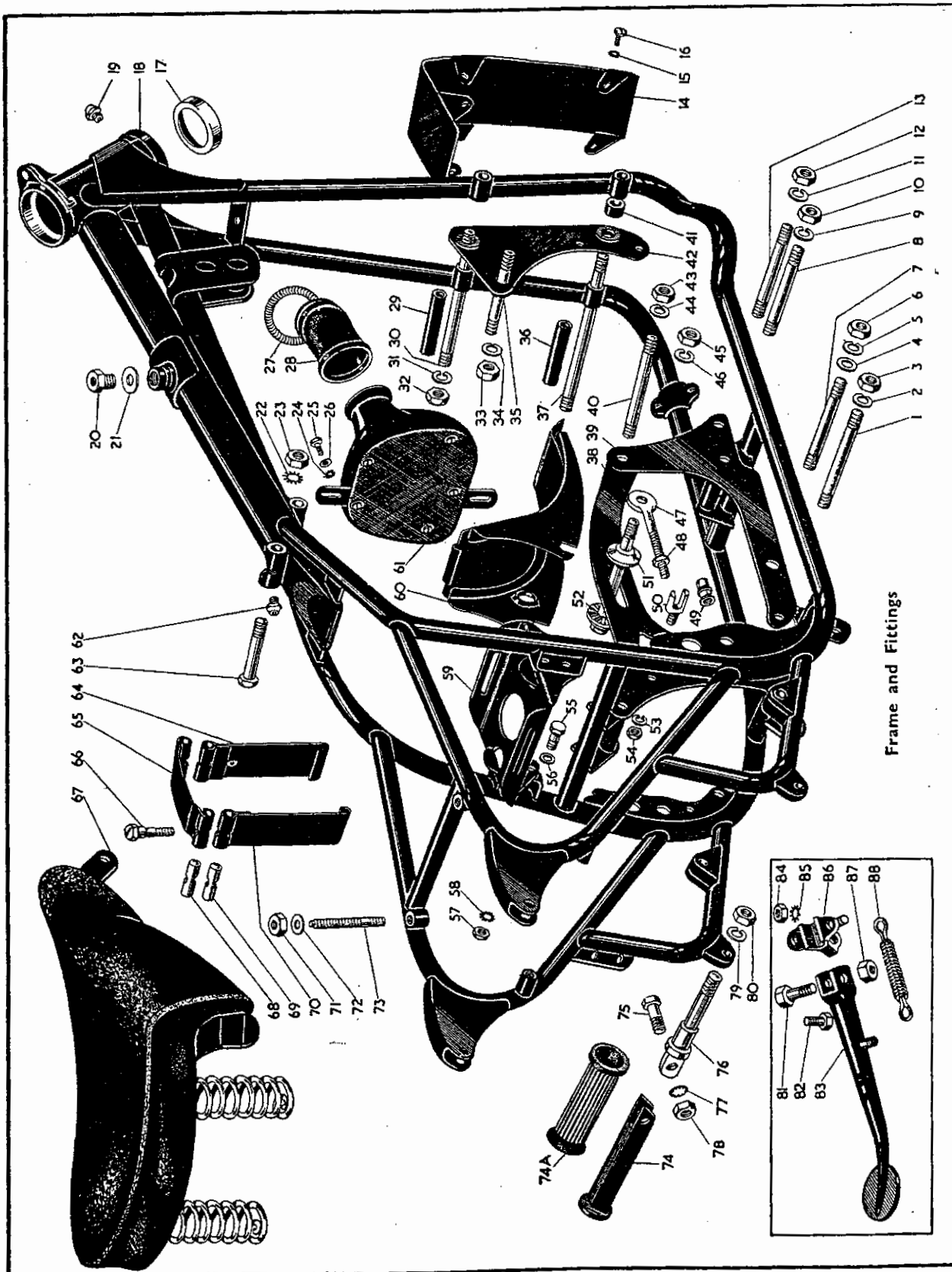

Plate 5—continued

FRAME and FITTINGS

B31 B33 (Swinging Arm)

Plate Ref. Number.	Models.	Part No.	Description.	Number per set.
81	B31 B33	42-4793	Prop stand bolt	1
82	B31 B33	42-4796	Prop stand lug clip bolt	2
83	B31 B33	42-4772	Prop stand leg	1
84	B31 B33	42-4797	Prop stand lug clip bolt locknut	1
85	B31 B33	36-382	Prop stand lug clip bolt washer	2
86	B31 B33	42-4776	Prop stand lug body complete	1
87	B31 B33	15-734	Prop stand bolt nut	1
88	B31 B33	65-4742	Prop stand spring	1

Plate 6

REAR SUSPENSION and CENTRAL STAND

B31 B33 (Swinging Arm)

Plate Ref. Number.	Models.	Part No.	Description.	Number per set.
1	B31 B33	42-4736	Central stand complete	1
2	B31 B33	28-2080	Central stand grease nipple	1
3	B31 B33	42-4730	Central stand spring	1
4	B31 B33	42-4745	Central stand tube	1
5	B31 B33	42-4744	Central stand pivot distance bar	1
6	B31 B33	15-39	Central stand pivot washer (plain)	2
7	B31 B33	3-1346	Central stand pivot stud washer (double spring)	1
8	B31 B33	35-707	Central stand pivot bar split pin	2
9	B31 B33	42-4806	Footrest distance tube complete (offside)	1
10	B31 B33	42-4804	Footrest bracket (offside)	1
11	B31 B33	42-4855	Footrest stud complete	1
12	B31 B33	29-7551	Footrest rubber	2
13	B31 B33	42-4343	Swinging arm fork spindle locknut	1
14	B31 B33	42-4364	Swinging arm fork spindle washer	1
15	B31 B33	1-1796	Rear mudguard bracket and damper top fixing bolt nut	2
16	B31 B33	2-522	Rear mudguard bracket and damper top fixing bolt washer (spring)	2
17	B31 B33	42-6763	Rear mudguard bracket and damper spacing collar	2
18	B31 B33	2-1733	Rear mudguard bracket and damper top fixing bolt washer (plain)	2
19	B31 B33	65-4185	Rear mudguard bracket and damper top fixing bolt	2
20	B31 B33	42-4299	Rear suspension damper spring (110 lbs. rate)	2
20	B31 B33	42-4302	Rear suspension damper spring (130 lbs. rate)	2
21	B31 B33	42-4289	Rear suspension split ring retainer (retaining outer shroud) (2 halves)	2
22	B31 B33	42-4291	Rear suspension outer shroud	2
23	B31 B33	66-2010	Swinging arm fork spindle securing bolt	1
24	B31 B33	33-382	Swinging arm fork spindle securing bolt washer (shakeproof)	1
25	B31 B33	42-4461	Rear suspension damper complete (110 lbs. rate)	2
25	B31 B33	42-4462	Rear suspension damper complete (130 lbs. rate) (Sidecar use)	2
26	B31 B33	42-4340	Swinging arm fork spindle complete	1
27	B31 B33	42-4362	Swinging arm housing 'silent bloc'	2
28	B31 B33	42-4292	Rear suspension inner shroud	2
29	B31 B33	3-1399	Rear suspension damper bottom fixing bolt	2
30	B31 B33	2-1733	Rear suspension damper bottom fixing bolt washer (plain)	2
31	B31 B33	19-5305	Rear suspension mounting bush (rubber)	4
32	B31 B33	42-4450	Swinging arm complete with bushes	1
33	B31 B33	67-4129	Rear suspension damper bottom fixing bolt washer	2
34	B31 B33	66-4707	Rear suspension damper bottom fixing bolt washer (shakeproof)	2
35	B31 B33	2-46	Rear suspension damper bottom fixing bolt nut	2
36	B31 B33	24-563	Rear wheel adjusting screw locknut	2
37	B31 B33	42-6040	Rear wheel adjusting screw	2
38	B31 B33	42-4841	Footrest stud securing nut	1
39	B31 B33	42-4842	Footrest stud washer	1
40	B31 B33	66-5524	Footrest stud washer	1
41	B31 B33	42-4854	Footrest bracket (nearside)	1
42	B31 B33	42-4557	Footrest distance tube complete (nearside)	1

REAR SUSPENSION and CENTRAL STAND B31 B33 (Swinging Arm)

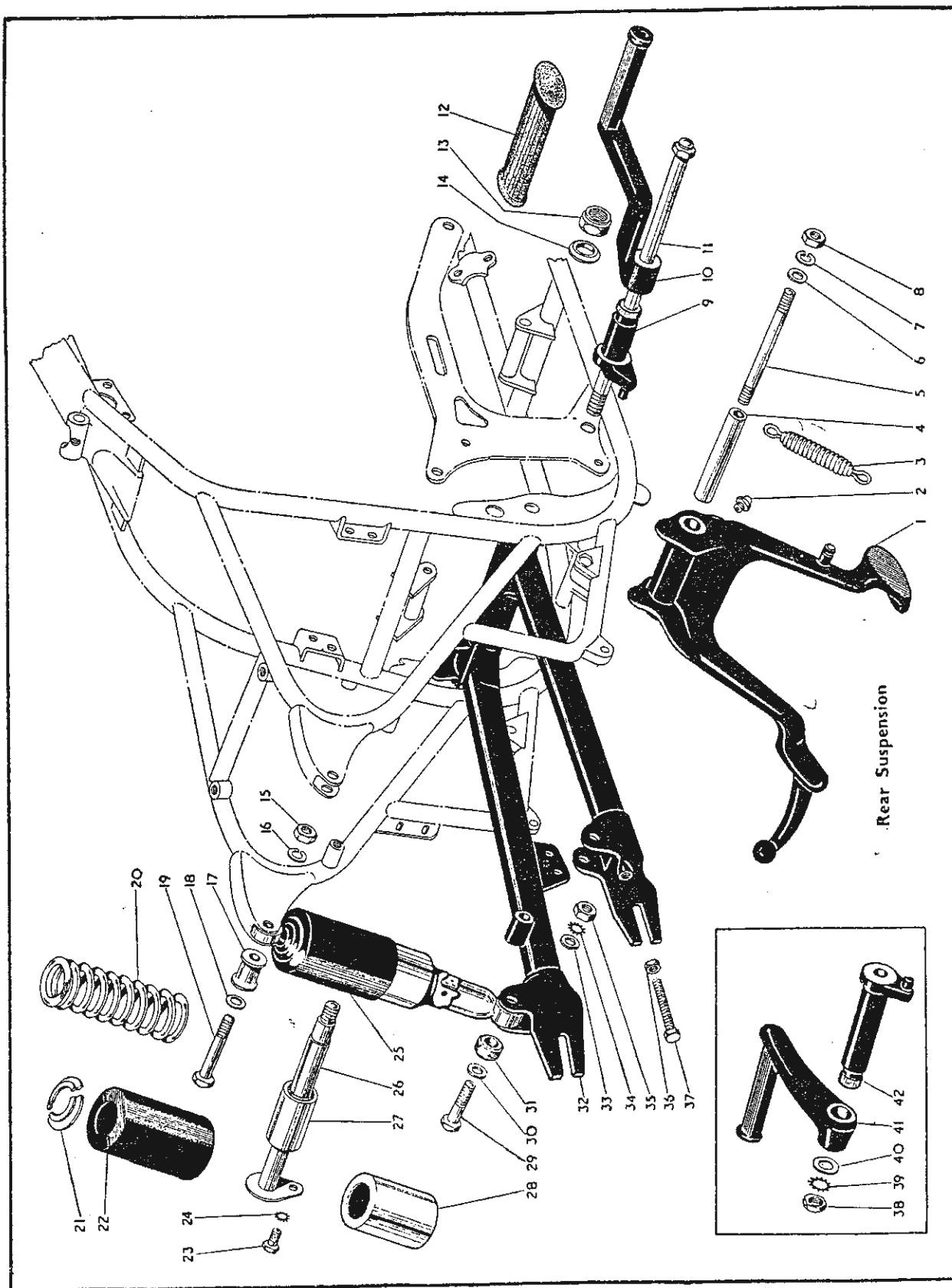

Rear
Suspension
and
Central Sta

Front L
and R

F

Mudguard
Oil Tap
Silencer
Toolbox

Pe
H
nd

Leg

Legsfield
Front
Safety

Front and
Safety E
Carrier
Handle

Electrical
Equipment
Tools

Plate 7

FRONT FORK and FITTINGS

B31 B33 (Swinging Arm)

Plate Ref. Number.	Models.	Part No.	Description.	Number per set.
—	B31 B33	42-5070	Front fork assembled complete (less steering damper)	1
—	B31 B33	42-5071	Front fork assembled complete (with steering damper)	As required
1	B31 B33	21-5371	Headlamp adjusting screw	2
2	B31 B33	42-5099	Headlamp adjusting screw washer	2
3	B31 B33	21-5164	Headlamp adjusting screw nut	2
4	B31 B33	42-5094	Headlamp cowl complete	1
5	B31 B33	45-5097	Headlamp cowl mounting ring	1
6	B31 B33	2-360	Headlamp cowl fixing screw	4
7	B31 B33	29-3319	Headlamp cowl fixing screw washer	4
8	B31 B33	2-47	Headlamp screw fixing screw nut	4
9	B31 B33	42-5090	Front fork cover complete	1
10	B31 B33	42-5093	Top yoke cover	1
10a	B31 B33	65-5332	Fork tube nut washer	2
11	B31 B33	65-5331	Fork tube nut	2
12	B31 B33	42-5035	Front fork top yoke	1
13	B31 B33	29-5315	Top yoke clip bolt nut	1
14	B31 B33	65-5446	Steering head lock grub screw	1
15	B31 B33	65-5445	Steering head lock	1
16	B31 B33	67-5024	Steering stem adjusting sleeve cap	1
17	B31 B33	67-5023	Steering stem adjusting sleeve	1
18	B31 B33	15-5155	Handlebar and yoke clip bolt washer	4
19	B31 B33	64-5334	Handlebar and yoke clip bolt	4
20	B31 B33	65-5333	Handlebar clip	2
21	B31 B33	27-5135	Fork top yoke clip bolt	1
22	B31 B33	66-5204	Steering head dust cap	1
23	B31 B33	65-5127	Steering head ball race cone (bottom)	1
24	B31 B33	65-5126	Steering head ball race cone (top)	1
25	B31 B33	1-4675	Steering head balls	40
26	B31 B33	42-5086	Fork bottom yoke	1
27	B31 B33	24-5160	Bottom yoke bolt nut	2
28	B31 B33	36-382	Bottom yoke bolt washer (shakeproof)	2
29	B31 B33	29-5289	Bottom yoke bolt	2
30	B31 B33	89-5061	Front fork shaft	2
31	B31 B33	29-5347	Front fork bottom bearing	2
32	B31 B33	29-5338	Fork shaft plug washer	2
33	B31 B33	29-5283	Fork shaft plug	2
34	B31 B33	42-5076	Fork sliding tube complete (O/S)	1
35	B31 B33	42-5084	Fork end cap bolt	4
36	B31 B33	35-33	Fork end cap bolt washer	4
37	B31 B33	2-1309	Fork end drain plug	2
38	B31 B33	2-292	Fork end drain plug washer (fibre)	2
39	B31 B33	42-5078	Fork sliding tube complete (N/S)	1
40	B31 B33	65-5424	Front fork top bearing	2
41	B31 B33	29-5320	Fork top bearing circlip	2
42	B31 B33	29-5313	Front fork oil seal	2
43	B31 B33	29-5310/3...	Front fork oil seal holder	2
44	B31 B33	89-5036	Front fork spring (sidecar use)	2
44	B31 B33	65-5391	Front fork spring (solo)	2
45	B31 B33	29-541	Horn foot fixing bolt washer (Shakeproof)	2
46	B31 B33	2-204	Horn foot fixing bolt	2
47	B31 B33	24-6035	Steering damper knob washer (spring)	1
48	B31 B33	65-5380	Steering damper friction washer	2
49	B31 B33	65-5328	Steering damper centre.	1
50	B31 B33	25-5247	Steering damper star washer	1
51	B31 B33	42-5014	Steering damper anchor plate	1
52	B31 B33	2-49	Steering damper anchor plate bolt nut	1
53	B31 B33	36-382	Steering damper anchor plate bolt washer (shakeproof)	1
54	B31 B33	2-923	Steering damper anchor plate bolt washer (plain)	1
55	B31 B33	28-2338	Steering damper anchor plate bolt	1
56	B31 B33	67-5021	Steering damper adjusting rod complete	1
57	B31 B33	42-5089	Fork end cap	2

FRONT FORK and FITTINGS

B31 B33 (Swinging Arm)

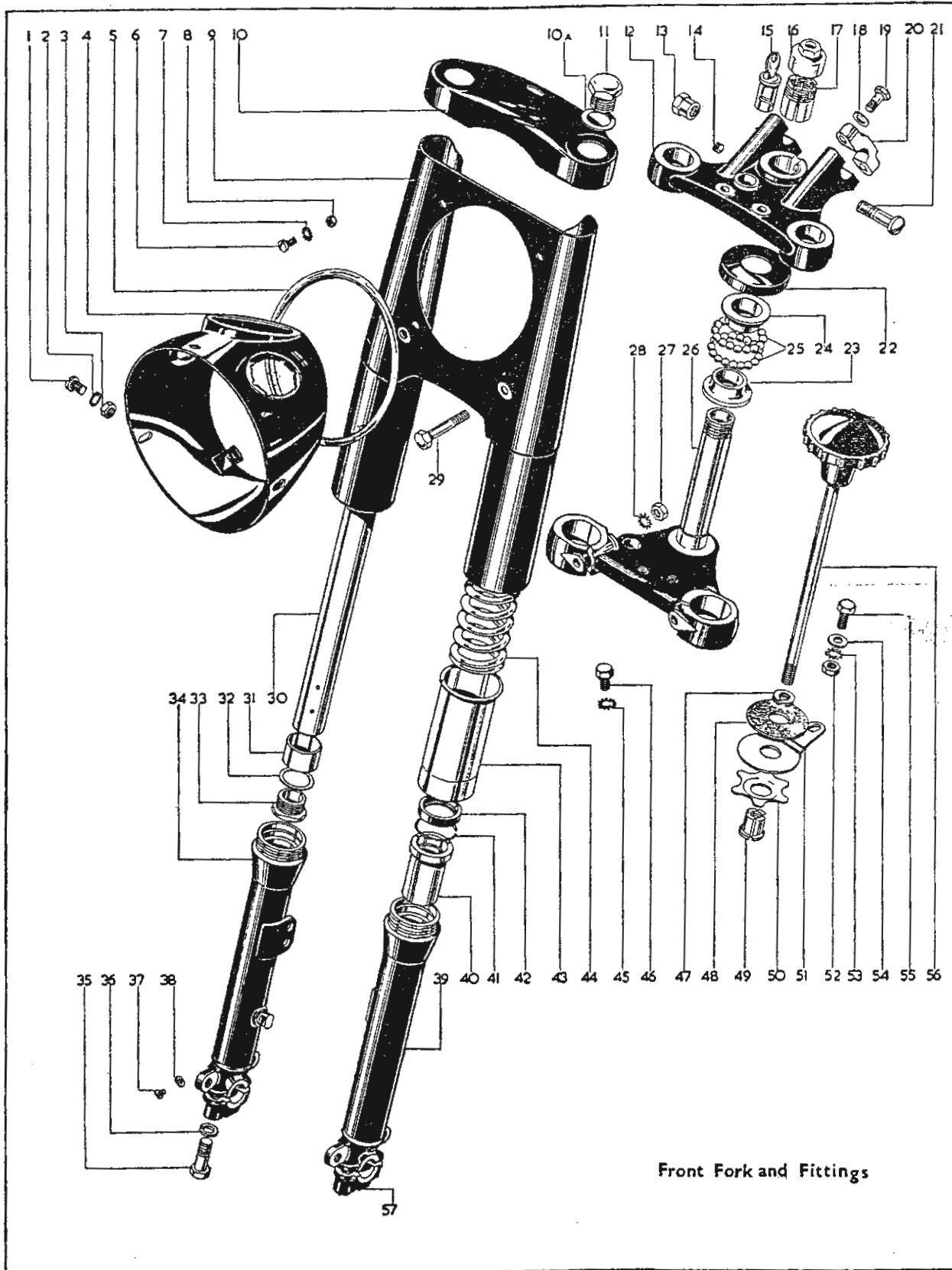

Front Fork and Fittings

Front Fork and Fittings

F

Mudguard
Oil Tank
Silence
Tool

Pe
H
nd

Le

Legs
Pr
Safet

Front Fork
Safet
Carri
Har

Electri
Equipm
Tools

Plate 8

FRONT HUB and WHEEL FITTINGS

B31 B33 (Swinging Arm)

Plate Ref. Number.	Models.	Part No.	Description.	Number per set.
—	B31 B33	42-5809	Front hub with rim and spoke assembly	1
1	B31 B33	42-5843	Front wheel cover plate	1
2	B31 B33	42-5821	Bearing dust cover circlip	1
3	B31 B33	42-5820	Bearing dust cover	1
4	B31 B33	42-5811	Front wheel spoke	40
5	B31 B33	42-5810	Front wheel rim	1
6	B31 B33	42-5812	Front wheel spoke nipple	40
7	B31 B33	42-5814	Front hub	1
8	B31 B33	42-5837	Front brake shoe with lining	2
9	B31 B33	42-5839	Brake shoe lining	2
10	B31 B33	42-5824	Front wheel spindle	1
11	B31 B33	42-5863	Front brake fulcrum pin	1
12	B31 B33	42-5822	Bearing backing ring	1
13	B31 B33	42-5819	Front wheel bearing	2
14	B31 B33	42-5823	Bearing retaining ring	1
15	B31 B33	42-5827	Front brake anchor plate	1
16	B31 B33	42-5842	Front wheel spindle nut	1
17	B31 B33	3-1049	Front brake fulcrum pin washer	1
18	B31 B33	42-5864	Front brake fulcrum pin nut	1
19	B31 B33	2-449	Front brake cam spindle nut	1
20	B31 B33	24-5914	Front brake cam spindle washer	1
21	B31 B33	42-5836	Front brake lever and cable toggle pin	1
22	B31 B33	35-701	Front brake lever pivot pin split pin	1
23	B31 B33	42-5854	Front brake lever	1
24	B31 B33	42-5830	Front brake cam	1
26	B31 B33	42-5840	Brake shoe lining rivet	16
27	B31 B33	42-5841	Brake shoe spring	2

Plate 9

REAR HUB and WHEEL FITTINGS

B31 B33 (Swinging Arm)

Plate Ref. Number.	Models.	Part No.	Description.	Number per set.
—	B31 B33	42-6311	Rear hub with rim and spoke assembly	1
1	B31 B33	42-6077	Rear hub fixed spindle nut	1
2	B31 B33	42-6078	Rear hub fixed spindle washer	1
3	B31 B33	42-6324	Rear hub fixed spindle distance collar	1
4	B31 B33	42-6333	Rear hub sprocket complete	1
5	B31 B33	42-9033	Transmission chain (rear)	1
6	B31 B33	89-3022	Rear hub sprocket bearing	1
7	B31 B33	42-6105	Rear hub grease retainer	1
8	B31 B33	42-6325	Rear hub fixed spindle	1
9	B31 B33	42-6328	Dust cover	1
10	B31 B33	42-5810	Rear wheel rim	1
11	B31 B33	42-6313	Rear hub	1
12	B31 B33	42-5839	Rear brake shoe lining	2
13	B31 B33	42-5841	Rear brake shoe spring	2
14	B31 B33	42-5837	Rear brake shoe with lining	2
15	B31 B33	42-6329	Bearing abutment ring	1
16	B31 B33	42-6323	Spindle distance piece	1
17	B31 B33	42-5819	Rear hub bearing	1
18	B31 B33	42-6335	Bearing retaining ring	1
19	B31 B33	42-6314	Rear brake anchor plate with stud and locknut	1
20	B31 B33	42-5828	Rear brake fulcrum pin	1
21	B31 B33	2-2138	Rear brake fulcrum pin washer	1
22	B31 B33	40-162	Rear brake fulcrum pin domed nut	1
23	B31 B33	42-6330	Rear hub anchor plate distance collar	1

B31 B33 (Swinging Arm)

Plate Ref. Number.	Models.	Part No.	Description.	Number per set.
24	... B31 B33	42-6336	Rear hub spindle washer	1
25	... B31 B33	42-6320	Rear hub spindle complete	1
26	... B31 B33	3-855	Anchor strap swinging arm bolt	1
27	... B31 B33	35-705	Anchor strap swinging arm split pin	1
28	... B31 B33	66-4708	Anchor strap swing arm bolt washer	1
29	... B31 B33	15-431	Anchor strap swinging arm washer (plain)	1
30	... B31 B33	24-5860	Anchor strap swinging arm bolt nut	1
31	... B31 B33	15-541	Rear anchor plate stud nut	1
32	... B31 B33	15-716	Rear anchor plate washer	1
33	... B31 B33	42-6084	Rear brake anchor strap	1
34	... B31 B33	42-5836	Rear brake lever and cable toggle pivot pin	1
35	... B31 B33	35-701	Rear brake lever pivot pin split pin	1
36	... B31 B33	2-449	Rear brake cam spindle nut	1
37	... B31 B33	24-5914	Rear brake cam spindle washer	1
38	... B31 B33	42-6317	Rear brake lever	1
39	... B31 B33	42-5830	Rear brake cam assembly	1
40	... B31 B33	42-6326	Rear hub sprocket bolt	4
41	... B31 B33	42-5840	Rear brake shoe rivet	16
42	... B31 B33	42-5812	Rear wheel spoke nipple	40
43	... B31 B33	42-5811	Rear wheel spoke	40
44	... B31 B33	42-6327	Rear hub sprocket bolt spherical nut	1

STANDARD BOLTS

All Bolts are C.E.I. unless otherwise stated

Part No.	Length under Head.	Thickness of Head.	Length of Thread.	Across Flats.	Diameter.
2-14	1:1/32"	3/16"	13/16"	.440" Hex.	1/4"
2-204	1/2"	3/16"	1/2"	.440" Hex.	1/4"
2-220	3/8"	3/16"	3/8"	.440" Hex.	1/4"
2-1354	.641"	.187"	.641"	.440" Hex.	1/4"
2-1402	7/8"	1/8"	3/8"	.440" Hex.	1/4"
2-2273	7/16"	5/32"	3/8"	.440" Hex.	1/4"
24-225	.750"	.187"	3/8"	.440" Hex.	1/4"
1-5069	.625"	.187"	.625"	.525" Hex.	5/16"
2-129	.750"	.250"	.625"	.440" Hex.	5/16"
2-1934	.750"	.156"	.625"	.440" Hex.	5/16"
2-6026	1.187"	.156"	.625"	.440" Hex.	5/16"
15-480	1.109"	.250"	.781"	.525" Hex.	5/16"
15-1355	1.500"	.218"	.625"	.525" Hex.	5/16"
15-7354	.625"	.156"	.625"	.440" Hex.	5/16"
27-6311	.750"	.125"	.625"	.440" Hex.	5/16"
28-2338	.718"	.218"	.687"	.525" Hex.	5/16"
24-649	.877"	.187"	.877"	.594" Hex.	3/8"
65-4185	2.687"	.250"	.750"	.504" Hex.	3/8"

B31 B33 (Swinging Arm)

Plate Ref. Number.	Models.	Part No.	Description.	Number per set.
1	B31 B33	67-6881	Rear number plate	1
2	B31 B33	67-6851	Rear number plate rubber extrusion	1
3	B31 B33	2-49	Oil tank tap fixing bolt nut	1
4	B31 B33	2-537	Oil tank top fixing bolt washer	2
5	B31 B33	42-8341	Oil tank tap fixing bolt rubber	1
6	B31 B33	42-8351	Oil tank fixing bracket	1
7	B31 B33	42-8331	Oil tank top fixing bolt spacing tube	1
8	B31 B33	42-8329	Oil tank front fixing bolt saddle washer	1
9	B31 B33	2-49	Oil tank front fixing bolt nut	1
10	B31 B33	2-537	Oil tank top fixing bolt washer	1
11	B31 B33	42-8341	Oil tank front fixing bolt rubber	1
12	B31 B33	42-8385	Oil tank fixing bolt	1
13	B31 B33	42-8340	Rocker feed pipe banjo locknut	1
14	B31 B33	2-2894	Rocker feed pipe banjo washer (fibre)	1
15	B31 B33	42-8331	Oil tank front fixing spacing tube	1
16	B31 B33	42-8339	Oil tank top fixing spacing tube	1
17	B31 B33	2-537	Oil tank top fixing bolt washer (plain)	1
18	B31 B33	29-5289	Oil tank top fixing bolt	1
19	B31 B33	42-8367	Oil tank with fixed fittings	1
20	B31 B33	42-8342	Oil tank mounting strip (rubber)	1
21	B31 B33	67-42	Oil tank filler cap washer	1
22	B31 B33	65-8500	Oil tank filler cap	1
23	B31 B33	29-4329	Support bridge bottom fixing and licence holder bolt	1
24	B31 B33	42-5101	Licence holder distance tube	1
25	B31 B33	2-923	Licence holder distance tube washer	1
26	B31 B33	2-204	Front mudguard support bridge screw	2
27	B31 B33	66-7518	Front mudguard support bridge washer (fibre)	2
28	B31 B33	2-1462	Front mudguard support bridge washer (spring)	2
29	B31 B33	27-8560	Front mudguard support bridge washer (plain)	2
30	B31 B33	2-2395	Front mudguard support bridge fixing screw nut	2
31	B31 B33	67-6543	Front mudguard with fixed fittings	1
32	B31 B33	2-204	Front mudguard stay fixing bolt	2
33	B31 B33	2-1462	Front mudguard stay fixing bolt washer (spring)	2
34	B31 B33	27-8560	Front mudguard stay fixing bolt washer (plain)	2
35	B31 B33	67-6547	Front mudguard stay insulator	2
36	B31 B33	42-6528	Front mudguard stay	1
37	B31 B33	24-8784	Front mudguard stay fork end washer (spring)	2
38	B31 B33	15-7354	Front mudguard stay fork end bolt...	2
39	B31 B33	2-2395	Front mudguard stay fork end bolt nut	2
40	B31 B33	28-2338	Support bridge fixing bolt (bottom)	3
41	B31 B33	36-382	Support bridge fixing bolt washer (shakeproof)	4
42	B31 B33	2-2395	Front mudguard stay fixing bolt nut	2
43	B31 B33	67-6548	Front mudguard bridge stay insulator	2
44	B31 B33	2-49	Support bridge fixing bolt nut (bottom)	4
45	B31 B33	65-6623	Front mudguard support bridge	1
46	B31 B33	15-447	Front stand mudguard fixing bolt nut	2
47	B31 B33	24-8784	Front stand fork end fixing bolt washer	2
48	B31 B33	15-7354	Front stand fork end fixing bolt	2
49	B31 B33	2-1354	Front stand mudguard fixing bolt	2
50	B31 B33	42-6530	Front stand	1
51	B31 B33	42-8426	Oil tank filter	1
52	B31 B33	42-8343	Oil tank filter washer (fibre)	1
53	B31 B33	42-8422	Oil tank return pipe	1
54	B31 B33	42-8422	Oil tank feed pipe	1
55	B31 B33	42-6853	Rear mudguard distance piece (rubber)	2
56	B31 B33	42-6759	Rear mudguard fixing clip	2
57	B31 B33	2-525	Rear mudguard fixing clip bolt washer	4
58	B31 B33	24-8328	Rear mudguard fixing clip bolt	4
59	B31 B33	2-49	Rear mudguard stay frame bracket bolt nut	4
60	B31 B33	24-8784	Rear mudguard stay frame bracket bolt washer	4
61	B31 B33	67-6761	Mudguard stay frame bracket (O/S)	1
61	B31 B33	67-6762	Mudguard stay frame bracket (N/S)	1
62	B31 B33	28-2338	Mudguard stay frame bracket bolt	4
63	B31 B33	2-923	Mudguard stay frame bracket bolt washer	4
64	B31 B33	24-8784	Mudguard stay frame bracket frame bolt washer	2
65	B31 B33	67-8313	Mudguard stay frame bracket bolt	2
66	B31 B33	42-6858	Rear mudguard stay (N/S)	1
66	B31 B33	42-6860	Rear mudguard stay (O/S)	1
67	B31 B33	24-8784	Rear mudguard stay fixing bolt washer	4
68	B31 B33	2-49	Mudguard stay fixing bolt nut	4

Mudguard
Oil Tank
Silencer
ToolboxPC
H
noLegshield
Front
SafetyFront and
Safety
Carrier
HandElectric
Equipment

Plate 10 MUDGUARDS, OIL TANK, SILENCER and TOOLBOX
B31 B33 (Swinging Arm)

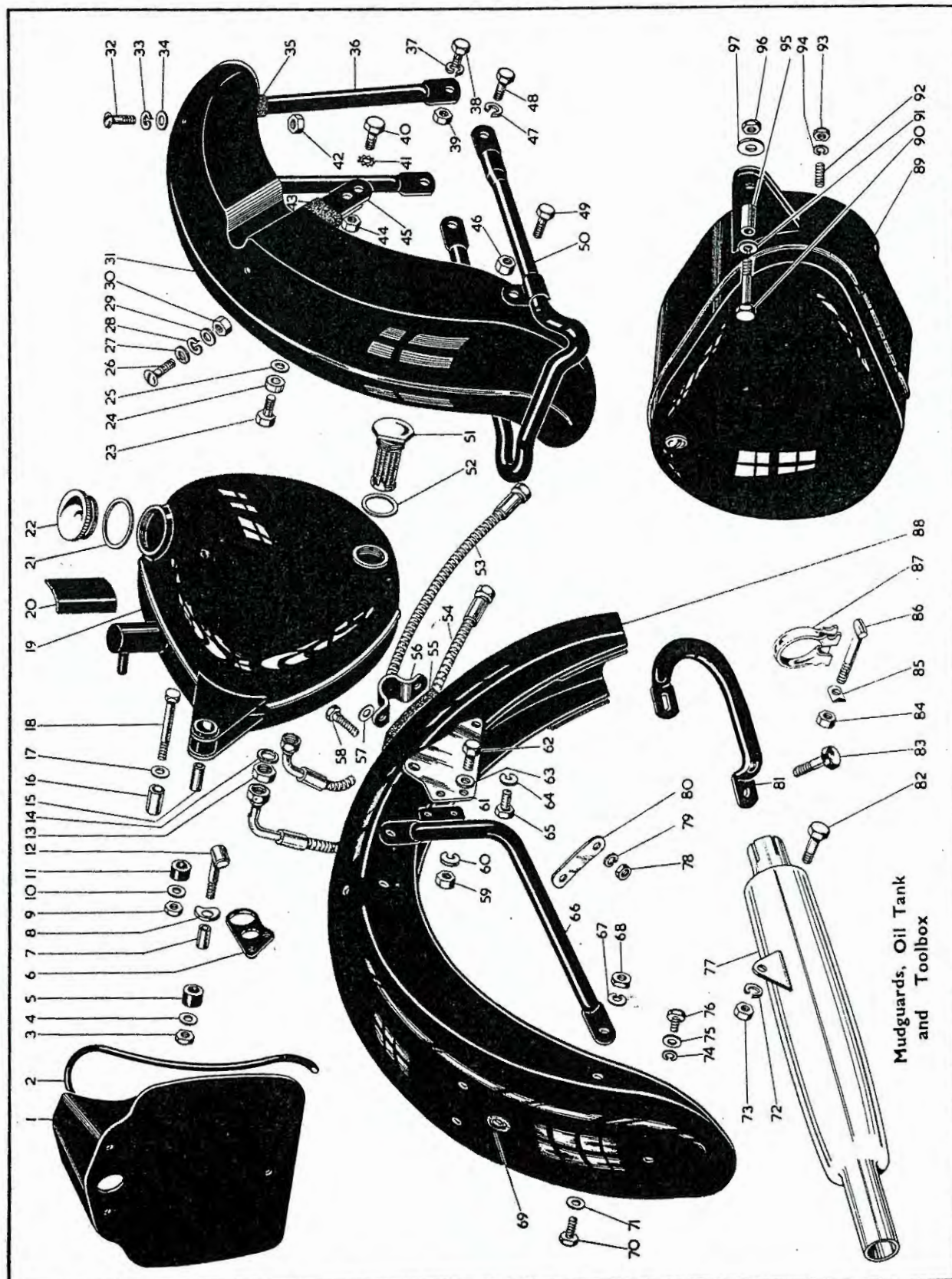

Plate 10—continued

MUDGUARDS, OIL TANK,
SILENCER and TOOLBOX

B31 B33 (Swinging Arm)

Plate Ref. Number.	Models.	Part No.	Description.	Number per set.
69	B31 B33	67-8839	Rear mudguard wiring grommet	2
70	B31 B33	28-2338	Mudguard stay fixing bolt	2
71	B31 B33	2-923	Mudguard stay fixing bolt washer	4
72	B31 B33	2-522	Silencer fixing bracket bolt washer	1
73	B31 B33	2-449	Silencer fixing bracket bolt nut	1
74	B31 B33	2-1462	Rear number plate fixing bolt washer	4
75	B31 B33	27-8560	Rear number plate fixing bolt washer (plain)	4
76	B31 B33	2-220	Rear number plate fixing bolt	4
77	B31 B33	42-2970	Silencer	1
78	B31 B33	2-2395	Mudguard fixing clip bolt nut	4
79	B31 B33	2-1462	Mudguard fixing clip bolt washer	4
80	B31 B33	42-6782	Mudguard stiffening plate	2
81	B31 B33	42-6865	Lifting handle	1
82	B31 B33	2-803	Silencer fixing bracket bolt	1
83	B31 B33	27-6037	Mudguard stay and lifting handle bolt	2
84	B31 B33	21-5102	Silencer and exhaust pipe clip nut	1
85	B31 B33	90-3064	Silencer and exhaust pipe clip swivel	1
86	B31 B33	90-3063	Silencer and exhaust pipe clip pin	1
87	B31 B33	42-2861	Silencer and exhaust pipe clip	1
88	B31 B33	42-6856	Rear mudguard with fixed fittings	1
89	B31 B33	42-9189	Toolbox complete with fixed fittings	1
90	B31 B33	29-4329	Toolbox fixing bolt (top)	1
91	B31 B33	24-8784	Toolbox fixing bolt washer (spring)	1
92	B31 B33	65-5368	Toolbox fixing stud	2
93	B31 B33	2-49	Toolbox fixing stud nut	2
94	B31 B33	24-8784	Toolbox fixing stud washer (spring)	2
95	B31 B33	42-8339	Toolbox fixing bolt distance tube (top)	1
96	B31 B33	2-49	Toolbox fixing bolt nut (top)	1
97	B31 B33	27-5676	Toolbox fixing bolt washer (top)	1

STANDARD BOLTS

All Bolts are C.E.I. (Screwdriver slotted) unless otherwise stated

Part No.	Length under Head.	Thickness of Head.	Length of Thread.	Across Head.	Diameter.
1-4806	.500"	.125"	.500"	.312"	3/16"
3-360	.406"	.078"	.406"	.312"	3/16"
2-498	.312"	.062"	.312"	.312"	3/16" Whit.
2-1309	.343"	.062"	.343"	.312"	3/16"
2-2582	.343"	.125"	.343"	.250"	3/16" Whit.
24-7065	.250"	.062"	.250"	.312"	3/16"
2-77	.312"	.062"	.312"	.375"	1/4"
2-79	.500"	.109"	.500"	.375"	1/4"
2-510	.658"	.093"	.375"	.375"	1/4"
2-1500	.687"	.109"	.375"	.375"	1/4"
2-2210	.718"	.062"	.562"	.562"	1/4"
2-3718	.658"	.109"	.658"	.375"	1/4"
15-7161	.500"	.125"	.312"	.500"	1/4"
2-2980	1.25"	.93"	.625"	.562"	5/16"

PETROL TANK, HANDLEBAR and DUAL SEAT B31 B33 (Swinging Arm)

Plate Ref. Number.	Models.	Part No.	Description.	Number per set.
1	B31 B33	65-8516	Throttle twist grip control (less cables cover)	1
2	B31 B33	42-8655	Combined front brake and air control complete	1
3	B31 B33	42-8726	Front brake cable and cover complete	1
4	B31 B33	65-8813	Throttle cable and cover complete	1
5	B31 B33	42-8693	Air control cable and cover complete	1
6	B31 B33	65-4960	Handlebar	1
7	B31 B33	65-8502	Dummy grip (L/H bar)	1
8	B31 B33	29-8820	Clutch control complete (less cable and cover)	1
9	B31 B33	66-8513	Exhaust control complete (less cable and cover)	1
10	B31 B33	65-8795	Exhaust lifter cable and cover complete	1
11	B31 B33	65-8680	Clutch control cable and cover complete	1
12	B31 B33	29-7898	Petrol tank filler cap	1
13	B31 B33	42-8034	Petrol tank badge clip screw nut	4
14	B31 B33	42-8020	Petrol tank badge clip	2
15	B31 B33	2-79	Knee grip screw	4
16	B31 B33	65-8220	Petrol tank badge	2
17	B31 B33	65-8317	Petrol tank badge clip screw	4
18	B31 B33	42-8051	Petrol tank rubber (top tube)	2
19	B31 B33	42-8052	Petrol tank anti-roll rubber	2
20	B31 B33	65-8206	Knee grip (N/S)	1
20	B31 B33	65-8205	Knee grip (O/S)	1
21	B31 B33	2-923	Petrol tank stiffening plate stud washer	2
22	B31 B33	2-49	Petrol tank stiffening plate stud nut	2
23	B31 B33	36-382	Petrol tank stiffening plate stud washer	2
24	B31 B33	42-8058	Petrol tank stiffening plate	1
25	B31 B33	24-8504	Petrol tap washer (fibre) (.078")	As required
25	B31 B33	65-8218	Petrol tap washer (fibre) ($\frac{1}{16}$ ")	As required
25	B31 B33	65-8219	Petrol tap washer (fibre) ($\frac{1}{8}$ ")	As required
26	B31 B33	65-8216	Petrol tap	1
27	B31 B33	42-9060	Dual seat front support pin	1
28	B31 B33	15-645	Dual seat front support pin bolt	1
29	B31 B33	28-2338	Dual seat fixing bolt	2
30	B31 B33	2-923	Dual seat fixing bolt washer	2
31	B31 B33	35-33	Dual seat fixing bolt washer (spring)	2
32	B31 B33	42-9058	Dual seat front support bracket	1
33	B31 B33	42-9197	Dual seat support rubber	2
34	B31 B33	42-8076	Petrol Pipe (plastic)	1
35	B31 B33	36-382	Mudguard bridge and dual seat bracket washer	2
36	B31 B33	2-49	Mudguard bridge and dual seat bracket nut	2
37	B31 B33	2-49	Dual seat rear fixing stud nut	2
38	B31 B33	42-9077	Dual seat rear fixing stud	2
39	B31 B33	42-9196	Dual seat rear support bracket	1
40	B31 B33	2-923	Mudguard bridge and dual seat bolt washer	2
41	B31 B33	28-2338	Mudguard bridge and dual seat fixing bolt	2
42	B31 B33	42-9072	Dual seat complete with brackets	1
—	B31 B33	42-9073	Dual seat loose fittings (sets)	1
43	B31 B33	42-8104	Petrol tank (4 gallon)	1
43	B31 B33	42-8043	Petrol tank (2 gallon)	As required.
44	B31 B33	42-8012	Petrol tank mounting rubber (top)	1
45	B31 B33	2-1945	Petrol tank fixing bolt washer	1
46	B31 B33	42-8011	Petrol tank fixing bolt	1
47	B31 B33	42-8010	Petrol tank rubber grommet	1

PISTONS

B31 B33 (Swinging Arm)

Model	Comp. Ratio	Pistons Complete			Compression Rings (2)			Scraper Rings		
		Standard	$\frac{1}{2}$ mm. O.S.	1mm. O.S.	Standard	$\frac{1}{2}$ mm. O.S.	1mm. O.S.	Standard	$\frac{1}{2}$ mm. O.S.	1mm. O.S.
B31	6.5	65-809	65-811	65-813	65-744	65-745	65-746	65-735	65-736	65-737
B33	7.5	65-1660	65-1662	65-1664	65-1250	65-1251	65-1252	65-1253	65-1254	65-1255

PETROL TANK, HANDLEBAR and DUAL SEAT

B31 B33 (Swinging Arm)

Petrol Tank,
Handlebar,
and Dual Seat

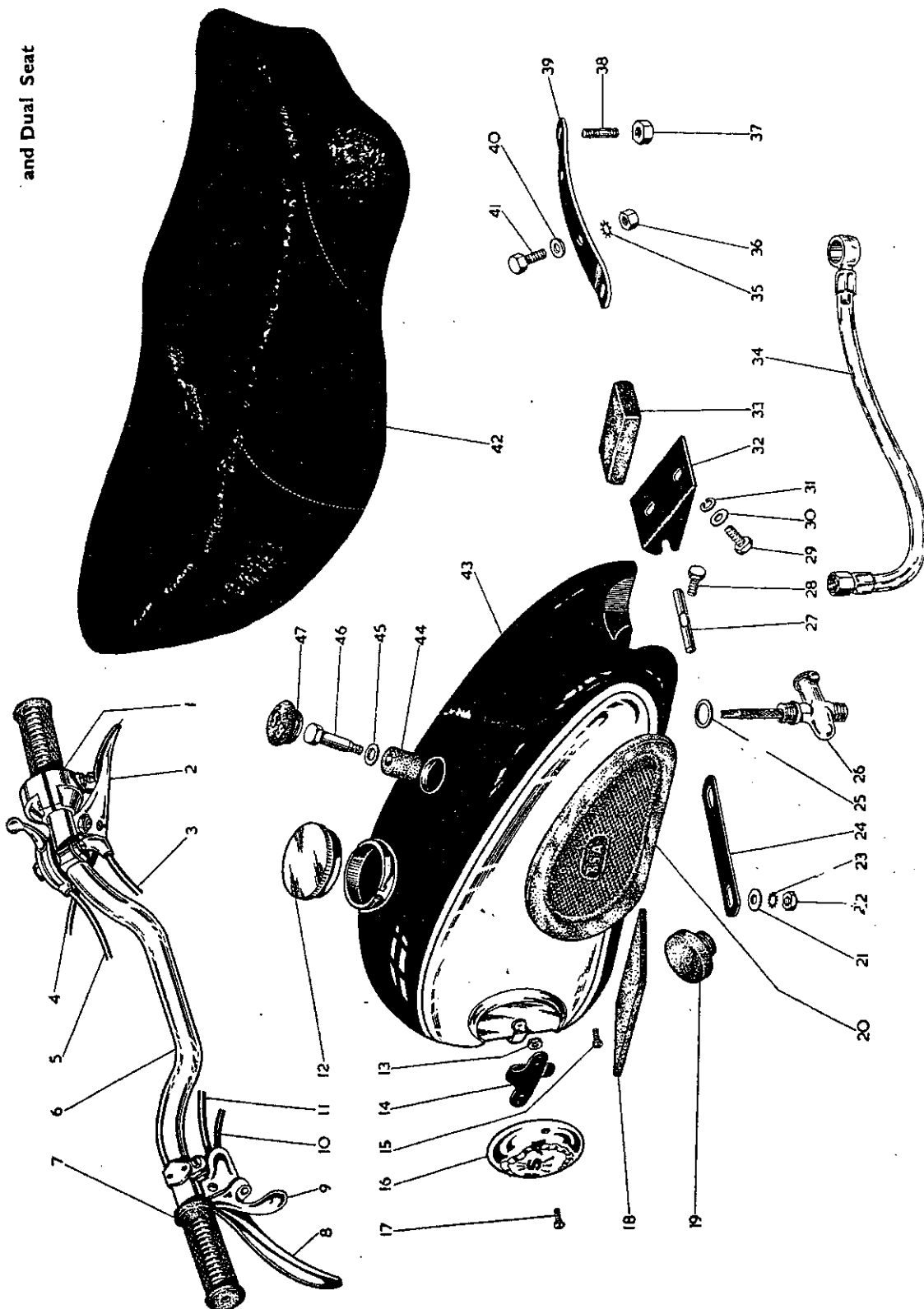

Legislation
From
Safety
Front and
Safety
Carriage
Electric
Equipment
Tools

Plate 12 CHAINGUARD, CHAINCASE and REAR BRAKE CONTROL

B31 B33 (Swinging Arm)

Plate Ref. Number.	Models.	Part No.	Description.	Number per set.
1	B31 B33	24-7343	Rear brake pedal bolt	1
2	B31 B33	24-978	Rear brake pedal bolt washer (spring)	1
3	B31 B33	42-7027	Rear brake pedal	1
4	B31 B33	42-4355	Rear brake pedal return spring	1
5	B31 B33	42-4349	Rear brake cross shaft	1
6	B31 B33	42-7032	Rear brake cable complete	1
7	B31 B33	42-7031	Rear brake cross shaft lever bolt	1
8	B31 B33	24-978	Rear brake cross shaft lever washer (spring)	1
9	B31 B33	42-4350	Rear brake cross shaft lever	1
10	B31 B33	42-8010	Chaincase rubber grommet	2
11	B31 B33	29-541	Chaincase securing bolt washer (S/Proof.)	6
12	B31 B33	24-7343	Chaincase securing bolt (top and bottom)	4
13	B31 B33	42-7715	Rear chaincase top section	1
14	B31 B33	2-525	Chaincase securing bolt washer	2
15	B31 B33	2-204	Chaincase securing bolt (rear)	2
16	B31 B33	29-541	Chaincase securing bolt washer (S/Proof.)	2
17	B31 B33	42-7730	Chainguard	1
18	B31 B33	42-7722	Rear chaincase rear section	1
19	B31 B33	42-7719	Rear chaincase bottom section	1
20	B31 B33	42-7727	Rear chaincase and footrest rubber sleeve	1
21	B31 B33	42-7710	Rear chaincase front section	1
22	B31 B33	29-541	Chaincase fixing bolt washer (S/Proof.)	1
23	B31 B33	2-1354	Chaincase fixing bolt	1
—	B31 B33	2-2899	Rear chaincase washer (top and bottom)	4

STANDARD NUTS

All Nuts are C.E.I. unless otherwise stated

Part No.	Across flats.	Thickness.	Size.	Part No.	Across Flats.	Thickness.	Size.
1-4616	.340" Hex.	.162"	3/16"	2-1813	.594" Hex.	.218"	3/8"
2-47	.312" Hex.	.140"	3/16"	3-720	.594" Hex.	.187"	3/8"
2-1588	.255" Hex.	.110"	3/16"	24-5161	.594" Hex.	.343"	3/8"
15-8147	.340" Hex.	.125"	3/16"	24-5764	.782" Hex.	.312"	3/8"
25-7151	.340" Hex.	.187"	3/16"	2-440	.594" Hex.	.312"	7/16"
1-6035	.340" Hex.	3/16"	1/4"	2-933	.525" Hex.	.375"	7/16"
2-51	.440" Hex.	.250"	1/4"	2-1925	.782" Hex.	.375"	7/16"
2-53	.440" Hex.	.109"	1/4" Whit.	15-152	.592" Hex.	.406"	7/16"
2-443	.440" Hex.	.109"	1/4"	15-541	.782" Hex.	.281"	7/16"
2-1027	.340" Hex.	1/8"	1/4"	24-5860	.594" Hex.	.187"	7/16"
2-2395	.440" Hex.	.187"	1/4"	25-4325	.919" Hex.	.540"	7/16"
2-49	.525" Hex.	.218"	5/16"	2-52	.919" Hex.	.406"	1/2"
2-833	.440" Hex.	.343"	5/16"	2-124	.782" Hex.	.203"	1/2"
2-1616	.440" Hex.	.125"	5/16"	24-7000	.782" Hex.	.250"	1/2"
15-5196	.525" Hex.	.281"	5/16"	27-6716	.782" Hex.	.187"	1/2"
15-6524	.525" Hex.	.175"	5/16"	2-835	.919" Hex.	.375"	9/16"
24-563	.440" Hex.	.187"	5/16"	15-1455	.782" Hex.	.218"	9/16"
24-6040	.525" Hex.	.156"	5/16"	24-4255	.919" Hex.	.187"	9/16"
1-1706	.594" Hex.	.250"	3/8"	28-53	.782" Hex.	.344"	9/16"
2-46	.594" Hex.	.312"	3/8"				

Plate 12 CHAINGUARD, CHAINCASE and REAR BRAKE CONTROL

B31 B33 (Swinging Arm)

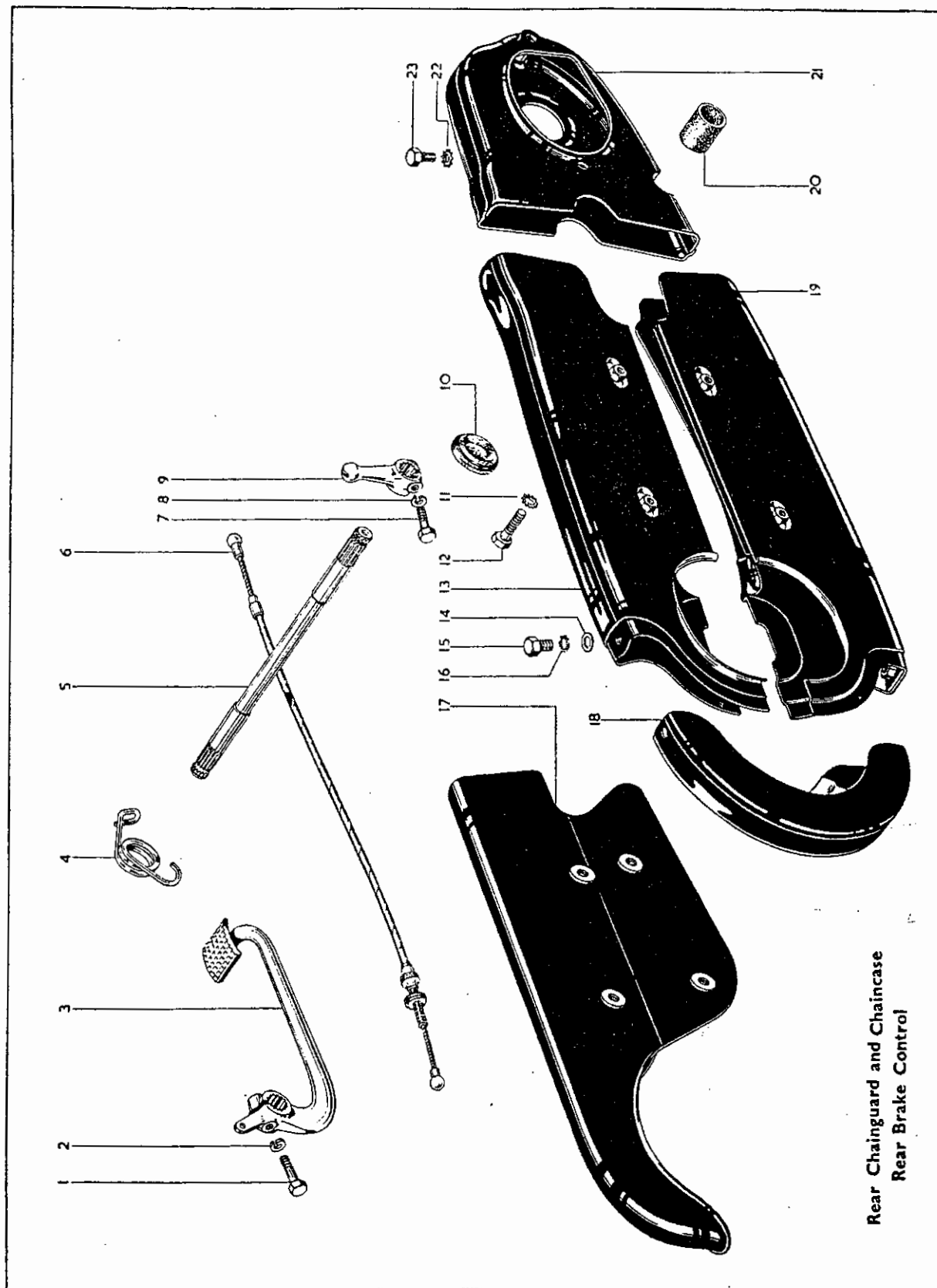

Rear Chainguard and Chaincase
Rear Brake Control

Plate 13

LEGSHIELDS

B31 B33 (Swinging Arm)

Plate Ref. Number.	Models.	Part No.	Description.	Number per set.
—	B31 B33	42-7219	Legshields assembled complete	1
1	B31 B33	42-7216	Legshield support tube complete (bottom)	2
2	B31 B33	15-7161	Legshield support tube clip screw	8
—	B31 B33	27-8560	Legshield support tube clip washer (plain)	8
—	B31 B33	2-2395	Legshield support tube clip nut	8
3	B31 B33	42-7207	Legshield (nearside)	1
4	B31 B33	67-7205	Legshield top cross tube adaptor	2
5	B31 B33	42-4906	Legshield front down tube split clamp	2
6	B31 B33	2-803	Legshield front down tube bolt	2
7	B31 B33	42-7210	Legshield top spacing sleeve	1
8	B31 B33	42-7211	Legshield top cross tube adaptor stud	1
9	B31 B33	42-7212	Legshield front down tube clamp eye bolt	2
10	B31 B33	66-7351	Legshield support tube complete (top) (1956)	2
11	B31 B33	2-522	Legshield front down tube bolt washer (spring)	4
12	B31 B33	2-46	Legshield front down tube bolt nut	4
13	B31 B33	2-2138	Legshield front down tube bolt washer (plain)	4
14	B31 B33	42-7206	Legshield (offside)	1
15	B31 B33	66-7353	Legshield support tube clip	8
16	B31 B33	27-5684	Crankcase and engine plate stud	1

STANDARD WASHERS (Plain)

Part No.	Outside Dia.	Inside Dia.	Thickness.	Part No.	Outside Dia.	Inside Dia.	Thickness.
1-1804	.680"	.385"	.072"	2-2580	.500"	.275"	.064"
2-130	.687"	.380"	.080"	3-3525	.562"	.218"	.048"
2-370	.625"	.317"	.156"	15-39	.843"	.505"	.064"
2-525	.500"	.255"	.048"	15-431	.750"	.442"	.064"
2-861	.750"	.380"	.081"	15-5155	.525"	.328"	.048"
2-923	.625"	.317"	.062"	24-594	.937"	.505"	.092"
2-1096	.375"	.192"	.044"	24-7911	.875"	.380"	.156"
2-1291	.750"	.522"	.080"	25-7180	1.00"	.281"	.048"
2-1374	.656"	.255"	.080"	26-9461	.562"	.203"	.048"
2-1945	.875"	.442"	.064"	27-5676	1.00"	.380"	.092"
2-2138	.750"	.380"	.064"	27-8560	.625"	.255"	.048"

LEGSHIELDS B31 B33 (Swinging Arm)

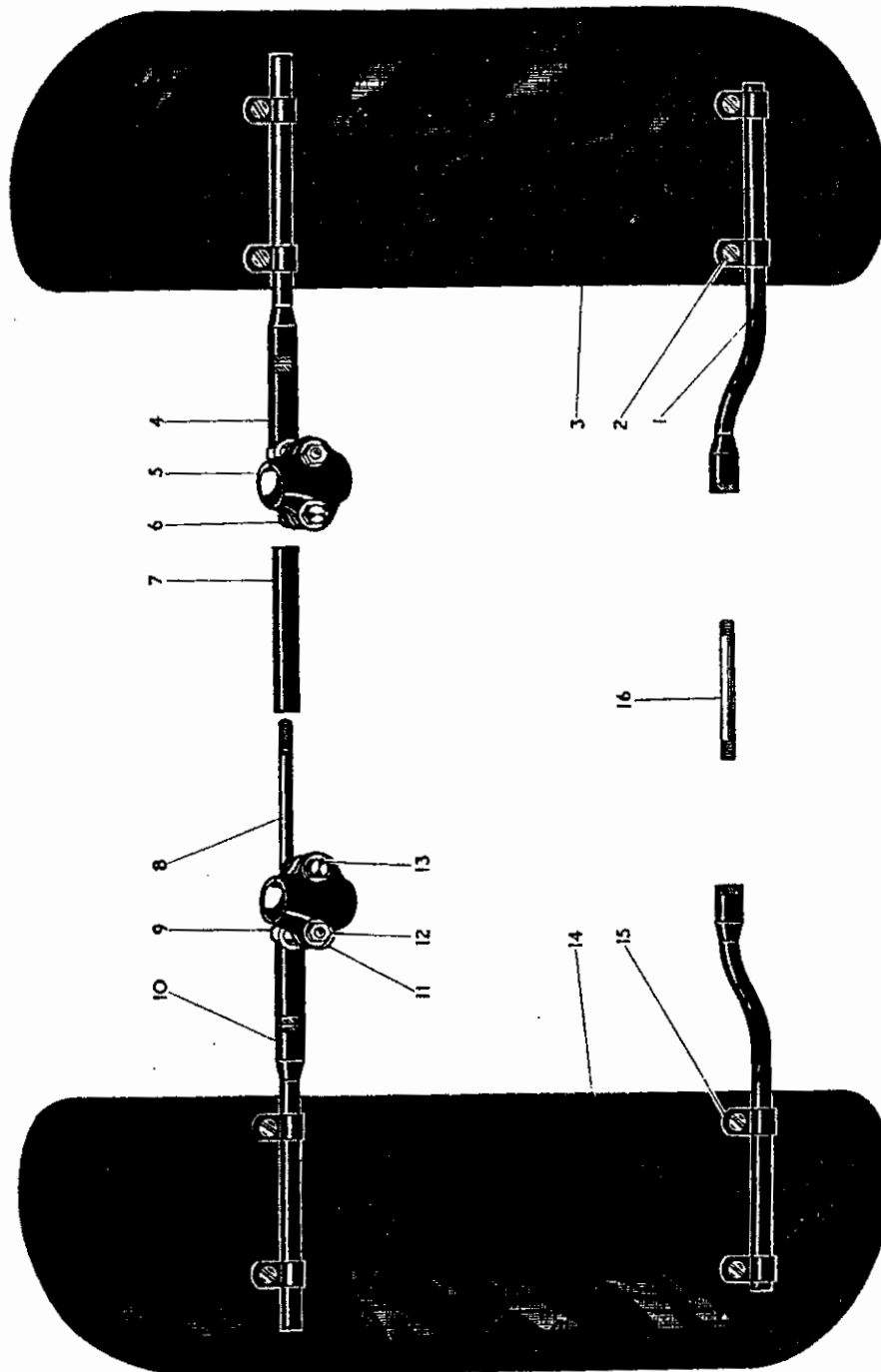

Legshields

Legshields
B31 B33
Safe
Front
Side
Elect
Equip
Tools

LEGSHIELDS and FRONT SAFETY BARS

B31 B33 (Swinging Arm)

Plate Ref. Number.	Models.	Part No.	Description.	Number per set.
—	B31 B33	42-7215	Legshield and front safety bar assembly	1
1	B31 B33	42-7211	Legshield top cross tube adaptor stud	1
2	B31 B33	42-7210	Legshield top spacing sleeve	1
3	B31 B33	67-7205	Legshield top cross tube adaptor	2
4	B31 B33	66-7351	Legshield support tube (top) complete	2
5	B31 B33	2-2395	Legshield support tube clip nut	8
6	B31 B33	27-8560	Legshield support tube clip washer (plain)	8
7	B31 B33	2-522	Legshield front down tube split clamp eye bolt washer (spring)	2
8	B31 B33	2-522	Front safety bar eye bolt washer (spring)	2
9	B31 B33	2-46	Front safety bar eye bolt nut	2
10	B31 B33	42-7212	Legshield front down tube clip clamp eye bolt	2
11	B31 B33	2-46	Front safety bar top fixing bolt nut	2
12	B31 B33	2-46	Front safety bar top fixing bolt nut	1
13	B31 B33	2-522	Front safety bar top fixing bolt washer (spring)	1
14	B31 B33	42-4905	Front safety bar eye bolt spacing tube	1
15	B31 B33	42-4904	Front safety bar eye bolt	2
16	B31 B33	65-4185	Front safety bar top fixing bolt	1
17	B31 B33	66-7353	Legshield support tube clip	8
18	B31 B33	42-4906	Legshield front support tube split clamp	2
19	B31 B33	66-7351	Legshield support tube complete (top)	2
20	B31 B33	42-7216	Legshield support tube complete (bottom)	2
21	B31 B33	15-7161	Legshield support tube clip screw	8
22	B31 B33	42-7206	Legshield (offside)	1
23	B31 B33	42-4900	Front safety bar assembly	1
24	B31 B33	42-4907	Front safety bar engine plate distance collar	2
25	B31 B33	42-7207	Legshield (nearside)	1

STANDARD WASHERS (Spring)

Part No.	Outer Dia.	Inside Dia.	Thickness.	Part No.	Outer Dia.	Inside Dia.	Thickness.
2-522	.750"	.390"	.056"	15-716	.937"	.453"	.064"
2-995	.656"	.380"	.040" double	24-978	.437"	.255"	.040"
2-1462	.593"	.255"	.040"	24-6035	.593"	.317"	.040" double
2-1967	.875"	.440"	.064"	27-6043	.750"	.437"	.046" double
2-2903	.562"	.406"	.062"	28-8784	.625"	.315"	.040"
3-110	.441"	.281"	.080"	35-33	.500"	.343"	.080"
3-111	.614"	.406"	.104"				

B31 B33 (Swinging Arm)

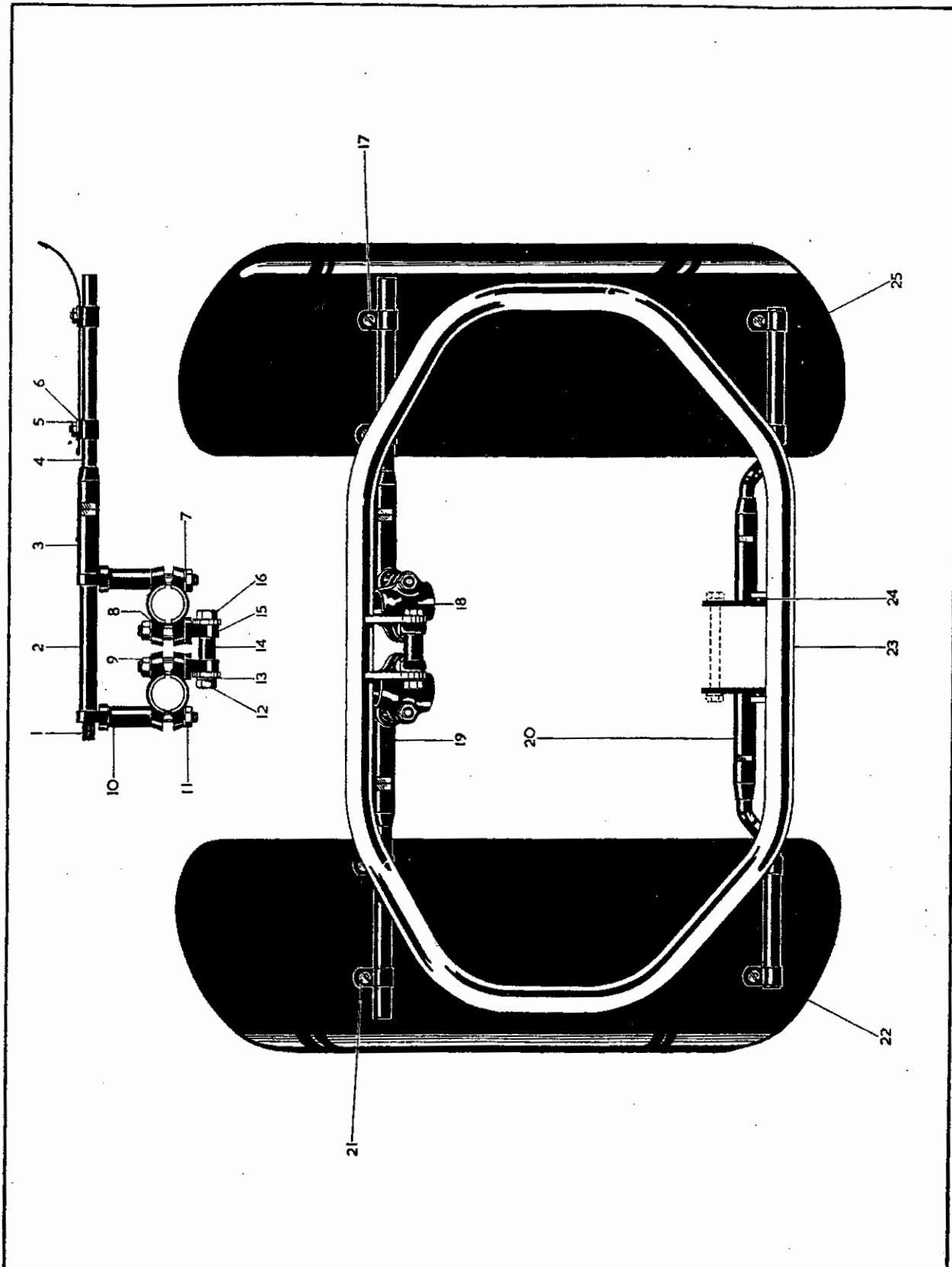

**Legible
Front
Safety
Carrier
Hazard
Warning
Labels
Electrical
Equipment
Tools**

Plate 15

FRONT and REAR SAFETY BARS, CARRIER and HANDRAIL B31 B33 (Swinging Arm)

Plate Ref. Number.	Models.	Part No.	Description.	Number per set.
—	B31 B33	42-4899	Front safety bar assembled complete with fittings	1
1	B31 B33	2-46	Front safety bar split clamp bolt nut	2
2	B31 B33	2-2903	Front safety bar split clamp bolt washer	2
3	B31 B33	2-803	Front safety bar split clamp bolt	2
4	B31 B33	42-4906	Front safety bar split clamp	2
5	B31 B33	42-4904	Front safety bar eye bolt	2
—	B31 B33	2-522	Front safety bar eye bolt washer (spring)	2
—	B31 B33	2-46	Front safety bar eye bolt nut	2
6	B31 B33	2-46	Front safety bar top fixing bolt nut	1
7	B31 B33	2-522	Front safety bar top fixing bolt washer (spring)	1
8	B31 B33	42-4905	Front safety bar eye bolt spacing tube	1
9	B31 B33	65-4185	Front safety bar fixing bolt (top)	1
10	B31 B33	42-4900	Front safety bar complete	1
11	B31 B33	42-4907	Front safety bar engine plate distance collar	2
12	B31 B33	42-4910	Rear safety bar complete (offside)	1
13	B31 B33	42-4914	Rear safety bar complete (nearside)	1
—	B31 B33	42-4909	Rear safety bar assembly	1
14	B31 B33	15-7161	Carrier fixing screw (rear) (for use with saddle)	2
15	B31 B33	2-525	Carrier fixing screw washer (rear) (plain) (for use with saddle)	2
16	B31 B33	2-1462	Carrier fixing screw washer (rear) (spring) (for use with saddle)	2
17	B31 B33	2-2395	Carrier fixing screw nut (rear) (for use with saddle)	2
18	B31 B33	42-6920	Carrier complete (for use with saddle)	1
19	B31 B33	27-6037	Carrier fixing screw (front) (for use with saddle)	2
20	B31 B33	24-6770	Handrail mudguard bolt	2
21	B31 B33	2-293	Handrail mudguard bolt washer (plain)	2
22	B31 B33	42-9172	Dual seat handrail complete	1
23	B31 B33	36-382	Handrail mudguard bolt washer (shakeproof)	2
24	B31 B33	2-49	Handrail mudguard bolt nut	2
25	B31 B33	2-49	Handrail mudguard stay bolt nut	2
26	B31 B33	24-8784	Handrail mudguard stay bolt washer (spring)	2
27	B31 B33	2-923	Handrail mudguard stay bolt washer (plain)	2
28	B31 B33	27-6037	Handrail mudguard stay bolt	2
—	B31 B33	65-4894	Pillion footrest anchor bolt (replaces 29-7560 when rear safety bars are fitted)	2

STANDARD WASHERS (Shakeproof)

Part No.	Outer Diameter.	Inside Diameter.	Part No.	Outer Diameter.	Inside Diameter.
29-541	1/2"	1/4"	36-399	11/16"	3/8"
29-3319	3/8"	3/16"	65-595	7/8"	1/2"
36-341	9/16"	5/16"	66-4707	11/16"	3/8"
36-382	9/16"	5/16"	66-4708	3/4"	7/16"

FRONT and REAR SAFETY BARS, CARRIER and HANDRAIL

B31 B33 (Swinging Arm)

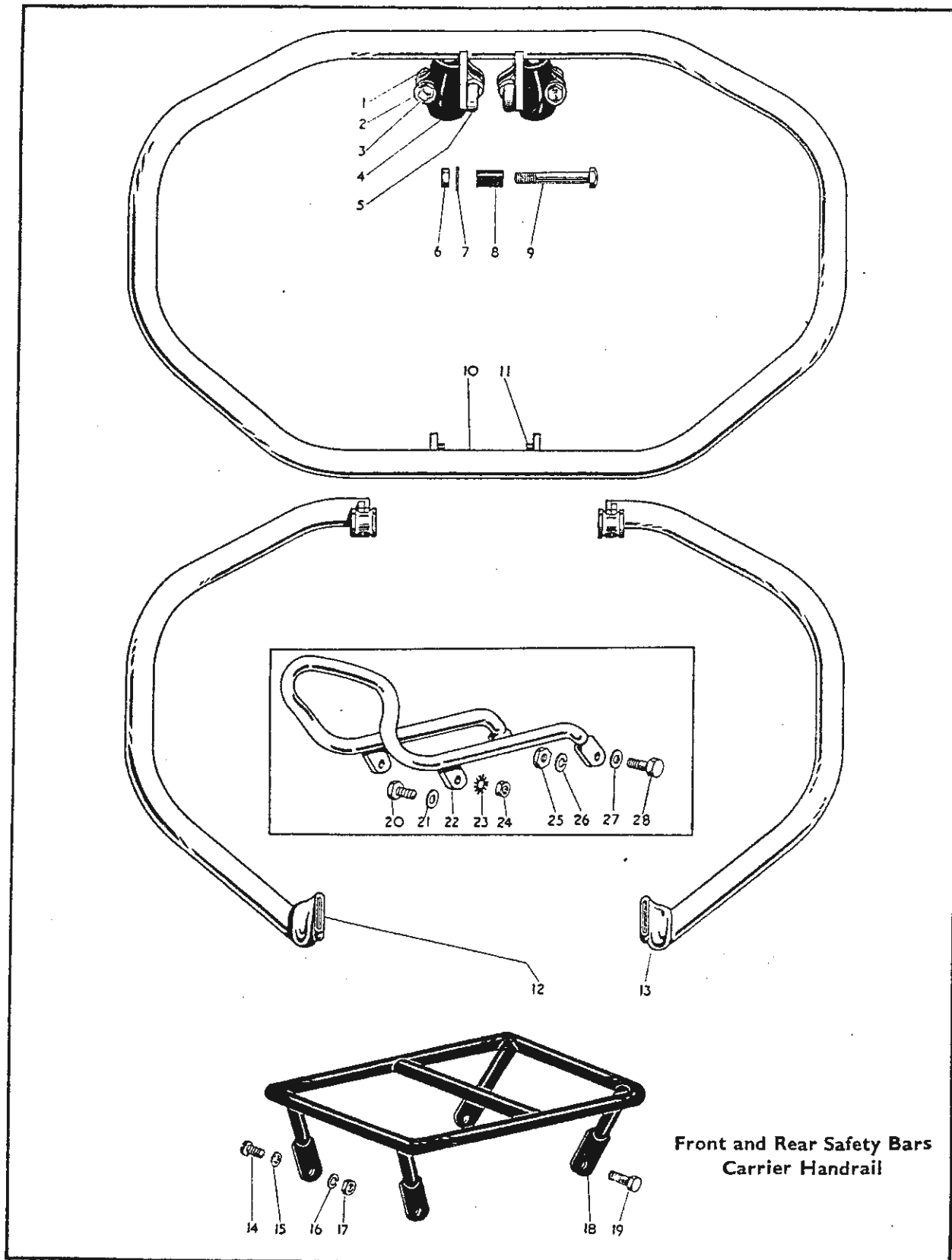

Front and Rear Safety Bars
Carrier Handrail

ELECTRICAL EQUIPMENT

B31 B33 (Swinging arm)

Plate Ref. Number.	Models.	Part No.	Description.	Number per set.
1	B31 B33	19-1639	Rectifier	1
2	B31 B33	24-8784	Rectifier fixing nut washer (spring)	1
3	B31 B33	2-49	Rectifier fixing nut	1
4	B31 B33	19-1666	Lighting switch	1
5	B31 B33	19-736	Cable harness (less switch)	1
6	B31 B33	42-9129	Stop light tension spring	1
7	B31 B33	2-47	Stop light switch screw nut	2
8	B31 B33	29-3319	Stop light switch screw washer (shakeproof)	2
9	B31 B33	19-1114	Stop light switch	1
10	B31 B33	2-1309	Stop light switch screw	2
11	B33	19-2136	Speedometer (120 m.p.h.) solo and sidecar	1
11	B31	19-2137	Speedometer (180 k.p.h.) solo	1
11	B31	19-2140	Speedometer (120 m.p.h.) sidecar	1
11	B31	19-2141	Speedometer (180 k.p.h.) sidecar	1
12	B31 B33	65-9267	Speedometer cable	1
13	B31 B33	19-1220	Distributor	1
13	B31 B33	19-1011	Stop tail lamp	1
14	B31 B33	66-9049	Cable clip (rubber)	15
15	B31 B33	19-2038	Horn bolt	2
16	B31 B33	19-2039	Horn bolt washer (spring)	2
17	B31 B33	19-2037	Horn foot distance piece	1
18	B31 B33	19-2036	Horn foot	1
19	B31 B33	19-2035	Electric horn	1
20	B31 B33	19-706	Horn push and dipper switch (standard handlebar)	1
20	B31 B33	19-709	Horn push and dipper switch (Western type handlebar)	1
21	B31 B33	2-2273	Coil fixing bolt	2
22	B31 B33	19-723	Coil	1
23	B31 B33	2-1462	Coil fixing bolt washer (spring)	2
24	B31 B33	2-2395	Coil fixing bolt nut	2
25	B31 B33	19-731	Headlamp reflector unit	1
26	B31 B33	19-609	Headlamp rim	1
27	B31 B33	19-1552	Battery	1
27	B31 B33	19-649	Ammeter	1

CARBURETTORS

B31 B33 (Swinging Arm)

Model	Type	Choke Size (inches)	Main Jet	Pilot Jet	Throttle Valve	Needle Position	Needle Jet	Engine End Size (inches)
B31 Home ...	376/81	1	260	30	376/3 $\frac{1}{2}$	2	.1065	1
B31 Export	376/82	1	200	30	376/3 $\frac{1}{2}$	2	.1065	1
B33 Home ...	376/85	1 $\frac{1}{16}$	260	25	376/3 $\frac{1}{2}$	3	.1065	1 $\frac{1}{16}$
B33 Export	376/84	1 $\frac{1}{16}$	210	25	376/3 $\frac{1}{2}$	3	.1065	1 $\frac{1}{16}$

ELECTRICAL EQUIPMENT

B31 B33 (Swinging Arm)

Electrical Equipment

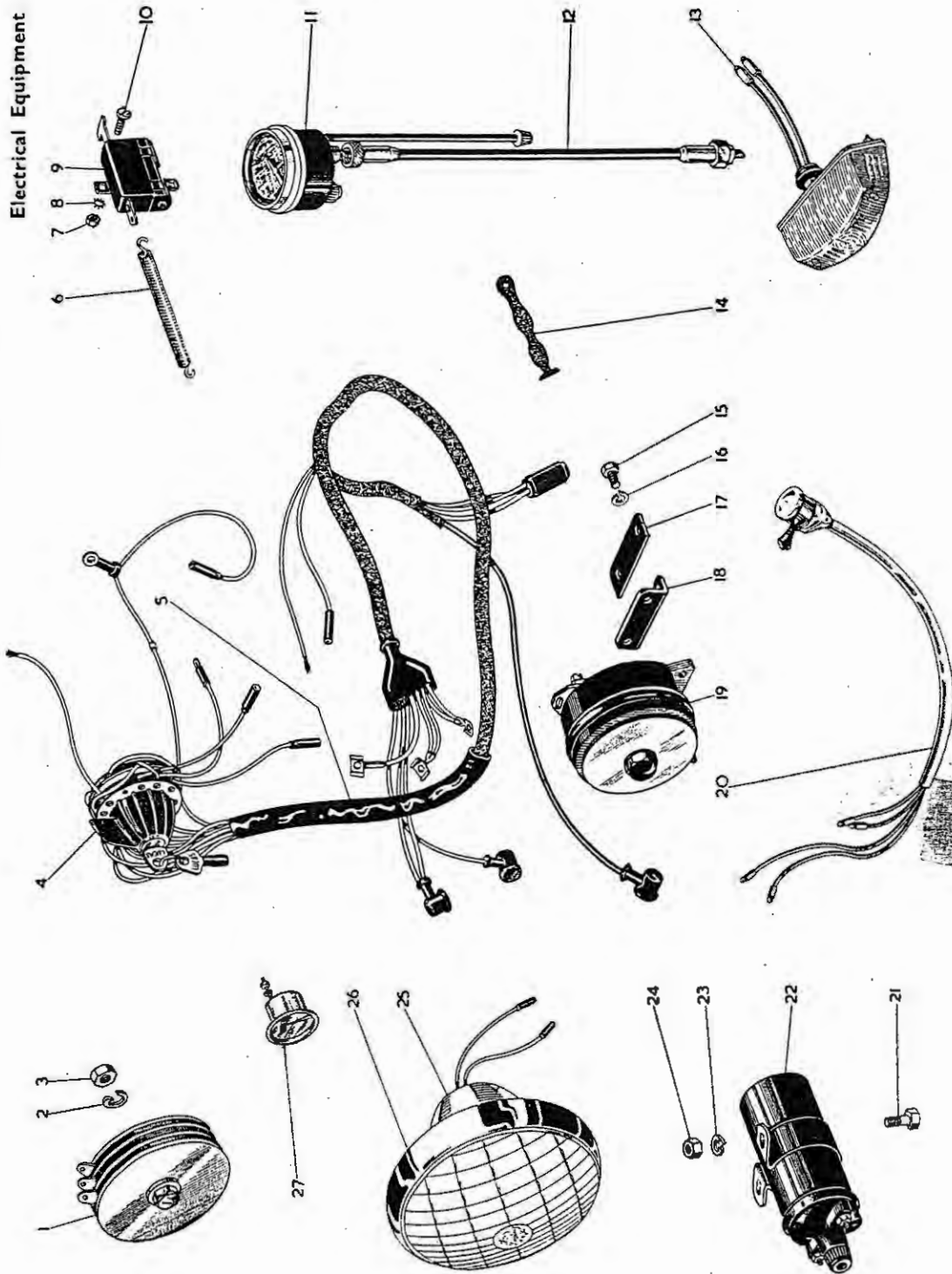

Plate 17

TOOLS and SUNDRIES

B31 B33 (Swinging Arm)

Plate Ref. Number.	Models.	Part No.	Description.	Number per set.
—	B31 B33	42-9185	Toolbag complete with tools	1
1	B31 B33	66-9132	Spark plug spanner	1
2	B31 B33	65-9246	Carburettor and tappet adjusting spanner	1
3	B31 B33	29-9253	Tommy bar	1
4	B31 B33	29-9254	Combination spanner	1
5	B31 B33	1-3051	Double ended spanner (B.S.A.)	1
6	B31 B33	66-9036	Box spanner	1
7	B31 B33	42-9026	Inflator	1
8	B31 B33	65-9115	Box spanner (small)	1
9	B31 B33	42-9080	Damper unit adjusting spanner	1
10	B31 B33	65-9132	Tappet adjusting spanner	1
11	B31 B33	29-9257	Box spanner	1
12	B31 B33	65-9282	Toolbag only	1
13	B31 B33	65-9133	Tappet adjusting spanner	1
14	B31 B33	65-9130	Tappet feelers (set)	1
15	B31 B33	65-9243	Front fork top nut and gland nut spanner	1
16	B31 B33	42-9195	Licence holder	1
17	B31 B33	42-9177	Clutch key and tyre lever	1
18	B31 B33	42-9186	Screwdriver and feeler (distributor)	1
19	B31 B33	29-9252	Tyre lever	1

Plate 17

TOOLS and SUNDRIES

B31 B33 (Swinging Arm)

