

- NO. 1 DISASSEMBLING, ADJUSTING, REPAIRS AND REPAIRS
NO. 2 DISASSEMBLING THE ENGINE, REPAIRS AND REPAIRS
NO. 3 DISASSEMBLING THE ENGINE, REPAIRS AND REPAIRS
NO. 4 DISASSEMBLING THE ENGINE, REPAIRS AND REPAIRS
NO. 5 DISASSEMBLING THE ENGINE, REPAIRS AND REPAIRS



SERVICE CHART

Removing the Engine Gearbox Unit and Complete Dismantling

Beagle
No. B2



1. REMOVAL OF ENGINE UNIT
Apply a suitable spacer to the end of the oil pump drive shaft and the engine unit and remove the engine unit.
Remove the oil pump drive shaft and the engine unit.
Remove the oil pump drive shaft and the engine unit.
Remove the oil pump drive shaft and the engine unit.



PETROL INJECTION

The petrol injection pump is a unit which is mounted on the side of the engine unit. It is a unit which is mounted on the side of the engine unit. It is a unit which is mounted on the side of the engine unit. It is a unit which is mounted on the side of the engine unit.



CLUTCH AND PERMANENT DRIVE

Remove the clutch spring screws and remove the clutch spring. Remove the clutch spring. Remove the clutch spring. Remove the clutch spring.



5. REMOVAL OF THE BRAKEPADS
Remove the brake pads from the brake drum. Remove the brake pads from the brake drum. Remove the brake pads from the brake drum. Remove the brake pads from the brake drum.



RING GAPS

If the piston rings are worn they will be too close to the cylinder wall. If the piston rings are worn they will be too close to the cylinder wall. If the piston rings are worn they will be too close to the cylinder wall. If the piston rings are worn they will be too close to the cylinder wall.



ATTENTION TO CYLINDER HEAD - REMOVAL OF VALVES

In order to remove the valves from the cylinder head, the valves must be removed. The valves must be removed. The valves must be removed. The valves must be removed.



REMOVAL OF PISTON

The piston and piston rings are now removed. The piston and piston rings are now removed. The piston and piston rings are now removed. The piston and piston rings are now removed.



REMOVAL OF PERMANENT DRIVE COVER

Remove the permanent drive cover from the side of the engine unit. Remove the permanent drive cover from the side of the engine unit. Remove the permanent drive cover from the side of the engine unit. Remove the permanent drive cover from the side of the engine unit.



REMOVAL OF PERMANENT DRIVE COVER

Remove the permanent drive cover from the side of the engine unit. Remove the permanent drive cover from the side of the engine unit. Remove the permanent drive cover from the side of the engine unit. Remove the permanent drive cover from the side of the engine unit.



PARTS AVAILABLE IN THIS SERIES

NO. 1 DISASSEMBLING, ADJUSTING, REPAIRING AND REPLACING PARTS

NO. 2 REPAIRING THE ENGINE CASE BODY AND MAIN COMPONENTS

NO. 3 OPERATING AND REPAIRING THE ENGINE-GARAGE UNIT

NO. 4 FRONT FORD, STEERING AND WHEELS

NO. 5 ALTERNATIVE UNIT REPLACEMENT PARTS



SERVICE CHART

Automotive Unit Replacement Parts

Beagle
No. B5

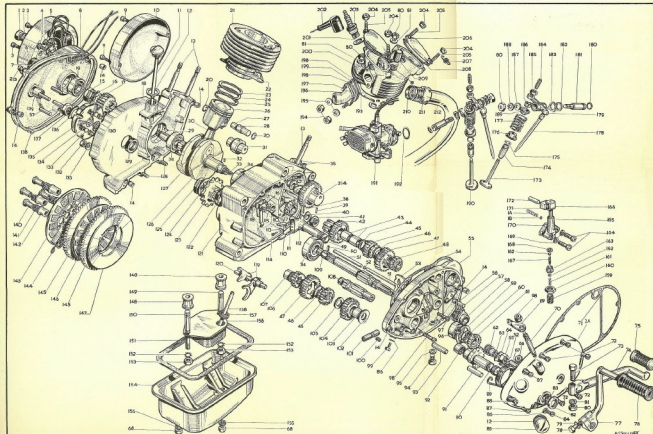

1A 1 00 13-010		2A 1 00 13-000		SPARE NUMBERS	
1	00 13-010	1	00 13-010	144	13-010
2	00 13-010	2	00 13-010	145	13-010
3	00 13-010	3	00 13-010	146	13-010
4	00 13-010	4	00 13-010	147	13-010
5	00 13-010	5	00 13-010	148	13-010
6	00 13-010	6	00 13-010	149	13-010
7	00 13-010	7	00 13-010	150	13-010
8	00 13-010	8	00 13-010	151	13-010
9	00 13-010	9	00 13-010	152	13-010
10	00 13-010	10	00 13-010	153	13-010
11	00 13-010	11	00 13-010	154	13-010
12	00 13-010	12	00 13-010	155	13-010
13	00 13-010	13	00 13-010	156	13-010
14	00 13-010	14	00 13-010	157	13-010
15	00 13-010	15	00 13-010	158	13-010
16	00 13-010	16	00 13-010	159	13-010
17	00 13-010	17	00 13-010	160	13-010
18	00 13-010	18	00 13-010	161	13-010
19	00 13-010	19	00 13-010	162	13-010
20	00 13-010	20	00 13-010	163	13-010
21	00 13-010	21	00 13-010	164	13-010
22	00 13-010	22	00 13-010	165	13-010
23	00 13-010	23	00 13-010	166	13-010
24	00 13-010	24	00 13-010	167	13-010
25	00 13-010	25	00 13-010	168	13-010
26	00 13-010	26	00 13-010	169	13-010
27	00 13-010	27	00 13-010	170	13-010
28	00 13-010	28	00 13-010	171	13-010
29	00 13-010	29	00 13-010	172	13-010
30	00 13-010	30	00 13-010	173	13-010
31	00 13-010	31	00 13-010	174	13-010
32	00 13-010	32	00 13-010	175	13-010
33	00 13-010	33	00 13-010	176	13-010
34	00 13-010	34	00 13-010	177	13-010
35	00 13-010	35	00 13-010	178	13-010
36	00 13-010	36	00 13-010	179	13-010
37	00 13-010	37	00 13-010	180	13-010
38	00 13-010	38	00 13-010	181	13-010
39	00 13-010	39	00 13-010	182	13-010
40	00 13-010	40	00 13-010	183	13-010
41	00 13-010	41	00 13-010	184	13-010
42	00 13-010	42	00 13-010	185	13-010
43	00 13-010	43	00 13-010	186	13-010
44	00 13-010	44	00 13-010	187	13-010
45	00 13-010	45	00 13-010	188	13-010
46	00 13-010	46	00 13-010	189	13-010
47	00 13-010	47	00 13-010	190	13-010
48	00 13-010	48	00 13-010	191	13-010
49	00 13-010	49	00 13-010	192	13-010
50	00 13-010	50	00 13-010	193	13-010
51	00 13-010	51	00 13-010	194	13-010
52	00 13-010	52	00 13-010	195	13-010
53	00 13-010	53	00 13-010	196	13-010
54	00 13-010	54	00 13-010	197	13-010
55	00 13-010	55	00 13-010	198	13-010
56	00 13-010	56	00 13-010	199	13-010
57	00 13-010	57	00 13-010	200	13-010
58	00 13-010	58	00 13-010	201	13-010
59	00 13-010	59	00 13-010	202	13-010
60	00 13-010	60	00 13-010	203	13-010
61	00 13-010	61	00 13-010	204	13-010
62	00 13-010	62	00 13-010	205	13-010
63	00 13-010	63	00 13-010	206	13-010
64	00 13-010	64	00 13-010	207	13-010
65	00 13-010	65	00 13-010	208	13-010
66	00 13-010	66	00 13-010	209	13-010
67	00 13-010	67	00 13-010	210	13-010
68	00 13-010	68	00 13-010	211	13-010
69	00 13-010	69	00 13-010	212	13-010
70	00 13-010	70	00 13-010	213	13-010
71	00 13-010	71	00 13-010	214	13-010
72	00 13-010	72	00 13-010	215	13-010
73	00 13-010	73	00 13-010	216	13-010
74	00 13-010	74	00 13-010	217	13-010
75	00 13-010	75	00 13-010	218	13-010
76	00 13-010	76	00 13-010	219	13-010
77	00 13-010	77	00 13-010	220	13-010
78	00 13-010	78	00 13-010	221	13-010
79	00 13-010	79	00 13-010	222	13-010
80	00 13-010	80	00 13-010	223	13-010
81	00 13-010	81	00 13-010	224	13-010
82	00 13-010	82	00 13-010	225	13-010
83	00 13-010	83	00 13-010	226	13-010
84	00 13-010	84	00 13-010	227	13-010
85	00 13-010	85	00 13-010	228	13-010
86	00 13-010	86	00 13-010	229	13-010
87	00 13-010	87	00 13-010	230	13-010
88	00 13-010	88	00 13-010	231	13-010
89	00 13-010	89	00 13-010	232	13-010
90	00 13-010	90	00 13-010	233	13-010
91	00 13-010	91	00 13-010	234	13-010
92	00 13-010	92	00 13-010	235	13-010
93	00 13-010	93	00 13-010	236	13-010
94	00 13-010	94	00 13-010	237	13-010
95	00 13-010	95	00 13-010	238	13-010
96	00 13-010	96	00 13-010	239	13-010
97	00 13-010	97	00 13-010	240	13-010
98	00 13-010	98	00 13-010	241	13-010
99	00 13-010	99	00 13-010	242	13-010
100	00 13-010	100	00 13-010	243	13-010
101	00 13-010	101	00 13-010	244	13-010
102	00 13-010	102	00 13-010	245	13-010
103	00 13-010	103	00 13-010	246	13-010
104	00 13-010	104	00 13-010	247	13-010
105	00 13-010	105	00 13-010	248	13-010
106	00 13-010	106	00 13-010	249	13-010
107	00 13-010	107	00 13-010	250	13-010
108	00 13-010	108	00 13-010	251	13-010
109	00 13-010	109	00 13-010	252	13-010
110	00 13-010	110	00 13-010	253	13-010
111	00 13-010	111	00 13-010	254	13-010
112	00 13-010	112	00 13-010	255	13-010
113	00 13-010	113	00 13-010	256	13-010
114	00 13-010	114	00 13-010	257	13-010
115	00 13-010	115	00 13-010	258	13-010
116	00 13-010	116	00 13-010	259	13-010
117	00 13-010	117	00 13-010	260	13-010
118	00 13-010	118	00 13-010	261	13-010
119	00 13-010	119	00 13-010	262	13-010
120	00 13-010	120	00 13-010	263	13-010
121	00 13-010	121	00 13-010	264	13-010
122	00 13-010	122	00 13-010	265	13-010
123	00 13-010	123	00 13-010	266	13-010
124	00 13-010	124	00 13-010	267	13-010
125	00 13-010	125	00 13-010	268	13-010
126	00 13-010	126	00 13-010	269	13-010
127	00 13-010	127	00 13-010	270	13-010
128	00 13-010	128	00 13-010	271	13-010
129	00 13-010	129	00 13-010	272	13-010
130	00 13-010	130	00 13-010	273	13-010
131	00 13-010	131	00 13-010	274	13-010
132	00 13-010	132	00 13-010	275	13-010
133	00 13-010	133	00 13-010	276	13-010
134	00 13-010	134	00 13-010	277	13-010
135	00 13-010	135	00 13-010	278	13-010
136	00 13-010	136	00 13-010	279	13-010
137	00 13-010	137	00 13-010	280	13-010
138	00 13-010	138	00 13-010	281	13-010
139	00 13-010	139	00 13-010	282	13-010
140	00 13-010	140	00 13-010	283	13-010
141	00 13-010	141	00 13-010	284	13-010
142	00 13-010	142	00 13-010	285	13-010
143	00 13-010	143	00 13-010	286	13-010
144	00 13-010	144	00 13-010	287	13-010
145	00 13-010	145	00 13-010	288	13-010
146	00 13-010	146	00 13-010	289	13-010
147	00 13-010	147	00 13-010	290	13-010
148	00 13-010	148	00 13-010	291	13-010
149	00 13-010	149	00 13-010	292	13-010
150	00 13-010	150	00 13-010	293	13-010
151	00 13-010	151	00 13-010	294	13-010
152	00 13-010	152	00 13-010	295	13-010
153	00 13-010	153	00 13-010	296	13-010
154	00 13-010	154	00 13-010	297	13-010
155	00 13-010	155	00 13-010	298	13-010
156	00 13-010	156	00 13-010	299	13-010
157	00 13-010	157	00 13-010	300	13-010
158	00 13-010	158	00 13-010	301	13-010
159	00 13-010	159	00 13-010	302	13-010
160	00 13-010	160	00 13-010	303	13-010
161	00 13-010	161	00 13-010	304	13-010
162	00 13-010	162	00 13-010	305	13-010
163	00 13-010	163	00 13-010	306	13-010
164	00 13-010	164	00 13-010	307	13-010
165	00 13-010	165	00 13-010	308	13-010
166	00 13-010	166	00 13-010	309	13-010
167	00 13-010	167	00 13-010	310	13-010
168	00 13-010	168	00 13-010	311	13-010
169	00 13-010	169	00 13-010	312	13-010
170	00 13-010	170	00 13-010	313	13-010
171	00 13-010	171	00 13-010	314	13-010
172	00 13-010	172	00 13-010	315	13-010
173	00 13-010	173	00 13-010	316	13-010
174	00 13-010	174	00 13-010	317	13-010
175	00 13-010	175	00 13-010	318	13-010
176	00 13-010	176	00 13-010	319	13-010
177	00 13-010	177	00 13-010	320	13-010
178	00 13-010	178	00 13-010	321	13-010
179	00 13-010	179	00 13-010	322	13-010
180	00 13-010	180	00 13-010	323	13-010
181	00 13-010	181	00 13-010	324	13-010
182	00 13-010	182	00 13-010	325	13-010
183	00 13-010	183	00 13-010	326	13-010
184	00 13-010	184	00 13-010	327	13-010
185	00 13-010	185	00 13-010	328	13-010
186	00 13-010	186	00 13-010	329	13-010
18					