

# CATALOGUE OF



ISSUED BY

**BSA** MOTOR CYCLES LTD.  
Service Department  
MONTGOMERY STREET  
BIRMINGHAM 11

TELEPHONE . . . BIRMINGHAM, VICTORIA 2234 (6 lines)  
TELEGRAMS . . . . . "SELSERV," BIRMINGHAM

All communications relating to Spare Parts or Repairs to B.S.A. Motor Cycles  
should be addressed to the above.

B-31 & B-33

Swing arm models

Late 50's & Early 60's

B.S.A. MOTOR CYCLES LTD.

Registered Offices and Works

ARMOURY ROAD, BIRMINGHAM, 11

Telephones: BIRMINGHAM VICTORIA 2381 (30 lines)

Telegrams and Cables: "SELMOTO, BIRMINGHAM"

Contractors to Her Majesty's Government, the War Office, the Admiralty, the Post Office, the Colonial and Foreign Governments

Copyright B.S.A. Co. Ltd.

Printed in England.

## 'B' GROUP GENERAL INDEX

|  | Pages  |
|--|--------|
| Air Cleaners ...                         | 24     |
| Battery Carrier ...                      | 24     |
| Carburettors and Settings ...            | 46     |
| Carrier ...                              | 45     |
| Central Stand ...                        | 26     |
| Chainguard and Chaincase (rear) ...      | 38     |
| Clutch and Front Chaincase ...           | 21-23  |
| Colour Finishes ...                      | 3      |
| Dual Seat and Fittings ...               | 36     |
| Engine (General) ...                     | 13-18  |
| Equipment (Electrical) ...               | 3, 46  |
| Equipment (Speedometers) ...             | 3      |
| Exhaust Pipes ...                        | 13     |
| Footrests ...                            | 26     |
| Frame and Fittings ...                   | 23-26  |
| Front Fork and Fittings ...              | 28     |
| Front Hub and Wheel Fittings ...         | 30     |
| Front Stand ...                          | 33     |
| Gearbox and Control Parts ...            | 18-21  |
| Handlebars and Controls ...              | 36     |
| Handrail ...                             | 44     |
| Legshields ...                           | 40     |
| Legshields and Safety Bars ...           | 42     |
| Mudguards and Fittings (Front) ...       | 33-35  |
| Mudguards and Fittings (Rear) ...        | 33-35  |
| Oil Tank and Fittings ...                | 33-35  |
| Overseas Distributors ...                | 9-12   |
| Petrol Tank and Fittings ...             | 36     |
| Pillion Footrests ...                    | 24     |
| Pistons ...                              | 15, 36 |
| Prop Stand ...                           | 24, 26 |
| Rear Brake Control ...                   | 38     |
| Rear Hub and Wheel Fittings ...          | 30-32  |
| Rear Suspension ...                      | 26     |
| Safety Bars (Front) ...                  | 44     |
| Safety Bars (Rear) ...                   | 44     |
| Silencer and Fittings ...                | 33-35  |
| Standard Bolts ...                       | 32     |
| Standard Bolts (Screwdriver Slotted) ... | 35     |
| Standard Nuts ...                        | 38     |
| Standard Washers (Plain) ...             | 40     |
| Standard Washers (Spring) ...            | 42     |
| Standard Washers (Shakeproof) ...        | 44     |
| Stockists ...                            | 4-8    |
| Toolbox and Fittings ...                 | 33-35  |
| Tools and Sundries ...                   | 48     |

Near Side - Left  
Off Side - Right

#### SUFFIX NUMBERS TO BE USED TO IDENTIFY VARYING FINISHES

|      |  |
|------|--|
| /001 | Cadmium  |
| /003 | Bright Chrome                                    |
| /007 | Black Enamel                                     |
| /017 | Chrome Plate, Black Lined Gold                   |
| /019 | Chrome Plate, Matt Silver Lined Red              |
| /021 | Polished Aluminium                               |
| /024 | Polychromatic Silver Beige                       |
| /026 | Chrome Plate and Silver Beige Lined Red          |
| /036 | Maroon and Chrome Lined Gold                     |
| /037 | Maroon only                                      |
| /038 | Metallic Green and Chrome Plate Lined Dark Green |
| /039 | Metallic Green                                   |
| /040 | Dark Green                                       |
| /041 | Chrome Rim and Maroon Hub                        |
| /042 | Chrome Rim and Dark Green Hub                    |
| /043 | Chrome Rim and Beige Hub                         |
| /044 | Chrome Rim and Black Hub                         |
| /078 | Brilliant Red and Chrome                         |
| /100 | Almond Green                                     |
| /101 | Gunmetal Grey                                    |
| /102 | Princess Grey                                    |

When ordering components with varying finishes, i.e., Petrol Tanks, Wheels, Rims, Brake Rods, Front Fork Oil Seal Holder — please state finish required by adding the appropriate suffix number to part number.

#### EXAMPLE. Petrol Tank

Metallic Green and Chrome Plate Lined Dark Green — 67-8104/038

---

#### SPARKING PLUGS

Champion Sparking Plugs Ltd., Feltham, Middlesex

---

#### ELECTRICAL EQUIPMENT

J. Lucas Ltd., Great King Street, Birmingham

---

#### SPEEDOMETERS

Smith's Motor Accessories, Cricklewood Works, London

## Plate 1

## ENGINE

## B31 B33 (Swinging Arm)

| Plate Ref.<br>Number. | Models. | Part No. | Description.                                    | Number<br>per set. |
|-----------------------|---------|----------|---|--------------------|
| 1                     | B31     | 65-1703  | Cylinder barrel                                 | 1                  |
| 1                     | B33     | 65-1707  | Cylinder barrel                                 | 1                  |
| 2                     | B31     | 65-1706  | Cylinder base washer                            | 1                  |
| 2                     | B33     | 65-1706  | Cylinder base washer                            | 2                  |
| 2                     | B33     | 65-134   | Cylinder base shim                              | 1                  |
| 3                     | B31 B33 | 65-930   | Push rod cover stud nut                         | 2                  |
| 4                     | B31 B33 | 29-541   | Push rod cover stud nut washer                  | 2                  |
| 5                     | B31 B33 | 24-4227  | Push rod cover tube stud                        | 2                  |
| 6                     | B31 B33 | 66-1379  | Push rod cover tube washer                      | 1                  |
| 7                     | B31 B33 | 66-1937  | Tappet recess cover washer                      | 1                  |
| 8                     | B31 B33 | 66-1936  | Tappet recess cover                             | 1                  |
| 9                     | B31 B33 | 29-2158  | Tappet recess cover screw                       | 4                  |
| 10                    | B31 B33 | 66-115   | Cylinder holding down bolt                      | 4                  |
| 11                    | B31 B33 | 65-1084  | Push rod  | 2                  |
| 12                    | B31 B33 | 65-1080  | Push rod cover tube                             | 1                  |
| 13                    | B31 B33 | 65-1142  | Valve rocker inspection cover                   | 1                  |
| 14                    | B31 B33 | 2-2582   | Valve rocker inspection cover screw             | 4                  |
| 15                    | B31 B33 | 65-1143  | Valve rocker inspection cover washer            | 1                  |
| 16                    | B31 B33 | 42-2967  | Exhaust pipe                                    | 1                  |
| —                     | B31 B33 | 42-2861  | Silencer and exhaust pipe clip                  | 1                  |
| —                     | B31 B33 | 21-5102  | Silencer clip pin nut                           | 1                  |
| —                     | B31 B33 | 90-3063  | Exhaust pipe clip pin                           | 1                  |
| —                     | B31 B33 | 90-3064  | Exhaust pipe clip swivel pin                    | 1                  |
| 17                    | B31     | 65-1110  | Valve (exhaust)                                 | 1                  |
| 17                    | B33     | 65-1240  | Valve (exhaust)                                 | 1                  |
| 18                    | B31     | 65-1514  | Valve guide (exhaust)                           | 1                  |
| 18                    | B33     | 65-1516  | Valve guide (exhaust)                           | 1                  |
| 19                    | B31 B33 | 65-1149  | Valve spring collar (exhaust)                   | 1                  |
| 20                    | B31     | 15-1525  | Valve split cotter (exhaust) (halves)           | 2                  |
| 20                    | B33     | 15-1525  | Valve split cotter (inlet and exhaust) (halves) | 4                  |
| 21                    | B31     | 31-103   | Valve stem cap exhaust                          | 1                  |
| 22                    | B31 B33 | 65-1160  | Cylinder head cover (exhaust)                   | 1                  |
| 23                    | B31 B33 | 2-443    | Exhaust lifter cable holder nut                 | 1                  |
| 24                    | B31 B33 | 27-1163  | Exhaust lifter cable holder                     | 1                  |
| 25                    | B31 B33 | 2-443    | Exhaust lifter spindle nut                      | 1                  |
| 26                    | B31 B33 | 2-525    | Exhaust lifter spindle washer                   | 1                  |
| 27                    | B31 B33 | 65-1137  | Exhaust lifter                                  | 1                  |
| 28                    | B31 B33 | 35-701   | Exhaust lifter spindle split pin                | 1                  |
| 29                    | B31 B33 | 65-1165  | Exhaust lifter spindle                          | 1                  |
| 30                    | B31 B33 | 2-2894   | Exhaust lifter bush washer (fibre)              | 1                  |
| 31                    | B31 B33 | 65-387   | Exhaust lifter bush                             | 1                  |
| 32                    | B31 B33 | 65-401   | Exhaust lifter spindle washer (felt)            | 1                  |
| 33                    | B31 B33 | 65-402   | Exhaust lifter spindle washer                   | 1                  |
| 34                    | B31 B33 | 65-403   | Exhaust lifter spindle spring                   | 1                  |
| 35                    | B31 B33 | 66-1436  | Exhaust lifter lever                            | 1                  |
| 36                    | B31 B33 | 2-443    | Exhaust lifter spindle nut                      | 1                  |
| 37                    | B31 B33 | 2-525    | Exhaust lifter spindle washer                   | 1                  |
| 38                    | B31 B33 | 65-317   | Rocker oil feed pipe banjo screw                | 2                  |
| 39                    | B31 B33 | 66-102   | Sparkling plug washer                           | 1                  |
| 40                    | B31 B33 | 65-114   | Sparkling plug                                  | 1                  |
| 41                    | B31     | 65-209   | Valve stem cap (inlet)                          | 1                  |
| 42                    | B31     | 29-410   | Valve split cotter (inlet) (halves)             | 2                  |
| 43                    | B31 B33 | 65-1149  | Valve spring collar (inlet)                     | 1                  |
| 44                    | B31 B33 | 31-8430  | Rocker oil feed pipe union washer (top)         | 2                  |
| 45                    | B31 B33 | 65-1161  | Valve rocker fulcrum pin                        | 2                  |
| 46                    | B31 B33 | 65-1146  | Valve spring (inner)                            | 2                  |
| 47                    | B31 B33 | 65-1147  | Valve spring (outer)                            | 2                  |
| 48                    | B31     | 65-1513  | Valve guide (inlet)                             | 1                  |
| 48                    | B33     | 65-1515  | Valve guide (inlet)                             | 1                  |
| 49                    | B31 B33 | 65-1118  | Valve rocker fulcrum pin washer                 | 2                  |
| 50                    | B31 B33 | 65-1117  | Valve rocker fulcrum spring                     | 2                  |
| 51                    | B31 B33 | 65-1102  | Valve rocker (inlet)                            | 1                  |
| 52                    | B31 B33 | 65-1100  | Valve rocker (exhaust)                          | 1                  |
| 53                    | B31 B33 | 27-1111  | Valve rocker spindle thrust washer              | 2                  |
| 54                    | B31 B33 | 29-541   | Cylinder head cover washer                      | 8                  |
| 55                    | B31 B33 | 65-1166  | Cylinder head cover screw                       | 8                  |
| 56                    | B31     | 65-1700  | Cylinder head with fixed fittings               | 1                  |
| 56                    | B33     | 65-1704  | Cylinder head with fixed fittings               | 1                  |
| 57                    | B31 B33 | 36-481   | Valve rocker spindle nut washer                 | 2                  |
| 58                    | B31 B33 | 65-311   | Valve rocker spindle nut                        | 2                  |

# ENGINE

B31 B33 (Swinging Arm)

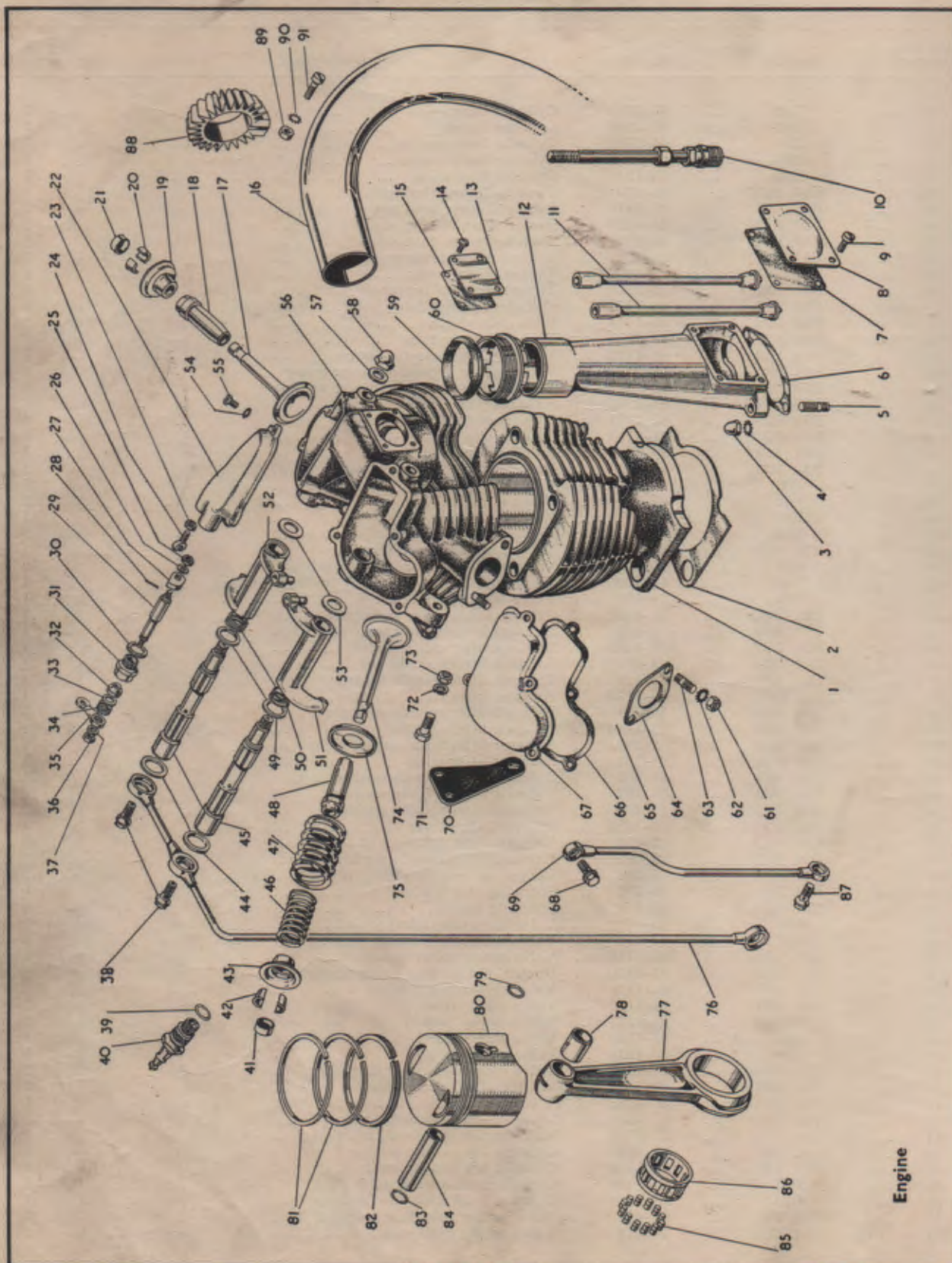

Engine

## Plate 1—continued

## ENGINE

## B31 B33 (Swinging Arm)

| Plate Ref.<br>Number. | Models. | Part No. | Description.   | Number<br>per set. |
|-----------------------|---------|----------|--|--------------------|
| 59                    | B31 B33 | 66-1367  | Push rod cover tube gland packing                                    | 1                  |
| 60                    | B31 B33 | 65-1082  | Push rod cover tube gland nut  | 1                  |
| 61                    | B31 B33 | 2-49     | Carburettor stud nut   | 2                  |
| 62                    | B31 B33 | 65-1776  | Spark plug suppressor  | 1                  |
| 63                    | B31 B33 | 36-382   | Carburettor stud nut washer  | 2                  |
| 64                    | B31 B33 | 24-5205  | Carburettor stud   | 2                  |
| 64                    | B31     | 65-1163  | Carburettor flange washer (Tufnol)                                   | 1                  |
| 64                    | B33     | 65-1238  | Carburettor flange washer (Tufnol)                                   | 1                  |
| 66                    | B31 B33 | 65-1164  | Cylinder head cover washer (paper)                                   | 2                  |
| 67                    | B31 B33 | 65-1159  | Cylinder head cover (inlet)  | 1                  |
| 68                    | B31 B33 | 26-1253  | Oil return pipe banjo screw (top)                                    | 1                  |
| 69                    | B31 B33 | 65-1218  | Oil return pipe complete   | 1                  |
| 70                    | B31 B33 | 42-50    | Engine steady plate  | 1                  |
| 71                    | B31 B33 | 28-2338  | Engine steady plate bolt   | 2                  |
| 72                    | B31 B33 | 24-8784  | Engine steady plate bolt washer (spring)                             | 2                  |
| 73                    | B31 B33 | 2-49     | Engine steady plate bolt nut   | 2                  |
| 74                    | B31     | 65-1111  | Valve (inlet)  | 1                  |
| 74                    | B33     | 65-1239  | Valve (inlet)  | 1                  |
| 75                    | B31 B33 | 65-1519  | Valve spring seat  | 2                  |
| 76                    | B31 B33 | 42-48    | Rocker oil feed pipe complete  | 1                  |
| 77                    | B31     | 66-482   | Connecting rod with bushes   | 1                  |
| 77                    | B33     | 65-1613  | Connecting rod with bushes   | 1                  |
| 78                    | B31 B33 | 66-492   | Gudgeon pin bush   | 1                  |
| 79                    | B31 B33 | 66-954   | Gudgeon pin retaining circlip  | 1                  |
| 80                    | B31     | 65-809   | Piston complete with rings, gudgeon pin and circlips (standard)      | 1                  |
| 80                    | B33     | 65-1660  | Piston complete with rings, gudgeon pin and circlips (7.5 to 1 C.R.) | 1                  |
| 81                    | B31     | 65-744   | Compression ring   | 2                  |
| 81                    | B33     | 65-1250  | Compression ring   | 2                  |
| 81                    | B33     | 24-1792  | Compression ring (Maxigroove)  | 2                  |
| 82                    | B31     | 65-735   | Piston scraper ring  | 1                  |
| 82                    | B33     | 65-1253  | Piston scraper ring  | 1                  |
| 83                    | B31 B33 | 66-954   | Gudgeon pin retaining circlip  | 1                  |
| 84                    | B31     | 65-440   | Gudgeon pin  | 1                  |
| 84                    | B33     | 66-953   | Gudgeon pin  | 1                  |
| 85                    | B31 B33 | 24-375   | Crankpin roller  | 24                 |
| 86                    | B31 B33 | 66-506   | Roller cage  | 1                  |
| 87                    | B31 B33 | 26-1253  | Oil return pipe banjo screw (bottom)                                 | 1                  |
| 88                    | B31 B33 | 65-2890  | Exhaust pipe finned collar   | 1                  |
| 89                    | B31 B33 | 21-5102  | Exhaust pipe finned collar nut                                       | 1                  |
| 90                    | B31 B33 | 29-541   | Exhaust pipe finned collar screw washer                              | 1                  |
| 91                    | B31 B33 | 21-6187  | Exhaust pipe finned collar screw                                     | 1                  |

## Plate 2

## ENGINE

## B31 B33 (Swinging Arm)

| Plate Ref.<br>Number. | Models. | Part No. | Description.                             | Number<br>per set. |
|-----------------------|---------|----------|--|--------------------|
| 1                     | B31 B33 | 1-4675   | Oil valve spring ball                    | 1                  |
| 2                     | B31 B33 | 66-1684  | Oil valve spring                         | 1                  |
| 3                     | B31 B33 | 66-1683  | Oil valve retaining screw washer (fibre) | 1                  |
| 4                     | B31 B33 | 65-2188  | Oil valve spring retaining screw         | 1                  |
| 5                     | B31 B33 | 65-2157  | Timing cover screw                       | 6                  |
| 6                     | B31 B33 | 42-124   | Contact breaker fixing screw             | 3                  |
| 7                     | B31 B33 | 66-1920  | Timing cover washer                      | 1                  |
| 8                     | B31 B33 | 66-698   | Engine shaft oil feed pipe               | 1                  |
| 9                     | B31 B33 | 29-905   | Engine shaft timing pinion nut           | 1                  |
| 10                    | B31 B33 | 66-1923  | Oil feed washer (rubber)                 | 2                  |
| 11                    | B31 B33 | 66-2007  | Cam pinion spindle bolt                  | 2                  |
| 12                    | B31 B33 | 66-2008  | Timing gear plate with bearing           | 1                  |

ENGINE  
B31 B33 (Swinging Arm)

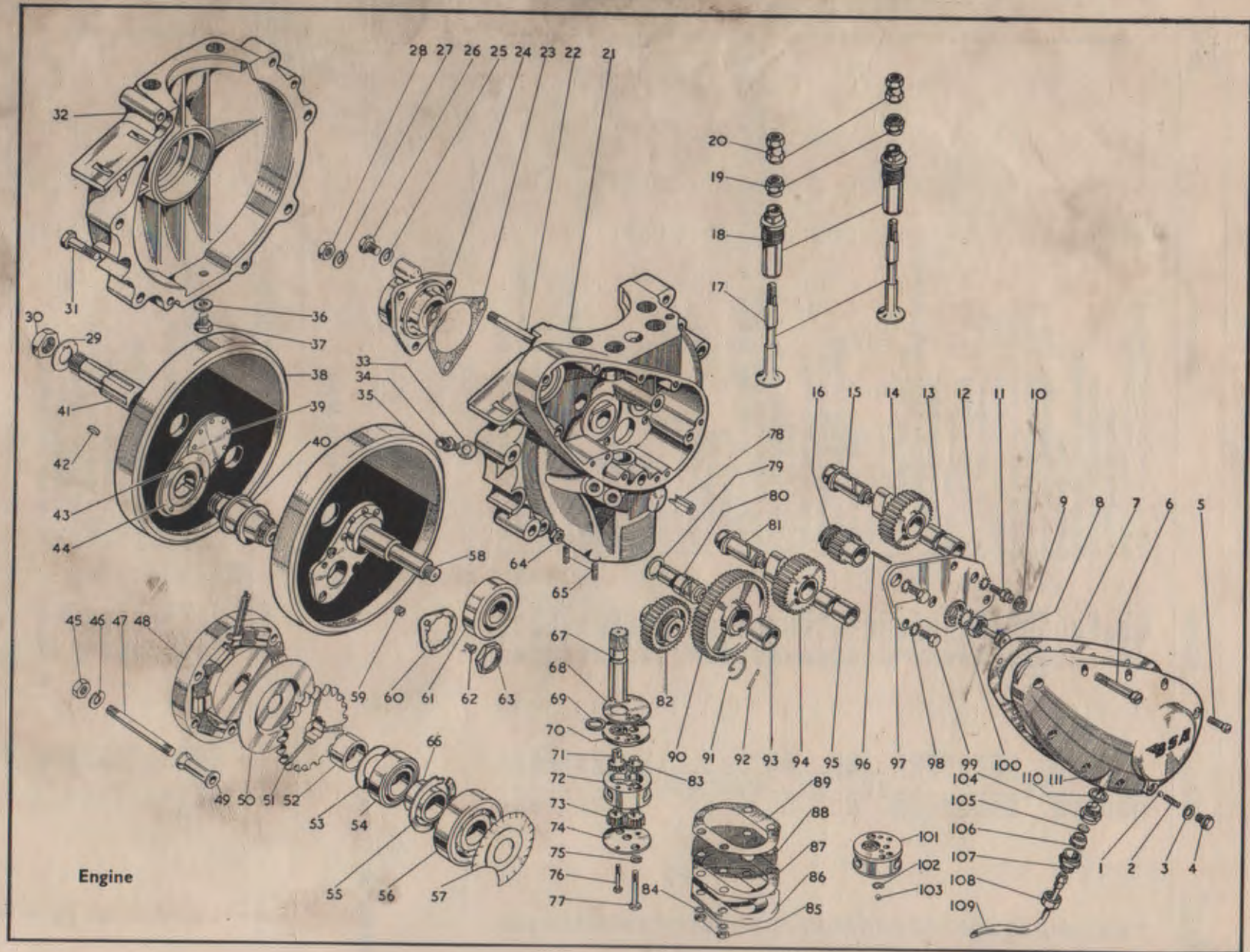

Plate 2—continued

ENGINE

B31 B33 (Swinging Arm)

| Plate Ref.<br>Number. | Models. | Part No. | Description.  | Number<br>per set. |
|-----------------------|---------|----------|---|--------------------|
| 13                    | B31 B33 | 65-441   | Cam pinion bush (exhaust)                                 | 2                  |
| 14                    | B31 B33 | 65-2420  | Cam pinion complete (exhaust)                             | 1                  |
| 15                    | B31 B33 | 65-2426  | Cam pinion spindle (exhaust)                              | 1                  |
| 16                    | B31 B33 | 65-692   | Engine shaft timing pinion                                | 1                  |
| 17                    | B31 B33 | 66-1493  | Tappet (inlet and exhaust)                                | 2                  |
| 18                    | B31 B33 | 66-1494  | Tappet guide (inlet and exhaust)                          | 2                  |
| 19                    | B31     | 15-6524  | Tappet locknut  | 2                  |
| 19                    | B33     | 65-1332  | Tappet locknut  | 2                  |
| 20                    | B31 B33 | 66-1511  | Tappet head (inlet and exhaust)                           | 2                  |
| 21                    | B31 B33 | *42-112  | Crankcase with fixed fittings (gear side) (see footnote)  | 1                  |
| 22                    | B31 B33 | 31-212   | Crankcase stud (top) (rear)                               | 1                  |
| 23                    | B31 B33 | 42-121   | Contact breaker housing joint washer                      | 1                  |
| 24                    | B31 B33 | 42-119   | Contact breaker housing                                   | 1                  |
| 25                    | B31 B33 | 2-1462   | Contact breaker clamp bolt washer (spring)                | 1                  |
| 26                    | B31 B33 | 21-5841  | Contact breaker clamp bolt                                | 1                  |
| 27                    | B31 B33 | 2-1462   | Contact breaker fixing screw washer                       | 3                  |
| 28                    | B31 B33 | 2-2395   | Contact breaker fixing screw nut                          | 3                  |
| 29                    | B31 B33 | 29-2024  | Alternator nut lockwasher                                 | 1                  |
| 30                    | B31 B33 | 29-2023  | Alternator Nut  | 1                  |
| 31                    | B31 B33 | 15-1355  | Crankcase connecting bolt                                 | 3                  |
| 32                    | B31 B33 | *42-111  | Crankcase with fixed fittings (drive side) (see footnote) | 1                  |
| 33                    | B31 B33 | 66-1683  | Crankcase oil pipe adaptor washer                         | 2                  |
| 34                    | B31 B33 | 65-2252  | Crankcase oil pipe adaptor                                | 2                  |
| 35                    | B31     | 65-1125  | Flywheel with engine shaft (gear side)                    | 1                  |
| 35                    | B33     | 65-1235  | Flywheel with engine shaft (gear side)                    | 1                  |
| 36                    | B31 B33 | 2-4553   | Crankcase drain plug washer (fibre)                       | 1                  |
| 37                    | B31 B33 | 28-243   | Crankcase drain plug                                      | 1                  |
| 38                    | B31     | 42-93    | Flywheel with engine shaft (drive side)                   | 1                  |
| 38                    | B33     | 42-94    | Flywheel with engine shaft (drive side)                   | 1                  |
| 39                    | B31 B33 | 27-1239  | Engine shaft rivet  | 14                 |
| 40                    | B31 B33 | 66-545   | Crankpin  | 1                  |
| 41                    | B31 B33 | 42-95    | Engine shaft (drive side)                                 | 1                  |
| 42                    | B31 B33 | 2-36     | Crankpin key  | 1                  |
| 43                    | B31 B33 | 66-630   | Thrust washer rivet                                       | 6                  |
| 44                    | B31 B33 | 66-629   | Thrust washer   | 2                  |
| 45                    | B31 B33 | 42-101   | Alternator fixing stud nut                                | 3                  |
| 46                    | B31 B33 | 24-8784  | Alternator fixing stud nut washer (spring)                | 3                  |
| 47                    | B31 B33 | 42-98    | Alternator fixing stud                                    | 3                  |
| 48                    | B31 B33 | 19-1222  | Alternator  | 1                  |
| 49                    | B31 B33 | 42-99    | Alternator spacer   | 3                  |
| 50                    | B31 B33 | 29-2031  | Alternator spinner  | 1                  |
| 51                    | B33     | 42-88    | Engine sprocket (19T) (solo)                              | 1                  |
| 51                    | B31     | 42-89    | Engine sprocket (17T) (solo and s/car)                    | 1                  |
| 52                    | B31 B33 | 42-96    | Engine sprocket distance piece                            | 1                  |
| 53                    | B31 B33 | 66-661   | Engine shaft shim (drive side)                            | 1                  |
| 54                    | B31 B33 | 65-2045  | Ball bearing (drive side)                                 | 1                  |
| 55                    | B31 B33 | 65-2240  | Main bearing spring ring                                  | 1                  |
| 56                    | B31 B33 | 24-724   | Roller bearing (drive side)                               | 1                  |
| 57                    | B31 B33 | 24-2113  | Oil flinger   | 1                  |
| 58                    | B31 B33 | 65-1129  | Engine shaft (gear side)                                  | 1                  |
| 59                    | B31 B33 | 65-479   | Crankpin oil hole grub screw                              | 1                  |
| 60                    | B31 B33 | 31-300   | Crankpin nut locking washer                               | 2                  |
| 61                    | B31 B33 | 24-722   | Roller bearing (gear side)                                | 1                  |
| 62                    | B31 B33 | 2-77     | Crankpin nut locking washer screw                         | 2                  |
| 63                    | B31 B33 | 31-298   | Crankpin nut  | 2                  |
| 64                    | B31 B33 | 2-49     | Crankcase connecting bolt nut                             | 4                  |
| 65                    | B31 B33 | 31-222   | Crankcase scavenge cover stud                             | 4                  |
| 66                    | B31 B33 | 66-660   | Engine shaft distance collar                              | 1                  |
| 67                    | B31 B33 | 66-2620  | Oil pump driving spindle                                  | 1                  |
| 68                    | B31 B33 | 65-2618  | Oil pump and crankcase joint washer                       | 1                  |
| 69                    | B31 B33 | 65-2606  | Oil pump top plate washer                                 | 1                  |
| 70                    | B31 B33 | 65-2598  | Oil pump top plate  | 1                  |
| 71                    | B31 B33 | 65-2592  | Oil pump feed gear (driver)                               | 1                  |
| 72                    | B31 B33 | 65-2596  | Oil pump body   | 1                  |
| 73                    | B31 B33 | 65-2590  | Oil pump scavenge gear                                    | 2                  |
| 74                    | B31 B33 | 65-2625  | Oil pump bottom plate                                     | 1                  |
| 75                    | B31 B33 | 24-978   | Oil pump bolt washer (spring)                             | 2                  |
| 76                    | B31 B33 | 15-848   | Oil pump bolt   | 2                  |

\*Supplied only as 42-110 crankcase drive side and gear side assembled with fixed fittings ... 1

## Plate 2—continued

## ENGINE

## B31 B33 (Swinging Arm)

| Plate Ref.<br>Number. | Models. | Part No. | Description.                           | Number<br>per set. |
|-----------------------|---------|----------|--|--------------------|
| 77                    | B31 B33 | 65-2604  | Oil pump fixing bolt                   | 2                  |
| 78                    | B31 B33 | 65-2580  | Oil pump driving spindle retaining pin | 1                  |
| 79                    | B31 B33 | 36-3528  | Idler pinion thrust washer             | 1                  |
| 80                    | B31 B33 | 65-2335  | Idler pinion spindle                   | 1                  |
| 81                    | B31 B33 | 65-2425  | Cam pinion spindle (inlet)             | 1                  |
| 82                    | B31 B33 | 42-120   | Contact breaker pinion                 | 1                  |
| 83                    | B31 B33 | 65-2591  | Oil pump feed gear (driven)            | 1                  |
| 84                    | B31 B33 | 29-541   | Crankcase scavenge cover stud washer   | 4                  |
| 85                    | B31 B33 | 2-51     | Crankcase scavenge cover stud nut      | 4                  |
| 86                    | B31 B33 | 65-2611  | Crankcase scavenge cover               | 1                  |
| 87                    | B31 B33 | 65-2612  | Crankcase scavenge cover washer        | 1                  |
| 88                    | B31 B33 | 65-2623  | Oil pump filter                        | 1                  |
| 89                    | B31 B33 | 65-2612  | Crankcase scavenge cover washer        | 1                  |
| 90                    | B31 B33 | 66-2250  | Magdyno drive idler pinion complete    | 1                  |
| 91                    | B31 B33 | 42-123   | Contact breaker pinion circlip         | 1                  |
| 92                    | B31 B33 | 42-122   | Contact breaker pinion pin             | 1                  |
| 93                    | B31 B33 | 65-2336  | Idler pinion bush                      | 1                  |
| 94                    | B31 B33 | 65-2420  | Cam pinion complete (inlet)            | 1                  |
| 95                    | B31 B33 | 65-441   | Cam pinion bush (inlet)                | 2                  |
| 96                    | B31 B33 | 65-693   | Engine shaft timing pinion key         | 1                  |
| 97                    | B31 B33 | 1-5069   | Timing gear plate bolt (C.E.I.)        | 1                  |
| 98                    | B31 B33 | 36-382   | Timing gear plate washer (shakeproof)  | 6                  |
| 99                    | B31 B33 | 21-2902  | Timing gear plate bolt (Whit.)         | 3                  |
| 100                   | B31 B33 | 65-695   | Timing pinion locking washer           | 1                  |
| 101                   | B31 B33 | 65-2589  | Oil pump complete                      | 1                  |
| 102                   | B31 B33 | 65-2622  | Oil pump ball retaining circlip        | 1                  |
| 103                   | B31 B33 | 65-2593  | Oil pump ball                          | 1                  |
| 104                   | B31 B33 | 65-2168  | Timing cover air release adaptor       | 1                  |
| 105                   | B31 B33 | 15-82    | Air release disc                       | 1                  |
| 106                   | B31 B33 | 65-2171  | Air release adaptor screw              | 1                  |
| 107                   | B31 B33 | 65-2165  | Timing cover air release body          | 1                  |
| 108                   | B31 B33 | 66-8332  | Breather extension pipe nut            | 1                  |
| 109                   | B31 B33 | 65-2166  | Breather extension pipe                | 1                  |
| 110                   | B31 B33 | 31-8430  | Air release adaptor washer (fibre)     | 1                  |
| 111                   | B31 B33 | 65-2143  | Timing cover                           | 1                  |

## Plate 3

## GEARBOX

## B31 B33 (Swinging Arm)

| Plate Ref.<br>Number. | Models. | Part No. | Description.                             | Number<br>per set. |
|-----------------------|---------|----------|--|--------------------|
| 1                     | B31 B33 | 67-3026  | Ball bearing spring ring                 | 1                  |
| 2                     | B31 B33 | 67-3067  | Gearbox sprocket oil seal                | 1                  |
| 3                     | B31 B33 | 24-4065  | Constant mesh gear ball bearing          | 1                  |
| 4                     | B31 B33 | 67-3073  | Constant mesh gear bush                  | 1                  |
| 5                     | B31 B33 | 67-3192  | Constant mesh gear complete (26T)        | 1                  |
| 6                     | B31 B33 | 67-3080  | Constant mesh gear bush (drilled)        | 1                  |
| 7                     | B31 B33 | 67-3201  | Mainshaft sliding gear (20T)             | 1                  |
| 8                     | B31 B33 | 67-3202  | Mainshaft sliding gear (24T)             | 1                  |
| 9                     | B31 B33 | 67-3329  | Gearbox mainshaft with gear              | 1                  |
| —                     | B31 B33 | 67-3330  | Gearbox mainshaft only                   | 1                  |
| 10                    | B31 B33 | 2-433    | Gearbox mainshaft key                    | 1                  |
| 11                    | B31 B33 | 15-4124  | Clutch push rod                          | 1                  |
| 12                    | B31 B33 | 67-3101  | Mainshaft gear locating ring             | 1                  |
| 13                    | B31 B33 | 67-3191  | Gearbox mainshaft gear (16T)             | 1                  |
| 14                    | B31 B33 | 24-4217  | Mainshaft bearing                        | 1                  |
| 15                    | B31 B33 | 67-3028  | Mainshaft bearing spring ring            | 1                  |
| 16                    | B31 B33 | 67-3161  | Kickstarter ratchet pinion sleeve washer | 1                  |
| 17                    | B31 B33 | 67-3169  | Kickstarter ratchet pinion bush          | 1                  |
| 18                    | B31 B33 | 67-3162  | Kickstarter ratchet spring               | 1                  |

# GEARBOX B31 B33 (Swinging Arm)

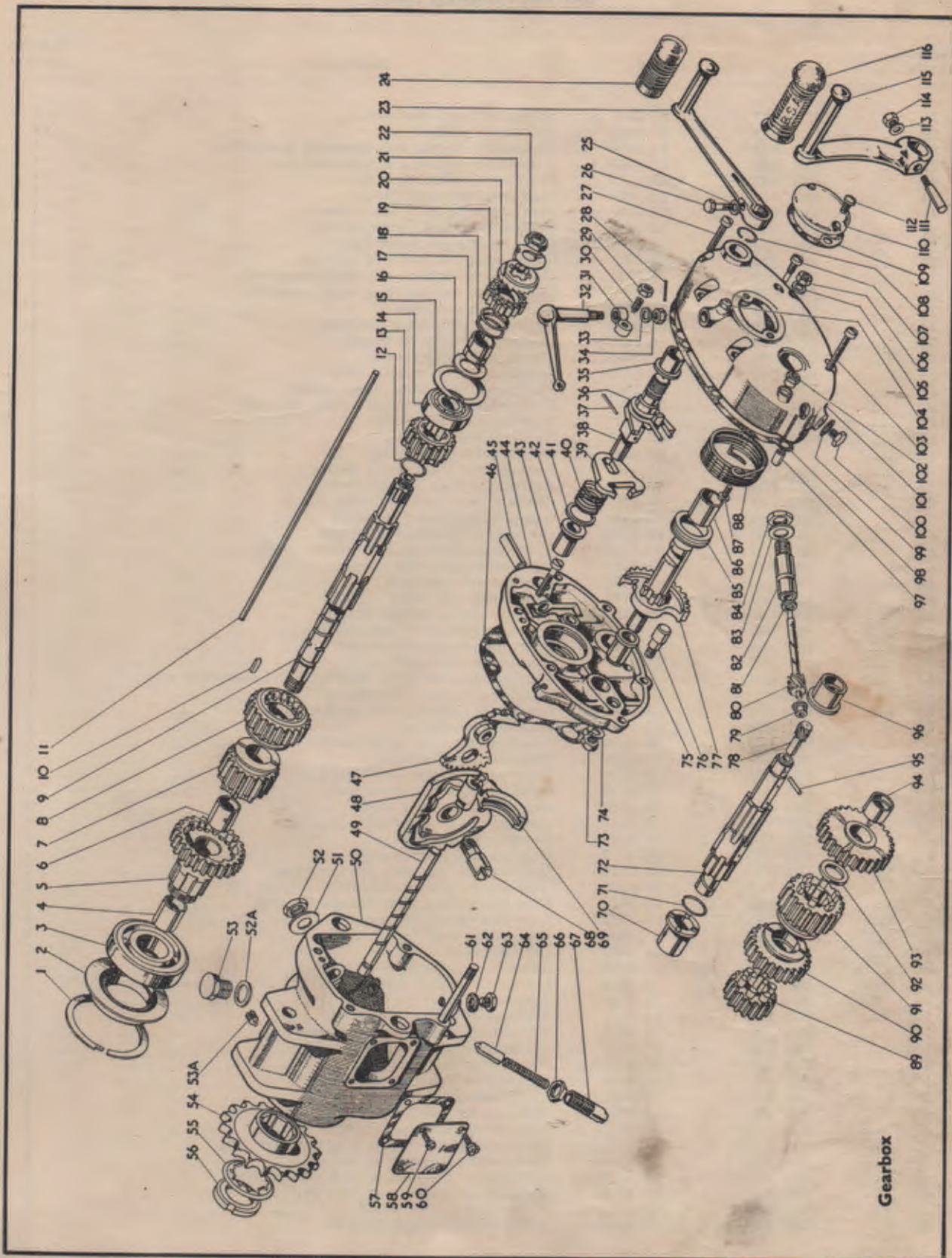

# Plate 3—continued

## GEARBOX

### B31 B33 (Swinging Arm)

| Plate Ref.<br>Number. | Models. | Part No. | Description   | Number<br>per set. |
|-----------------------|---------|----------|---|--------------------|
| 19                    | B31 B33 | 67-3376  | Kickstarter ratchet pinion                            | 1                  |
| 20                    | B31 B33 | 67-3167  | Kickstarter ratchet                                   | 1                  |
| 21                    | B31 B33 | 67-3164  | Kickstarter ratchet and mainshaft lock washer         | 1                  |
| 22                    | B31 B33 | 67-3163  | Kickstarter ratchet and mainshaft nut                 | 1                  |
| 23                    | B31 B33 | 42-3017  | Gearchange operating lever                            | 1                  |
| 24                    | B31 B33 | 29-3250  | Foot operating lever rubber                           | 1                  |
| 25                    | B31 B33 | 2-525    | Foot operating lever screw washer                     | 1                  |
| 26                    | B31 B33 | 65-3361  | Selector lever foot operating screw                   | 1                  |
| 27                    | B31 B33 | 65-3061  | Outer cover fixing screw (long)                       | 2                  |
| 28                    | B31 B33 | 35-702   | Clutch push rod lever nut split pin                   | 1                  |
| 29                    | B31 B33 | 2-452    | Clutch push rod lever adjusting screw nut             | 1                  |
| 30                    | B31 B33 | 65-3403  | Clutch push rod adjusting screw complete              | 1                  |
| 31                    | B31 B33 | 65-3360  | Clutch push rod lever                                 | 1                  |
| 32                    | B31 B33 | 67-3180  | Clutch operating lever complete                       | 1                  |
| 33                    | B31 B33 | 2-525    | Clutch push rod lever washer                          | 1                  |
| 34                    | B31 B33 | 15-1485  | Clutch push rod lever nut                             | 1                  |
| 35                    | B31 B33 | 67-3353  | Gearchange lever spindle bush                         | 1                  |
| 36                    | B31 B33 | 67-3340  | Footchange stop plate return spring                   | 1                  |
| 37                    | B31 B33 | 35-709   | Gear selector plate spring washer split pin           | 1                  |
| 38                    | B31 B33 | 67-3335  | Selector spindle complete                             | 1                  |
| 39                    | B31 B33 | 67-3341  | Gear selector plate                                   | 1                  |
| 40                    | B31 B33 | 67-3342  | Gear selector plate spring                            | 1                  |
| 41                    | B31 B33 | 24-868   | Gear selector plate spring washer                     | 1                  |
| 42                    | B31 B33 | 67-3170  | Footchange lever spindle bush                         | 1                  |
| 43                    | B31 B33 | 65-2157  | Gearbox inner cover retaining screw                   | 1                  |
| 44                    | B31 B33 | 67-3344  | Gearbox inner cover complete                          | 1                  |
| 45                    | B31 B33 | 67-3350  | Gearchange quadrant pivot pin                         | 1                  |
| 46                    | B31 B33 | 67-3346  | Gearbox inner cover joint washer (paper)              | 1                  |
| 47                    | B31 B33 | 67-3347  | Gearchange quadrant complete                          | 1                  |
| 48                    | B31 B33 | 67-3332  | Gear control cam plate complete                       | 1                  |
| 49                    | B31 B33 | 67-3116  | Gear shifter fork shaft                               | 1                  |
| 50                    | B31 B33 | 42-3006  | Gearbox case with fixed fittings                      | 1                  |
| 51                    | B31 B33 | 67-3328  | Gear cam plate pivot pin washer                       | 1                  |
| 52                    | B31 B33 | 2-124    | Gear cam plate pivot pin nut                          | 1                  |
| 53                    | B31 B33 | 67-3117  | Gear shifter fork grub screw                          | 1                  |
| 54                    | B31 B33 | 67-3065  | Gearbox sprocket (19T) (B31 solo, B33 solo and s/car) | 1                  |
| 55                    | B31 B33 | 67-3068  | Gearbox sprocket (17T) sidecar                        | 1                  |
| 56                    | B31 B33 | 24-4263  | Gearbox sprocket locking washer                       | 1                  |
| 57                    | B31 B33 | 67-3052  | Gearbox sprocket nut                                  | 1                  |
| 58                    | B31 B33 | 29-3449  | Gearbox inspection cover washer                       | 1                  |
| 59                    | B31 B33 | 29-3448  | Gearbox inspection cover                              | 1                  |
| 60                    | B31 B33 | 2-498    | Gearbox inspection cover screw                        | 1                  |
| 61                    | B31 B33 | 27-4258  | Gearbox inspection cover screw                        | 3                  |
| 62                    | B31 B33 | 67-3023  | Gearbox outer cover stud                              | 4                  |
| 63                    | B31 B33 | 2-4553   | Gearbox drain plug washer (fibre)                     | 1                  |
| 64                    | B31 B33 | 28-243   | Gearbox drain plug                                    | 1                  |
| 65                    | B31 B33 | 67-3119  | Gearbox cam plate plunger                             | 1                  |
| 66                    | B31 B33 | 67-3121  | Gear control cam plate plunger spring                 | 1                  |
| 67                    | B31 B33 | 67-3122  | Gear control cam plate plunger housing nut            | 1                  |
| 68                    | B31 B33 | 67-3120  | Gear control cam plate plunger housing                | 1                  |
| 69                    | B31 B33 | 67-3327  | Gear cam plate pivot pin                              | 1                  |
| 70                    | B31 B33 | 67-3204  | Gear shifter fork                                     | 2                  |
| 71                    | B31 B33 | 65-3337  | Layshaft bush   | 1                  |
| 72                    | B31 B33 | 67-3101  | Layshaft gear locating ring                           | 1                  |
| 73                    | B31 B33 | 42-3018  | Layshaft complete with gear (17T)                     | 1                  |
| 74                    | B31 B33 | 42-3019  | Layshaft only   | 1                  |
| 75                    | B31 B33 | 2-49     | Kickstarter quadrant stop nut                         | 1                  |
| 76                    | B31 B33 | 24-8784  | Kickstarter quadrant stop washer                      | 1                  |
| 77                    | B31 B33 | 67-3151  | Kickstarter spindle bush                              | 1                  |
| 78                    | B31 B33 | 67-3152  | Kickstarter quadrant stop                             | 1                  |
| 79                    | B31 B33 | 42-3160  | Kickstarter crank spindle assembly                    | 1                  |
| 80                    | B31 B33 | 67-3088  | Speedometer driving gear (6T)                         | 1                  |
| 81                    | B31 B33 | 65-3377  | Speedometer gear bush                                 | 1                  |
| 82                    | B31 B33 | 67-3175  | Speedometer driven gear (11T)                         | 1                  |
| 83                    | B31 B33 | 65-3375  | Speedometer driven gear thrust washer                 | 1                  |
| 84                    | B31 B33 | 65-3390  | Speedometer driven gear bush                          | 1                  |
| 85                    | B31 B33 | 65-3392  | Speedometer driven gear bush washer (fibre)           | 1                  |
| 86                    | B31 B33 | 65-3391  | Speedometer driven gear bush nut                      | 1                  |
| 87                    | B31 B33 | 67-3173  | Kickstarter spindle sleeve                            | 1                  |
| 88                    | B31 B33 | 67-3153  | Kickstarter lever spindle bush                        | 1                  |

# Plate 3—continued

## GEARBOX

B31 B33 (Swinging Arm)

| Plate Ref.<br>Number. | Models. | Part No. | Description.                                 | Number<br>per set. |
|-----------------------|---------|----------|--|--------------------|
| 87                    | B31 B33 | 2-3718   | Kickstarter spring screw                     | 1                  |
| 88                    | B31 B33 | 67-3174  | Kickstarter spring                           | 1                  |
| 89                    | B31 B33 | 42-3020  | Layshaft gear (17T)                          | 1                  |
| 90                    | B31 B33 | 42-3023  | Layshaft sliding gear (23T)                  | 1                  |
| 91                    | B31 B33 | 67-3198  | Layshaft sliding gear (19T)                  | 1                  |
| 92                    | B31 B33 | 67-3203  | Layshaft thrust washer                       | 1                  |
| 93                    | B31 B33 | 67-3199  | Layshaft gear complete (27T)                 | 1                  |
| 94                    | B31 B33 | 67-3093  | Layshaft gear bush                           | 1                  |
| 95                    | B31 B33 | 67-3128  | Speedometer gear layshaft peg                | 1                  |
| 96                    | B31 B33 | 67-3099  | Layshaft bush                                | 1                  |
| 97                    | B31 B33 | 66-3074  | Dowel  | 2                  |
| 98                    | B31 B33 | 67-3354  | Gearbox outer cover joint washer (paper)     | 1                  |
| 99                    | B31 B33 | 2-4553   | Oil level plug washer (fibre)                | 1                  |
| 100                   | B31 B33 | 28-243   | Oil level plug                               | 1                  |
| 101                   | B31 B33 | 67-3351  | Gearbox outer cover complete                 | 1                  |
| 102                   | B31 B33 | 27-4401  | Kickstarter spring screw locknut             | 1                  |
| 103                   | B31 B33 | 67-1705  | Outer cover fixing screw (short)             | 1                  |
| 104                   | B31 B33 | 28-2080  | Grease nipple                                | 1                  |
| 105                   | B31 B33 | 2-923    | Outer cover fixing nut washer                | 4                  |
| 106                   | B31 B33 | 67-3034  | Outer cover fixing nut                       | 4                  |
| 107                   | B31 B33 | 67-3176  | Speedometer driven gear retaining pin        | 1                  |
| —                     | B31 B33 | 67-1709  | Speedometer driven gear retaining pin washer | 1                  |
| 108                   | B31 B33 | 15-4240  | Gearchange operating spindle circlip         | 1                  |
| 109                   | B31 B33 | 64-3106  | Inspection cover joint washer (fibre)        | 1                  |
| 110                   | B31 B33 | 67-3024  | Inspection cover                             | 1                  |
| 111                   | B31 B33 | 2-2579   | Kickstarter crank cotter                     | 1                  |
| 112                   | B31 B33 | 24-7178  | Inspection cover fixing screw                | 2                  |
| 113                   | B31 B33 | 15-5155  | Kickstarter crank cotter washer (plain)      | 1                  |
| 114                   | B31 B33 | 2-2578   | Kickstarter crank cotter nut                 | 1                  |
| 115                   | B31 B33 | 42-3167  | Kickstarter crank                            | 1                  |
| 116                   | B31 B33 | 65-3397  | Kickstarter pedal rubber                     | 1                  |

Clutch and  
Front  
Chaincase

# Plate 4

## CLUTCH and FRONT CHAINCASE

B31 B33 (Swinging Arm)

| Plate Ref.<br>Number. | Models. | Part No. | Description.   | Number<br>per set. |
|-----------------------|---------|----------|--|--------------------|
| 1                     | B31 B33 | 65-3063  | Primary chaincase fixing screw (front)                                   | 6                  |
| 2                     | B31 B33 | 67-1711  | Primary chaincase front fixing, oil level and drain screw                | 2                  |
| 3                     | B31 B33 | 67-1706  | Primary chaincase fixing screw (front)                                   | 4                  |
| 4                     | B31 B33 | 67-42    | Primary chaincase inspection cap washer                                  | 1                  |
| 5                     | B31 B33 | 65-3364  | Primary chaincase inspection cap   | 1                  |
| 6                     | B31 B33 | 67-1704  | Primary chaincase fixing screw (front)                                   | 3                  |
| 7                     | B31 B33 | 67-1709  | Primary chaincase front fixing, oil level and drain screw washer (fibre) | 5                  |
| 8                     | B31 B33 | 42-7543  | Primary chaincase (front)  | 1                  |
| 9                     | B31 B33 | 42-3199  | Clutch centre pin nut  | 4                  |
| 10                    | B31 B33 | 42-3204  | Clutch spring  | 4                  |
| 11                    | B31 B33 | 42-3203  | Clutch spring cup  | 4                  |
| 12                    | B31 B33 | 42-3173  | Pressure plate assembly  | 1                  |
| 13                    | B31 B33 | 42-3192  | Driving plate assembly   | 5                  |
| 14                    | B31 B33 | 42-3195  | Clutch driven plate  | 5                  |
| 15                    | B31 B33 | 42-3202  | Drive rubber   | 4                  |
| 16                    | B31 B33 | 42-3187  | Retaining plate (outer)  | 1                  |
| 17                    | B31 B33 | 42-3201  | Rebound rubber   | 4                  |
| 18                    | B31 B33 | 42-3184  | Clutch spider  | 1                  |
| 19                    | B31 B33 | 42-3200  | Clutch centre  | 1                  |
| 20                    | B31 B33 | 42-3182  | Retaining plate (inner)  | —                  |
| 21                    | B31 B33 | 42-3207  | Clutch centre pin  | 4                  |
| 22                    | B31 B33 | 42-3208  | Clutch housing and sprocket assembly                                     | 1                  |

# CLUTCH and FRONT CHAINCASE

B31 B33 (Swinging Arm)

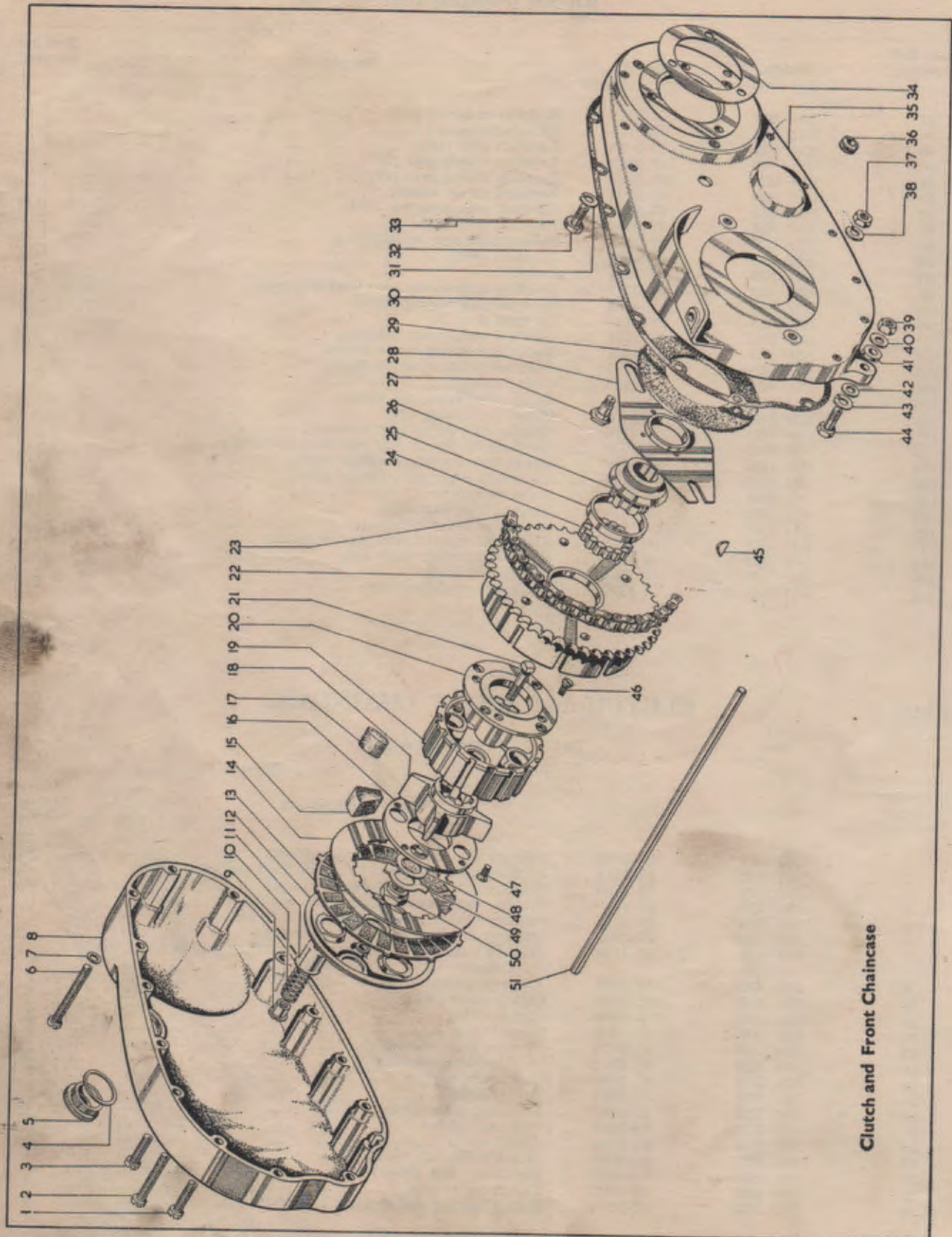

Clutch and Front Chaincase

## Plate 4—continued

## CLUTCH and FRONT CHAINCASE

B31 B33 (Swinging Arm)

| Plate Ref.<br>Number. | Models.     | Part No.    | Description.   | Number<br>per set. |
|-----------------------|-------------|-------------|--|--------------------|
| 23 ...                | B31 ...     | 24-8716 ... | Transmission chain (front) 67 pitches ...                | 1                  |
| 23 ...                | B33 ...     | 24-8930 ... | Transmission chain (front) 68 pitches ...                | 1                  |
| 24 ...                | B31 B33 ... | 42-3206 ... | Clutch roller ...  | 20                 |
| 25 ...                | B31 B33 ... | 42-3177 ... | Clutch housing bearing ring ...                          | 1                  |
| 26 ...                | B31 B33 ... | 42-3170 ... | Clutch sleeve ...  | 1                  |
| 27 ...                | B31 B33 ... | 42-7520 ... | Primary chaincase sliding plate bolt ...                 | 2                  |
| 28 ...                | B31 B33 ... | 66-7520 ... | Primary chaincase sliding plate ...                      | 1                  |
| 29 ...                | B31 B33 ... | 42-7504 ... | Primary chaincase felt washer (back) ...                 | 1                  |
| 30 ...                | B31 B33 ... | 42-7544 ... | Primary chaincase joint washer ...                       | 1                  |
| 31 ...                | B31 B33 ... | 24-8784 ... | Primary chaincase back securing bolt washer (spring) ... | 3                  |
| 32 ...                | B31 B33 ... | 42-7516 ... | Primary chaincase back securing bolt ...                 | 3                  |
| 33 ...                | B31 B33 ... | 65-8038 ... | Chaincase securing bolt wire ...                         | 1                  |
| 34 ...                | B31 B33 ... | 66-7575 ... | Primary chaincase and crankcase joint washer ...         | 1                  |
| 35 ...                | B31 B33 ... | 42-7542 ... | Primary chaincase (back) ...                             | 1                  |
| 36 ...                | B31 B33 ... | 42-7539 ... | Chaincase cable grommet (back) ...                       | 1                  |
| 37 ...                | B31 B33 ... | 2-2395 ...  | Chaincase sliding plate bolt nut ...                     | 2                  |
| 38 ...                | B31 B33 ... | 2-1462 ...  | Chaincase sliding plate bolt washer ...                  | 2                  |
| 39 ...                | B31 B33 ... | 2-49 ...    | Chaincase fixing bolt nut (back) ...                     | 1                  |
| 40 ...                | B31 B33 ... | 2-923 ...   | Chaincase fixing bolt washer (back) ...                  | 1                  |
| 41 ...                | B31 B33 ... | 42-4792 ... | Chaincase fixing distance collar (back) ...              | 1                  |
| 42 ...                | B31 B33 ... | 29-940 ...  | Chaincase fixing distance washer (back) ...              | As required        |
| 43 ...                | B31 B33 ... | 35-33 ...   | Chaincase fixing bolt washer (spring) ...                | 1                  |
| 44 ...                | B31 B33 ... | 2-6026 ...  | Chaincase fixing bolt (back) ...                         | 1                  |
| 45 ...                | B31 B33 ... | 2-433 ...   | Clutch sleeve key ...                                    | 1                  |
| 46 ...                | B31 B33 ... | 42-3183 ... | Retaining plate screw (inner) ...                        | 4                  |
| 47 ...                | B31 B33 ... | 42-3183 ... | Retaining plate screw (outer) ...                        | 4                  |
| 48 ...                | B31 B33 ... | 42-3190 ... | Mainshaft nut washer ...                                 | 1                  |
| 49 ...                | B31 B33 ... | 42-3191 ... | Mainshaft nut tab washer ...                             | 1                  |
| 50 ...                | B31 B33 ... | 42-3171 ... | Mainshaft nut ...  | 1                  |
| 51 ...                | B31 B33 ... | 15-4124 ... | Clutch operating rod ...                                 | 1                  |

## Plate 5

## FRAME and FITTINGS

B31 B33 (Swinging Arm)

| Plate Ref.<br>Number. | Models.     | Part No.    | Description.   | Number<br>per set. |
|-----------------------|-------------|-------------|--|--------------------|
| 1 ...                 | B31 B33 ... | 65-4182 ... | Rear engine and gearbox plate stud (top and bottom rear) ...             | 2                  |
| 2 ...                 | B31 B33 ... | 2-522 ...   | Rear engine and gearbox plate stud washer (spring) ...                   | 5                  |
| 3 ...                 | B31 B33 ... | 2-46 ...    | Rear engine and gearbox plate stud nut ...                               | 5                  |
| 4 ...                 | B31 B33 ... | 2-1945 ...  | Gearbox pivot stud washer (plain) ...                                    | 2                  |
| 5 ...                 | B31 B33 ... | 2-1967 ...  | Gearbox pivot stud washer (spring) ...                                   | 2                  |
| 6 ...                 | B31 B33 ... | 2-1925 ...  | Gearbox pivot stud nut ...   | 2                  |
| 7 ...                 | B31 B33 ... | 42-4077 ... | Gearbox pivot stud ...   | 1                  |
| 8 ...                 | B31 B33 ... | 27-5683 ... | Rear engine and gearbox plate stud (bottom front) ...                    | 1                  |
| 9 ...                 | B31 B33 ... | 2-522 ...   | Rear engine and gearbox plate stud washer (spring) (bottom front) ...    | 2                  |
| 10 ...                | B31 B33 ... | 2-46 ...    | Rear engine and gearbox plate stud nut (bottom front) ...                | 2                  |
| 11 ...                | B31 B33 ... | 2-522 ...   | Crankcase and rear engine plate fixing stud washer (spring) (bottom) ... | 2                  |
| 12 ...                | B31 B33 ... | 2-46 ...    | Crankcase and rear engine plate fixing stud nut (bottom) ...             | 2                  |
| 13 ...                | B31 B33 ... | 27-5683 ... | Crankcase and rear engine plate stud (bottom) ...                        | 1                  |
| 14 ...                | B31 B33 ... | 42-4125 ... | Front engine plate cover ...   | 1                  |
| 15 ...                | B31 B33 ... | 29-3319 ... | Front engine plate cover screw washer (shakeproof) ...                   | 6                  |
| 16 ...                | B31 B33 ... | 2-1309 ...  | Front engine plate cover screw ...                                       | 6                  |
| 17 ...                | B31 B33 ... | 66-4149 ... | Ball head cup ...  | 2                  |
| 18 ...                | B31 B33 ... | 42-4440 ... | Frame complete with central stand ...                                    | 1                  |
| 19 ...                | B31 B33 ... | 42-4132 ... | Rear engine and gearbox plate bolt (top) ...                             | 1                  |
| 20 ...                | B31 B33 ... | 28-2080 ... | Ball head grease nipple ...  | 1                  |
| 21 ...                | B31 B33 ... | 42-4078 ... | Petrol tank fixing bolt socket ...                                       | 1                  |
| 21 ...                | B31 B33 ... | 29-8740 ... | Petrol tank fixing bolt socket tab washer ...                            | 1                  |
| 22 ...                | B31 B33 ... | 66-4707 ... | Saddle front fixing bolt washer (shakeproof) ...                         | 1                  |

## FRAME and FITTINGS

## B31 B33 (Swinging Arm)

| Plate Ref.<br>Number. | Models. | Part No. | Description.  | Number<br>per set. |
|-----------------------|---------|----------|---|--------------------|
| 23                    | B31 B33 | 2-46     | Saddle front fixing bolt nut                                    | 1                  |
| 24                    | B31 B33 | 29-3319  | Air cleaning fixing screw washer (shakeproof)                   | 2                  |
| —                     | B31 B33 | 42-4591  | Air cleaner element   | 1                  |
| —                     | B31 B33 | 42-4592  | Air cleaner element cover                                       | 1                  |
| —                     | B31 B33 | 42-4593  | Air cleaner element sealing ring                                | 1                  |
| —                     | B31 B33 | 42-4594  | Air cleaner element retaining clip                              | 1                  |
| —                     | B31 B33 | 42-4588  | Air cleaner fixing screw distance collar                        | 1                  |
| 25                    | B31 B33 | 42-4574  | Air cleaner fixing screw  | 2                  |
| 26                    | B31 B33 | 2-1096   | Air cleaner fixing screw washer (plain)                         | 2                  |
| 27                    | B31 B33 | 67-4588  | Air cleaner rubber connection spring clip                       | 1                  |
| 28                    | B31 B33 | 42-4568  | Air cleaner rubber connection                                   | 1                  |
| 29                    | B31 B33 | 42-4070  | Front engine plate and frame distance tube                      | 1                  |
| 30                    | B31 B33 | 27-5690  | Front engine plate frame stud (top)                             | 1                  |
| 31                    | B31 B33 | 2-522    | Front engine plate frame stud washer (spring)                   | 4                  |
| 32                    | B31 B33 | 2-46     | Front engine plate frame stud nut                               | 4                  |
| 33                    | B31 B33 | 2-46     | Crankcase front fixing stud nut                                 | 6                  |
| 34                    | B31 B33 | 2-522    | Crankcase front fixing stud washer (spring)                     | 6                  |
| 35                    | B31 B33 | 27-5684  | Crankcase and front engine plate front fixing stud              | 3                  |
| 36                    | B31 B33 | 42-4070  | Front engine plate and frame distance tube                      | 1                  |
| 37                    | B31 B33 | 42-4099  | Front engine plate stud (bottom) and horn fixing stud           | 1                  |
| 38                    | B31 B33 | 42-4072  | Rear engine and gearbox plate (top)                             | 2                  |
| 39                    | B31 B33 | 42-4073  | Rear engine and gearbox plate (bottom)                          | 2                  |
| 40                    | B31 B33 | 65-4182  | Crankcase and rear engine plate top fixing stud                 | 1                  |
| 41                    | B31 B33 | 42-4071  | Front engine plate distance collar                              | 2                  |
| 42                    | B31 B33 | 42-4068  | Front engine plate (offside)                                    | 1                  |
| 42                    | B31 B33 | 42-4066  | Front engine plate (nearside)                                   | 1                  |
| 43                    | B31 B33 | 2-46     | Crankcase and rear engine plate top fixing stud nut             | 2                  |
| 44                    | B31 B33 | 2-522    | Crankcase and rear engine plate top fixing stud washer (spring) | 2                  |
| 45                    | B31 B33 | 2-1925   | Gearbox locking stud nut  | 1                  |
| 46                    | B31 B33 | 66-4708  | Gearbox locking stud washer (shakeproof)                        | 1                  |
| 47                    | B31 B33 | 42-4076  | Gearbox adjusting screw   | 1                  |
| 48                    | B31 B33 | 2-1616   | Gearbox adjusting screw locknut                                 | 1                  |
| 49                    | B31 B33 | 15-5664  | Gearbox adjusting screw nut                                     | 1                  |
| 50                    | B31 B33 | 27-5705  | Gearbox adjusting screw stop                                    | 1                  |
| 51                    | B31 B33 | 42-4075  | Gearbox locking stud washer (serrated)                          | 1                  |
| 52                    | B31 B33 | 42-4074  | Gearbox locking stud complete                                   | 1                  |
| 53                    | B31 B33 | 2-1462   | Gearbox adjusting screw stop washer (spring)                    | 1                  |
| 54                    | B31 B33 | 2-2395   | Gearbox adjusting screw stop nut                                | 1                  |
| 55                    | B31 B33 | 24-6770  | Battery base plate bolt   | 4                  |
| 56                    | B31 B33 | 2-923    | Battery base plate bolt washer (plain)                          | 2                  |
| 57                    | B31 B33 | 15-6524  | Battery base plate bolt nut                                     | 2                  |
| 58                    | B31 B33 | 36-382   | Battery base plate bolt washer (shakeproof)                     | 4                  |
| 59                    | B31 B33 | 42-4515  | Battery base plate  | 1                  |
| 60                    | B31 B33 | 42-4406  | Rear engine plate cover   | 1                  |
| 61                    | B31 B33 | 42-4583  | Air cleaner complete  | 1                  |
| 62                    | B31 B33 | 28-2080  | Saddle front fixing bolt grease nipple                          | 1                  |
| 63                    | B31 B33 | 67-4030  | Saddle front fixing bolt  | 1                  |
| —                     | B31 B33 | 42-4514  | Battery carrier complete  | 1                  |
| 64                    | B31 B33 | 42-4516  | Battery strap (side) complete                                   | 1                  |
| 65                    | B31 B33 | 42-4502  | Battery strap (top)   | 1                  |
| —                     | B31 B33 | 2-6537   | Battery strap bolt washer (plain)                               | 2                  |
| 66                    | B31 B33 | 24-7343  | Battery strap bolt  | 2                  |
| 67                    | B31 B33 | 42-9032  | Saddle (as required) (1954/5)                                   | 1                  |
| 67                    | B31 B33 | 42-9032  | Saddle (as required)  | 1                  |
| 68                    | B31 B33 | 42-4505  | Battery strap swivel pin (plain hole)                           | 1                  |
| 69                    | B31 B33 | 42-4506  | Battery strap swivel pin (tapped hole)                          | 1                  |
| 70                    | B31 B33 | 42-4503  | Battery strap (side)  | 1                  |
| 71                    | B31 B33 | 2-49     | Saddle rear fixing stud nut                                     | 4                  |
| 72                    | B31 B33 | 2-923    | Saddle rear fixing stud washer (plain)                          | 4                  |
| 73                    | B31 B33 | 67-4040  | Saddle rear fixing stud   | 2                  |
| —                     | B31 B33 | 42-4835  | Pillion footrest complete assembly                              | 2                  |
| 74                    | B31 B33 | 29-7581  | Pillion footrest only   | 2                  |
| 74A                   | B31 B33 | 29-7583  | Pillion footrest rubber   | 2                  |
| 75                    | B31 B33 | 29-7564  | Pillion footrest swivel bolt                                    | 2                  |
| 76                    | B31 B33 | 29-7560  | Pillion footrest anchor bolt                                    | 2                  |
| 77                    | B31 B33 | 36-382   | Pillion footrest swivel bolt washer                             | 2                  |
| 78                    | B31 B33 | 24-6040  | Pillion footrest swivel bolt nut                                | 2                  |
| 79                    | B31 B33 | 2-522    | Pillion footrest anchor bolt washer                             | 2                  |
| 80                    | B31 B33 | 2-46     | Pillion footrest anchor bolt nut                                | 2                  |
| —                     | B31 B33 | 42-4769  | Prop stand assembly   | 1                  |

# FRAME and FITTINGS

B31 B33 (Swinging Arm)

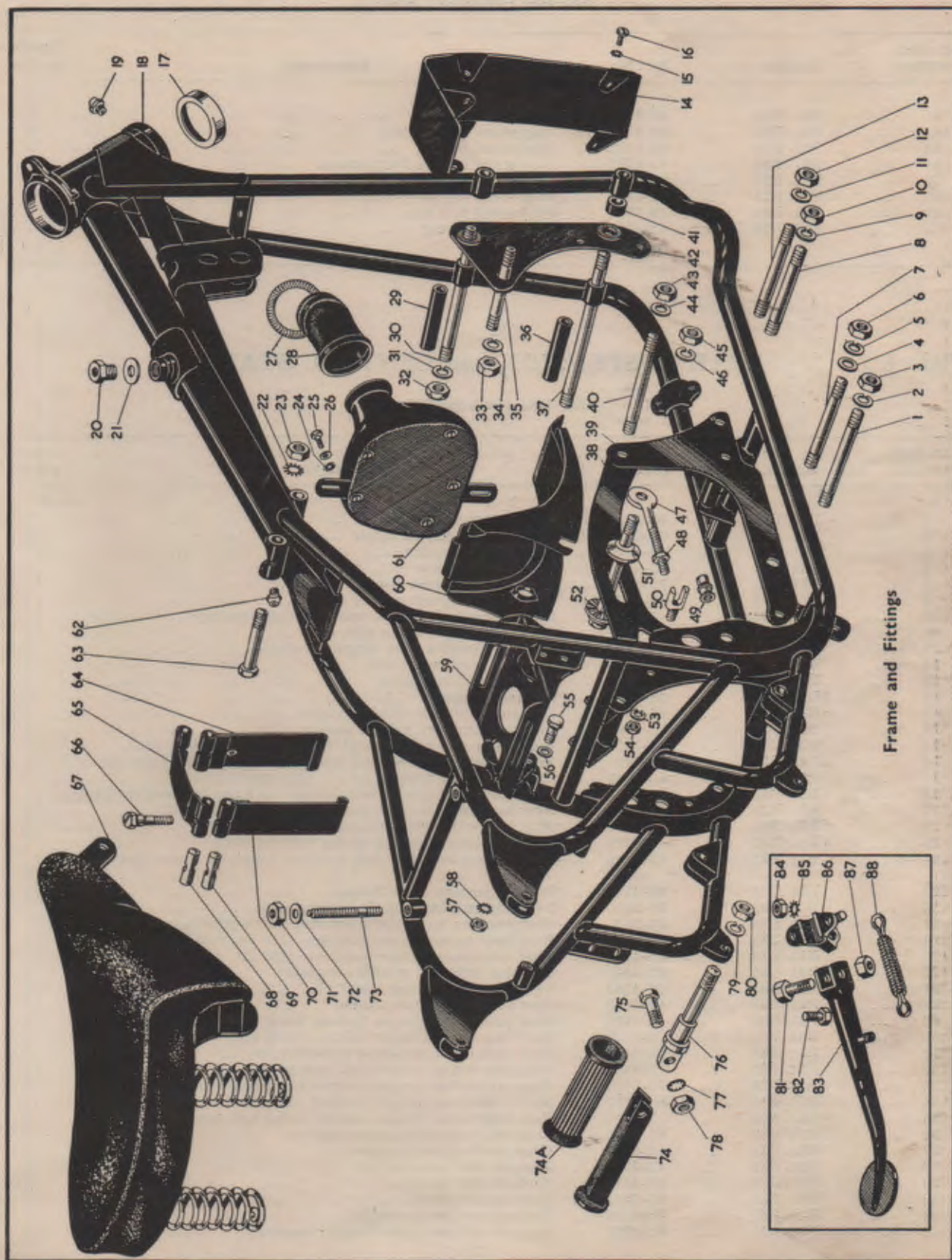

## Plate 5—continued

## FRAME and FITTINGS

## B31 B33 (Swinging Arm)

| Plate Ref.<br>Number. | Models. | Part No. | Description.                     | Number<br>per set. |
|-----------------------|---------|----------|----------------------------------|--------------------|
| 81 ...                | B31 B33 | 42-4793  | Prop stand bolt                  | 1                  |
| 82 ...                | B31 B33 | 42-4796  | Prop stand lug clip bolt         | 2                  |
| 83 ...                | B31 B33 | 42-4772  | Prop stand leg                   | 1                  |
| 84 ...                | B31 B33 | 42-4797  | Prop stand lug clip bolt locknut | 1                  |
| 85 ...                | B31 B33 | 36-382   | Prop stand lug clip bolt washer  | 2                  |
| 86 ...                | B31 B33 | 42-4776  | Prop stand lug body complete     | 1                  |
| 87 ...                | B31 B33 | 15-734   | Prop stand bolt nut              | 1                  |
| 88 ...                | B31 B33 | 65-4742  | Prop stand spring                | 1                  |

## Plate 6

## REAR SUSPENSION and CENTRAL STAND

## B31 B33 (Swinging Arm)

| Plate Ref.<br>Number. | Models. | Part No. | Description.  | Number<br>per set. |
|-----------------------|---------|----------|---|--------------------|
| 1 ...                 | B31 B33 | 42-4736  | Central stand complete  | 1                  |
| 2 ...                 | B31 B33 | 28-2080  | Central stand grease nipple   | 1                  |
| 3 ...                 | B31 B33 | 42-4730  | Central stand spring  | 1                  |
| 4 ...                 | B31 B33 | 42-4745  | Central stand tube  | 1                  |
| 5 ...                 | B31 B33 | 42-4744  | Central stand pivot distance bar  | 1                  |
| 6 ...                 | B31 B33 | 15-39    | Central stand pivot washer (plain)                                      | 2                  |
| 7 ...                 | B31 B33 | 3-1346   | Central stand pivot stud washer (double spring)                         | 1                  |
| 8 ...                 | B31 B33 | 35-707   | Central stand pivot bar split pin                                       | 2                  |
| 9 ...                 | B31 B33 | 42-4806  | Footrest distance tube complete (offside)                               | 1                  |
| 10 ...                | B31 B33 | 42-4804  | Footrest bracket (offside)  | 1                  |
| 11 ...                | B31 B33 | 42-4855  | Footrest stud complete  | 1                  |
| 12 ...                | B31 B33 | 29-7551  | Footrest rubber   | 2                  |
| 13 ...                | B31 B33 | 42-4343  | Swinging arm fork spindle locknut                                       | 1                  |
| 14 ...                | B31 B33 | 42-4364  | Swinging arm fork spindle washer  | 1                  |
| 15 ...                | B31 B33 | 1-1796   | Rear mudguard bracket and damper top fixing bolt nut...                 | 2                  |
| 16 ...                | B31 B33 | 2-522    | Rear mudguard bracket and damper top fixing bolt washer (spring)        | 2                  |
| 17 ...                | B31 B33 | 42-6763  | Rear mudguard bracket and damper spacing collar                         | 2                  |
| 18 ...                | B31 B33 | 2-1733   | Rear mudguard bracket and damper top fixing bolt washer (plain)         | 2                  |
| 19 ...                | B31 B33 | 65-4185  | Rear mudguard bracket and damper top fixing bolt                        | 2                  |
| 20 ...                | B31 B33 | 42-4299  | Rear suspension damper spring (110 lbs. rate)                           | 2                  |
| 20 ...                | B31 B33 | 42-4302  | Rear suspension damper spring (130 lbs. rate)                           | 2                  |
| 21 ...                | B31 B33 | 42-4289  | Rear suspension split ring retainer (retaining outer shroud) (2 halves) | 2                  |
| 22 ...                | B31 B33 | 42-4291  | Rear suspension outer shroud  | 2                  |
| 23 ...                | B31 B33 | 66-2010  | Swinging arm fork spindle securing bolt                                 | 1                  |
| 24 ...                | B31 B33 | 33-382   | Swinging arm fork spindle securing bolt washer (shakeproof)             | 1                  |
| 25 ...                | B31 B33 | 42-4461  | Rear suspension damper complete (110 lbs. rate)                         | 2                  |
| 25 ...                | B31 B33 | 42-4462  | Rear suspension damper complete (130 lbs. rate) (Sidecar use)           | 2                  |
| 26 ...                | B31 B33 | 42-4340  | Swinging arm fork spindle complete                                      | 1                  |
| 27 ...                | B31 B33 | 42-4362  | Swinging arm housing 'silent bloc'                                      | 2                  |
| 28 ...                | B31 B33 | 42-4292  | Rear suspension inner shroud  | 2                  |
| 29 ...                | B31 B33 | 3-1399   | Rear suspension damper bottom fixing bolt                               | 2                  |
| 30 ...                | B31 B33 | 2-1733   | Rear suspension damper bottom fixing bolt washer (plain)                | 2                  |
| 31 ...                | B31 B33 | 19-5305  | Rear suspension mounting bush (rubber)                                  | 4                  |
| 32 ...                | B31 B33 | 42-4450  | Swinging arm complete with bushes                                       | 1                  |
| 33 ...                | B31 B33 | 67-4129  | Rear suspension damper bottom fixing bolt washer                        | 2                  |
| 34 ...                | B31 B33 | 66-4707  | Rear suspension damper bottom fixing bolt washer (shakeproof)           | 2                  |
| 35 ...                | B31 B33 | 2-46     | Rear suspension damper bottom fixing bolt nut                           | 2                  |
| 36 ...                | B31 B33 | 24-563   | Rear wheel adjusting screw locknut                                      | 2                  |
| 37 ...                | B31 B33 | 42-6040  | Rear wheel adjusting screw  | 2                  |
| 38 ...                | B31 B33 | 42-4841  | Footrest stud securing nut  | 1                  |
| 39 ...                | B31 B33 | 42-4842  | Footrest stud washer  | 1                  |
| 40 ...                | B31 B33 | 66-5524  | Footrest stud washer  | 1                  |
| 41 ...                | B31 B33 | 42-4854  | Footrest bracket (nearside)   | 1                  |
| 42 ...                | B31 B33 | 42-4557  | Footrest distance tube complete (nearside)                              | 1                  |

# REAR SUSPENSION and CENTRAL STAND

B31 B33 (Swinging Arm)

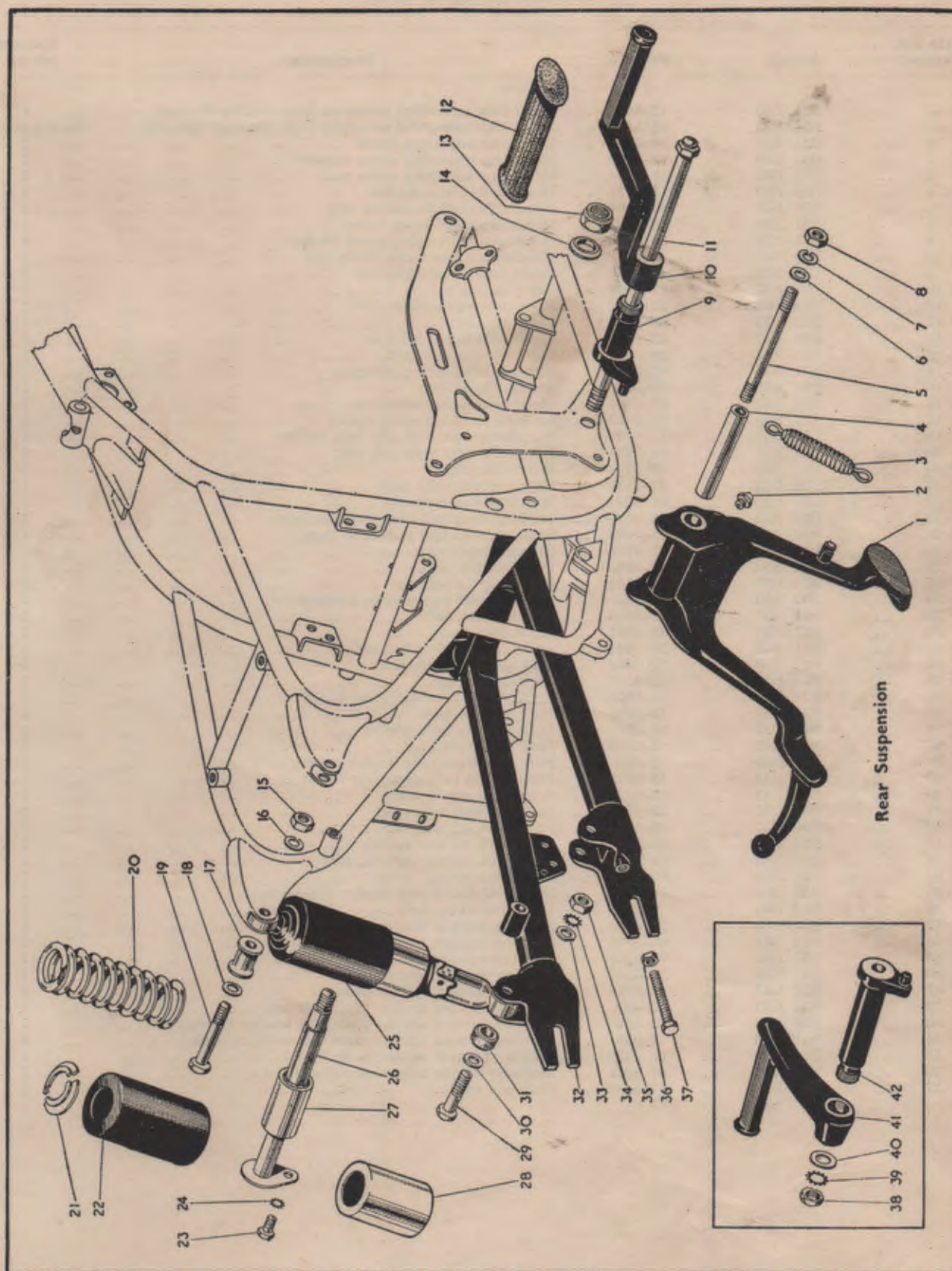

Rear  
Suspension  
and  
Central Stand

## Plate 7

## FRONT FORK and FITTINGS

B31 B33 (Swinging Arm)

| Plate Ref.<br>Number. | Models. | Part No.  | Description.  | Number<br>per set. |
|-----------------------|---------|-----------|---|--------------------|
| —                     | B31 B33 | 42-5070   | Front fork assembled complete (less steering damper)  | 1                  |
| —                     | B31 B33 | 42-5071   | Front fork assembled complete (with steering damper)  | As required        |
| 1                     | B31 B33 | 21-5371   | Headlamp adjusting screw                              | 2                  |
| 2                     | B31 B33 | 42-5099   | Headlamp adjusting screw washer                       | 2                  |
| 3                     | B31 B33 | 21-5164   | Headlamp adjusting screw nut                          | 2                  |
| 4                     | B31 B33 | 42-5094   | Headlamp cowl complete                                | 1                  |
| 5                     | B31 B33 | 45-5097   | Headlamp cowl mounting ring                           | 1                  |
| 6                     | B31 B33 | 2-360     | Headlamp cowl fixing screw                            | 4                  |
| 7                     | B31 B33 | 29-3319   | Headlamp cowl fixing screw washer                     | 4                  |
| 8                     | B31 B33 | 2-47      | Headlamp screw fixing screw nut                       | 4                  |
| 9                     | B31 B33 | 42-5090   | Front fork cover complete                             | 1                  |
| 10                    | B31 B33 | 42-5093   | Top yoke cover  | 1                  |
| 10a                   | B31 B33 | 65-5332   | Fork tube nut washer                                  | 2                  |
| 11                    | B31 B33 | 65-5331   | Fork tube nut   | 2                  |
| 12                    | B31 B33 | 42-5035   | Front fork top yoke                                   | 1                  |
| 13                    | B31 B33 | 29-5315   | Top yoke clip bolt nut                                | 1                  |
| 14                    | B31 B33 | 65-5446   | Steering head lock grub screw                         | 1                  |
| 15                    | B31 B33 | 65-5445   | Steering head lock                                    | 1                  |
| 16                    | B31 B33 | 67-5024   | Steering stem adjusting sleeve cap                    | 1                  |
| 17                    | B31 B33 | 67-5023   | Steering stem adjusting sleeve                        | 1                  |
| 18                    | B31 B33 | 15-5155   | Handlebar and yoke clip bolt washer                   | 4                  |
| 19                    | B31 B33 | 64-5334   | Handlebar and yoke clip bolt                          | 4                  |
| 20                    | B31 B33 | 65-5333   | Handlebar clip  | 2                  |
| 21                    | B31 B33 | 27-5135   | Fork top yoke clip bolt                               | 1                  |
| 22                    | B31 B33 | 66-5204   | Steering head dust cap                                | 1                  |
| 23                    | B31 B33 | 65-5127   | Steering head ball race cone (bottom)                 | 1                  |
| 24                    | B31 B33 | 65-5126   | Steering head ball race cone (top)                    | 1                  |
| 25                    | B31 B33 | 1-4675    | Steering head balls                                   | 40                 |
| 26                    | B31 B33 | 42-5086   | Fork bottom yoke                                      | 1                  |
| 27                    | B31 B33 | 24-5160   | Bottom yoke bolt nut                                  | 2                  |
| 28                    | B31 B33 | 36-382    | Bottom yoke bolt washer (shakeproof)                  | 2                  |
| 29                    | B31 B33 | 29-5289   | Bottom yoke bolt                                      | 2                  |
| 30                    | B31 B33 | 89-5061   | Front fork shaft                                      | 1                  |
| 31                    | B31 B33 | 29-5347   | Front fork bottom bearing                             | 1                  |
| 32                    | B31 B33 | 29-5338   | Fork shaft plug washer                                | 2                  |
| 33                    | B31 B33 | 29-5283   | Fork shaft plug                                       | 2                  |
| 34                    | B31 B33 | 42-5076   | Fork sliding tube complete (O/S)                      | 1                  |
| 35                    | B31 B33 | 42-5084   | Fork end cap bolt                                     | 4                  |
| 36                    | B31 B33 | 35-33     | Fork end cap bolt washer                              | 4                  |
| 37                    | B31 B33 | 2-1309    | Fork end drain plug                                   | 2                  |
| 38                    | B31 B33 | 2-292     | Fork end drain plug washer (fibre)                    | 2                  |
| 39                    | B31 B33 | 42-5078   | Fork sliding tube complete (N/S)                      | 1                  |
| 40                    | B31 B33 | 65-5424   | Front fork top bearing                                | 2                  |
| 41                    | B31 B33 | 29-5320   | Fork top bearing circlip                              | 2                  |
| 42                    | B31 B33 | 29-5313   | Front fork oil seal                                   | 2                  |
| 43                    | B31 B33 | 29-5310/3 | Front fork oil seal holder                            | 2                  |
| 44                    | B31 B33 | 89-5036   | Front fork spring (sidcar use)                        | 2                  |
| 44                    | B31 B33 | 65-5391   | Front fork spring (solo)                              | 2                  |
| 45                    | B31 B33 | 29-541    | Horn foot fixing bolt washer (Shakeproof)             | 2                  |
| 46                    | B31 B33 | 2-204     | Horn foot fixing bolt                                 | 2                  |
| 47                    | B31 B33 | 24-6035   | Steering damper knob washer (spring)                  | 1                  |
| 48                    | B31 B33 | 65-5380   | Steering damper friction washer                       | 2                  |
| 49                    | B31 B33 | 65-5328   | Steering damper centre.                               | 1                  |
| 50                    | B31 B33 | 25-5247   | Steering damper star washer                           | 1                  |
| 51                    | B31 B33 | 42-5014   | Steering damper anchor plate                          | 1                  |
| 52                    | B31 B33 | 2-49      | Steering damper anchor plate bolt nut                 | 1                  |
| 53                    | B31 B33 | 36-382    | Steering damper anchor plate bolt washer (shakeproof) | 1                  |
| 54                    | B31 B33 | 2-923     | Steering damper anchor plate bolt washer (plain)      | 1                  |
| 55                    | B31 B33 | 28-2338   | Steering damper anchor plate bolt                     | 1                  |
| 56                    | B31 B33 | 67-5021   | Steering damper adjusting rod complete                | 1                  |
| 57                    | B31 B33 | 42-5089   | Fork end cap  | 2                  |

# FRONT FORK and FITTINGS

B31 B33 (Swinging Arm)

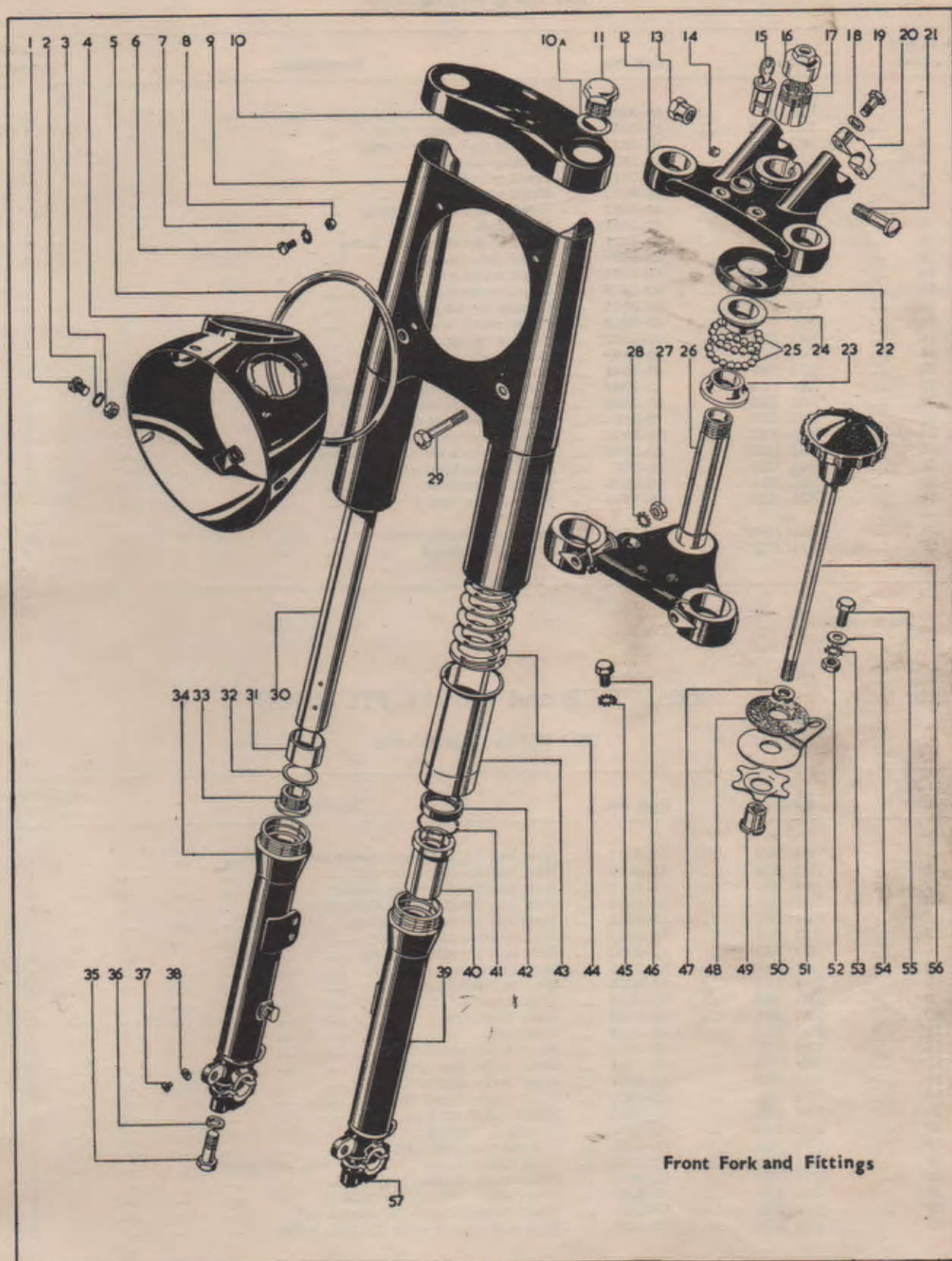

Front Fork and Fittings

Front Fork and Fittings

## Plate 8

## FRONT HUB and WHEEL FITTINGS

B31 B33 (Swinging Arm)

| Plate Ref.<br>Number. | Models. | Part No. | Description.                           | Number<br>per set. |
|-----------------------|---------|----------|--|--------------------|
| —                     | B31 B33 | 42-5809  | Front hub with rim and spoke assembly  | 1                  |
| 1                     | B31 B33 | 42-5843  | Front wheel cover plate                | 1                  |
| 2                     | B31 B33 | 42-5821  | Bearing dust cover circlip             | 1                  |
| 3                     | B31 B33 | 42-5820  | Bearing dust cover                     | 1                  |
| 4                     | B31 B33 | 42-5811  | Front wheel spoke                      | 40                 |
| 5                     | B31 B33 | 42-5810  | Front wheel rim                        | 1                  |
| 6                     | B31 B33 | 42-5812  | Front wheel spoke nipple               | 40                 |
| 7                     | B31 B33 | 42-5814  | Front hub                              | 1                  |
| 8                     | B31 B33 | 42-5837  | Front brake shoe with lining           | 2                  |
| 9                     | B31 B33 | 42-5839  | Brake shoe lining                      | 2                  |
| 10                    | B31 B33 | 42-5824  | Front wheel spindle                    | 1                  |
| 11                    | B31 B33 | 42-5863  | Front brake fulcrum pin                | 1                  |
| 12                    | B31 B33 | 42-5822  | Bearing backing ring                   | 1                  |
| 13                    | B31 B33 | 42-5819  | Front wheel bearing                    | 2                  |
| 14                    | B31 B33 | 42-5823  | Bearing retaining ring                 | 1                  |
| 15                    | B31 B33 | 42-5827  | Front brake anchor plate               | 1                  |
| 16                    | B31 B33 | 42-5842  | Front wheel spindle nut                | 1                  |
| 17                    | B31 B33 | 3-1049   | Front brake fulcrum pin washer         | 1                  |
| 18                    | B31 B33 | 42-5864  | Front brake fulcrum pin nut            | 1                  |
| 19                    | B31 B33 | 2-449    | Front brake cam spindle nut            | 1                  |
| 20                    | B31 B33 | 24-5914  | Front brake cam spindle washer         | 1                  |
| 21                    | B31 B33 | 42-5836  | Front brake lever and cable toggle pin | 1                  |
| 22                    | B31 B33 | 35-701   | Front brake lever pivot pin split pin  | 1                  |
| 23                    | B31 B33 | 42-5854  | Front brake lever                      | 1                  |
| 24                    | B31 B33 | 42-5830  | Front brake cam                        | 1                  |
| 26                    | B31 B33 | 42-5840  | Brake shoe lining rivet                | 16                 |
| 27                    | B31 B33 | 42-5841  | Brake shoe spring                      | 2                  |

## Plate 9

## REAR HUB and WHEEL FITTINGS

B31 B33 (Swinging Arm)

| Plate Ref.<br>Number. | Models. | Part No. | Description.                                  | Number<br>per set. |
|-----------------------|---------|----------|---|--------------------|
| —                     | B31 B33 | 42-6311  | Rear hub with rim and spoke assembly          | 1                  |
| 1                     | B31 B33 | 42-6077  | Rear hub fixed spindle nut                    | 1                  |
| 2                     | B31 B33 | 42-6078  | Rear hub fixed spindle washer                 | 1                  |
| 3                     | B31 B33 | 42-6324  | Rear hub fixed spindle distance collar        | 1                  |
| 4                     | B31 B33 | 42-6333  | Rear hub sprocket complete                    | 1                  |
| 5                     | B31 B33 | 42-9033  | Transmission chain (rear)                     | 1                  |
| 6                     | B31 B33 | 89-3022  | Rear hub sprocket bearing                     | 1                  |
| 7                     | B31 B33 | 42-6105  | Rear hub grease retainer                      | 1                  |
| 8                     | B31 B33 | 42-6325  | Rear hub fixed spindle                        | 1                  |
| 9                     | B31 B33 | 42-6328  | Dust cover                                    | 1                  |
| 10                    | B31 B33 | 42-5810  | Rear wheel rim                                | 1                  |
| 11                    | B31 B33 | 42-6313  | Rear hub                                      | 1                  |
| 12                    | B31 B33 | 42-5839  | Rear brake shoe lining                        | 2                  |
| 13                    | B31 B33 | 42-5841  | Rear brake shoe spring                        | 2                  |
| 14                    | B31 B33 | 42-5837  | Rear brake shoe with lining                   | 2                  |
| 15                    | B31 B33 | 42-6329  | Bearing abutment ring                         | 1                  |
| 16                    | B31 B33 | 42-6323  | Spindle distance piece                        | 1                  |
| 17                    | B31 B33 | 42-5819  | Rear hub bearing                              | 1                  |
| 18                    | B31 B33 | 42-6335  | Bearing retaining ring                        | 1                  |
| 19                    | B31 B33 | 42-6314  | Rear brake anchor plate with stud and locknut | 1                  |
| 20                    | B31 B33 | 42-5828  | Rear brake fulcrum pin                        | 1                  |
| 21                    | B31 B33 | 2-2138   | Rear brake fulcrum pin washer                 | 1                  |
| 22                    | B31 B33 | 40-162   | Rear brake fulcrum pin domed nut              | 1                  |
| 23                    | B31 B33 | 42-6330  | Rear hub anchor plate distance collar         | 1                  |

Plate 8 FRONT HUB  
and WHEEL FITTINGS  
B31 B33 (Swinging Arm)

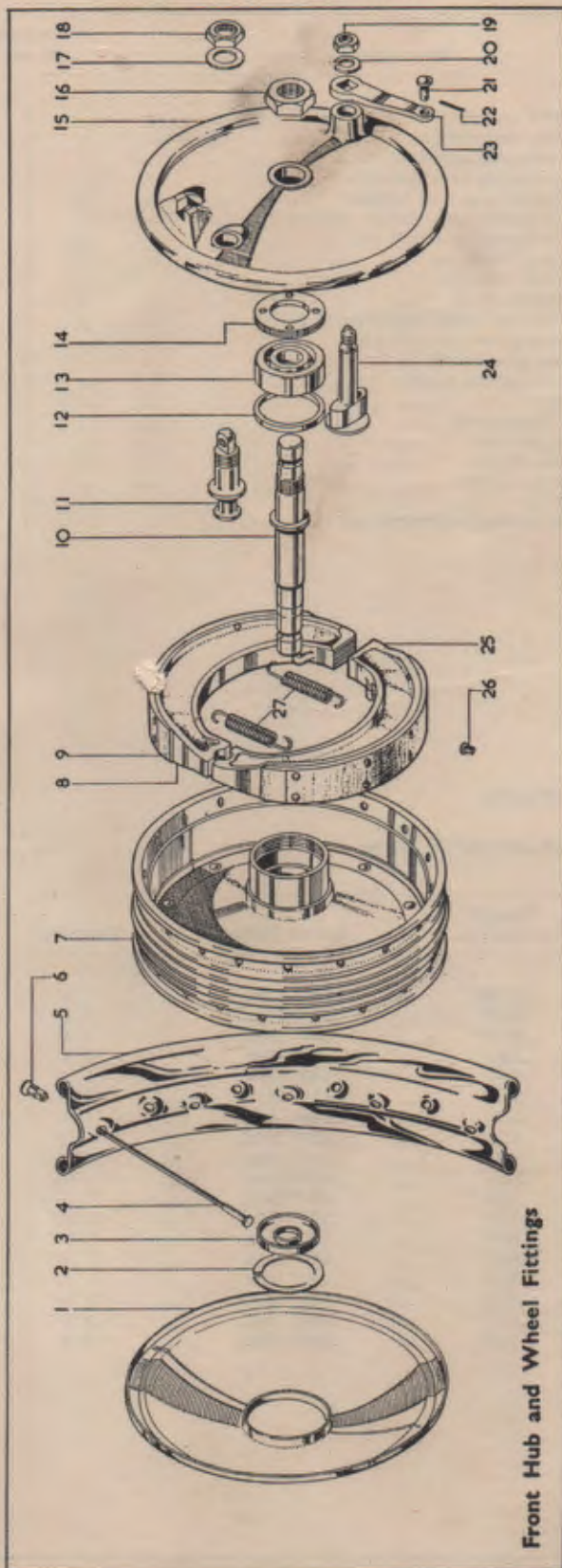
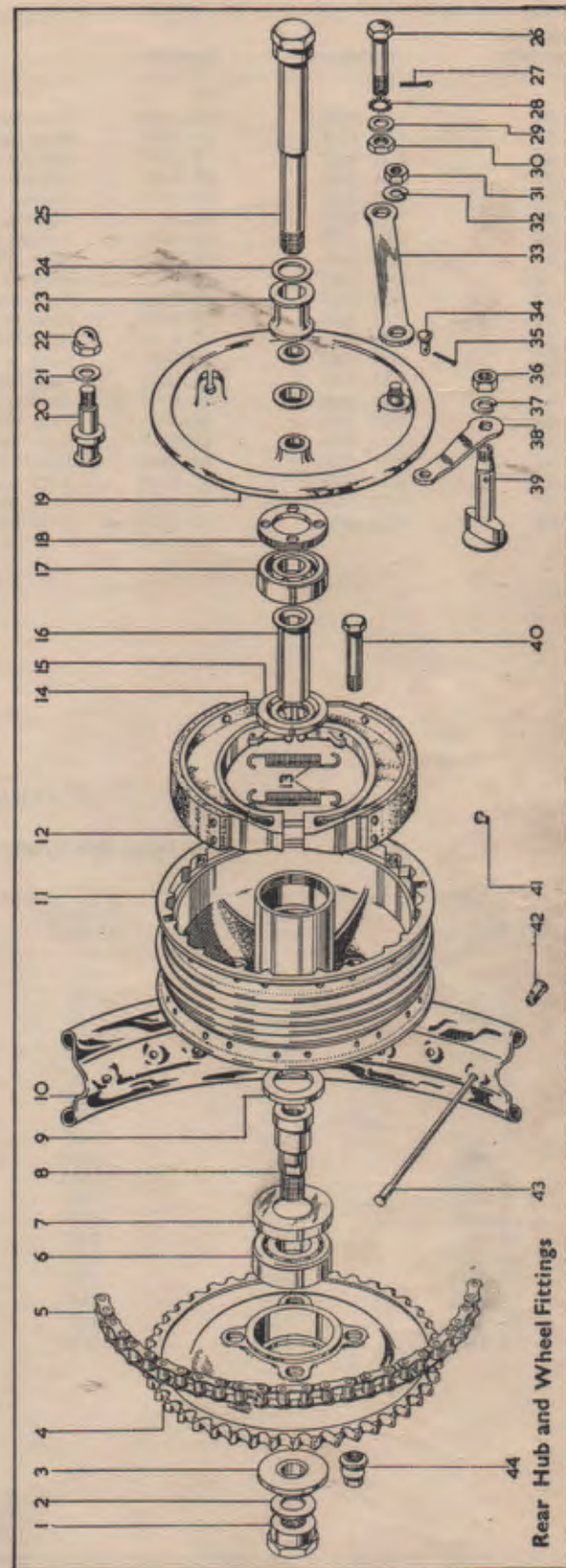

Plate 9 REAR HUB  
and WHEEL FITTINGS  
B31 B33 (Swinging Arm)



## Plate 9—continued

## REAR HUB and WHEEL FITTINGS

## B31 B33 (Swinging Arm)

| Plate Ref.<br>Number. | Models.     | Part No.    | Description.                                    | Number<br>per set. |
|-----------------------|-------------|-------------|---|--------------------|
| 24 ...                | B31 B33 ... | 42-6336 ... | Rear hub spindle washer ...                     | 1                  |
| 25 ...                | B31 B33 ... | 42-6320 ... | Rear hub spindle complete ...                   | 1                  |
| 26 ...                | B31 B33 ... | 3-855 ...   | Anchor strap swinging arm bolt ...              | 1                  |
| 27 ...                | B31 B33 ... | 35-705 ...  | Anchor strap swinging arm split pin ...         | 1                  |
| 28 ...                | B31 B33 ... | 66-4708 ... | Anchor strap swing arm bolt washer ...          | 1                  |
| 29 ...                | B31 B33 ... | 15-431 ...  | Anchor strap swinging arm washer (plain)...     | 1                  |
| 30 ...                | B31 B33 ... | 24-5860 ... | Anchor strap swinging arm bolt nut ...          | 1                  |
| 31 ...                | B31 B33 ... | 15-541 ...  | Rear anchor plate stud nut ...                  | 1                  |
| 32 ...                | B31 B33 ... | 15-716 ...  | Rear anchor plate washer ...                    | 1                  |
| 33 ...                | B31 B33 ... | 42-6084 ... | Rear brake anchor strap ...                     | 1                  |
| 34 ...                | B31 B33 ... | 42-5836 ... | Rear brake lever and cable toggle pivot pin ... | 1                  |
| 35 ...                | B31 B33 ... | 35-701 ...  | Rear brake lever pivot pin split pin ...        | 1                  |
| 36 ...                | B31 B33 ... | 2-449 ...   | Rear brake cam spindle nut ...                  | 1                  |
| 37 ...                | B31 B33 ... | 24-5914 ... | Rear brake cam spindle washer ...               | 1                  |
| 38 ...                | B31 B33 ... | 42-6317 ... | Rear brake lever ...                            | 1                  |
| 39 ...                | B31 B33 ... | 42-5830 ... | Rear brake cam assembly ...                     | 1                  |
| 40 ...                | B31 B33 ... | 42-6326 ... | Rear hub sprocket bolt ...                      | 4                  |
| 41 ...                | B31 B33 ... | 42-5840 ... | Rear brake shoe rivet... ..                     | 16                 |
| 42 ...                | B31 B33 ... | 42-5812 ... | Rear wheel spoke nipple ...                     | 40                 |
| 43 ...                | B31 B33 ... | 42-5811 ... | Rear wheel spoke ...                            | 40                 |
| 44 ...                | B31 B33 ... | 42-6327 ... | Rear hub sprocket bolt spherical nut ...        | 1                  |

## STANDARD BOLTS

All Bolts are C.E.I. unless otherwise stated

| Part No.    | Length<br>under Head. | Thickness<br>of Head. | Length<br>of Thread. | Across Flats. | Diameter. |
|-------------|-----------------------|-----------------------|----------------------|---------------|-----------|
| 2-14 ...    | 1:1/32"               | 3/16"                 | 13/16"               | .440" Hex.    | 1/4"      |
| 2-204 ...   | 1/2"                  | 3/16"                 | 1/2"                 | .440" Hex.    | 1/4"      |
| 2-220 ...   | 3/8"                  | 3/16"                 | 3/8"                 | .440" Hex.    | 1/4"      |
| 2-1354 ...  | .641"                 | .187"                 | .641"                | .440" Hex.    | 1/4"      |
| 2-1402 ...  | 7/8"                  | 1/8"                  | 3/8"                 | .440" Hex.    | 1/4"      |
| 2-2273 ...  | 7/16"                 | 5/32"                 | 3/8"                 | .440" Hex.    | 1/4"      |
| 24-225 ...  | .750"                 | .187"                 | 3/8"                 | .440" Hex.    | 1/4"      |
| 1-5069 ...  | .625"                 | .187"                 | .625"                | .525" Hex.    | 5/16"     |
| 2-129 ...   | .750"                 | .250"                 | .625"                | .440" Hex.    | 5/16"     |
| 2-1934 ...  | .750"                 | .156"                 | .625"                | .440" Hex.    | 5/16"     |
| 2-6026 ...  | 1.187"                | .156"                 | .625"                | .440" Hex.    | 5/16"     |
| 15-480 ...  | 1.109"                | .250"                 | .781"                | .525" Hex.    | 5/16"     |
| 15-1355 ... | 1.500"                | .218"                 | .625"                | .525" Hex.    | 5/16"     |
| 15-7354 ... | .625"                 | .156"                 | .625"                | .440" Hex.    | 5/16"     |
| 27-6311 ... | .750"                 | .125"                 | .625"                | .440" Hex.    | 5/16"     |
| 28-2338 ... | .718"                 | .218"                 | .687"                | .525" Hex.    | 5/16"     |
| 24-649 ...  | .877"                 | .187"                 | .877"                | .594" Hex.    | 3/8"      |
| 65-4185 ... | 2.687"                | .250"                 | .750"                | .504" Hex.    | 3/8"      |

## B31 B33 (Swinging Arm)

| Plate Ref.<br>Number. | Models. | Part No. | Description.   | Number<br>per set. |
|-----------------------|---------|----------|--|--------------------|
| 1                     | B31 B33 | 67-6881  | Rear number plate                                    | 1                  |
| 2                     | B31 B33 | 67-6851  | Rear number plate rubber extrusion                   | 1                  |
| 3                     | B31 B33 | 2-49     | Oil tank tap fixing bolt nut                         | 1                  |
| 4                     | B31 B33 | 2-537    | Oil tank top fixing bolt washer                      | 2                  |
| 5                     | B31 B33 | 42-8341  | Oil tank tap fixing bolt rubber                      | 1                  |
| 6                     | B31 B33 | 42-8351  | Oil tank fixing bracket                              | 1                  |
| 7                     | B31 B33 | 42-8331  | Oil tank top fixing bolt spacing tube                | 1                  |
| 8                     | B31 B33 | 42-8329  | Oil tank front fixing bolt saddle washer             | 1                  |
| 9                     | B31 B33 | 2-49     | Oil tank front fixing bolt nut                       | 1                  |
| 10                    | B31 B33 | 2-537    | Oil tank top fixing bolt washer                      | 1                  |
| 11                    | B31 B33 | 42-8341  | Oil tank front fixing bolt rubber                    | 1                  |
| 12                    | B31 B33 | 42-8385  | Oil tank fixing bolt                                 | 1                  |
| 13                    | B31 B33 | 42-8340  | Rocker feed pipe banjo locknut                       | 1                  |
| 14                    | B31 B33 | 2-2894   | Rocker feed pipe banjo washer (fibre)                | 1                  |
| 15                    | B31 B33 | 42-8331  | Oil tank front fixing spacing tube                   | 1                  |
| 16                    | B31 B33 | 42-8339  | Oil tank top fixing spacing tube                     | 1                  |
| 17                    | B31 B33 | 2-537    | Oil tank top fixing bolt washer (plain)              | 1                  |
| 18                    | B31 B33 | 29-5289  | Oil tank top fixing bolt                             | 1                  |
| 19                    | B31 B33 | 42-8367  | Oil tank with fixed fittings                         | 1                  |
| 20                    | B31 B33 | 42-8342  | Oil tank mounting strip (rubber)                     | 1                  |
| 21                    | B31 B33 | 67-42    | Oil tank filler cap washer                           | 1                  |
| 22                    | B31 B33 | 65-8500  | Oil tank filler cap                                  | 1                  |
| 23                    | B31 B33 | 29-4329  | Support bridge bottom fixing and licence holder bolt | 1                  |
| 24                    | B31 B33 | 42-5101  | Licence holder distance tube                         | 1                  |
| 25                    | B31 B33 | 2-923    | Licence holder distance tube washer                  | 1                  |
| 26                    | B31 B33 | 2-204    | Front mudguard support bridge screw                  | 2                  |
| 27                    | B31 B33 | 66-7518  | Front mudguard support bridge washer (fibre)         | 2                  |
| 28                    | B31 B33 | 2-1462   | Front mudguard support bridge washer (spring)        | 2                  |
| 29                    | B31 B33 | 27-8560  | Front mudguard support bridge washer (plain)         | 2                  |
| 30                    | B31 B33 | 2-2395   | Front mudguard support bridge fixing screw nut       | 2                  |
| 31                    | B31 B33 | 67-6543  | Front mudguard with fixed fittings                   | 1                  |
| 32                    | B31 B33 | 2-204    | Front mudguard stay fixing bolt                      | 2                  |
| 33                    | B31 B33 | 2-1462   | Front mudguard stay fixing bolt washer (spring)      | 2                  |
| 34                    | B31 B33 | 27-8560  | Front mudguard stay fixing bolt washer (plain)       | 2                  |
| 35                    | B31 B33 | 67-6547  | Front mudguard stay insulator                        | 2                  |
| 36                    | B31 B33 | 42-6528  | Front mudguard stay                                  | 1                  |
| 37                    | B31 B33 | 24-8784  | Front mudguard stay fork end washer (spring)         | 2                  |
| 38                    | B31 B33 | 15-7354  | Front mudguard stay fork end bolt                    | 2                  |
| 39                    | B31 B33 | 2-2395   | Front mudguard stay fork end bolt nut                | 2                  |
| 40                    | B31 B33 | 28-2338  | Support bridge fixing bolt (bottom)                  | 3                  |
| 41                    | B31 B33 | 36-382   | Support bridge fixing bolt washer (shakeproof)       | 4                  |
| 42                    | B31 B33 | 2-2395   | Front mudguard stay fixing bolt nut                  | 2                  |
| 43                    | B31 B33 | 67-6548  | Front mudguard bridge stay insulator                 | 2                  |
| 44                    | B31 B33 | 2-49     | Support bridge fixing bolt nut (bottom)              | 4                  |
| 45                    | B31 B33 | 65-6623  | Front mudguard support bridge                        | 1                  |
| 46                    | B31 B33 | 15-447   | Front stand mudguard fixing bolt nut                 | 2                  |
| 47                    | B31 B33 | 24-8784  | Front stand fork end fixing bolt washer              | 2                  |
| 48                    | B31 B33 | 15-7354  | Front stand fork end fixing bolt                     | 2                  |
| 49                    | B31 B33 | 2-1354   | Front stand mudguard fixing bolt                     | 2                  |
| 50                    | B31 B33 | 42-6530  | Front stand  | 1                  |
| 51                    | B31 B33 | 42-8426  | Oil tank filter                                      | 1                  |
| 52                    | B31 B33 | 42-8343  | Oil tank filter washer (fibre)                       | 1                  |
| 53                    | B31 B33 | 42-8422  | Oil tank return pipe                                 | 1                  |
| 54                    | B31 B33 | 42-8422  | Oil tank feed pipe                                   | 1                  |
| 55                    | B31 B33 | 42-6853  | Rear mudguard distance piece (rubber)                | 2                  |
| 56                    | B31 B33 | 42-6759  | Rear mudguard fixing clip                            | 2                  |
| 57                    | B31 B33 | 2-525    | Rear mudguard fixing clip bolt washer                | 4                  |
| 58                    | B31 B33 | 24-8328  | Rear mudguard fixing clip bolt                       | 4                  |
| 59                    | B31 B33 | 2-49     | Rear mudguard stay frame bracket bolt nut            | 4                  |
| 60                    | B31 B33 | 24-8784  | Rear mudguard stay frame bracket bolt washer         | 4                  |
| 61                    | B31 B33 | 67-6761  | Mudguard stay frame bracket (O/S)                    | 1                  |
| 61                    | B31 B33 | 67-6762  | Mudguard stay frame bracket (N/S)                    | 1                  |
| 62                    | B31 B33 | 28-2338  | Mudguard stay frame bracket bolt                     | 4                  |
| 63                    | B31 B33 | 2-923    | Mudguard stay frame bracket bolt washer              | 4                  |
| 64                    | B31 B33 | 24-8784  | Mudguard stay frame bracket frame bolt washer        | 2                  |
| 65                    | B31 B33 | 67-8313  | Mudguard stay frame bracket bolt                     | 2                  |
| 66                    | B31 B33 | 42-6858  | Rear mudguard stay (N/S)                             | 1                  |
| 66                    | B31 B33 | 42-6860  | Rear mudguard stay (O/S)                             | 1                  |
| 67                    | B31 B33 | 24-8784  | Rear mudguard stay fixing bolt washer                | 4                  |
| 68                    | B31 B33 | 2-49     | Mudguard stay fixing bolt nut                        | 4                  |

Plate 10 MUDGUARDS, OIL TANK, SILENCER and TOOLBOX  
B31 B33 (Swinging Arm)

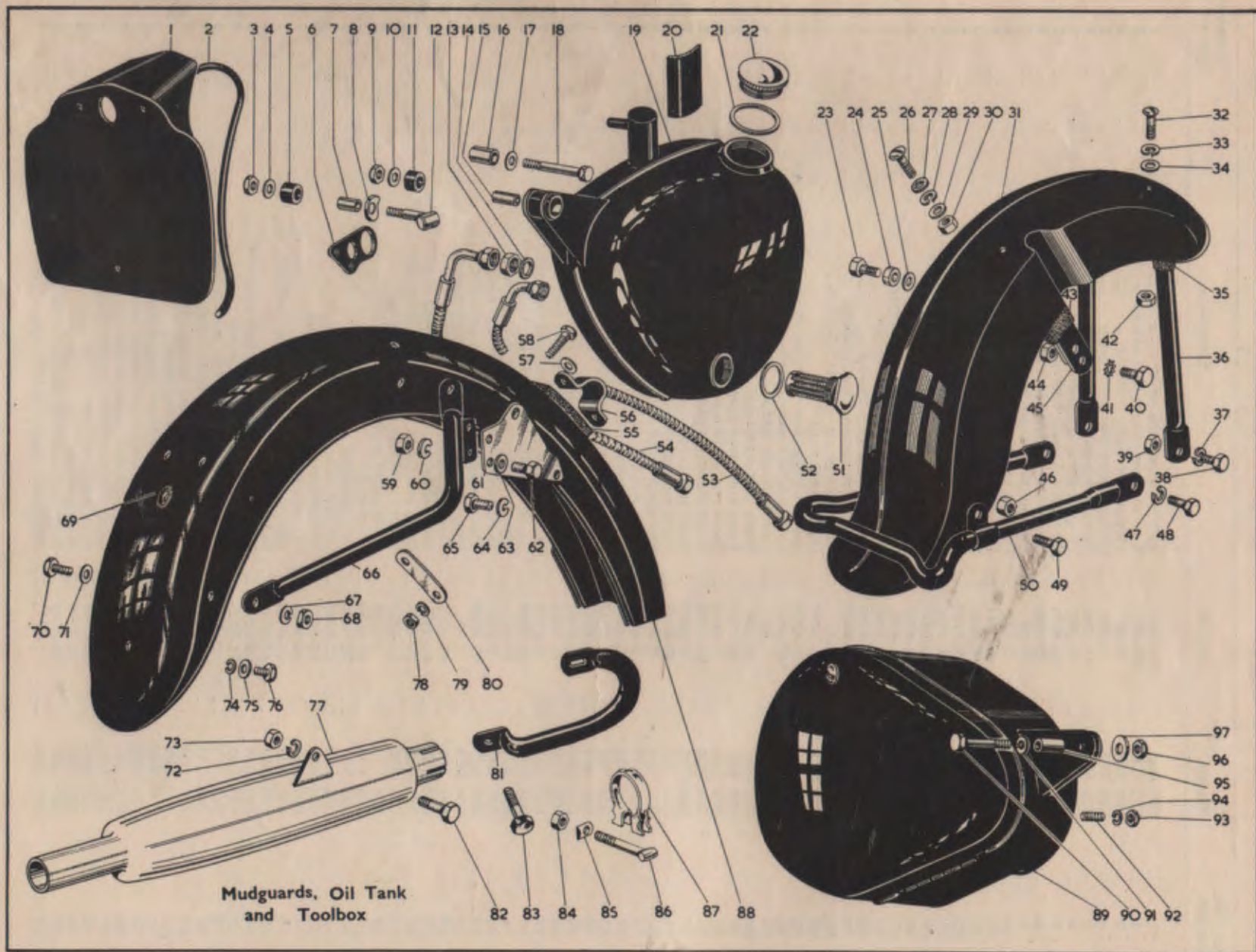

## Plate 10—continued

MUDGUARDS, OIL TANK,  
SILENCER and TOOLBOX

B31 B33 (Swinging Arm)

| Plate Ref.<br>Number. | Models. | Part No. | Description.                                 | Number<br>per set. |
|-----------------------|---------|----------|--|--------------------|
| 69                    | B31 B33 | 67-6839  | Rear mudguard wiring grommet                 | 2                  |
| 70                    | B31 B33 | 28-2338  | Mudguard stay fixing bolt                    | 2                  |
| 71                    | B31 B33 | 2-923    | Mudguard stay fixing bolt washer             | 4                  |
| 72                    | B31 B33 | 2-522    | Silencer fixing bracket bolt washer          | 1                  |
| 73                    | B31 B33 | 2-449    | Silencer fixing bracket bolt nut             | 1                  |
| 74                    | B31 B33 | 2-1462   | Rear number plate fixing bolt washer         | 4                  |
| 75                    | B31 B33 | 27-8560  | Rear number plate fixing bolt washer (plain) | 4                  |
| 76                    | B31 B33 | 2-220    | Rear number plate fixing bolt                | 4                  |
| 77                    | B31 B33 | 42-2970  | Silencer                                     | 1                  |
| 78                    | B31 B33 | 2-2395   | Mudguard fixing clip bolt nut                | 4                  |
| 79                    | B31 B33 | 2-1462   | Mudguard fixing clip bolt washer             | 4                  |
| 80                    | B31 B33 | 42-6782  | Mudguard stiffening plate                    | 2                  |
| 81                    | B31 B33 | 42-6865  | Lifting handle                               | 1                  |
| 82                    | B31 B33 | 2-803    | Silencer fixing bracket bolt                 | 1                  |
| 83                    | B31 B33 | 27-6037  | Mudguard stay and lifting handle bolt        | 2                  |
| 84                    | B31 B33 | 21-5102  | Silencer and exhaust pipe clip nut           | 1                  |
| 85                    | B31 B33 | 90-3064  | Silencer and exhaust pipe clip swivel        | 1                  |
| 86                    | B31 B33 | 90-3063  | Silencer and exhaust pipe clip pin           | 1                  |
| 87                    | B31 B33 | 42-2861  | Silencer and exhaust pipe clip               | 1                  |
| 88                    | B31 B33 | 42-6856  | Rear mudguard with fixed fittings            | 1                  |
| 89                    | B31 B33 | 42-9189  | Toolbox complete with fixed fittings         | 1                  |
| 90                    | B31 B33 | 29-4329  | Toolbox fixing bolt (top)                    | 1                  |
| 91                    | B31 B33 | 24-8784  | Toolbox fixing bolt washer (spring)          | 1                  |
| 92                    | B31 B33 | 65-5368  | Toolbox fixing stud                          | 2                  |
| 93                    | B31 B33 | 2-49     | Toolbox fixing stud nut                      | 2                  |
| 94                    | B31 B33 | 24-8784  | Toolbox fixing stud washer (spring)          | 2                  |
| 95                    | B31 B33 | 42-8339  | Toolbox fixing bolt distance tube (top)      | 1                  |
| 96                    | B31 B33 | 2-49     | Toolbox fixing bolt nut (top)                | 1                  |
| 97                    | B31 B33 | 27-5676  | Toolbox fixing bolt washer (top)             | 1                  |

## STANDARD BOLTS

All Bolts are C.E.I. (Screwdriver slotted) unless otherwise stated

| Part No. | Length<br>under Head. | Thickness<br>of Head. | Length<br>of Thread. | Across Head. | Diameter.   |
|----------|-----------------------|-----------------------|----------------------|--------------|-------------|
| 1-4806   | .500"                 | .125"                 | .500"                | .312"        | 3/16"       |
| 3-360    | .406"                 | .078"                 | .406"                | .312"        | 3/16"       |
| 2-498    | .312"                 | .062"                 | .312"                | .312"        | 3/16" Whit. |
| 2-1309   | .343"                 | .062"                 | .343"                | .312"        | 3/16"       |
| 2-2582   | .343"                 | .125"                 | .343"                | .250"        | 3/16" Whit. |
| 24-7065  | .250"                 | .062"                 | .250"                | .312"        | 3/16"       |
| 2-77     | .312"                 | .062"                 | .312"                | .375"        | 1/4"        |
| 2-79     | .500"                 | .109"                 | .500"                | .375"        | 1/4"        |
| 2-510    | .656"                 | .093"                 | .375"                | .375"        | 1/4"        |
| 2-1500   | .687"                 | .109"                 | .375"                | .375"        | 1/4"        |
| 2-2210   | .718"                 | .062"                 | .562"                | .562"        | 1/4"        |
| 2-3718   | .656"                 | .109"                 | .656"                | .375"        | 1/4"        |
| 15-7161  | .500"                 | .125"                 | .312"                | .500"        | 1/4"        |
| 2-2980   | 1.25"                 | .93"                  | .625"                | .562"        | 5/16"       |

## Plate 11

# PETROL TANK, HANDLEBAR and DUAL SEAT B31 B33 (Swinging Arm)

| Plate Ref.<br>Number. | Models. | Part No. | Description.                                    | Number<br>per set. |
|-----------------------|---------|----------|---|--------------------|
| 1                     | B31 B33 | 65-8516  | Throttle twist grip control (less cables cover) | 1                  |
| 2                     | B31 B33 | 42-8655  | Combined front brake and air control complete   | 1                  |
| 3                     | B31 B33 | 42-8726  | Front brake cable and cover complete            | 1                  |
| 4                     | B31 B33 | 65-8813  | Throttle cable and cover complete               | 1                  |
| 5                     | B31 B33 | 42-8693  | Air control cable and cover complete            | 1                  |
| 6                     | B31 B33 | 65-4960  | Handlebar                                       | 1                  |
| 7                     | B31 B33 | 65-8502  | Dummy grip (L/H bar)                            | 1                  |
| 8                     | B31 B33 | 29-8820  | Clutch control complete (less cable and cover)  | 1                  |
| 9                     | B31 B33 | 66-8513  | Exhaust control complete (less cable and cover) | 1                  |
| 10                    | B31 B33 | 65-8795  | Exhaust lifter cable and cover complete         | 1                  |
| 11                    | B31 B33 | 65-8680  | Clutch control cable and cover complete         | 1                  |
| 12                    | B31 B33 | 29-7898  | Petrol tank filler cap                          | 1                  |
| 13                    | B31 B33 | 42-8034  | Petrol tank badge clip screw nut                | 4                  |
| 14                    | B31 B33 | 42-8020  | Petrol tank badge clip                          | 2                  |
| 15                    | B31 B33 | 2-79     | Knee grip screw                                 | 4                  |
| 16                    | B31 B33 | 65-8220  | Petrol tank badge                               | 2                  |
| 17                    | B31 B33 | 65-8317  | Petrol tank badge clip screw                    | 4                  |
| 18                    | B31 B33 | 42-8051  | Petrol tank rubber (top tube)                   | 2                  |
| 19                    | B31 B33 | 42-8052  | Petrol tank anti-roll rubber                    | 2                  |
| 20                    | B31 B33 | 65-8206  | Knee grip (N/S)                                 | 1                  |
| 20                    | B31 B33 | 65-8205  | Knee grip (O/S)                                 | 1                  |
| 21                    | B31 B33 | 2-923    | Petrol tank stiffening plate stud washer        | 2                  |
| 22                    | B31 B33 | 2-49     | Petrol tank stiffening plate stud nut           | 2                  |
| 23                    | B31 B33 | 36-382   | Petrol tank stiffening plate stud washer        | 2                  |
| 24                    | B31 B33 | 42-8058  | Petrol tank stiffening plate                    | 1                  |
| 25                    | B31 B33 | 24-8504  | Petrol tap washer (fibre) (.078")               | As required        |
| 25                    | B31 B33 | 65-8218  | Petrol tap washer (fibre) ( $\frac{1}{16}$ ")   | As required        |
| 26                    | B31 B33 | 65-8219  | Petrol tap washer (fibre) ( $\frac{3}{32}$ ")   | As required        |
| 26                    | B31 B33 | 65-8216  | Petrol tap                                      | 1                  |
| 27                    | B31 B33 | 42-9060  | Dual seat front support pin                     | 1                  |
| 28                    | B31 B33 | 15-645   | Dual seat front support pin bolt                | 1                  |
| 29                    | B31 B33 | 28-2338  | Dual seat fixing bolt                           | 2                  |
| 30                    | B31 B33 | 2-923    | Dual seat fixing bolt washer                    | 2                  |
| 31                    | B31 B33 | 35-33    | Dual seat fixing bolt washer (spring)           | 2                  |
| 32                    | B31 B33 | 42-9058  | Dual seat front support bracket                 | 1                  |
| 33                    | B31 B33 | 42-9197  | Dual seat support rubber                        | 2                  |
| 34                    | B31 B33 | 42-8076  | Petrol Pipe (plastic)                           | 1                  |
| 35                    | B31 B33 | 36-382   | Mudguard bridge and dual seat bracket washer    | 2                  |
| 36                    | B31 B33 | 2-49     | Mudguard bridge and dual seat bracket nut       | 2                  |
| 37                    | B31 B33 | 2-49     | Dual seat rear fixing stud nut                  | 2                  |
| 38                    | B31 B33 | 42-9077  | Dual seat rear fixing stud                      | 2                  |
| 39                    | B31 B33 | 42-9196  | Dual seat rear support bracket                  | 1                  |
| 40                    | B31 B33 | 2-923    | Mudguard bridge and dual seat bolt washer       | 2                  |
| 41                    | B31 B33 | 28-2338  | Mudguard bridge and dual seat fixing bolt       | 2                  |
| 42                    | B31 B33 | 42-9072  | Dual seat complete with brackets                | 1                  |
| 43                    | B31 B33 | 42-9073  | Dual seat loose fittings (sets)                 | 1                  |
| 43                    | B31 B33 | 42-8104  | Petrol tank (4 gallon)                          | 1                  |
| 44                    | B31 B33 | 42-8043  | Petrol tank (2 gallon)                          | As required.       |
| 45                    | B31 B33 | 42-8012  | Petrol tank mounting rubber (top)               | 1                  |
| 46                    | B31 B33 | 2-1945   | Petrol tank fixing bolt washer                  | 1                  |
| 46                    | B31 B33 | 42-8011  | Petrol tank fixing bolt                         | 1                  |
| 47                    | B31 B33 | 42-8010  | Petrol tank rubber grommet                      | 1                  |

## PISTONS

B31 B33 (Swinging Arm)

| Model | Comp.<br>Ratio | Pistons Complete |                        |           | Compression Rings (2) |                        |           | Scraper Rings |                        |           |
|-------|----------------|------------------|------------------------|-----------|-----------------------|------------------------|-----------|---------------|------------------------|-----------|
|       |                | Standard         | $\frac{1}{2}$ mm. O.S. | 1mm. O.S. | Standard              | $\frac{1}{2}$ mm. O.S. | 1mm. O.S. | Standard      | $\frac{1}{2}$ mm. O.S. | 1mm. O.S. |
| B31   | 6.5            | 65-809           | 65-811                 | 65-813    | 65-744                | 65-745                 | 65-746    | 65-735        | 65-736                 | 65-737    |
| B33   | 7.5            | 65-1660          | 65-1662                | 65-1664   | 65-1250               | 65-1251                | 65-1252   | 65-1253       | 65-1254                | 65-1255   |

# PETROL TANK, HANDLEBAR and DUAL SEAT B31 B33 (Swinging Arm)

Petrol Tank,  
Handlebar,  
and Dual Seat

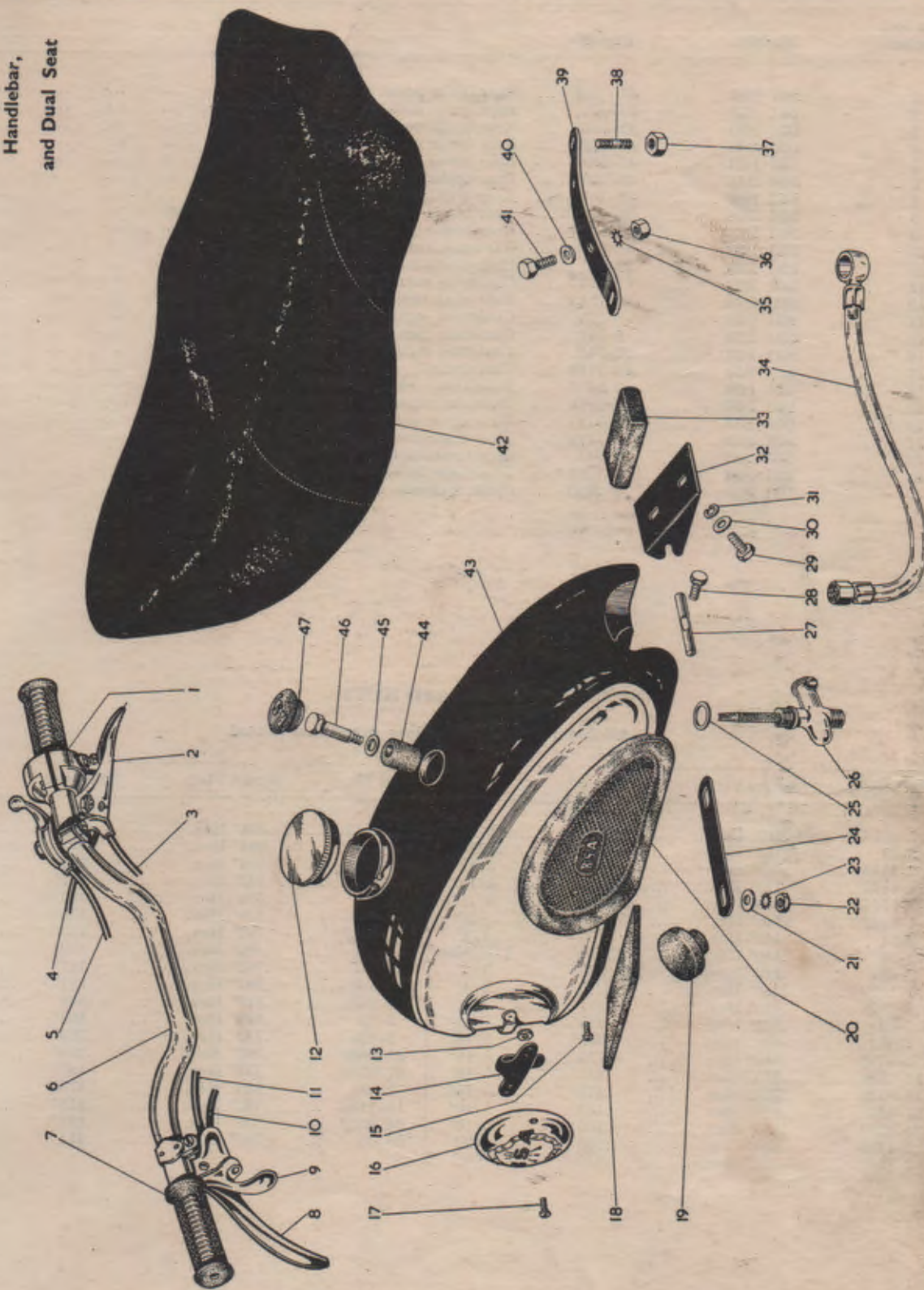

Petrol  
Tank  
and Dual  
Seat

# Plate 12 CHAINGUARD, CHAINCASE and REAR BRAKE CONTROL

B31 B33 (Swinging Arm)

| Plate Ref.<br>Number. | Models. | Part No. | Description.                                 | Number<br>per set. |
|-----------------------|---------|----------|--|--------------------|
| 1                     | B31 B33 | 24-7343  | Rear brake pedal bolt                        | 1                  |
| 2                     | B31 B33 | 24-978   | Rear brake pedal bolt washer (spring)        | 1                  |
| 3                     | B31 B33 | 42-7027  | Rear brake pedal                             | 1                  |
| 4                     | B31 B33 | 42-4355  | Rear brake pedal return spring               | 1                  |
| 5                     | B31 B33 | 42-4349  | Rear brake cross shaft                       | 1                  |
| 6                     | B31 B33 | 42-7032  | Rear brake cable complete                    | 1                  |
| 7                     | B31 B33 | 42-7031  | Rear brake cross shaft lever bolt            | 1                  |
| 8                     | B31 B33 | 24-978   | Rear brake cross shaft lever washer (spring) | 1                  |
| 9                     | B31 B33 | 42-4350  | Rear brake cross shaft lever                 | 1                  |
| 10                    | B31 B33 | 42-8010  | Chaincase rubber grommet                     | 2                  |
| 11                    | B31 B33 | 29-541   | Chaincase securing bolt washer (S/Proof.)    | 6                  |
| 12                    | B31 B33 | 24-7343  | Chaincase securing bolt (top and bottom)     | 4                  |
| 13                    | B31 B33 | 42-7715  | Rear chaincase top section                   | 1                  |
| 14                    | B31 B33 | 2-525    | Chaincase securing bolt washer               | 2                  |
| 15                    | B31 B33 | 2-204    | Chaincase securing bolt (rear)               | 2                  |
| 16                    | B31 B33 | 29-541   | Chaincase securing bolt washer (S/Proof.)    | 2                  |
| 17                    | B31 B33 | 42-7730  | Chainguard                                   | 1                  |
| 18                    | B31 B33 | 42-7722  | Rear chaincase rear section                  | 1                  |
| 19                    | B31 B33 | 42-7719  | Rear chaincase bottom section                | 1                  |
| 20                    | B31 B33 | 42-7727  | Rear chaincase and footrest rubber sleeve    | 1                  |
| 21                    | B31 B33 | 42-7710  | Rear chaincase front section                 | 1                  |
| 22                    | B31 B33 | 29-541   | Chaincase fixing bolt washer (S/Proof.)      | 1                  |
| 23                    | B31 B33 | 2-1354   | Chaincase fixing bolt                        | 1                  |
| —                     | B31 B33 | 2-2899   | Rear chaincase washer (top and bottom)       | 4                  |

## STANDARD NUTS

All Nuts are C.E.I. unless otherwise stated

| Part No. | Across Flats. | Thickness. | Size.      | Part No. | Across Flats. | Thickness. | Size. |
|----------|---------------|------------|------------|----------|---------------|------------|-------|
| 1-4616   | .340" Hex.    | .162"      | 3/16"      | 2-1813   | .594" Hex.    | .218"      | 3/8"  |
| 2-47     | .312" Hex.    | .140"      | 3/16"      | 3-720    | .594" Hex.    | .187"      | 3/8"  |
| 2-1588   | .255" Hex.    | .110"      | 3/16"      | 24-5161  | .594" Hex.    | .343"      | 3/8"  |
| 15-8147  | .340" Hex.    | .125"      | 3/16"      | 24-5764  | .782" Hex.    | .312"      | 3/8"  |
| 25-7151  | .340" Hex.    | .187"      | 3/16"      | 2-440    | .594" Hex.    | .312"      | 7/16" |
| 1-6032   | .340" Hex.    | 3/16"      | 1/4"       | 2-933    | .525" Hex.    | .375"      | 7/16" |
| 2-51     | .440" Hex.    | .250"      | 1/4"       | 2-1925   | .782" Hex.    | .375"      | 7/16" |
| 2-53     | .440" Hex.    | .109"      | 1/4" Whit. | 15-152   | .592" Hex.    | .406"      | 7/16" |
| 2-443    | .440" Hex.    | .109"      | 1/4"       | 15-541   | .782" Hex.    | .281"      | 7/16" |
| 2-1027   | .340" Hex.    | 1/8"       | 1/4"       | 24-5860  | .594" Hex.    | .187"      | 7/16" |
| 2-2395   | .440" Hex.    | .187"      | 1/4"       | 25-4325  | .919" Hex.    | .540"      | 7/16" |
| 2-49     | .525" Hex.    | .218"      | 5/16"      | 2-52     | .919" Hex.    | .406"      | 1/2"  |
| 2-833    | .440" Hex.    | .343"      | 5/16"      | 2-124    | .782" Hex.    | .203"      | 1/2"  |
| 2-1616   | .440" Hex.    | .125"      | 5/16"      | 24-7000  | .782" Hex.    | .250"      | 1/2"  |
| 15-5196  | .525" Hex.    | .281"      | 5/16"      | 27-6716  | .782" Hex.    | .187"      | 1/2"  |
| 15-6524  | .525" Hex.    | .175"      | 5/16"      | 2-835    | .919" Hex.    | .375"      | 9/16" |
| 24-563   | .440" Hex.    | .187"      | 5/16"      | 15-1455  | .782" Hex.    | .218"      | 9/16" |
| 24-6040  | .525" Hex.    | .156"      | 5/16"      | 24-4255  | .919" Hex.    | .187"      | 9/16" |
| 1-1706   | .594" Hex.    | .250"      | 3/8"       | 28-53    | .782" Hex.    | .344"      | 9/16" |
| 2-46     | .594" Hex.    | .312"      | 3/8"       |          |               |            |       |

Plate 12 CHAINGUARD, CHAINCASE and REAR BRAKE CONTROL  
B31 B33 (Swinging Arm)

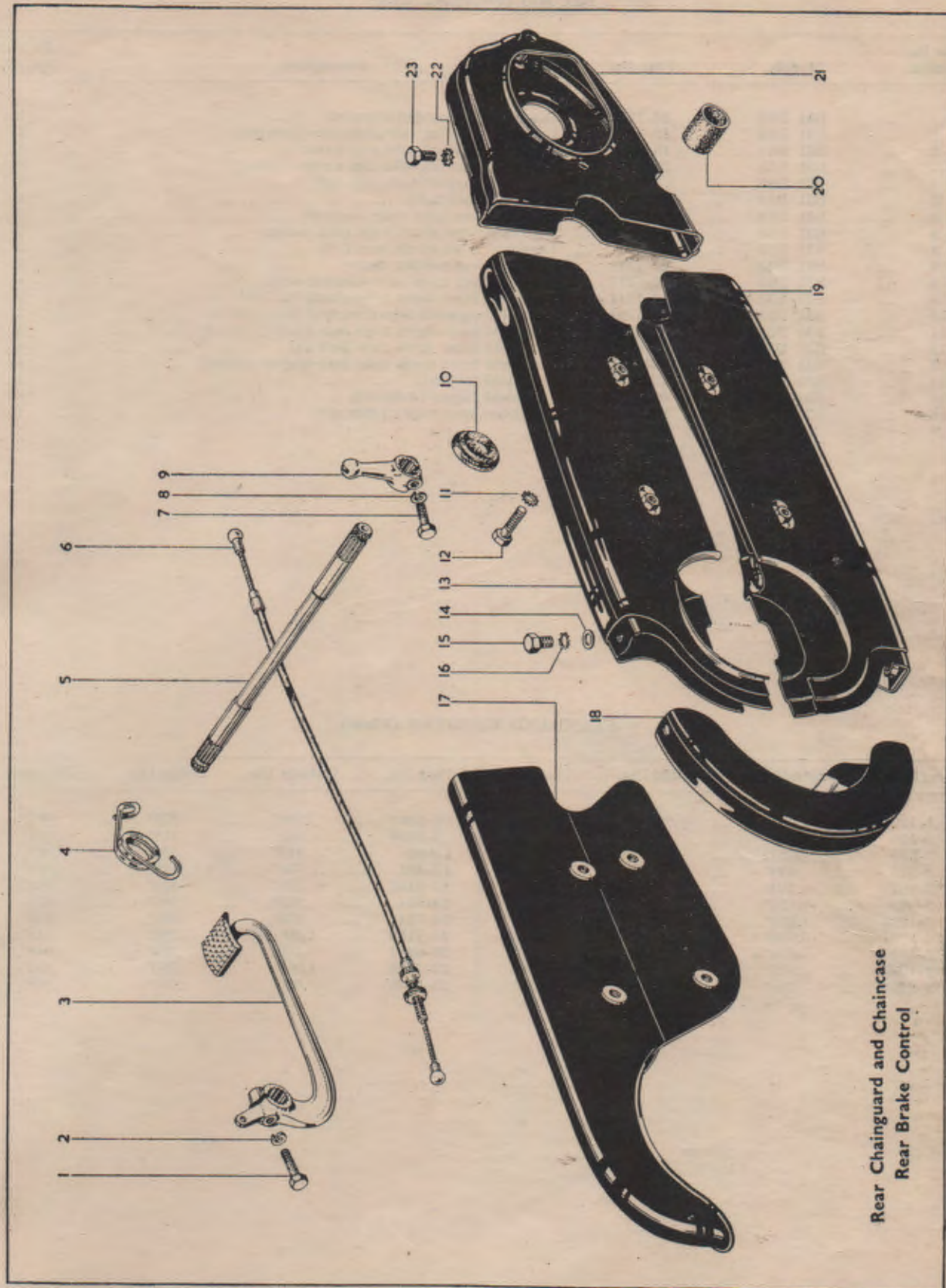

Rear Chainguard and Chaincase  
Rear Brake Control

## Plate 13

## LEGSHIELDS

## B31 B33 (Swinging Arm)

| Plate Ref.<br>Number. | Models. | Part No. | Description.                                   | Number<br>per set. |
|-----------------------|---------|----------|--|--------------------|
| ...                   | B31 B33 | 42-7219  | Legshields assembled complete                  | 1                  |
| 1                     | B31 B33 | 42-7216  | Legshield support tube complete (bottom)       | 2                  |
| 2                     | B31 B33 | 15-7161  | Legshield support tube clip screw              | 8                  |
| ...                   | B31 B33 | 27-8560  | Legshield support tube clip washer (plain)     | 8                  |
| ...                   | B31 B33 | 2-2395   | Legshield support tube clip nut                | 8                  |
| 3                     | B31 B33 | 42-7207  | Legshield (nearside)                           | 1                  |
| 4                     | B31 B33 | 67-7205  | Legshield top cross tube adaptor               | 2                  |
| 5                     | B31 B33 | 42-4906  | Legshield front down tube split clamp          | 2                  |
| 6                     | B31 B33 | 2-803    | Legshield front down tube bolt                 | 2                  |
| 7                     | B31 B33 | 42-7210  | Legshield top spacing sleeve                   | 1                  |
| 8                     | B31 B33 | 42-7211  | Legshield top cross tube adaptor stud          | 1                  |
| 9                     | B31 B33 | 42-7212  | Legshield front down tube clamp eye bolt       | 2                  |
| 10                    | B31 B33 | 66-7351  | Legshield support tube complete (top)-(1956)   | 2                  |
| 11                    | B31 B33 | 2-522    | Legshield front down tube bolt washer (spring) | 4                  |
| 12                    | B31 B33 | 2-46     | Legshield front down tube bolt nut             | 4                  |
| 13                    | B31 B33 | 2-2138   | Legshield front down tube bolt washer (plain)  | 4                  |
| 14                    | B31 B33 | 42-7206  | Legshield (offside)                            | 1                  |
| 15                    | B31 B33 | 66-7353  | Legshield support tube clip                    | 8                  |
| 16                    | B31 B33 | 27-5684  | Crankcase and engine plate stud                | 1                  |

## STANDARD WASHERS (Plain)

| Part No. | Outside Dia. | Inside Dia. | Thickness. | Part No. | Outside Dia. | Inside Dia. | Thickness. |
|----------|--------------|-------------|------------|----------|--------------|-------------|------------|
| 1-1804   | .680"        | .385"       | .072"      | 2-2580   | .500"        | .275"       | .064"      |
| 2-130    | .687"        | .380"       | .080"      | 3-3525   | .562"        | .218"       | .048"      |
| 2-370    | .625"        | .317"       | .156"      | 15-39    | .843"        | .505"       | .064"      |
| 2-525    | .500"        | .255"       | .048"      | 15-431   | .750"        | .442"       | .064"      |
| 2-861    | .750"        | .380"       | .081"      | 15-5155  | .525"        | .328"       | .048"      |
| 2-923    | .625"        | .317"       | .062"      | 24-594   | .937"        | .505"       | .092"      |
| 2-1096   | .375"        | .192"       | .044"      | 24-7911  | .875"        | .380"       | .156"      |
| 2-1291   | .750"        | .522"       | .080"      | 25-7180  | 1.00"        | .281"       | .048"      |
| 2-1374   | .656"        | .255"       | .080"      | 26-9461  | .562"        | .203"       | .048"      |
| 2-1945   | .875"        | .442"       | .064"      | 27-5676  | 1.00"        | .380"       | .092"      |
| 2-2138   | .750"        | .380"       | .064"      | 27-8560  | .625"        | .255"       | .048"      |

# LEGSHIELDS

B31 B33 (Swinging Arm)

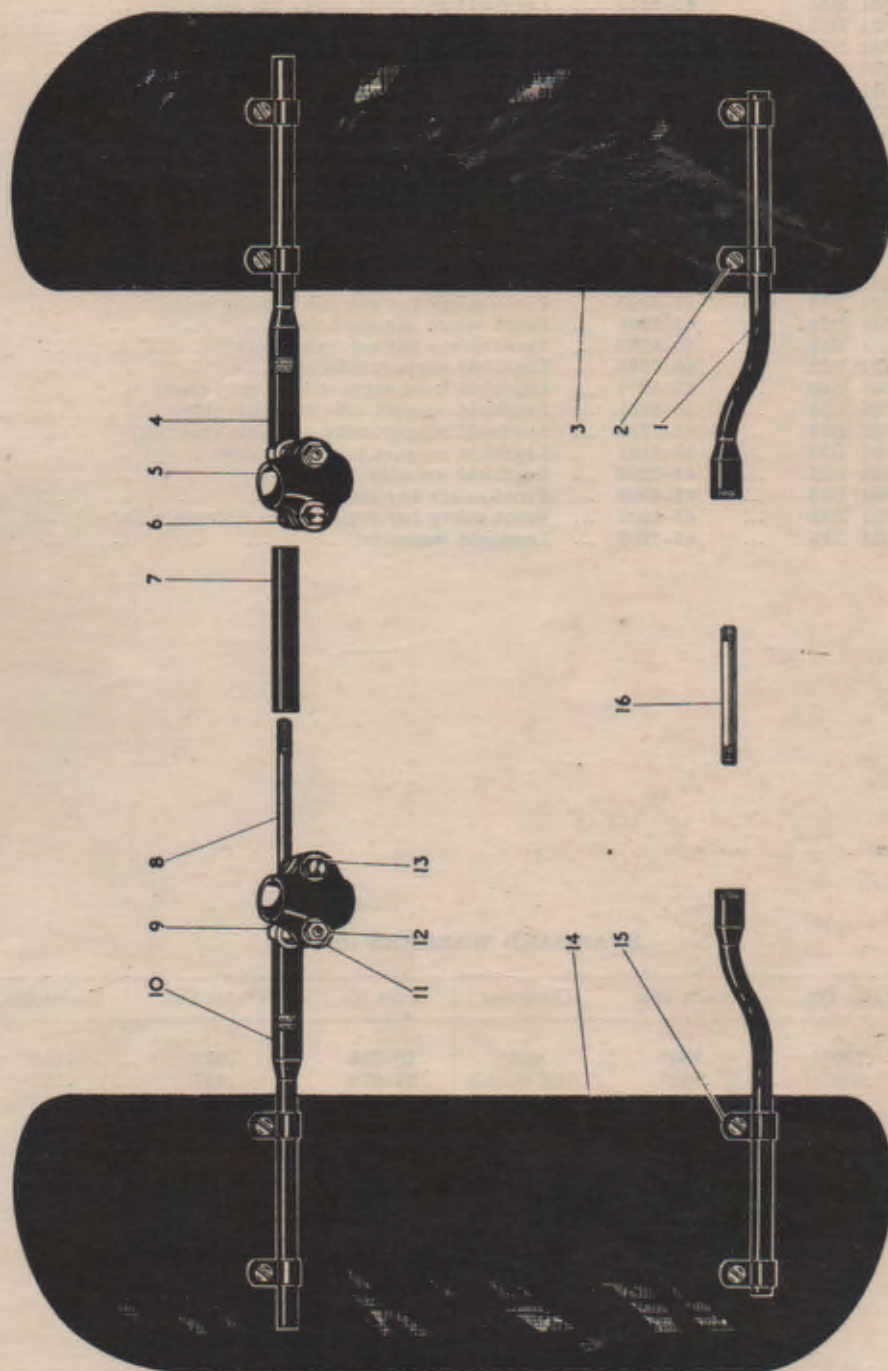

Legshields

## LEGSHIELDS and FRONT SAFETY BARS

B31 B33 (Swinging Arm)

| Plate Ref.<br>Number. | Models. | Part No. | Description.   | Number<br>per set. |
|-----------------------|---------|----------|--|--------------------|
| —                     | B31 B33 | 42-7215  | Legshield and front safety bar assembly                        | 1                  |
| 1                     | B31 B33 | 42-7211  | Legshield top cross tube adaptor stud                          | 1                  |
| 2                     | B31 B33 | 42-7210  | Legshield top spacing sleeve                                   | 1                  |
| 3                     | B31 B33 | 67-7205  | Legshield top cross tube adaptor                               | 2                  |
| 4                     | B31 B33 | 66-7351  | Legshield support tube (top) complete                          | 2                  |
| 5                     | B31 B33 | 2-2395   | Legshield support tube clip nut                                | 8                  |
| 6                     | B31 B33 | 27-8560  | Legshield support tube clip washer (plain)                     | 8                  |
| 7                     | B31 B33 | 2-522    | Legshield front down tube split clamp eye bolt washer (spring) | 2                  |
| 8                     | B31 B33 | 2-522    | Front safety bar eye bolt washer (spring)                      | 2                  |
| 9                     | B31 B33 | 2-46     | Front safety bar eye bolt nut                                  | 2                  |
| 10                    | B31 B33 | 42-7212  | Legshield front down tube clip clamp eye bolt                  | 2                  |
| 11                    | B31 B33 | 2-46     | Front safety bar top fixing bolt nut                           | 2                  |
| 12                    | B31 B33 | 2-46     | Front safety bar top fixing bolt nut                           | 1                  |
| 13                    | B31 B33 | 2-522    | Front safety bar top fixing bolt washer (spring)               | 1                  |
| 14                    | B31 B33 | 42-4905  | Front safety bar eye bolt spacing tube                         | 1                  |
| 15                    | B31 B33 | 42-4904  | Front safety bar eye bolt                                      | 2                  |
| 16                    | B31 B33 | 65-4185  | Front safety bar top fixing bolt                               | 1                  |
| 17                    | B31 B33 | 66-7353  | Legshield support tube clip                                    | 8                  |
| 18                    | B31 B33 | 42-4906  | Legshield front support tube split clamp                       | 2                  |
| 19                    | B31 B33 | 66-7351  | Legshield support tube complete (top)                          | 2                  |
| 20                    | B31 B33 | 42-7216  | Legshield support tube complete (bottom)                       | 2                  |
| 21                    | B31 B33 | 15-7161  | Legshield support tube clip screw                              | 8                  |
| 22                    | B31 B33 | 42-7206  | Legshield (offside)  | 1                  |
| 23                    | B31 B33 | 42-4900  | Front safety bar assembly                                      | 1                  |
| 24                    | B31 B33 | 42-4907  | Front safety bar engine plate distance collar                  | 2                  |
| 25                    | B31 B33 | 42-7207  | Legshield (nearside)   | 1                  |

## STANDARD WASHERS (Spring)

| Part No. | Outer Dia. | Inside Dia. | Thickness.   | Part No. | Outer Dia. | Inside Dia. | Thickness.   |
|----------|------------|-------------|--------------|----------|------------|-------------|--------------|
| 2-522    | .750"      | .390"       | .056"        | 15-716   | .937"      | .453"       | .064"        |
| 2-995    | .656"      | .380"       | .040" double | 24-978   | .437"      | .255"       | .040"        |
| 2-1462   | .593"      | .255"       | .040"        | 24-6035  | .593"      | .317"       | .040" double |
| 2-1967   | .875"      | .440"       | .064"        | 27-6043  | .750"      | .437"       | .046" double |
| 2-2903   | .562"      | .406"       | .062"        | 28-8784  | .625"      | .315"       | .040"        |
| 3-110    | .441"      | .281"       | .080"        | 35-33    | .500"      | .343"       | .080"        |
| 3-111    | .614"      | .406"       | .104"        |          |            |             |              |

# LEGSHIELDS and FRONT SAFETY BARS

B31 B33 (Swinging Arm)

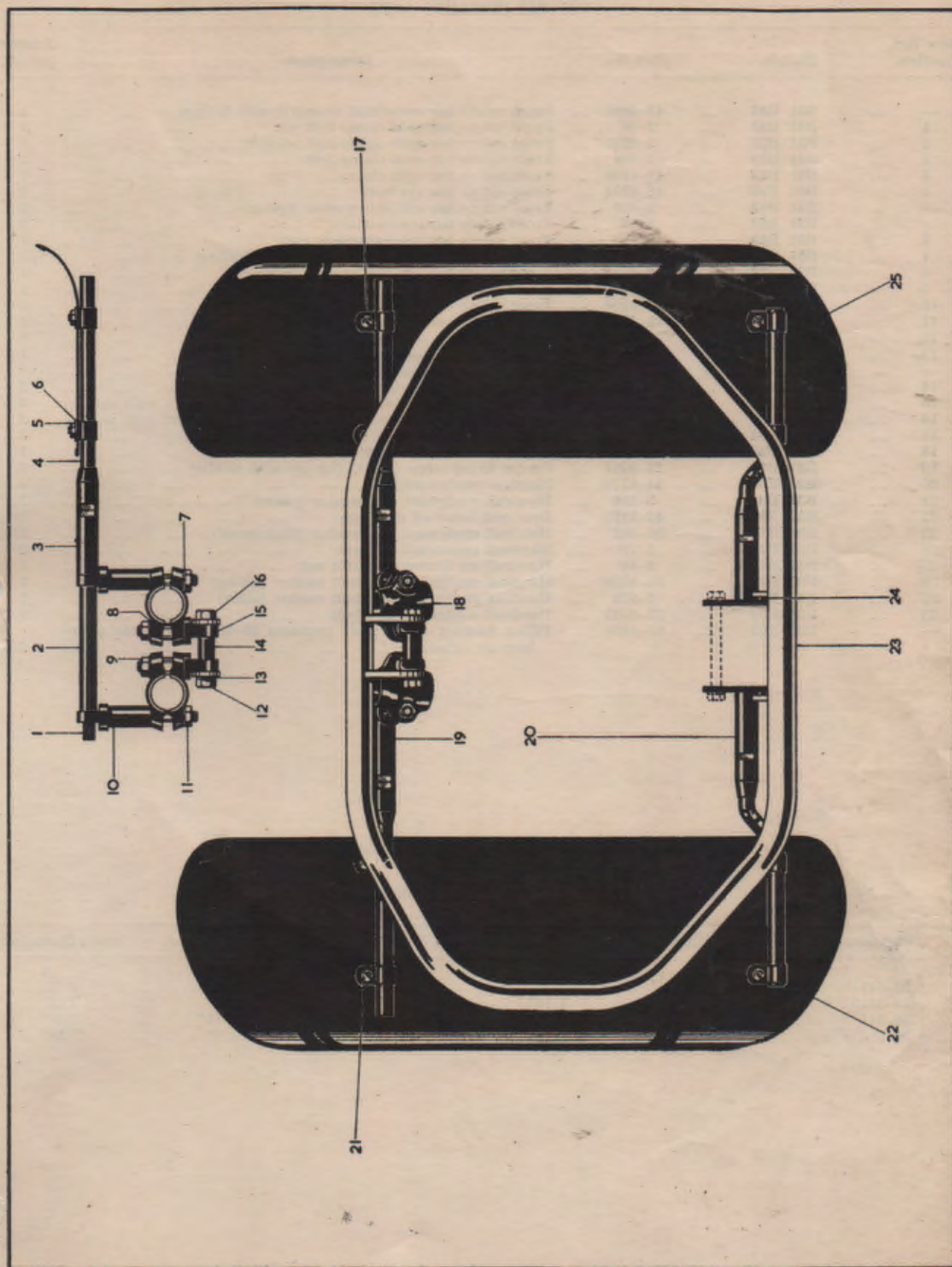

## Plate 15

FRONT and REAR SAFETY BARS, CARRIER  
and HANDRAIL

B31 B33 (Swinging Arm)

| Plate Ref.<br>Number. | Models. | Part No. | Description.   | Number<br>per set. |
|-----------------------|---------|----------|--|--------------------|
| —                     | B31 B33 | 42-4899  | Front safety bar assembled complete with fittings                                | 1                  |
| 1                     | B31 B33 | 2-46     | Front safety bar split clamp bolt nut  | 2                  |
| 2                     | B31 B33 | 2-2903   | Front safety bar split clamp bolt washer   | 2                  |
| 3                     | B31 B33 | 2-803    | Front safety bar split clamp bolt  | 2                  |
| 4                     | B31 B33 | 42-4906  | Front safety bar split clamp   | 2                  |
| 5                     | B31 B33 | 42-4904  | Front safety bar eye bolt  | 2                  |
| —                     | B31 B33 | 2-522    | Front safety bar eye bolt washer (spring)  | 2                  |
| —                     | B31 B33 | 2-46     | Front safety bar eye bolt nut  | 2                  |
| 6                     | B31 B33 | 2-46     | Front safety bar top fixing bolt nut   | 1                  |
| 7                     | B31 B33 | 2-522    | Front safety bar top fixing bolt washer (spring)                                 | 1                  |
| 8                     | B31 B33 | 42-4905  | Front safety bar eye bolt spacing tube   | 1                  |
| 9                     | B31 B33 | 65-4185  | Front safety bar fixing bolt (top)   | 1                  |
| 10                    | B31 B33 | 42-4900  | Front safety bar complete  | 1                  |
| 11                    | B31 B33 | 42-4907  | Front safety bar engine plate distance collar                                    | 2                  |
| 12                    | B31 B33 | 42-4910  | Rear safety bar complete (offside)   | 1                  |
| 13                    | B31 B33 | 42-4914  | Rear safety bar complete (nearside)  | 1                  |
| —                     | B31 B33 | 42-4909  | Rear safety bar assembly   | 1                  |
| 14                    | B31 B33 | 15-7161  | Carrier fixing screw (rear) (for use with saddle)                                | 2                  |
| 15                    | B31 B33 | 2-525    | Carrier fixing screw washer (rear) (plain) (for use with saddle)                 | 2                  |
| 16                    | B31 B33 | 2-1462   | Carrier fixing screw washer (rear) (spring) (for use with saddle)                | 2                  |
| 17                    | B31 B33 | 2-2395   | Carrier fixing screw nut (rear) (for use with saddle)                            | 2                  |
| 18                    | B31 B33 | 42-6920  | Carrier complete (for use with saddle)   | 1                  |
| 19                    | B31 B33 | 27-6037  | Carrier fixing screw (front) (for use with saddle)                               | 2                  |
| 20                    | B31 B33 | 24-6770  | Handrail mudguard bolt   | 2                  |
| 21                    | B31 B33 | 2-293    | Handrail mudguard bolt washer (plain)  | 2                  |
| 22                    | B31 B33 | 42-9172  | Dual seat handrail complete  | 1                  |
| 23                    | B31 B33 | 36-382   | Handrail mudguard bolt washer (shakeproof)                                       | 2                  |
| 24                    | B31 B33 | 2-49     | Handrail mudguard bolt nut   | 2                  |
| 25                    | B31 B33 | 2-49     | Handrail mudguard stay bolt nut  | 2                  |
| 26                    | B31 B33 | 24-8784  | Handrail mudguard stay bolt washer (spring)                                      | 2                  |
| 27                    | B31 B33 | 2-923    | Handrail mudguard stay bolt washer (plain)                                       | 2                  |
| 28                    | B31 B33 | 27-6037  | Handrail mudguard stay bolt  | 2                  |
| —                     | B31 B33 | 65-4894  | Pillion footrest anchor bolt (replaces 29-7560 when rear safety bars are fitted) | 2                  |

## STANDARD WASHERS (Shakeproof)

| Part No. | Outer Diameter. | Inside Diameter. | Part No. | Outer Diameter. | Inside Diameter. |
|----------|-----------------|------------------|----------|-----------------|------------------|
| 29-541   | 1/2"            | 1/4"             | 36-399   | 11/16"          | 3/8"             |
| 29-3319  | 3/8"            | 3/16"            | 65-595   | 7/8"            | 1/2"             |
| 36-341   | 9/16"           | 5/16"            | 66-4707  | 11/16"          | 3/8"             |
| 36-382   | 9/16"           | 5/16"            | 66-4708  | 3/4"            | 7/16"            |

# FRONT and REAR SAFETY BARS, CARRIER and HANDRAIL B31 B33 (Swinging Arm)

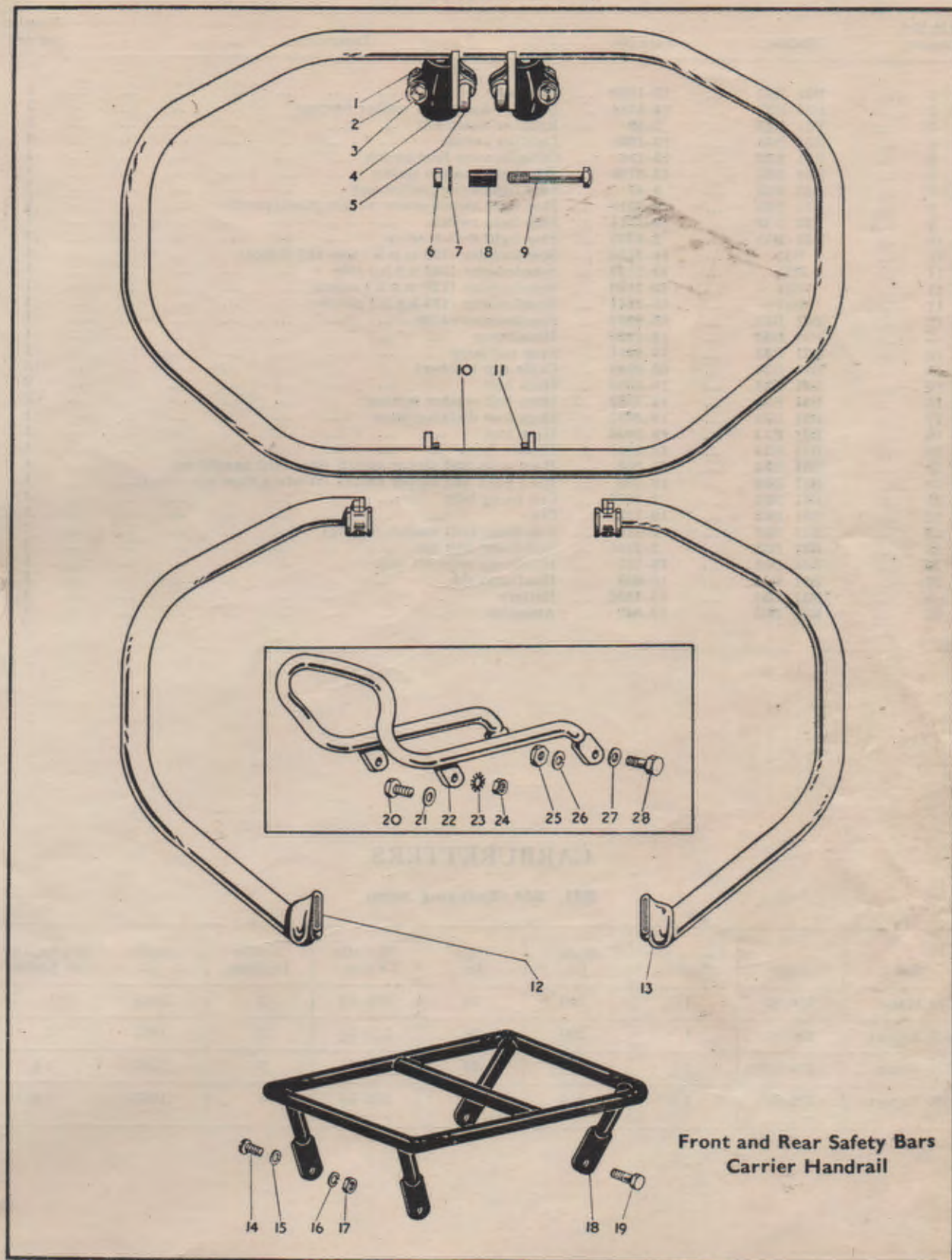

Front and Rear Safety Bars  
Carrier Handrail

## ELECTRICAL EQUIPMENT

## B31 B33 (Swinging arm)

| Plate Ref.<br>Number. | Models. | Part No. | Description.   | Number<br>per set. |
|-----------------------|---------|----------|--|--------------------|
| 1                     | B31 B33 | 19-1639  | Rectifier  | 1                  |
| 2                     | B31 B33 | 24-8784  | Rectifier fixing nut washer (spring)                 | 1                  |
| 3                     | B31 B33 | 2-49     | Rectifier fixing nut                                 | 1                  |
| 4                     | B31 B33 | 19-1666  | Lighting switch                                      | 1                  |
| 5                     | B31 B33 | 19-736   | Cable harness (less switch)                          | 1                  |
| 6                     | B31 B33 | 42-9129  | Stop light tension spring                            | 1                  |
| 7                     | B31 B33 | 2-47     | Stop light switch screw nut                          | 2                  |
| 8                     | B31 B33 | 29-3319  | Stop light switch screw washer (shakeproof)          | 2                  |
| 9                     | B31 B33 | 19-1114  | Stop light switch                                    | 1                  |
| 10                    | B31 B33 | 2-1309   | Stop light switch screw                              | 2                  |
| 11                    | B33     | 19-2136  | Speedometer (120 m.p.h.) solo and sidecar            | 1                  |
| 11                    | B31     | 19-2137  | Speedometer (180 k.p.h.) solo                        | 1                  |
| 11                    | B31     | 19-2140  | Speedometer (120 m.p.h.) sidecar                     | 1                  |
| 11                    | B31     | 19-2141  | Speedometer (180 k.p.h.) sidecar                     | 1                  |
| 12                    | B31 B33 | 65-9267  | Speedometer cable                                    | 1                  |
| —                     | B31 B33 | 19-1220  | Distributor  | 1                  |
| 13                    | B31 B33 | 19-1011  | Stop tail lamp                                       | 1                  |
| 14                    | B31 B33 | 66-9049  | Cable clip (rubber)                                  | 15                 |
| 15                    | B31 B33 | 19-2038  | Horn bolt  | 2                  |
| 16                    | B31 B33 | 19-2039  | Horn bolt washer (spring)                            | 2                  |
| 17                    | B31 B33 | 19-2037  | Horn foot distance piece                             | 1                  |
| 18                    | B31 B33 | 19-2036  | Horn foot  | 1                  |
| 19                    | B31 B33 | 19-2035  | Electric horn  | 1                  |
| 20                    | B31 B33 | 19-706   | Horn push and dipper switch (standard handlebar)     | 1                  |
| 20                    | B31 B33 | 19-709   | Horn push and dipper switch (Western type handlebar) | 1                  |
| 21                    | B31 B33 | 2-2273   | Coil fixing bolt                                     | 2                  |
| 22                    | B31 B33 | 19-723   | Coil   | 1                  |
| 23                    | B31 B33 | 2-1462   | Coil fixing bolt washer (spring)                     | 2                  |
| 24                    | B31 B33 | 2-2395   | Coil fixing bolt nut                                 | 2                  |
| 25                    | B31 B33 | 19-731   | Headlamp reflector unit                              | 1                  |
| 26                    | B31 B33 | 19-609   | Headlamp rim   | 1                  |
| —                     | B31 B33 | 19-1552  | Battery  | 1                  |
| 27                    | B31 B33 | 19-649   | Ammeter  | 1                  |

## CARBURETTORS

## B31 B33 (Swinging Arm)

| Model        | Type   | Choke Size<br>(inches) | Main<br>Jet | Pilot<br>Jet | Throttle<br>Valve | Needle<br>Position | Needle<br>Jet | Engine End<br>Size (inches) |
|--------------|--------|------------------------|-------------|--------------|-------------------|--------------------|---------------|-----------------------------|
| B31 Home ... | 376/81 | 1                      | 260         | 30           | 376/3½            | 2                  | .1065         | 1                           |
| B31 Export   | 376/82 | 1                      | 200         | 30           | 376/3½            | 2                  | .1065         | 1                           |
| B33 Home ... | 376/85 | 1 ⅛                    | 260         | 25           | 376/3½            | 3                  | .1065         | 1 ⅛                         |
| B33 Export   | 376/84 | 1 ⅛                    | 210         | 25           | 376/3½            | 3                  | .1065         | 1 ⅛                         |

# ELECTRICAL EQUIPMENT

B31 B33 (Swinging Arm)

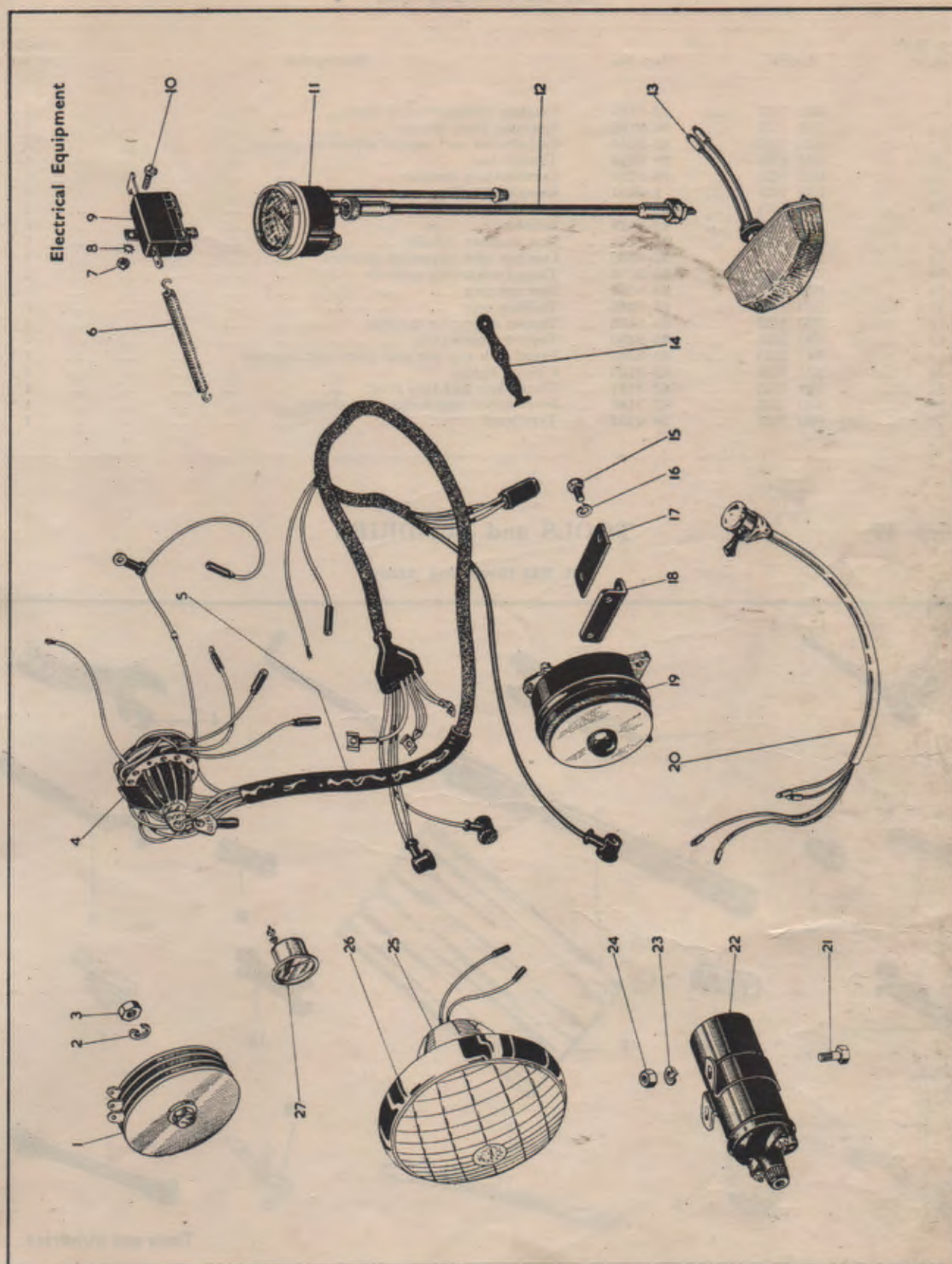

# Plate 17

## TOOLS and SUNDRIES

B31 B33 (Swinging Arm)

| Plate Ref.<br>Number. | Models. | Part No. | Description.   | Number<br>per set. |
|-----------------------|---------|----------|--|--------------------|
| ...                   | B31 B33 | ...      | 42-9185 ... Toolbag complete with tools              | 1                  |
| 1                     | B31 B33 | ...      | 66-9132 ... Sparking plug spanner                    | 1                  |
| 2                     | B31 B33 | ...      | 65-9246 ... Carburetter and tappet adjusting spanner | 1                  |
| 3                     | B31 B33 | ...      | 29-9253 ... Tommy bar                                | 1                  |
| 4                     | B31 B33 | ...      | 29-9254 ... Combination spanner                      | 1                  |
| 5                     | B31 B33 | ...      | 1-3051 ... Double ended spanner (B.S.A.)             | 1                  |
| 6                     | B31 B33 | ...      | 66-9036 ... Box spanner                              | 1                  |
| 7                     | B31 B33 | ...      | 42-9026 ... Inflator                                 | 1                  |
| 8                     | B31 B33 | ...      | 65-9115 ... Box spanner (small)                      | 1                  |
| 9                     | B31 B33 | ...      | 42-9080 ... Damper unit adjusting spanner            | 1                  |
| 10                    | B31 B33 | ...      | 65-9132 ... Tappet adjusting spanner                 | 1                  |
| 11                    | B31 B33 | ...      | 29-9257 ... Box spanner                              | 1                  |
| 12                    | B31 B33 | ...      | 65-9282 ... Toolbag only                             | 1                  |
| 13                    | B31 B33 | ...      | 65-9133 ... Tappet adjusting spanner                 | 1                  |
| 14                    | B31 B33 | ...      | 65-9130 ... Tappet feelers (set)                     | 1                  |
| 15                    | B31 B33 | ...      | 65-9243 ... Front fork top nut and gland nut spanner | 1                  |
| 16                    | B31 B33 | ...      | 42-9195 ... Licence holder                           | 1                  |
| 17                    | B31 B33 | ...      | 42-9177 ... Clutch key and tyre lever                | 1                  |
| 18                    | B31 B33 | ...      | 42-9186 ... Screwdriver and feeler (distributor)     | 1                  |
| 19                    | B31 B33 | ...      | 29-9252 ... Tyre lever                               | 1                  |

# Plate 17

## TOOLS and SUNDRIES

B31 B33 (Swinging Arm)

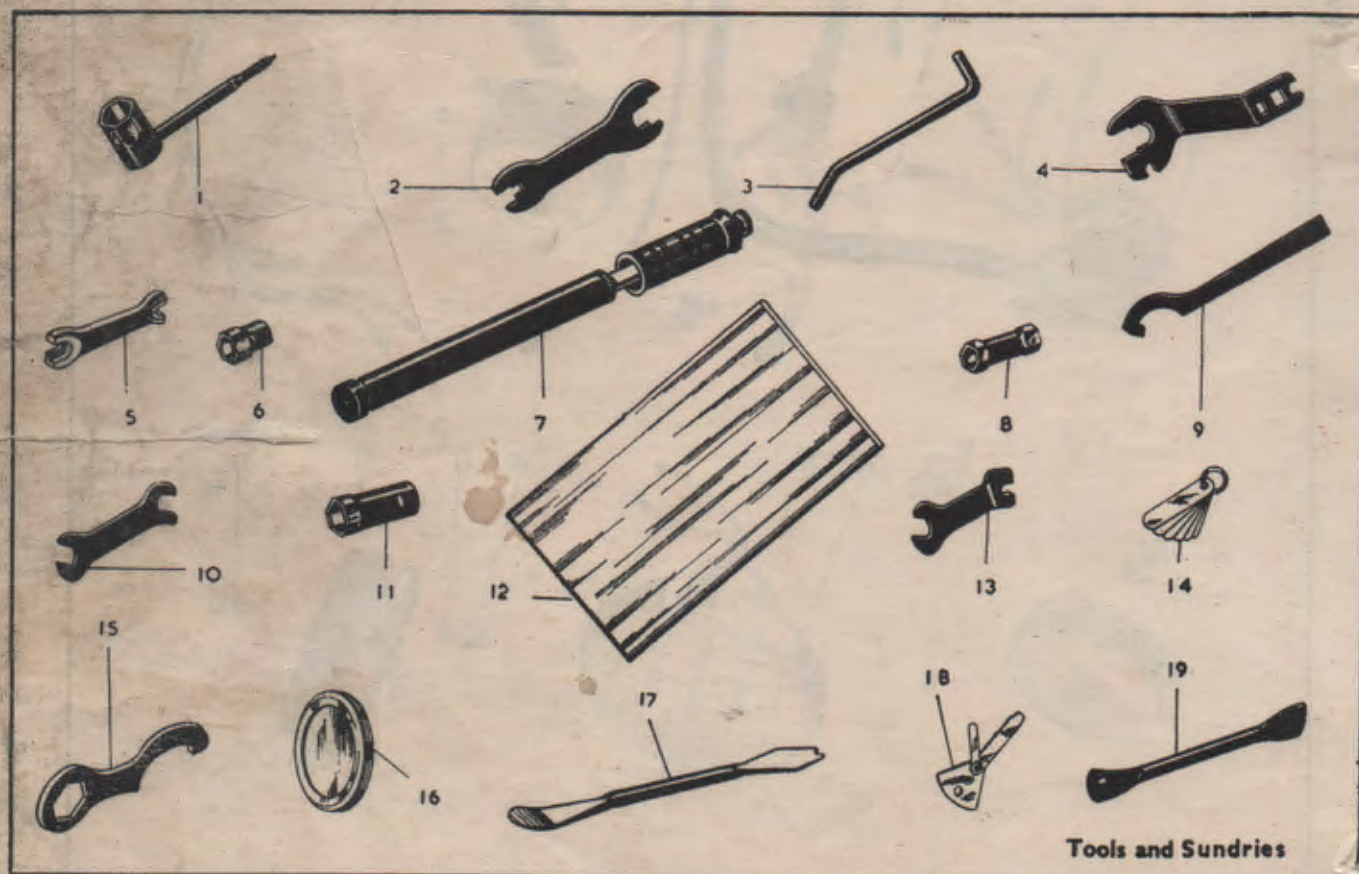

Tools and Sundries