

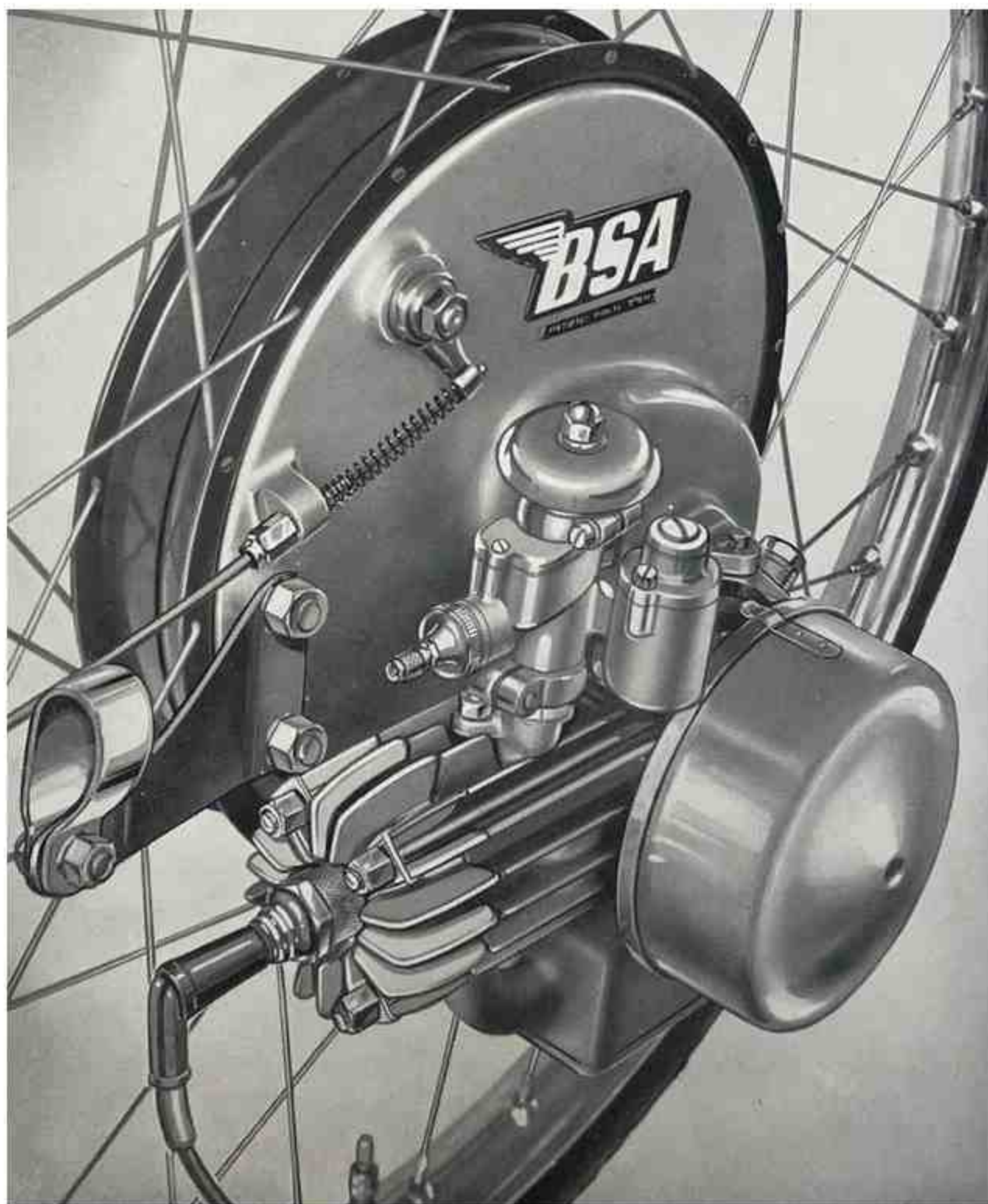

BSA Winged Wheel
Model W1
Spare Parts Catalogues
Series "B" & "D"



Catalogue

SERIES "B"



BSA

Winged Wheel

Model W1

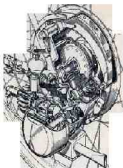

Plate Ref. No	Part Number	Description	No. per set
—	62-316	Wheel with hub and spokes only (26"x11")	1
—	62-330	Wheel with hub and spokes only (28"x11")	1
1	1-5991	Cable clip (rubber)	3
2	62-345	Combined spanner	1
3	32-9310	Spanner ($\frac{3}{8}$ "x1")	1
4	62-458	B.S.A. badge	1
5	62-469	Badge retaining screw	4
6	62-296	Crankcase inner cover oil seal	1
7	62-303	Crankcase inner cover	1
8	86-1256	Clutch shaft bearing	1
9	62-164	Grit protection washer	1
10	62-176	Clutch operating plate	1
11	62-163	Clutch shaft	1
12	62-181	Clutch spring housing	10
13	62-180	Clutch spring	10
14	62-179	Clutch spring back plate	1
15	62-175	Clutch spring plate	1
16 18	62-173	Clutch driving plate complete with inserts	2
17	62-172	Clutch driven plate (outer)	1
19	62-171	Clutch driven plate (inner)	1
20	62-193	Crankcase inner cover joint washer	1
21	62-168	Clutch gear wheel complete with bush and inserts	1
22	62-166	Clutch driven back plate	1
23, 25	62-362	Grit protection washer	2
24	62-165	Clutch bearing circlip	1
26	86-1256	Clutch shaft bearing	1
27	62-178	Clutch operating rod seal	1
28	62-177	Clutch operating rod	1
29	62-142	Magneto complete (Wico-Pacy)	1
—	62-486	Magneto complete (Miller)	1
30	21-5103	Magneto fixing nut	1
31	62-307	Drain screw	1
32	36-382	Magneto fixing nut washer (shakeproof)	1
33	62-120	Crankcase outer cover	1
34	62-388	Crankcase outer cover oil seal	1
35	62-358	Roller outer race	1
36	62-138	Crankcase roller	13
37	62-389	Spacing collar	1
38	62-138	Crankcase roller	13
39	62-143	Crankshaft key	2
40	62-123	Flywheel and connecting rod assembly	1
41	62-107	Crankcase outer cover fixing stud (short)	2
42	62-115	Crankcase outer cover fixing stud dowel bush	1
43	62-117	Oil filler bracket joint washer	1
44	62-116	Oil filler bracket	1
45	62-118	Oil filler bracket stud	2
46	29-3319	Oil filler bracket stud washer (shakeproof)	2
47	21-5161	Oil filler bracket stud nut	2
48	62-452	Ball cage with balls	1

Plate Ref. No	Part Number	Description	No. per set
49	62-184	Hub dust cap (large) (no longer fitted) ...	1
50	28-43	Crankcase oil filler plug ...	1
51	62-138	Crankcase roller ...	13
52	62-111	Roller outer race ...	1
53	62-388	Crankcase oil seal ...	1
54	62-139	Crankshaft pinion ...	1
55	62-242	Clutch release lever pivot ...	1
56	35-701	Clutch release lever split pin ...	2
57	8-1359	Retaining pin washer (steel and alloy shoe) ...	2
58	62-240	Retaining pin spring (steel shoe only) ...	2
59	2-1096	Retaining pin washer (steel shoe only) ...	2
—	62-563	Retaining pin washer (spring) (alloy shoe only) ...	2
60	35-701	Retaining pin washer split pin (steel shoe only) ...	2
—	62-561	Retaining pin nut (self-locking) (alloy shoe only) ...	2
61	62-236	Brake shoe return spring (steel shoe only) ...	1
—	62-479	Brake shoe return spring (alloy shoe only) ...	1
62	62-235	Brake shoe lining (steel and alloy shoe) ...	2
63	62-224	Brake shoe lining rivet (steel shoe only) ...	10
—	62-551	Brake shoe lining rivet (alloy shoe only) ...	8
64	35-702	Anchor plate split pin (steel and alloy shoe) ...	2
65	62-451	Anchor plate washer (steel and alloy shoe) ...	2
66	21-5204	Crankshaft pinion nut ...	1
67	62-140	Pinion tab washer ...	1
68	62-290	Hub spindle ...	1
69	62-313	Hub spindle oil seal ...	1
70	62-456	Hub shell and driven gear ...	1
71	29-925	Hub centre key ...	1
72	62-289	Crankcase inner cover bush (not sold separately) ...	1
73	62-110	Crankcase inner cover fixing stud ...	9
74	62-115	Crankcase inner cover dowel bush ...	2
75	29-541	Crankcase inner cover fixing stud washer (shakeproof) ...	9
76	21-5102	Crankcase inner cover fixing stud nut ...	9
77	62-365	Rear wheel spoke (for use with 26"x1½" wheel) (12 gauge) ...	36
—	62-332	Rear wheel spoke (for use with 28"x1½" wheel) (12 gauge) ...	36
78	62-317	Rear wheel rim (26"x1½") ...	1
—	62-331	Rear wheel rim (28"x1½") ...	1
79	62-351	Roller retainer drive spring ...	1
80	14-3596	Driving piece circlip ...	1
81	62-291	Roller retainer driver ...	1
82	14-3575	Ball cage with balls ...	1
83	14-3593	Driving piece ...	1
84	62-540	Hub nut lockwasher ...	1
85	62-297	Hub shell nut ...	1
86	62-367	Spoke nipple (12 gauge) ...	36
87	62-295	Dust cover ...	1
88	62-374	Sprocket (18T) ...	1
89	1-1797	Locking ring ...	1
90	1-4675	½" diameter steel ball ...	10
91	62-350	Fixed cone ...	1
92	14-3614	Oil seal assembly complete ...	1
93	62-376	Cone locking washer ...	1

Plate Ref. No	Part Number	Description	No. per set
94, 95	1-1804	Rear hub spindle washer	2
96	11-3038	Rear hub spindle nut	1
97	14-3594	Driving piece roller	5
98	62-198	Rear hub complete	1
99	62-314	Brake cam complete	1
100, 101	62-228	Brake shoes complete (steel)	2
—	62-474	Brake shoes complete (alloy)	2
102	62-113	Brake cam bush	1
103	62-102	Crankcase complete with outer cover and fittings	1
104	62-238	Brake cam lever	1
105	36-382	Brake cam washer (shakeproof)	1
106	21-5103	Brake cam nut	1
107	62-309	Torque link	1
108	14-3579	Torque clip bolt	1
109	62-246	Torque clip (Roadster) with nut and bolt	1
110	1-5954	Torque clip bolt washer (plain)	1
111	62-321	Torque clip (Sports) with nut and bolt	1
112	1-8417	Torque clip bolt nut	1
113	62-106	Cylinder fixing stud	4
114	62-146	Cylinder barrel	1
115	62-145	Cylinder barrel and crankcase joint washer	1
116, 117	62-153	Piston compression ring	2
118	62-151	Piston complete with gudgeon pin, rings, circlips and pegs	1
119	62-156	Piston ring retaining peg	2
120	35-4341	Torque link stud	2
121	36-382	Torque link washer (shakeproof)	2
122	21-5103	Torque link nut	2
123	62-385	Rear hub spindle locknut	1
124, 125	1-1804	Rear hub spindle washer	2
126	11-3038	Rear hub spindle nut	1
127	62-115	Crankcase outer cover fixing stud dowel bush	1
128	62-108	Crankcase outer cover fixing stud (long)	2
129	62-302	Clutch release lever	1
130	62-126	Small end bush	1
131	62-154	Gudgeon pin	1
132	62-155	Gudgeon pin circlip	1
133	62-219	Silencer baffle	1
134	62-227	Silencer body cover washer	1
135	29-541	Crankcase outer cover fixing nut washer (shakeproof)	4
136	21-5102	Crankcase outer cover fixing nut	4
137	29-541	Magneto fixing screw washer (shakeproof)	2
138	65-2158	Magneto fixing screw	2
139	62-221	Silencer bolt locknut	1
140	2-1865	Silencer bolt washer	1
141	62-470	Silencer body cover	1
142	2-1865	Silencer bolt washer	1
143	21-5364	Silencer body cover bolt	1
144	62-221	Exhaust pipe stud nut	9
145	62-148	Exhaust pipe stud	12
146	62-215	Exhaust assembly complete	1
147	62-226	Exhaust flange washer	1

Plate Ref. No	Part Number	Description	No. per set
148	62-369	Magneto cable clip	1
149	67-985	Spark plug cover and suppressor ...	1
150	62-338	Spark plug (14mm.)	1
151	62-158	Cylinder head	1
152	62-161	Cylinder head securing nut	4
153	62-542	Cylinder head securing plate	4
154	62-207	Inlet pipe joint washer	1
155	62-206	Inlet pipe	1
156	62-148	Inlet pipe fixing stud	2
157	62-221	Inlet pipe fixing stud nut	2
158	62-209	Amal carburetter	1
159	62-283	Throttle cable complete	1
160	62-286	Throttle lever	1
161	62-353	Brake cable tension spring	1
162	62-277	Brake cable complete	1
163	8-2048	Brake lever	1
164	21-5407	Petrol tank securing clip bolt	1
165	29-541	Petrol tank securing clip bolt washer (shake- proof)	1
166	62-319	Petrol tank securing clip	1
167	29-541	Petrol tank bar fixing nut washer (shake- proof)	1
168	21-5102	Petrol tank bar fixing nut	1
169	62-274	Clutch lever	1
170	62-271	Clutch cable complete	1
171	62-262	Flexible petrol pipe	1
172	1-6019	Petrol tank stay clip bolt	6
173	62-265	Petrol tank stay clip (outside)	2
174	62-370	Petrol pipe clip	1
175	62-266	Petrol tank stay clip (inside)	2
176	29-3319	Petrol tank stay clip bolt washer (shakeproof)	6
177	1-4616	Petrol tank stay clip bolt nut	6
178	62-261	Petrol tap	1
179	15-792	Petrol tap washer (fibre)	1
180	62-250	Petrol tank and carrier complete (less filler cap)	1
181	62-259	Petrol tank filler cap and measure	1
—	62-378	Petrol tank adaptor set, comprising ...	1
182	21-5411	Petrol tank securing clip bolt	1
183	62-319	Petrol tank securing clip	1
184	1-3241	Petrol tank stay clip bolt	4
185, 187	62-384	Petrol tank adaptor	2
186, 188	27-8560	Petrol tank adaptor washer	2
—	62-263	Petrol pipe securing clip with bolt and nut	2
—	62-375	Spindle packing washer (crankcase end) ...	1
—	62-381	Rear number plate	1
—	62-383	Front number plate	1
—	62-391	Clutch cable complete (tandem fitting) ...	1
—	62-394	Brake cable complete (tandem fitting) ...	1
—	62-397	Throttle cable complete (tandem fitting) ...	1
—	62-538	Hub shell ring (rubber)	1
—	62-541	Magneto fixing screw washer (plain) ...	2

BSA
Winged Wheel

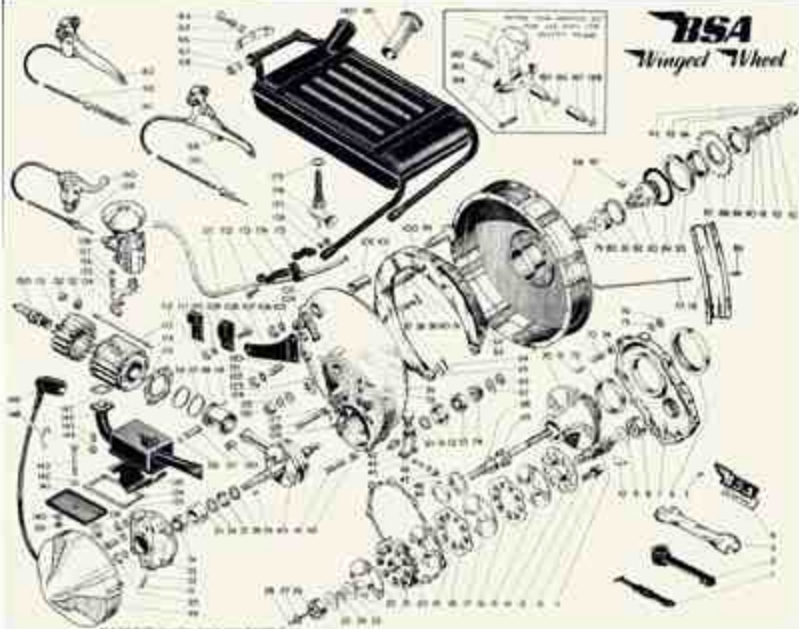

SPARKING PLUG (N.7)
Champion Sparking Plugs Ltd.,
Feltham, Middlesex.

MAGNETO (MIGEMAG, S90)
Messrs. Wico-Pacy, Denbigh Road
Bletchley, Bucks.

CARBURETTER (335/1)
Messrs. Amalgamated Carburetters
Ltd., Perry Barr, Birmingham.

MAGNETO (Type BS9)
Messrs. H. Miller & Co. Ltd.,
Aston Brook Street, Birmingham



B.S.A. CYCLES LTD., WAVERLEY WORKS
BIRMINGHAM, 10

Directors:

SIR BERNARD DICKER, K.B.E. (Chairman).
J. LEEK C.B.E. J. A. T. DICKINSON, O.B.E. S. F. DIGBY.
T. P. WHITTINGTON.

Telephone: BIRMINGHAM, VICTORIA 3711 (6 lines).
Telegrams and Cables: "SELCOYC, BIRMINGHAM."

Printed in England.

Catalogue

SERIES "D"



Winged Wheel

Model W1

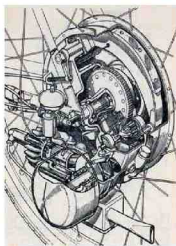

Plate Ref. No	Part Number	Description.	No. per set
—	62-316	Wheel with hub and spokes only (26"x1 $\frac{1}{2}$ ")	1
—	62-330	Wheel with hub and spokes only (28"x1 $\frac{1}{2}$ ")	1
1	1-5991	Cable clip (rubber)	3
2	62-345	Combined spanner	1
3	32-9310	Spanner ($\frac{5}{8}$ "x $\frac{3}{4}$ ")	1
4	62-458	B.S.A. badge	1
5	62-469	Badge retaining screw	4
6	62-296	Crankcase inner cover oil seal	1
7	62-303	Crankcase inner cover	1
8	86-1256	Clutch shaft bearing	1
9	62-164	Grit protection washer	1
10	62-176	Clutch operating plate	1
11	62-163	Clutch shaft	1
12	62-181	Clutch spring housing	10
13	62-180	Clutch spring	10
14	62-179	Clutch spring back plate	1
15	62-175	Clutch spring plate	1
16 18	62-173	Clutch driving plate complete with inserts .	2
17	62-172	Clutch driven plate (outer)	1
19	62-171	Clutch driven plate (inner)	1
20	62-193	Crankcase inner cover joint washer... ..	1
21	62-168	Clutch gear wheel complete with bush and inserts	1
22	62-166	Clutch driven back plate	1
23, 25	62-362	Grit protection washer	2
24	62-165	Clutch bearing circlip	1
26	86-1256	Clutch shaft bearing	1
27	62-178	Clutch operating rod seal	1
28	62-177	Clutch operating rod	1
29	62-142	Magneto complete (Wico-Pacy)	1
—	62-486	Magneto complete (Miller)	1
30	21-5103	Magneto fixing nut	1
31	62-307	Drain screw	1
32	36-382	Magneto fixing nut washer (shakeproof) ...	1
33	62-120	Crankcase outer cover... ..	1
34	62-388	Crankcase outer cover oil seal	1
35	62-358	Roller outer race	1
36	62-138	Crankcase roller	13
37	62-359	Spacing collar	1
38	62-138	Crankcase roller	13
39	62-143	Crankshaft key	2
40	62-123	Flywheel and connecting rod assembly ...	1
41	62-107	Crankcase outer cover fixing stud (short) ...	2
42	62-115	Crankcase outer cover fixing stud dowel bush	1
43	62-117	Oil filler bracket joint washer	1
44	62-116	Oil filler bracket	1
45	62-118	Oil filler bracket stud	2
46	29-3319	Oil filler bracket stud washer (shakeproof)	2
47	21-5161	Oil filler bracket stud nut	2
48	62-452	Ball cage with balls	1

Plate Ref. No	Part Number	Description	No. per set
49	62-184	Hub dust cap (large) (no longer fitted) ...	1
50	28-43	Crankcase oil filler plug ...	1
51	62-138	Crankcase roller ...	13
52	62-111	Roller outer race ...	1
53	62-388	Crankcase oil seal ...	1
54	62-139	Crankshaft pinion ...	1
55	62-242	Clutch release lever pivot ...	1
56	35-701	Clutch release lever split pin ...	2
57	8-1359	Retaining pin washer (steel and alloy shoe)	2
58	62-240	Retaining pin spring (steel shoe only) ...	2
59	2-1096	Retaining pin washer (steel shoe only) ...	2
—	62-563	Retaining pin washer (spring)(alloy shoe only)	2
60	35-701	Retaining pin washer split pin (steel shoe only)	2
—	62-561	Retaining pin nut (self-locking)(alloy shoe only)	2
61	62-236	Brake shoe return spring (steel shoe only) .	1
—	62-479	Brake shoe return spring (alloy shoe only).	1
62	62-235	Brake shoe lining (steel and alloy shoe) ...	2
63	62-224	Brake shoe lining rivet (steel shoe only) ...	10
—	62-551	Brake shoe lining rivet (alloy shoe only)...	8
64	35-702	Anchor plate split pin (steel and alloy shoe)	2
65	62-451	Anchor plate washer (steel and alloy shoe).	2
66	21-5204	Crankshaft pinion nut... ..	1
67	62-140	Pinion tab washer	1
68	62-290	Hub spindle	1
69	62-313	Hub spindle oil seal	1
70	62-456	Hub shell and driven gear	1
71	29-925	Hub centre key	2
72	62-299	Crankcase inner cover bush (not sold separately)	1
73	62-110	Crankcase inner cover fixing stud	9
74	62-115	Crankcase inner cover dowel bush	2
75	29-541	Crankcase inner cover fixing stud washer (shakeproof)	9
76	21-5102	Crankcase inner cover fixing stud nut	9
77	62-365	Rear wheel spoke (for use with 26"x1½" wheel) (12 gauge)	36
—	62-332	Rear wheel spoke (for use with 28"x1½" wheel) (12 gauge)	36
78	62-317	Rear wheel rim (26"x1½")	1
—	62-331	Rear wheel rim (28"x1½")	1
79	62-351	Roller retainer drive spring	1
80	14-3596	Driving piece circlip	1
81	62-291	Roller retainer driver	1
82	14-3575	Ball cage with balls	1
83	14-3593	Driving piece	1
84	62-540	Hub nut lockwasher	1
85	62-297	Hub shell nut	1
86	62-367	Spoke nipple (12 gauge)	36
87	62-295	Dust cover	1
88	62-374	Sprocket (18T)	1
89	1-1797	Locking ring	1
90	1-4675	½" diameter steel ball	10
91	62-350	Fixed cone	1
92	14-3614	Oil seal assembly complete	1
93	62-376	Cone locking washer	1

Plate Ref. No	Part Number	Description	No. per set
94, 95	1-1804	Rear hub spindle washer	2
96	11-3038	Rear hub spindle nut	1
97	14-3594	Driving piece roller	5
98	62-198	Rear hub complete	1
99	62-314	Brake cam complete	1
100, 101	62-228	Brake shoes complete (steel)... ..	2
—	62-474	Brake shoes complete (alloy)	2
102	62-113	Brake cam bush	1
103	62-102	Crankcase complete with outer cover and fittings	1
104	62-238	Brake cam lever	1
105	36-382	Brake cam washer (shakeproof)	1
106	21-5103	Brake cam nut	1
107	62-309	Torque link	1
108	14-3579	Torque clip bolt	1
109	62-246	Torque clip (Roadster) with nut and bolt... ..	1
110	1-5954	Torque clip bolt washer (plain)	1
111	62-321	Torque clip (Sports) with nut and bolt	1
112	1-8417	Torque clip bolt nut	1
113	62-106	Cylinder fixing stud	4
114	62-146	Cylinder barrel	1
115	62-145	Cylinder barrel and crankcase joint washer... ..	1
116, 117	62-153	Piston compression ring	2
118	62-151	Piston complete with gudgeon pin, rings, circlips and pegs	1
119	62-156	Piston ring retaining peg	2
120	35-4341	Torque link stud	2
121	36-382	Torque link washer (shakeproof)	2
122	21-5103	Torque link nut	2
123	62-385	Rear hub spindle locknut	1
124, 125	1-1804	Rear hub spindle washer	2
126	11-3038	Rear hub spindle nut	1
127	62-115	Crankcase outer cover fixing stud dowel bush	1
128	62-108	Crankcase outer cover fixing stud (long)	2
129	62-302	Clutch release lever	1
130	62-126	Small end bush	1
131	62-154	Gudgeon pin	1
132	62-155	Gudgeon pin circlip	1
133	62-219	Silencer baffle	1
134	62-227	Silencer body cover washer	1
135	29-541	Crankcase outer cover fixing nut washer (shakeproof)	4
136	21-5102	Crankcase outer cover fixing nut	4
137	29-541	Magneto fixing screw washer (shakeproof)... ..	2
138	62-141	Magneto fixing screw	2
139	62-221	Silencer bolt locknut	1
140	2-1865	Silencer bolt washer	1
141	62-470	Silencer body cover	1
142	2-1865	Silencer bolt washer	1
143	21-5364	Silencer body cover bolt	1
144	62-221	Exhaust pipe stud nut	2
145	62-148	Exhaust pipe stud	2
146	—	Exhaust assembly complete N.I.A.	1
147	62-226	Exhaust flange washer	1

Plate Ref. No	Part Number	Description	No. per set
148	62-369	Magneto cable clip	1
149	67-985	Sparking plug cover and suppressor ...	1
150	62-338	Sparking plug (14mm.)	1
151	62-158	Cylinder head	1
152	62-161	Cylinder head securing nut	4
153	62-542	Cylinder head securing plate	4
154	62-207	Inlet pipe joint washer	1
155	62-206	Inlet pipe	1
156	62-552	Inlet pipe fixing stud	2
157	62-221	Inlet pipe fixing stud nut	2
158	62-209	Amal carburetter	1
159	62-283	Throttle cable complete	1
160	62-286	Throttle lever	1
161	62-353	Brake cable tension spring	1
162	62-277	Brake cable complete	1
163	8-2048	Brake lever	1
164	21-5407	Petrol tank securing clip bolt	1
165	29-541	Petrol tank securing clip bolt washer (shake- proof)	1
166	62-319	Petrol tank securing clip	1
167	29-541	Petrol tank bar fixing nut washer (shake- proof)	1
168	21-5102	Petrol tank bar fixing nut	1
169	62-274	Clutch lever	1
170	62-271	Clutch cable complete	1
171	62-262	Flexible petrol pipe	1
172	1-6019	Petrol tank stay clip bolt	6
173	62-265	Petrol tank stay clip (outside)	2
174	62-370	Petrol pipe clip	1
175	62-266	Petrol tank stay clip (inside)	2
176	29-3319	Petrol tank stay clip bolt washer (shakeproof)	6
177	2-47	Petrol tank stay clip bolt nut	6
178	62-261	Petrol tap	1
179	15-792	Petrol tap washer (fibre)	1
180	62-250	Petrol tank and carrier complete (less filler cap)	1
181	62-259	Petrol tank filler cap and measure	1
—	62-378	Petrol tank adaptor set, comprising ...	1
182	21-5411	Petrol tank securing clip bolt	1
183	62-319	Petrol tank securing clip	1
184	1-3241	Petrol tank stay clip bolt	4
185, 187	62-384	Petrol tank adaptor	2
186, 188	27-8560	Petrol tank adaptor washer	2
—	62-263	Petrol pipe securing clip with bolt and nut	2
—	62-375	Spindle packing washer (crankcase end) ...	1
—	62-391	Clutch cable complete (tandem fitting) ...	1
—	62-394	Brake cable complete (tandem fitting) ...	1
—	62-397	Throttle cable complete (tandem fitting) ...	1
—	62-538	Hub shell ring (rubber)	1
—	62-541	Magneto fixing screw washer (plain) ...	2
—	62-564	Clutch and brake cable ferrule	as reqd.
—	62-570	Silencer complete (Burgess)	1
—	62-574	Sound absorbent pack (Burgess)	1
—	62-575	Silencer locknut (Burgess)	1
—	8-3847	Twist Grip Throttle Control & Dummy Grip	

BSA
Winged Wheel

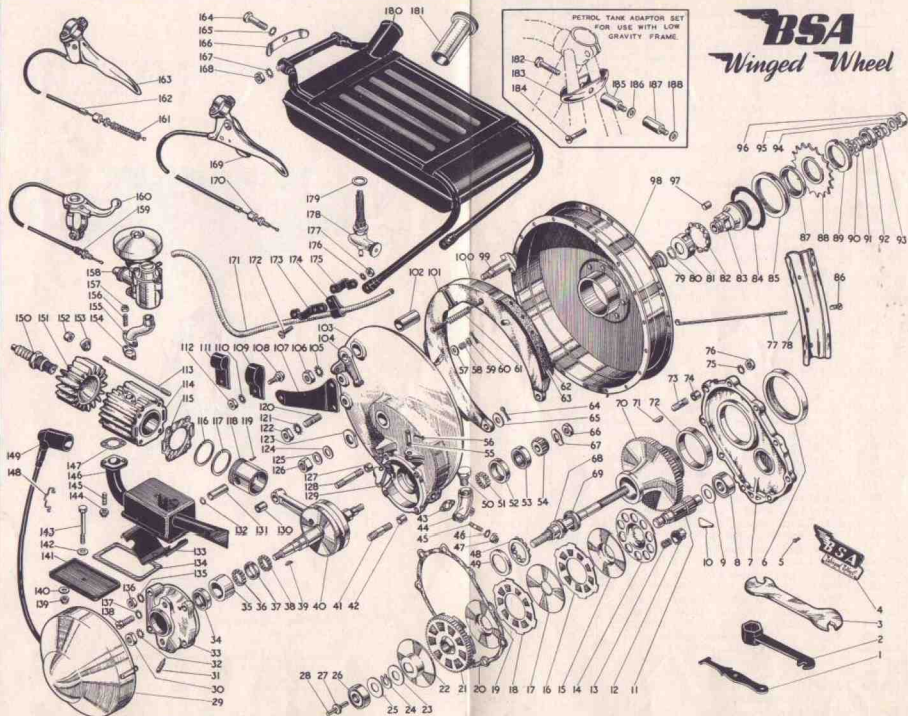

SPARKING PLUG (N.7)

Champion Sparking Plugs Ltd.,
Feltham, Middlesex.

MAGNETO (MIGEMAG, S90)

Messrs. Wico-Pacy, Denbigh Road,
Bletchley, Bucks.

CARBURETTER (335/1)

Messrs. Amalgamated Carburetters
Ltd., Perry Barr, Birmingham.

MAGNETO (Type BS9)

Messrs. H. Miller & Co. Ltd.,
Aston Brook Street, Birmingham



**B.S.A. MOTOR CYCLES LTD.,
BIRMINGHAM, 11**

Telephone: BIRMINGHAM, VICTORIA 2381
Telegrams and Cables: "SELMOTO BIRMINGHAM."

**Service, Spares and Repairs Department
WAVERLEY WORKS BIRMINGHAM, 10**

Telephone: BIRMINGHAM VICTORIA 3711
Telegrams and Cables: "SELSERV, BIRMINGHAM"